

15-199-20226-0000

FORM C-1 7/91

FORM MUST BE TYPED
FORM MUST BE SIGNED
ALL BLANKS MUST BE FILLED

FOR KCC USE:

EFFECTIVE DATE: 12-13-94

DISTRICT # 4

State of Kansas
NOTICE OF INTENTION TO DRILL

Must be approved by the K.C.C. five (5) days prior to commencing well

Expected Spud Date 12/14/94
month day year

SW SW NE 31 14 40 East
Sec Twp S. Rg West

OPERATOR: License # 5086
Name: Pintail Petroleum Ltd.
Address: 225 N. Market # 300
City/State/Zip: Wichita, KS. 67202
Contact Person: Innes Phillips
Phone: 316-263-2243

2310 feet from Stake / North line of Section
2310 feet from East / 2026X line of Section
IS SECTION X REGULAR IRREGULAR

(NOTE: Locate well on the Section Plat on Reverse Side)
County: Wallace
Lease Name: Woodmancy Well #: 1
Field Name: Wildcat

CONTRACTOR: License #: 30606
Name: Murfin Drilling Company

Is this a Pre-rated/Spec'd Field? yes X no
Target Formation(s): Marrow Sand
Nearest lease or unit boundary: 2310'

Well Drilled For: Well Class: Type Equipment:
X Oil Enh Rec Infield X Mud Rotary
Gas Storage Pool/Ext. Air Rotary
O&W Disposal X Wildcat Cable
Seismic: # of Holes Other

Ground Surface Elevation: 3704' feet MSL
Water well within one-quarter mile: X yes no
Public water supply well within one mile: X yes no

If O&W: old well information as follows:
Operator:
Well Name:
Comp. Date: Old Total Depth

Depth to bottom of fresh water: 250'
Depth to bottom of usable water: 1380'
Surface Pipe by Alternate: 1 X 300'

Directional, Deviated or Horizontal wellbore? yes X no
If yes, true vertical depth:
Bottom Hole Location:

Length of Surface Pipe Planned to be set: 300'
Length of Conductor pipe required: NA
Projected Total Depth: 5150'

Formation at Total Depth: Marrow Sand
Water Source for Drilling Operations:
well farm pond X other

AFFIDAVIT

The undersigned hereby affirms that the drilling, completion and eventual plugging of this well will comply with K.S.A. 55-101, et. seq.
It is agreed that the following minimum requirements will be met:

RECEIVED
STATE CORPORATION COMMISSION
DEC 08 1994
12-08-94

- 1. Notify the appropriate district office prior to spudding of well;
- 2. A copy of the approved notice of intent to drill shall be posted on each drilling rig;
- 3. The minimum amount of surface pipe as specified below shall be set by circulating cement to the top; in all cases surface pipe shall be set through all unconsolidated materials plus a minimum of 20 feet into the underlying formation;
- 4. If the well is dry hole, an agreement between the operator and the district office on plug length and placement is necessary prior to plugging;
- 5. The appropriate district office will be notified before well is either plugged or production casing is cemented in;
- 6. IF AN ALTERNATE II COMPLETION, PRODUCTION PIPE SHALL BE CEMENTED FROM BELOW ANY USABLE WATER TO SURFACE WITHIN 120 DAYS OF SPUD DATE. IN ALL CASES, NOTIFY DISTRICT OFFICE PRIOR TO ANY CEMENTING.

I hereby certify that the statements made herein are true and to the best of my knowledge and belief.
Date: 12/6/94 Signature of Operator or Agent: Walter James Phillips, President

FOR KCC USE:
API # 15- 199-20226-00-00
Conductor pipe required 7106 feet
Minimum surface pipe required 300 feet per Alt. X 2
Approved by: CB 12-8-94
This authorization expires: 6-8-95
(This authorization void if drilling not started within 6 months of effective date.)
Spud date: Agent:

REMEMBER TO:

- File Drill Pit Application (form DP-1) with intent to drill;
- File Completion Form ACD-1 within 120 days of spud date;
- File acreage attribution plat according to field proration orders;
- Notify appropriate district office 48 hours prior to workover or re-entry;
- Submit plugging report (CP-4) after plugging is completed;
- Obtain written approval before disposing or injecting salt water.

Mail to: Conservation Division, 200 Colorado Derby Building, 202 W. First St., Wichita, Kansas 67202-1286.

31
74
46

IN ALL CASES PLOT THE INTENDED WELL ON THE PLAT BELOW

PLAT OF ACREAGE ATTRIBUTABLE TO A WELL IN A PRORATED OR SPACED FIELD

If the intended well is in a prorated or spaced field, please fully complete this side of the form. If the intended well is in a prorated or spaced field complete the plat below showing that the well will be properly located in relationship to other wells producing from the common source of supply. Please show all the wells within 1 mile of the boundaries of the proposed acreage attribution unit for gas wells and within 1/2 mile of the boundaries of the proposed acreage attribution unit for oil wells.

API NO. 15- _____
 OPERATOR Pintail Petroleum, Ltd.
 LEASE Woodmancy
 WELL NUMBER 1
 FIELD Wildcat

LOCATION OF WELL: COUNTY Wallace
2310 feet from ~~South~~/north line of section
2310 feet from east/~~West~~ line of section
 SECTION 31 TWP 14 RG 40

NUMBER OF ACRES ATTRIBUTABLE TO WELL _____
 QTR/QTR/QTR OF ACREAGE SW - SW - NE

IS SECTION X REGULAR or _____ IRREGULAR
 IF SECTION IS IRREGULAR, LOCATE WELL FROM NEAREST CORNER BOUNDARY.

Section corner used: _____ NE _____ NW _____ SE _____ SW
PLAT

(Show location of the well and shade attributable acreage for prorated or spaced wells.)
 (Show footage to the nearest lease or unit boundary line.)

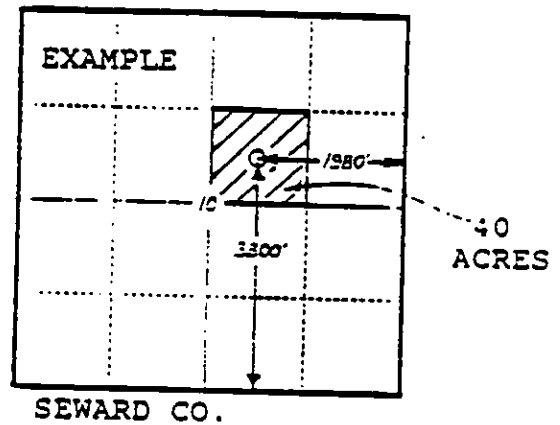
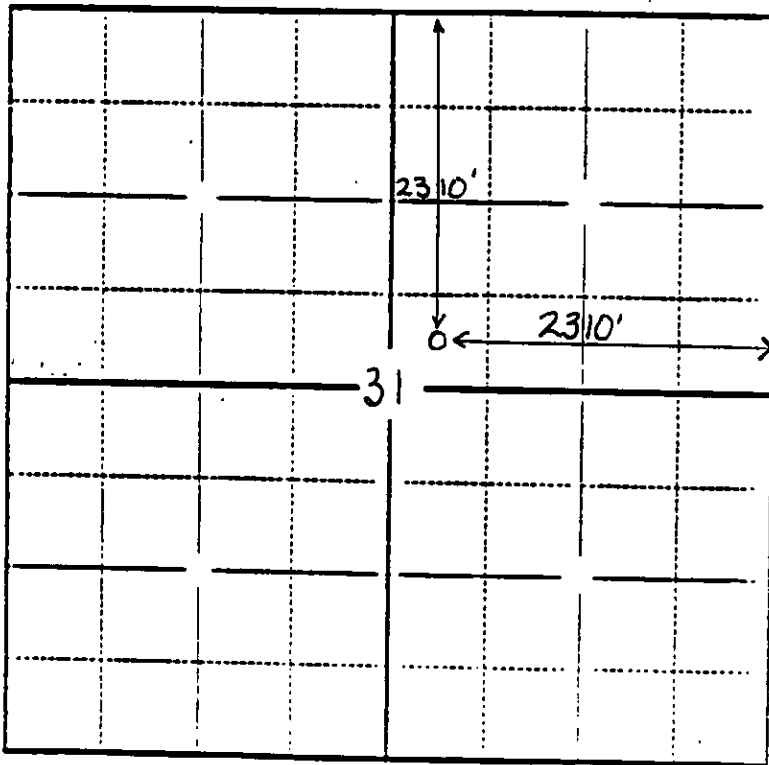

In plotting the proposed location of the well, you must show:

- 1) The manner in which you are using the depicted plat by identifying section lines, i.e. 1 section, 1 section with 8 surrounding sections, 4 sections, etc.;
- 2) the distance of the proposed drilling location from the section's south/north or east/west lines; and
- 3) the distance to the nearest lease or unit boundary line.