

15-199-20294-0000

For KCC Use: 7-17-02
Effective Date: 7-17-02
District #: 4
SGA? Yes No

KANSAS CORPORATION COMMISSION
OIL & GAS CONSERVATION DIVISION

Form C-1
September 1999
Form must be Typed
Form must be Signed
All blanks must be Filled

NOTICE OF INTENT TO DRILL

Must be approved by KCC five (5) days prior to commencing well

Expected Spud Date July 18 02
month day year

Spot East West
AP NE-NW-NW Sec. 24 Twp. 14 S. R. 40
348 feet from S / (N) (circle one) Line of Section
839 feet from E / (W) (circle one) Line of Section
Is SECTION Regular Irregular?

OPERATOR: License# 32959
Name: Deep Rock Exploration
Address: 111 W. 12th
City/State/Zip: Goodland, Kansas 67735
Contact Person: Ross McGukin
Phone: (785) 899-7060

(Note: Locate well on the Section Plat on reverse side)
County: Wallace
Lease Name: Grandview Farms Well #: 1
Field Name: ***

CONTRACTOR: License# 30606
Name: Murfin

Is this a Prorated / Spaced Field? Yes No
Target Formation(s): Chase Group
Nearest Lease or unit boundary: 348'

Well Drilled For: Oil Enh Rec Infield Mud Rotary
 Gas Storage Pool Ext. Air Rotary
 OWWO Disposal Wildcat Cable
 Seismic: # of Holes Other
 Other

Ground Surface Elevation: 3645 feet MSL
Water well within one-quarter mile: - Yes Yes No
Public water supply well within one mile: Yes No
Depth to bottom of fresh water: 300
Depth to bottom of usable water: 1680

If OWWO: old well information as follows:
Operator: _____
Well Name: _____
Original Completion Date: _____ Original Total Depth: _____

Surface Pipe by Alternate: 1 X 2
Length of Surface Pipe Planned to be set: 350
Length of Conductor Pipe required: NONE
Projected Total Depth: 4000
Formation at Total Depth: Lansing

Directional, Deviated or Horizontal wellbore? Yes No
If Yes, true vertical depth: _____
Bottom Hole Location: _____
KCC DKT #: _____

Water Source for Drilling Operations:
Well _____ Farm Pond _____ Other _____
DWR Permit #: _____
(Note: Apply for Permit with DWR)
Will Cores be taken? Yes No
If Yes, proposed zone: _____

AFFIDAVIT

RECEIVED

The undersigned hereby affirms that the drilling, completion and eventual plugging of this well will comply with K.S.A. 55-107 and 55-108. It is agreed that the following minimum requirements will be met:

JUL 11 2002

1. Notify the appropriate district office *prior* to spudding of well;
2. A copy of the approved notice of intent to drill *shall be* posted on each drilling rig;
3. The minimum amount of surface pipe as specified below *shall be set* by circulating cement to the top; in all cases surface pipe *shall be set* through all unconsolidated materials plus a minimum of 20 feet into the underlying formation.
4. If the well is dry hole, an agreement between the operator and the district office on plug length and placement is necessary *prior to plugging*;
5. The appropriate district office will be notified before well is either plugged or production casing is cemented in;
6. If an ALTERNATE II COMPLETION, production pipe shall be cemented from below any usable water to surface within **120 days** of spud date. *In all cases, NOTIFY district office prior to any cementing.*

CONSERVATION DIVISION
WICHITA, KS

I hereby certify that the statements made herein are true and to the best of my knowledge and belief.
Date: 7/10/02 Signature of Operator or Agent: Ross McGukin Title: _____

For KCC Use ONLY
API # 15 - 199-20294-0000
Conductor pipe required NONE feet
Minimum surface pipe required 350 feet per Alt. * (2)
Approved by: RSP 7-12-02
This authorization expires: 1-12-03
(This authorization void if drilling not started within 6 months of effective date.)
Spud date: _____ Agent: _____

Remember to:
- File Drill Pit Application (form CDP-1) with Intent to Drill;
- File Completion Form ACO-1 within 120 days of spud date;
- File acreage attribution plat according to field proration orders;
- Notify appropriate district office 48 hours prior to workover or re-entry;
- Submit plugging report (CP-4) after plugging is completed;
- Obtain written approval before disposing or injecting salt water.
27
14
MOA

IN ALL CASES PLOT THE INTENDED WELL ON THE PLAT BELOW

Plat of acreage attributable to a well in a prorated or spaced field

If the intended well is in a prorated or spaced field, please fully complete this side of the form. If the intended well is in a prorated or spaced field complete the plat below showing that the well will be properly located in relationship to other wells producing from the common source of supply. Please show all the wells and within 1 mile of the boundaries of the proposed acreage attribution unit for gas wells and within 1/2 mile of the boundaries of the proposed acreage attribution unit for oil wells.

API No. 15 - _____
 Operator: Deep Rock Exploration
 Lease: _____
 Well Number: 1
 Field: _____
 Number of Acres attributable to well: _____
 QTR / QTR / QTR of acreage: _____

Location of Well: County: Wallace
348 feet from S / N (circle one) Line of Section
839 feet from E / W (circle one) Line of Section
 Sec. 24 Twp. 14 S. R. 40 East West

Is Section Y Regular or _____ Irregular

If Section is Irregular, locate well from nearest corner boundary.
 Section corner used: ___NE ___NW ___SE ___SW

PLAT

*(Show location of the well and shade attributable acreage for prorated or spaced wells.)
 (Show footage to the nearest lease or unit boundary line.)*

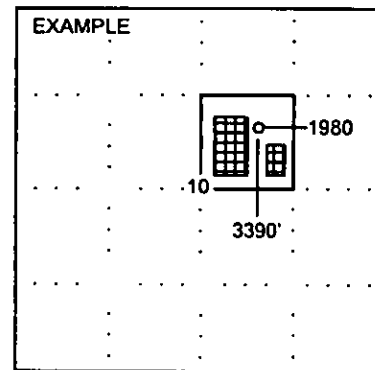
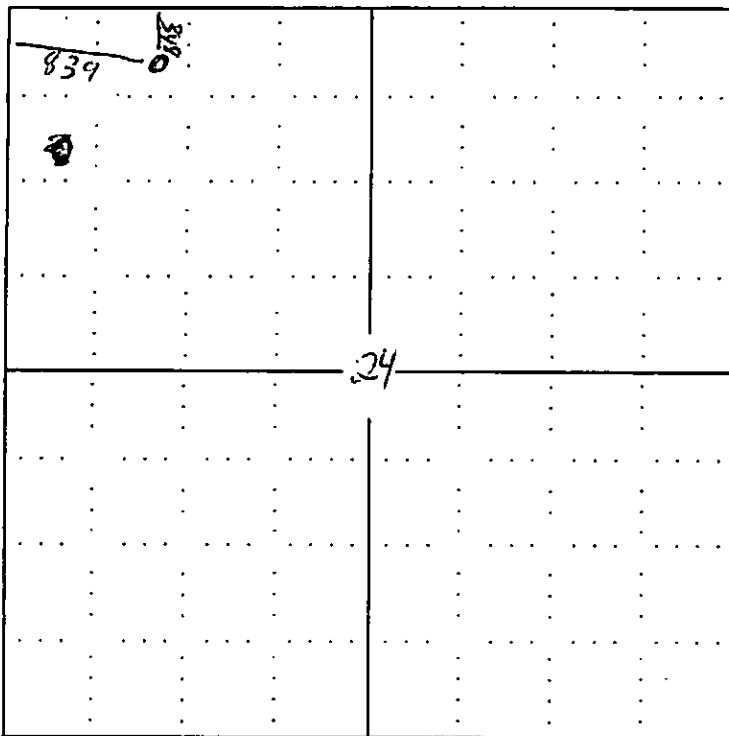

SEWARD CO.

NOTE: In all cases locate the spot of the proposed drilling locaton.

In plotting the proposed location of the well, you must show.

1. The manner in which you are using the depicted plat by identifying section lines, i.e. 1 section, 1 section with 8 surrounding sections, 4 sections, etc.
2. The distance of the proposed drilling location from the section's south / north and east / west.
3. The distance to the nearest lease or unit boundary line.
4. If proposed location is located within a prorated or spaced field a certificate of acreage attribution plat must be attached: (CO-7 for oil wells; CG-8 for gas wells).