

NOTICE OF INTENTION TO DRILL

(see rules on reverse side)

Expected Spud Date. March 5, 1988  
month day year

API Number 15- 199-20,143-00-00  
I-reg. Section

OPERATOR: License # 5171

(approx.) C S/2 N. Sec. 36 Twp. 14 S. Rg. 43 X East West

Name TXO Production Corp.

2740' Ft. from South Line of Section

Address 155 N. Market, Suite 1000

approx. ±1420' Ft. from East Line of Section

City/State/Zip Wichita, Kansas 67202

(Note: Locate well on Section Plat on reverse side)

Contact Person Cory West

Nearest lease or unit boundary line 460' (state line) feet

Phone (316) 269-7655

County Wallace

CONTRACTOR: License # 6033

Lease Name PURVIS FARMS Well # 4

Name Murfin Drilling Co.

Ground surface elevation 3897' feet MSL

City/State Wichita, Kansas 67202

Domestic well within 330 feet: no X yes

Well Drilled For: Well Class: Type Equipment:

Municipal well within one mile: no X yes

X Oil Storage Infield X Mud Rotary

Depth to bottom of fresh water 350'

Gas Inj X Pool Ext. Air Rotary

Depth to bottom of usable water 1800'

OWWO Expl Wildcat Cable

Surface pipe by Alternate: 1 2 X

If OWWO: old well info as follows:

Surface pipe planned to be set ±650'

Operator .....

Conductor pipe required none

Well Name .....

Projected Total Depth 5300' feet

Comp Date ..... Old Total Depth.....

Formation Morrow Sand

I certify that well will comply with K.S.A. 55-101, et seq., plus eventually plugging hole to KCC specifications.

Date 3-1-88 Signature of Operator or Agent Cory West

Title Drlg. & Prod. Engineer

For KCC Use:

Conductor Pipe Required ..... feet; Minimum Surface Pipe Required 350 feet per Alt. X (2)

This Authorization Expires 9-2-88 Approved By 3-2-88

EFFECTIVE DATE: 3-7-88

Must be filed with the K.C.C. five (5) days prior to commencing well  
This card void if drilling not started within six (6) months of date received by K.C.C.

Important procedures to follow:

1. Notify District office before setting surface casing.
2. Set surface casing by circulating cement to the top.
3. File completion forms ACO-1 with K.C.C. within 120 days of well spud date, following instructions on ACO-1, side 1, and including copies of wireline logs.
4. Notify District office 48 hours prior to old well workover or re-entry.
5. Prior to filing Intent, prepare a proposed plugging plan in case well is D & A, then obtain approval of plan when calling district office prior to setting surface pipe.
6. Submit plugging report (CP-4) to K.C.C. after plugging is completed.
7. Obtain an approved injection docket number before disposing of salt water.
8. Notify K.C.C. within 10 days when injection commences or terminates.
9. If an alternate 2 completion, cement in the production pipe from below any usable water to surface within 120 days of spud date.

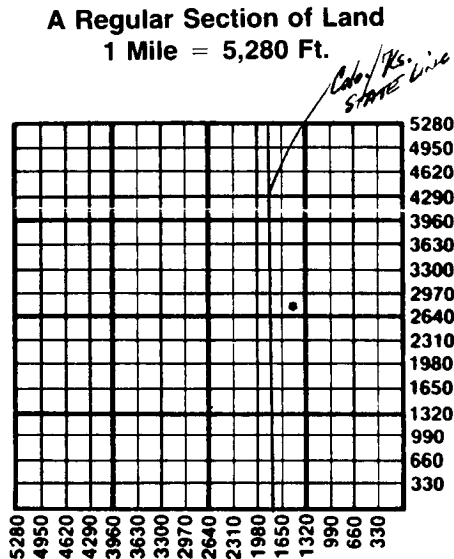

State Corporation Commission of Kansas  
Conservation Division  
200 Colorado Derby Building  
Wichita, Kansas 67202-1212  
(316) 263-3238

STATE CORPORATION COMMISSION

MAR 2 1988 03-02-88

CONSERVATION DIVISION