

NOTICE OF INTENTION TO DRILL

(see rules on reverse side)

Expected Spud Date. February 20, 1988
 month day year

API Number 15-199-20,141-00-00
 Irreg. Sec.
 SW Sec. 24 Twp. 14 S. Rg. 43 East
 1100' Ft. from South Line of Section
 Approx. 1451' Ft. from East Line of Section

OPERATOR: License # 5171
 Name TXO PRODUCTION CORP.
 Address 155 N. Market, Ste 1000
 City/State/Zip Wichita, Kansas 67202
 Contact Person Cory West
 Phone (316) 269-7655

(Note: Locate well on Section Plat on reverse side)
 Nearest lease or unit boundary line 460' feet
 County Wallace (Colorado State Line)
 Lease Name PURVIS FARMS Well # 1-24X

CONTRACTOR: License # 5422
 Name Abercrombie Drilling, Inc.
 City/State Wichita, Kansas

Ground surface elevation 3895' feet MSL
 Domestic well within 330 feet: yes no
 Municipal well within one mile: yes no

Well Drilled For: Well Class: Type Equipment:
 Oil Storage Infield Mud Rotary
 Gas Inj Pool Ext. Air Rotary
 OWWO Expl Wildcat Cable

Depth to bottom of fresh water 350'
 Depth to bottom of usable water 1800'
 Surface pipe by Alternate: 1 2
 Surface pipe planned to be set 750'
 Conductor pipe required ±300'
 Projected Total Depth 5400' feet
 Formation Mississippian

If OWWO: old well info as follows:
 Operator
 Well Name
 Comp Date Old Total Depth

I certify that well will comply with K.S.A. 55-101, et seq., plus eventually plugging hole to KCC specifications.
 Date 2-19-88 Signature of Operator or Agent Cory West Title Drilg. & Prod. Engineer

For KCC Use:
 Conductor Pipe Required feet; Minimum Surface Pipe Required 350 feet per Alt.
 This Authorization Expires 8-22-88 Approved By 2-22-88

EFFECTIVE DATE: 2-27-88

Must be filed with the K.C.C. five (5) days prior to commencing well
This card void if drilling not started within six (6) months of date received by K.C.C.

Important procedures to follow:

1. Notify District office before setting surface casing.
2. Set surface casing by circulating cement to the top.
3. File completion forms ACO-1 with K.C.C. within 120 days of well spud date, following instructions on ACO-1, side 1, and including copies of wireline logs.
4. Notify District office 48 hours prior to old well workover or re-entry.
5. Prior to filing Intent, prepare a proposed plugging plan in case well is D & A, then obtain approval of plan when calling district office prior to setting surface pipe.
6. Submit plugging report (CP-4) to K.C.C. after plugging is completed.
7. Obtain an approved injection docket number before disposing of salt water.
8. Notify K.C.C. within 10 days when injection commences or terminate.

A Regular Section of Land
1 Mile = 5,280 Ft.

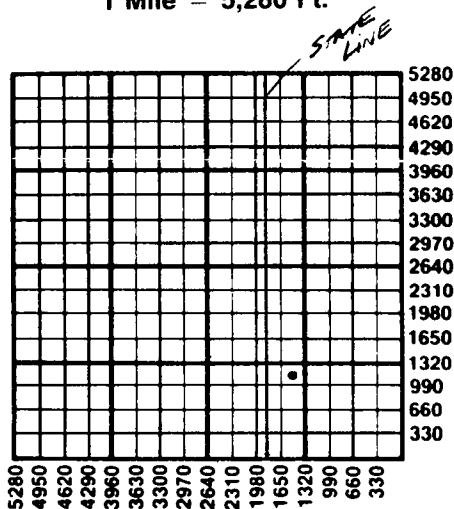

9. If an alternate 2 completion, cement in the production pipe from below any usable water to surface within 120 days of spud date.

FEB 22 1988
CONSERVATION DIVISION
Wichita, Kansas
02-22-88

State Corporation Commission of Kansas
Conservation Division
200 Colorado Derby Building
Wichita, Kansas 67202-1212
(316) 263-3238