

FOR KCC USE:

15-171-20211-00-01 "OWWO"

FORM C-1 7/91

EFFECTIVE DATE:

State of Kansas

FORM MUST BE TYPED

DISTRICT #

NOTICE OF INTENTION TO DRILL

FORM MUST BE SIGNED

SGA? Yes No

Must be approved by the K.C.C. five (5) days prior to commencing well

ALL BLANKS MUST BE FILLED

Expected Spud Date August 22 1994

Spot SE NE NE Sec 11 Twp 20 S, Rg 33 East West

OPERATOR: License # 5003 Name: McCoy Petroleum Corporation Address: 3017 N. Cypress City/State/Zip: Wichita, KS 67226-4003 Contact Person: Robert O'Dell Phone: (316) 636-2737

4290 feet from South / North line of Section 330 feet from East / West line of Section IS SECTION X REGULAR IRREGULAR?

CONTRACTOR: License #: 30606 Name: Murfin Drilling Co., Inc.

(NOTE: Locate well on the Section Plat on Reverse Side) County: Scott Lease Name: Wasinger "OWWO" Well #: 1-11 Field Name: Shallow Water NE

Well Drilled For: Oil Gas OWDG Seismic; # of Holes Other Well Class: Enh Rec Storage Disposal Pool Ext. Wildcat Other Type Equipment: Mud Rotary Air Rotary Cable

Is this a Prorated/Spaced Field? yes X no Target Formation(s): Morrow Nearest lease or unit boundary: 330' Ground Surface Elevation: 2946 feet MSL

If OWDG: old well information as follows: Operator: G.L. Morris Oil Corp. Well Name: #1 Wasinger Comp. Date: 7/4/81 Old Total Depth: 4654

Water well within one-quarter mile: yes X no Public water supply well within one mile: yes X no Depth to bottom of fresh water: 185' Depth to bottom of usable water: 1200'

Directional, Deviated or Horizontal wellbore? yes X no If yes, true vertical depth: Bottom Hole Location:

Surface Pipe by Alternate: 1 X 2 Length of Surface Pipe Planned to be set: 321' Length of Conductor pipe required: 0-

AFFIDAVIT

The undersigned hereby affirms that the drilling, completion and eventual plugging of this well will comply with K.S.A. 55-101, et. seq. It is agreed that the following minimum requirements will be met:

- 1. Notify the appropriate district office prior to spudding of well; 2. A copy of the approved notice of intent to drill shall be posted on each drilling rig; 3. The minimum amount of surface pipe as specified below shall be set by circulating cement to the top; in all cases surface pipe shall be set through all unconsolidated materials plus a minimum of 20 feet into the underlying formation; 4. If the well is dry hole, an agreement between the operator and the district office on plug length and placement is necessary prior to plugging; 5. The appropriate district office will be notified before well is either plugged or production casing is cemented in; 6. IF AN ALTERNATE II COMPLETION, PRODUCTION PIPE SHALL BE CEMENTED FROM BELOW ANY USABLE WATER TO SURFACE WITHIN 120 DAYS OF SPUD DATE. IN ALL CASES, NOTIFY DISTRICT OFFICE PRIOR TO ANY CEMENTING.

I hereby certify that the statements made herein are true and to the best of my knowledge and belief.

Date: 8-16-94 Signature of Operator or Agent: Robert E. O'Dell Title: Geologist

FOR KCC USE: API # 15- 171-20211-00-01 Conductor pipe required NONE feet Minimum surface pipe required 321' feet per Alt. X 2 Approved by: CB 8/17/94 This authorization expires: 2/17/95 (This authorization void if drilling not started within 6 months of effective date.) Spud date: Agent:

REMEMBER TO:

- File Drill Pit Application (form CDP-1) with Intent to Drill; - File Completion Form ACO-1 within 120 days of spud date; - File acreage attribution plat according to field proration orders; - Notify appropriate district office 48 hours prior to workover or re-entry; - Submit plugging report (CP-4) after plugging is completed; - Obtain written approval before disposing or injecting salt water.

Mail to: Conservation Division, 200 Colorado Derby Building, 202 W. First St., Wichita, Kansas 67202-1286.

Rec'd 8-16-94

11 20 33

**IN ALL CASES PLOT THE INTENDED WELL ON THE PLAT BELOW**

**PLAT OF ACREAGE ATTRIBUTABLE TO A WELL IN A PRORATED OR SPACED FIELD**

If the intended well is in a prorated or spaced field, please fully complete this side of the form. If the intended well is in a prorated or spaced field complete the plat below showing that the well will be properly located in relationship to other wells producing from the common source of supply. Please show all the wells within 1 mile of the boundaries of the proposed acreage attribution unit for gas wells and within 1/2 mile of the boundaries of the proposed acreage attribution unit for oil wells.

API NO. 15- \_\_\_\_\_  
 OPERATOR McCoy Petroleum Corporation  
 LEASE Wasinger "OWWO"  
 WELL NUMBER 1-11  
 FIELD Shallow Water NE

LOCATION OF WELL: COUNTY Scott  
 \_\_\_\_\_ feet from south/north line of section  
4290  
 \_\_\_\_\_ feet from east/west line of section  
330  
 SECTION 11 TWP 20S RG 33W

NUMBER OF ACRES ATTRIBUTABLE TO WELL 40  
 QTR/QTR/QTR OF ACREAGE \_\_\_\_\_ - NE - NE

IS SECTION X REGULAR or IRREGULAR  
**IF SECTION IS IRREGULAR, LOCATE WELL FROM NEAREST CORNER BOUNDARY.**

Section corner used: NE NW SE SW

**PLAT**

(Show location of the well and shade attributable acreage for prorated or spaced wells.)  
 (Show footage to the nearest lease or unit boundary line.)

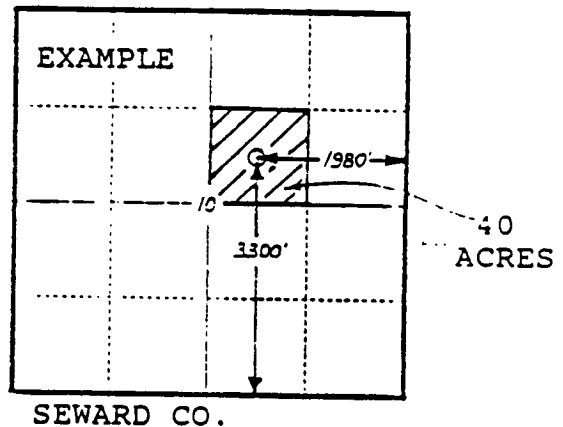
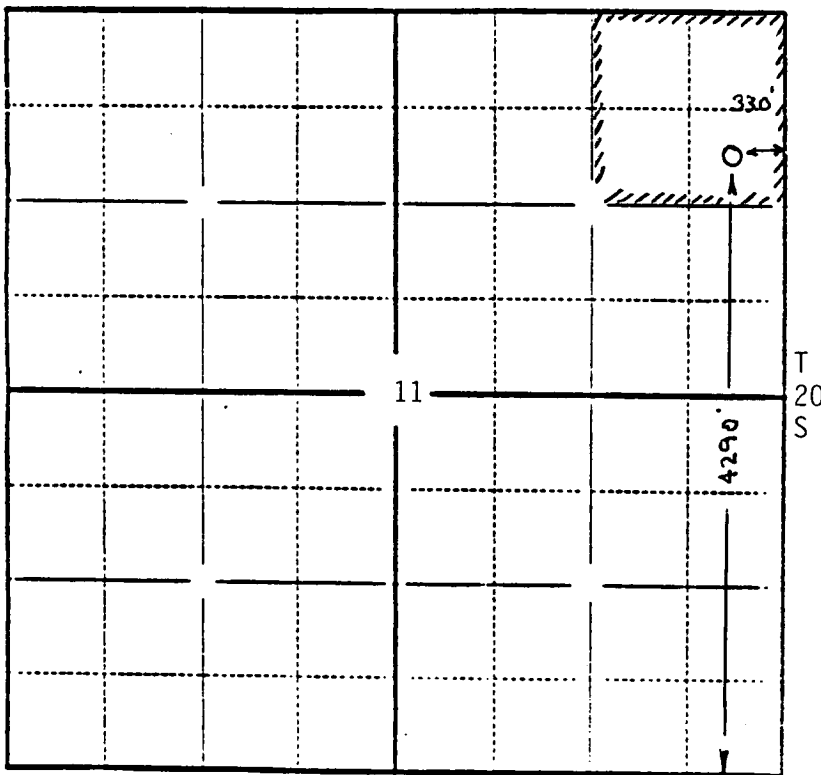

**RECEIVED**  
 KANSAS CORPORATION COMMISSION  
 AUG 16 1994 pm  
 CONSERVATION DIVISION  
 WICHITA, KS

In plotting the proposed location of the well, you must show:

- 1) The manner in which you are using the depicted plat by identifying section lines, i.e. 1 section, 1 section with 8 surrounding sections, 4 sections, etc.;
- 2) the distance of the proposed drilling location from the section's south/north and east/west lines; and
- 3) the distance to the nearest lease or unit boundary line.