

STATE OF KANSAS
 STATE CORPORATION COMMISSION
 200 Colorado Derby Building
 Wichita, Kansas 67202

WELL PLUGGING RECORD
 K.A.R.-82-3-117

API NUMBER 15199-20-133-00-00

LEASE NAME Purvis 34-17

WELL NUMBER #1

660 Ft. from S Section Line

1980 Ft. from E Section Line

SEC. 17 TWP. 14S RGE. 42 (W)

COUNTY Wallace

Date Well Completed 12-27-87

Plugging Commenced 12-28-87

Plugging Completed 12-29-87

TYPE OR PRINT
 NOTICE: Fill out completely
 and return to Cons. Div.
 office within 30 days.

LEASE OPERATOR Union Pacific Resources Company

ADDRESS P. O. Box 1257 Englewood, Colorado 80150

PHONE# (303) 721-2591 OPERATORS LICENSE NO. 6417

Character of Well D&A

(Oil, Gas, D&A, SWD, Input, Water Supply Well)

The plugging proposal was approved on 12-23-87 (date)

by Gilbert Baltzore (KCC District Agent's Name).

Is ACO-1 filed? Yes If not, is well log attached? _____

Objective

~~Production~~ Formation Morrow Sand Depth to Top 5084' Bottom 5094' T.D. 5320'

Show depth and thickness of all water, oil and gas formations.

OIL, GAS OR WATER RECORDS

CASING RECORD

Formation	Content	From	To	Size	Put In	Pulled out
Shawnee	Porous	3990'	4002'	8-5/8	698'	-0-

Describe in detail the manner in which the well was plugged, indicating where the mud fluid was placed and the method or methods used in introducing it into the hole. If cement or other plugs were used, state the character of same and depth placed, from feet to feet each set.
 Plug #1 - 2940' - 2830' - 25 sxs. 60-40 POZ w/6% gel. Plug #2 - 1960' - 1560' 100 sxs. same slurry mix. Plug #3 - 730' - 630' 0 40 sxs. Plug #4 - 40' - 0' - 10 sxs. 15 sxs. in rathole. 10 sxs. in mousehole. Cut casing 4' below ground level. Welded on plate.

(If additional description is necessary, use BACK of this form.)

Name of Plugging Contractor Haliburton Services License No. _____

Address Colorado Derby Boulding - Suite 600 Wichita, Kansas 67202-1203

STATE OF Colorado COUNTY OF Arapahoe, ss.

Joy L. Daniel

(Employee of Operator) or (Operator) of

above-described well, being first duly sworn on oath, says: That I have knowledge of the facts, statements, and matters herein contained and the log of the above-described well as filed that the same are true and correct, so help me God.

UNION PACIFIC RESOURCES COMPANY

(Signature) Joy L. Daniel

(Address) P.O. Box 1257 Englewood, CO 80150

SUBSCRIBED AND SWORN TO before me this 10th day of February, 19 88

Mary A. Bergman
 Notary Public

My Commission Expires: 8-5-90



Holloway & Holloway, Inc.
 4218 W. 14th St. Lane
 Greeley, CO 80634
 (303) 867-3715
 (303) 353-9747

15-199-20133-00-00

R. 42W

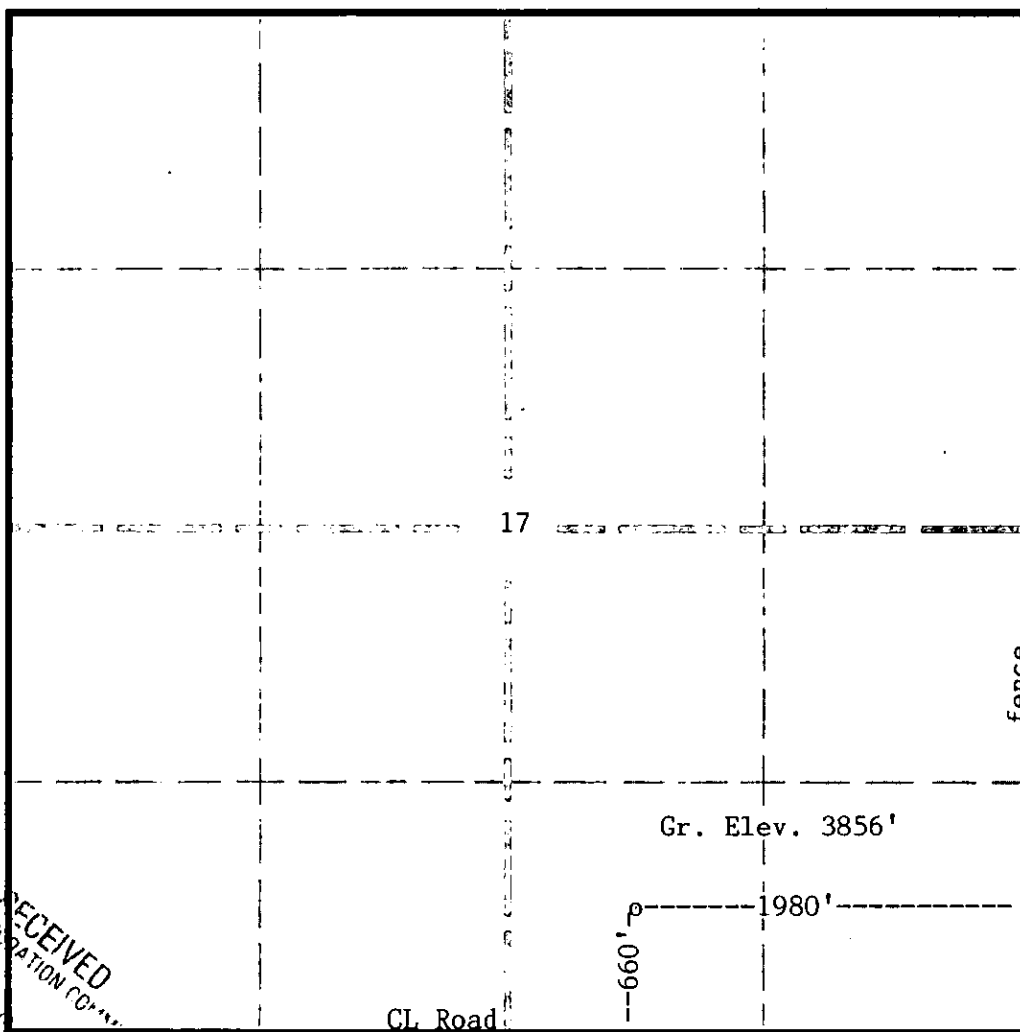

T.
14
S

RECEIVED
 STATE CORPORATION COMMISSION
 DEC 10 1987
 CONSERVATION DIVISION
 Wichita, Kansas

15-199-20133

Scale --- 1" = 1000'

In accordance with a request from Union Pacific Resources Company
 the Undersigned has determined the location of the No.1 Purvis 34-17 well
 to be 660'FSL & 1980'FEL as co-ordinates
 Section 17 Township 14S Range 42W of the 6th principal Meridian
 Wallace County, ~~Colorado~~ Kansas

I hereby certify,
 that this oil and/or gas well location certificate was prepared for Union Pacific Resources Company
 that it is not a land survey plat or improvement survey plat, and that it is not to be relied upon for the
 establishment of fence, building or other future improvement lines.

Date 11-24-87

Holloway & Holloway, Inc.
 States of
 Colorado, Nebraska, Wyoming