

4 P

**\* AMENDED**  
STATE CORPORATION COMMISSION OF KANSAS  
OIL & GAS CONSERVATION DIVISION

WELL COMPLETION OR RECOMPLETION FORM  
ACO-1 WELL HISTORY

DESCRIPTION OF WELL AND LEASE

Operator: License # 8458  
Name Trans-Western Operating Co.  
Address Box 276  
Golden, Colorado 80402  
City/State/Zip

Purchaser Permian Corp.  
5800 E. Shell, Tulsa, OK 74135

Operator Contact Person D. J. Isern  
Phone 303-279-2995

Contractor: License # 6033  
Name Murfin Drilling

Wellsite Geologist Russel Bak  
Phone 303-457-0042

Designate Type of Completion  
 New Well  Re-Entry  Workover  
 Oil  SWD  Temp Abd  
 Gas  Inj  Delayed Comp  
 Dry  Other (Core, Water Supply etc.)

If OWWO: old well info as follows:  
Operator  
Well Name  
Comp. Date Old Total Depth

WELL HISTORY

Drilling Method:  
 Mud Rotary  Air Rotary  Cable  
3-11-88 3-18-88 4-5-88  
Spud Date Date Reached TD Completion Date  
5,300 5,232  
Total Depth PBTD

Amount of Surface Pipe Set and Cemented at 430' w/250SX feet  
Multiple Stage Cementing Collar Used?  Yes  No  
If yes, show depth set 1,943 feet  
If alternate 2 completion, cement circulated from 1,943 feet depth to surf w/250 SX cmt  
7-25-88

API NO. 15-199,20147-00-00

County Wallace  
Lot 3  
S/2 Partial Sec 24 Twp 15S Rge 42 East West

1,780 Ft North from Southeast Corner of Section  
460 Ft West from Southeast Corner of Section  
(Note: Locate well in section plat below)

Lease Name White Well # 1-24

Field Name Stockholm South

Producing Formation Morrow

Elevation: Ground 3,928 KB 3,933

Section Plat

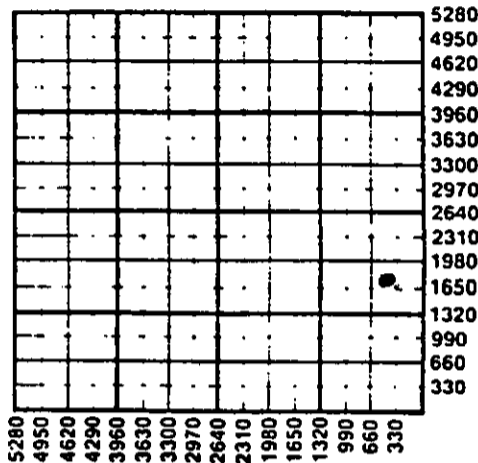

WATER SUPPLY INFORMATION

Disposition of Produced Water:  Disposal  Repressuring  
Docket #

Questions on this portion of the ACO-1 call:  
Water Resources Board (913) 296-3717

Source of Water:  
Division of Water Resources Permit #  
 Groundwater (Well) Ft North from Southeast Corner of Section Twp Rge East West  
 Surface Water (Stream, pond etc) Ft North from Southeast Corner of Section Twp Rge East West  
 Other (explain) B. Palen, Arapahoe Co. (purchased from city, R.W.D. #)

INSTRUCTIONS: This form shall be completed in duplicate and filed with the Kansas Corporation Commission, 200 Colorado Derby Building, Wichita, Kansas 67202, within 90 days after completion or recompletion of any well. Rule 82-3-130 and 82-3-107 apply. Information on side two of this form will be held confidential for a period of 12 months if requested in writing and submitted with the form. See rule 82-3-107 for confidentiality in excess of 12 months. One copy of all wireline logs and drillers time log shall be attached with this form. Submit CP-4 form with all plugged wells. Submit CP-111 form with all temporarily abandoned wells.

All requirements of the statutes, rules and regulations promulgated to regulate the oil and gas industry have been fully complied with and the statements herein are complete and correct to the best of my knowledge.

Signature H. Wayne Stack  
Title Consultant Date 6-2-88

Subscribed and sworn to before me this 3rd day of June 1988  
Notary Public Kathleen H. Koch  
Date Commission Expires October 25, 1990

K.C.C. OFFICE USE ONLY  
 Letter of Confidentiality Attached  
 Wireline Log Received  
 Drillers Timelog Received  
Distribution  
 KCC  SWD/Rep  NGPA  
 KGS  Plug  Other (Specify)  
6-24-88

15-199-20147-00-00

PLAT AND CERTIFICATION OF ACREAGE ATTRIBUTABLE TO AN OIL WELL

State Corporation Commission, Conservation Division  
200 Colorado Derby Bldg. Wichita, Kansas 67202

OPERATOR Trans-Western Operating CO.

LOCATION OF WELL:

LEASE White

1,780' feet from the S line

460 feet from the E line

WELL NUMBER 1-24

Of the Lot 3 of Sec24 T.15S R.43W

FIELD Stockholm

COUNTY Wallace

\*NUMBER OF ACRES  
ATTRIBUTABLE TO WELL 40

DESCRIPTION OF ACREAGE:  
Lot 3 of Section 24,  
T15S, R43W

PLAT

(Show location of Well and outline attributable acreage)  
(Show footage to nearest lease or unit boundry line)

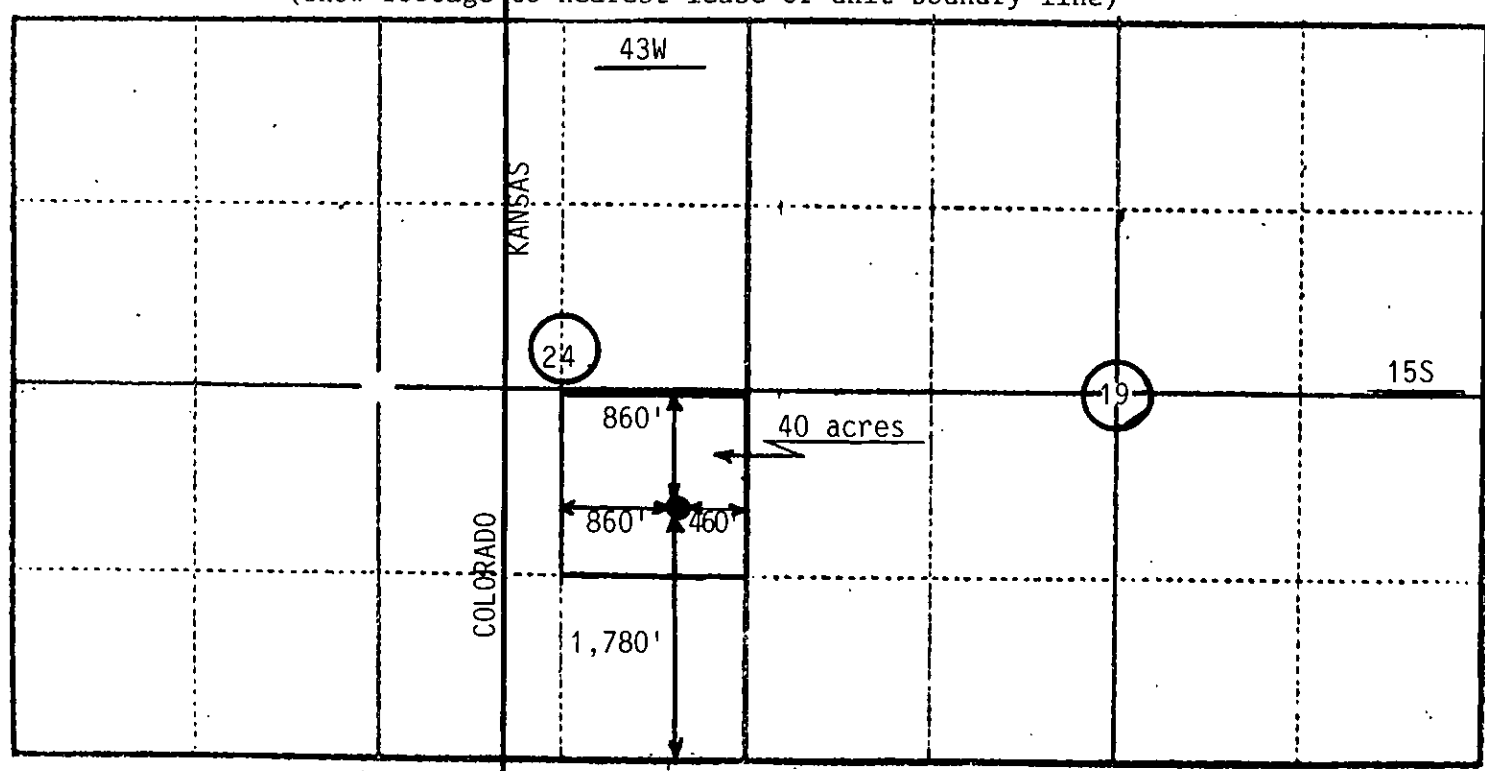

**RECEIVED**  
STATE CORPORATION COMMISSION  
NOV 15 1988  
CONSERVATION DIVISION  
Wichita, Kansas

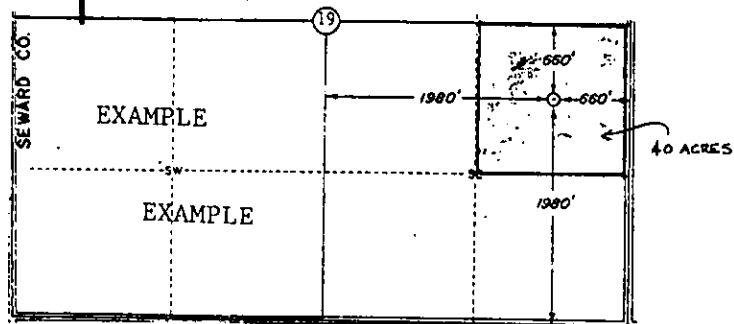

The undersigned hereby certifies that he is consultant  
for Trans-Western Operating Company, a duly authorized agent, that all information  
shown hereon is true and correct to the best of his knowledge and belief, and that  
all acreage claimed as attributable to the well named herein is held by production  
from that well.

*H Wayne Stack*

Suscribed and sworn to before me on this 21st day of November, 1988.

*Bathlem H. Reeb*  
Notary Public

My Commission expires October 25, 1990