

15-071-20122-00-00

STATE OF KANSAS
STATE CORPORATION COMMISSION

WELL PLUGGING RECORD

Give All Information Completely
Make Required Affidavit
Mail or Deliver Report to
Conservation Division
State Corporation Comm.
245 North Water
Wichita, KS 67202

Greeley County. Sec. 8 Twp. 17 Rge. 39 E/W
Location as "NE/CNW $\frac{1}{4}$ SW $\frac{1}{4}$ " or footage from lines
C NW 1/4

Lease Owner Dorchester Exploration Inc.
Lease Name University Well No. 1
Office Address 1204 Vaughn Bldg., Midland, Texas
Character of Well (Completed as Oil, Gas or Dry Hole)

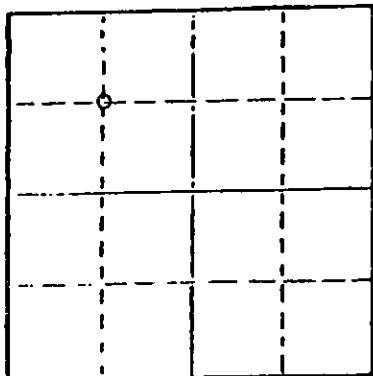

Locate well correctly on above Section Plat

Gas D&A
Date Well completed _____ 19____
Application for plugging filed _____ 19____
Application for plugging approved 1-29-1977 19____
Plugging commenced 1-29-1977 19____
Plugging completed 1-31-1977 19____
Reason for abandonment of well or producing formation
Non Commercial Value
If a producing well is abandoned, date of last production
None 19____

Was permission obtained from the Conservation Division or its agents before plugging was commenced? Yes

Name of Conservation Agent who supervised plugging of this well Mr. Balthazor
Producing formation Hugoton Depth to top 2919' Bottom 2959' Total Depth of Well 3060'
Show depth and thickness of all water, oil and gas formations.

OIL, GAS OR WATER RECORDS

CASING RECORD

FORMATION	CONTENT	FROM	TO	SIZE	PUT IN	PULLED OUT
Surface		0'	282'	8 5/8"	282'	0'
Production		0'	3049'	4 1/2"	3049'	30'

Describe in detail the manner in which the well was plugged, indicating where the mud fluid was placed and the method or methods used in introducing it into the hold. If cement or other plugs were used, state the character of same and depth placed, from _____ feet to _____ feet for each plug set.

Pumped 1 sack of hulls & 10 sacks cement to 2815'
Displaced w/ mud 2815' to 1000'
Pumped 10 sacks cement 1000' to 920'
Displaced w/ mud 920' to 280'
Pumped 10 sacks cement 280' to 160' Pressured to 700 lbs. 02-24-77
Displaced w/ mud 160' to 30'
Backed off 1 joint of 4 1/2" casing
Put bridge & 10 sacks cement 30' to 0'

(If additional description is necessary, use BACK of this sheet)

Name of Plugging Contractor Midwest Casing Pulling
Box F, Sublette, Kansas 67877 Kans. Permit # 766

STATE OF KANSAS COUNTY OF Haskell, ss.
I Edgear J. Eves (employee of owner) or (owner or operator)
of the above-described well, being first duly sworn on oath, says: That I have knowledge of the facts, statements, and matters herein contained and the log of the above-described well as filed and that the same are true and correct. So help me God.

(Signature) Edgear J. Eves
Box F, Sublette, Kansas 67877
(Address)

SUBSCRIBED AND SWORN TO before me this 3rd day of February, 1977

Leandra L. Eves
Notary Public.

My commission expires 12-6-1980



KANSAS DRILLERS LOG

S. 8 T. 17 R. 39 ^E/_W

API No. 15 — 071 — 20,122-00-00
 County Number

Loc. C NW

County Greeley

Operator
 Dorchester Exploration, Inc.

Address
 1100 Midland National Bank Tower, Midland, Texas 79701

Well No. 1 Lease Name University

Footage Location
 1320 feet from (N) (M) line 1320 feet from (E) (W) line

Principal Contractor DNB Drilling Co. Geologist R. L. Higginbottom

Spud Date 11-18-76 Total Depth 3060 P.B.T.D. 3049

Date Completed Oil Purchaser

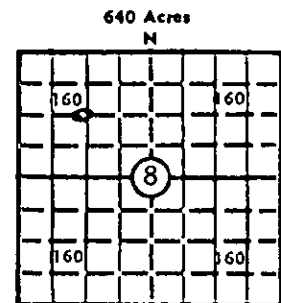

Locate well correctly
 Elev.: Gr. 3557
 DF _____ KB _____

CASING RECORD

Report of all strings set— surface, intermediate, production, etc.

Purpose of string	Size hole drilled	Size casing set (in O.D.)	Weight lbs/ft.	Setting depth	Type cement	Sacks	Type and percent additives
Surface	12 1/4"	8 5/8"	32	282	C1 "H"	250	3% CaCl
Production	7 7/8"	4 1/2"	10.5	3049	C1 "H"	350	4 1/2% Gel
					Poz-mix	150	10% Salt

LINER RECORD

PERFORATION RECORD

Top, ft.	Bottom, ft.	Sacks cement	Shots per ft.	Size & type	Depth interval
TUBING RECORD			9 holes total		2951-2959
			10 holes total		2919-2928
Size	Setting depth	Packer set at			

ACID, FRACTURE, SHOT, CEMENT, EXPLOSION RECORD

Amount and kind of material used	Depth interval treated
Acid 1000 gals 15%	2951-2959
Acid 1000 gals 15%	2919-2928
Frac 23,520 gals gel water, 13,500# 20-40 sand	2951-2959 2919-2928

INITIAL PRODUCTION

Date of first production	Producing method (flowing, pumping, gas lift, etc.)			
RATE OF PRODUCTION PER 24 HOURS	Oil	Gas	Water	Gas-oil ratio
	bbls.	MCF	bbls.	CFPB
Disposition of gas (vented, used on lease or sold)			Producing interval(s)	

INSTRUCTIONS: As provided in KCC Rule 82-2-125, within 90 days after completion of a well, one completed copy of this Drillers Log shall be transmitted to the State Geological Survey of Kansas, 4150 Monroe Street, Wichita, Kansas 67209. Copies of this form are available from the Conservation Division, State Corporation Commission, 3830 So. Meridian (P.O. Box 17027), Wichita, Kansas 66217. Phone AC 316-522-2206. If confidential custody is desired, please note Rule 82-2-125. Drillers Logs will be on open file in the Oil and Gas Division, State Geological Survey of Kansas, Lawrence, Kansas 66044.

Operator **Dorchester Exploration, Inc.** DESIGNATE TYPE OF COMP.: OIL, GAS, DRY HOLE, SWDW, ETC.:

Well No. **1** Lease Name **University** Dry Hole

s **8** T **17-SR 39** W

WELL LOG

Show all important zones of porosity and contents thereof; cored intervals, and all drill-stem tests, including depth interval tested, cushion used, time tool open, flowing and shut-in pressures, and recoveries.

SHOW GEOLOGICAL MARKERS, LOGS RUN, OR OTHER DESCRIPTIVE INFORMATION.

FORMATION DESCRIPTION, CONTENTS, ETC.	TOP	BOTTOM	NAME	DEPTH
Clay & Sand	0	282	Base Stone Corral	2594
Shale & Shells	282	1510		
Shale	1510	1925	L. Winfield	2919
Shale & Lime	1925	2838	Ft. Riley	2949
Lime & Shale	2838	3060		

Welex Compensated Acoustic Velocity Log

USE ADDITIONAL SHEETS, IF NECESSARY, TO COMPLETE WELL RECORD.

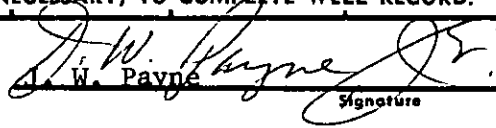
Date Received	 J. W. Payne Signature
	Manager of Operations Title
	12-21-76 Date