

FOR KCC USE:

EFFECTIVE DATE: 5-9-98

DISTRICT #
SEAT... Year... No

State of Kansas

NOTICE OF INTENTION TO DRILL

Must be approved by the K.C.C. five (5) days prior to commencing well

15-071-20689-0000

FORM C-1 7/91
FORM MUST BE TYPED
FORM MUST BE SIGNED
ALL BLANKS MUST BE FILLED

Expected Spud Date: May 5, 1998
month day year

Spot
Q.S./2 SE-SE. Sec 20. Twp 16. S. Rg 42. East
West

OPERATOR: License # 3581
Name: Red Oak Energy, Inc.
Address: 7701 E. Kellton, #710
City/State/Zip: Wichita, KS 67207
Contact Person: Kevin C. Davis
Phone: (316) 652-7373

330 feet from South / North line of Section
660 feet from East / West line of Section
IS SECTION X REGULAR IRREGULAR

(NOTE: Locate well on the Section Plat on Reverse Side)

CONTRACTOR: License #: 30606
Name: Murfin Drilling Co.

County: Greeley
Lessee Name: Mai Trust Well #: 1-20
Field Name: Wildcat

Is this a Prorated/Spaced Field? yes X no

Target Formation(s): Morrow - Miss

Nearest lease or unit boundary: 330'

Ground Surface Elevation: 3838 est. feet MSL

Water well within one-quarter mile: yes X no

Public water supply well within one mile: yes X no

Depth to bottom of fresh water: 280'

Depth to bottom of usable water: 1840'

Surface Pipe by Alternate: 1 X 2

Length of Surface Pipe Planned to be set: 330'

Length of Conductor pipe required: N/A

Projected Total Depth: 5300'

Formation at Total Depth: Mississippian

Water Source for Drilling Operations:

well farm pond X other

DWR Permit #:

Will Cores Be Taken? yes no

If yes, proposed zone:

Well Drilled For: Well Class: Type Equipment:

X Oil ... Enh Rec ... Infield X Mud Rotary
... Gas ... Storage ... Pool Ext. ... Air Rotary
... OWD ... Disposal X Wildcat ... Cable
... Seismic; ... # of Holes ... Other
... Other

If OWD: old well information as follows:
Operator:
Well Name:
Comp. Date: Old Total Depth

Directional, Deviated or Horizontal wellbore? yes X no

If yes, true vertical depth:

Bottom Hole Location:

AFFIDAVIT

The undersigned hereby affirms that the drilling, completion and eventual plugging of this well will comply with K.S.A. 55-101, et. seq.

It is agreed that the following minimum requirements will be met:

1. Notify the appropriate district office prior to spudding of well;
2. A copy of the approved notice of intent to drill shall be posted on each drilling rig;
3. The minimum amount of surface pipe as specified below shall be set by circulating cement to the top; in all cases surface pipe shall be set through all unconsolidated materials plus a minimum of 20 feet into the underlying formation;
4. If the well is dry hole, an agreement between the operator and the district office on plug length and placement is necessary prior to plugging;
5. The appropriate district office will be notified before well is either plugged or production casing is cemented in;
6. IF AN ALTERNATE II COMPLETION, PRODUCTION PIPE SHALL BE CEMENTED FROM BELOW ANY USABLE WATER TO SURFACE WITHIN 120 DAYS OF SPUD DATE. IN ALL CASES, NOTIFY DISTRICT OFFICE PRIOR TO ANY CEMENTING.

I hereby certify that the statements made herein are true and to the best of my knowledge and belief.
Date: 5/1/98 Signature of Operator or Agent: Kevin C. Davis Title: President

FOR KCC USE:
 API # 15- 071-20689-0000
 Conductor pipe required NONE feet
 Minimum surface pipe required 300 feet per Alt. X(2)
 Approved by: JK 5-4-98
 This authorization expires: 10-4-98
 (This authorization void if drilling not started within 6 months of effective date.)
 Spud date: Agent:

REMEMBER TO:

- File Drill Pit Application (form CDP-1) with Intent to Drill;
- File Completion Form ACD-1 within 120 days of spud date;
- File acreage attribution plat according to field proration orders;
- Notify appropriate district office 48 hours prior to workover or re-entry;
- Submit plugging report (CP-4) after plugging is completed;
- Obtain written approval before disposing or injecting salt water.

Mail to: Conservation Division, 208 Colorado Derby Building, 202 W. First St., Wichita, Kansas 67202-1286.

05-04-98

20
16
12M

IN ALL CASES PLOT THE INTENDED WELL ON THE PLAT BELOW
PLAT OF ACREAGE ATTRIBUTABLE TO A WELL IN A PRORATED OR SPACED FIELD

If the intended well is in a prorated or spaced field, please fully complete this side of the form. If the intended well is in a prorated or spaced field complete the plat below showing that the well will be properly located in relationship to other wells producing from the common source of supply. Please show all the wells within 1 mile of the boundaries of the proposed acreage attribution unit for gas wells and within 1/2 mile of the boundaries of the proposed acreage attribution unit for oil wells.

API NO. 15- _____
 OPERATOR Red Oak Energy, Inc.
 LEASE Mai Trust
 WELL NUMBER 1-20
 FIELD Wildcat

LOCATION OF WELL: COUNTY Greeley
 330 feet from south north line of section
 660 feet from east west line of section
 SECTION 20 TWP 16 RG 42

NUMBER OF ACRES ATTRIBUTABLE TO WELL _____
 QTR/QTR/QTR OF ACREAGE _____

IS SECTION X REGULAR or _____ IRREGULAR
IF SECTION IS IRREGULAR, LOCATE WELL FROM NEAREST CORNER BOUNDARY.

Section corner used: _____ NE _____ NW _____ SE _____ SW

PLAT
 (Show location of the well and shade attributable acreage for prorated or spaced wells.)
 (Show footage to the nearest lease or unit boundary line.)

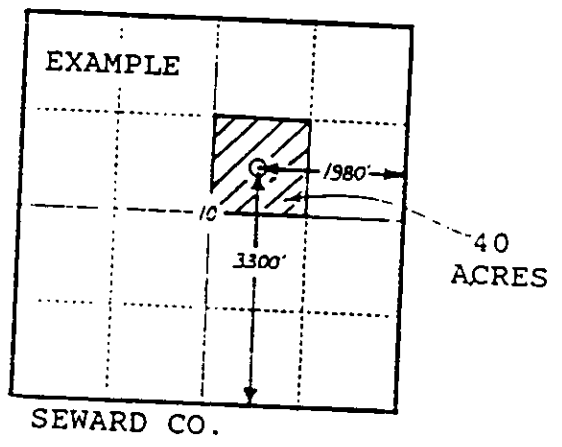
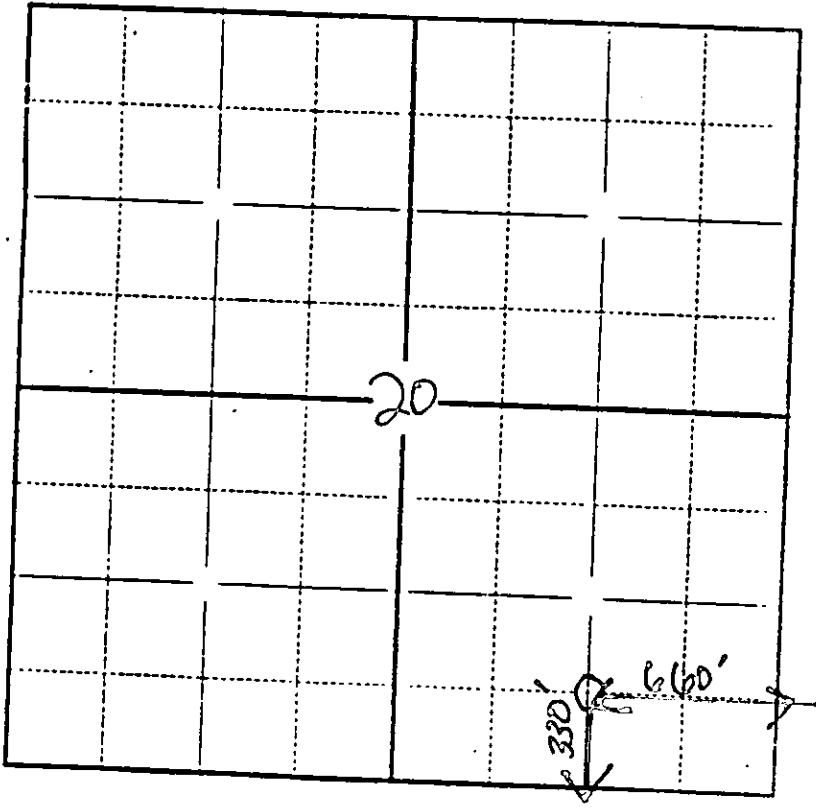

In plotting the proposed location of the well, you must show:

- 1) The manner in which you are using the depicted plat by identifying section lines, i.e. 1 section, 1 section with 8 surrounding sections, 4 sections, etc.;
- 2) the distance of the proposed drilling location from the section's south/north and east/west lines; and
- 3) the distance to the nearest lease or unit boundary line.