

STATE CORPORATION COMMISSION OF KANSAS
OIL & GAS CONSERVATION DIVISION
WELL COMPLETION OR RECOMPLETION FORM
ACO-1 WELL HISTORY -
DESCRIPTION OF WELL AND LEASE

Operator: License # 4728
Name ..Earth Minerals Search, Inc.
Address ..P.O. Box 441023
.....Houston, TX
City/State/Zip77244

Purchaser.....

Operator Contact Person Carl S. Graef
Phone ..713 589-9283

Contractor: License # 5382
Name ..Cheyenne Drilling

Wellsite Geologist.....Carl S. Graef.....
Phone..713 589-9283

Designate Type of Completion
___ New Well ___ Re-Entry ___ Workover
___ Oil ___ SWD ___ Temp Abd
___ Gas ___ Inj ___ Delayed Comp.
 Dry ___ Other (Core, Water Supply etc.)

If OMWO: old well info as follows:
Operator ..
Well Name ..
Comp. DateOld Total Depth.....

WELL HISTORY

Drilling Method:
 Mud Rotary ___ Air Rotary ___ Cable
12/26/85 12/30/85 1/26/86
Spud Date Date Reached TD Completion Date
2954
Total Depth PBTD

Amount of Surface Pipe Set and Cemented at 292 feet
Multiple Stage Cementing Collar Used? ___ Yes No
If yes, show depth set.....feet
If alternate 2 completion, cement circulated
from 0 feet depth to 292 w/ 225X cmt
Cement Company Name Halliburton
Invoice # 152922

API NO. 15-071-20,416-0000
County Greeley
SW ..SW ..SW Sec. 19. Twp. 19. Rge. 39. East
 West
330 Ft North from Southeast Corner of Section
4950 Ft West from Southeast Corner of Section
(Note: Locate well in section plat below)

Lease Name Abbott Well # 1
Field Name Bradshaw
Producing Formation.....
Elevation: Ground 3555 KB 3564

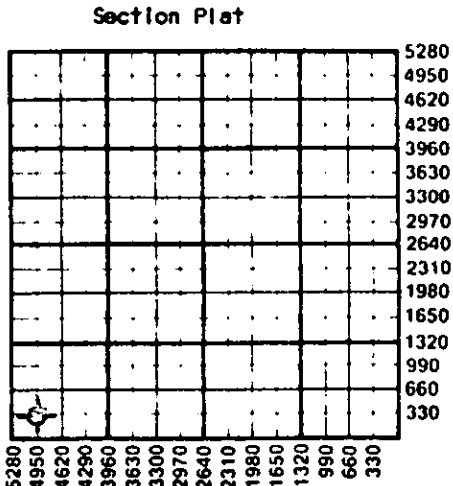

WATER SUPPLY INFORMATION
Disposition of Produced Water: ___ Disposal
Docket # ___ Repressuring

Questions on this portion of the ACO-1 call:
Water Resources Board (913) 296-3717
Source of Water:
Division of Water Resources Permit #.....
___ Groundwater.....Ft North from Southeast Corner
(Well)Ft West from Southeast Corner of
Sec Twp Rge ___ East ___ West
___ Surface Water.....Ft North from Southeast Corner
(Stream, pond etc).....Ft West from Southeast Corner
Sec Twp Rge ___ East ___ West
 Other (explain) DAVE CO
(purchased from city, R.W.D. #)

INSTRUCTIONS: This form shall be completed in duplicate and filed with the Kansas Corporation Commission, 200 Colorado Derby Building, Wichita, Kansas 67202, within 90 days after completion or recompletion of any well. Rule 82-3-130 and 82-3-107 apply.
Information on side two of this form will be held confidential for a period of 12 months if requested in writing and submitted with the form. See rule 82-3-107 for confidentiality in excess of 12 months.
One copy of all wireline logs and drillers time log shall be attached with this form. Submit CP-4 form with all plugged wells. Submit CP-111 form with all temporarily abandoned wells.

All requirements of the statutes, rules and regulations promulgated to regulate the oil and gas industry have been fully complied with and the statements herein are complete and correct to the best of my knowledge.

Signature [Signature]
Title Vice President Date 02-28-86

Subscribed and sworn to before me this 28th day of February, 1986.
Notary Public Ann L. Galloway
Date Commission Expires 11-02-89
Notary Public in and for the State of Texas

K.C.C. OFFICE USE ONLY
F Letter of Confidentiality Attached
C Wireline Log Received
C Drillers Time Log Received
Distribution
 KCC ___ SWD/Rep ___ NGPA
 KGS ___ Plug ___ Other
(Specify)

RECEIVED STATE CORPORATION COMMISSION ACO-1 (7-84)

MAR 3 1986

CONSERVATION DIVISION
Wichita, Kansas

My Commission Expires: 11-02-89

Sec. 19 Twp. 19 Rge. 39

Operator Name Earht Minerals Search, Inc. Lease Name Abbott Well # 1

Sec. 19 Twp. 19 Rge. 39 East West County Greeley

WELL LOG

INSTRUCTIONS: Show important tops and base of formations penetrated. Detail all cores. Report all drill stem tests giving interval tested, time tool open and closed, flowing and shut-in pressures, whether shut-in pressure reached static level, hydrostatic pressures, bottom hole temperature, fluid recovery, and flow rates if gas to surface during test. Attach extra sheet if more space is needed. Attach copy of log.

Drill Stem Tests Taken Yes No
 Samples Sent to Geological Survey Yes No
 Cores Taken Yes No

Formation Description
 Log Sample

Name	Top	Bottom
Upper Winfield	2844	2868

CASING RECORD <input checked="" type="checkbox"/> New <input type="checkbox"/> Used							
Report all strings set-conductor, surface, intermediate, production, etc.							
Purpose of String	Size Hole Drilled	Size Casing Set (In O.D.)	Weight Lbs/Ft.	Setting Depth	Type of Cement	#Sacks Used	Type and Percent Additives
Surface	12 1/4	8 7/8	23	293	class H	225	3% cacl, 2% gel
Production	7 7/8	4 1/2	10.5	2954	class G	550	1/4# floccul, 75% gel, 10% salt
PERFORATION RECORD				Acid, Fracture, Shot, Cement Squeeze Record			
Shots Per Foot	Specify Footage of Each Interval Perforated			(Amount and Kind of Material Used)		Depth	
2	2847-2861			750 gal 15% FE acid, 18000 gal KCl gel w/ 16000# 0-40sd, 4000# 10-20 sd			
TUBING RECORD				Liner Run <input type="checkbox"/> Yes <input checked="" type="checkbox"/> No			
Date of First Production	Producing Method <input type="checkbox"/> Flowing <input type="checkbox"/> Pumping <input type="checkbox"/> Gas Lift <input type="checkbox"/> Other (explain).....						
Estimated Production Per 24 Hours	Oil Bbls	Gas MCF	Water Bbls	Gas-Oil Ratio	Gravity		

METHOD OF COMPLETION

Disposition of gas: Vented Open Hole Perforation
 Sold Other (Specify)
 Used on Lease Dually Completed Conmingle