

OK 50

For KCC Use: 11-22-2011
Effective Date: 11-22-2011
District # 1
SGA? ☐ Yes ☒ No

KANSAS CORPORATION COMMISSION
OIL & GAS CONSERVATION DIVISION

Form CB-1
March 2010

Form must be Typed
Form must be Signed
All blanks must be Filled

CATHODIC PROTECTION BOREHOLE INTENT

Must be approved by the KCC sixty (60) days prior to commencing well.

Form KSONA-1, Certification of Compliance with the Kansas Surface Owner Notification Act, MUST be submitted with this form.

Expected Spud Date: DECEMBER 1, 2011
month day year

OPERATOR: License# 33851
Name: ONEOK PARTNERS Field Services, LLC
Address 1: 1407 E OKLAHOMA
Address 2: _____
City: ULYSSES State: KS Zip: 67880 + _____
Contact Person: ROGER JONES
Phone: 620-424-1549

CONTRACTOR: License# 32775
Name: MCLEAN'S CP INSTALLATION, INC
Type Drilling Equipment: ☒ Mud Rotary ☐ Cable
☐ Air Rotary ☐ Other

Construction Features

Length of Cathodic Surface (Non-Metallic) Casing
Planned to be set: 20 feet
Length of Conductor pipe (if any): _____ feet
Surface casing borehole size: 17 1/2"-20", 10"-230" inches
Cathodic surface casing size: 10" inches
Cathodic surface casing centralizers set at depths of: 20'; _____;
_____; _____; _____; _____; _____;
Cathodic surface casing will terminate at:
☐ Above surface ☐ Surface Vault ☒ Below Surface Vault
Pitless casing adaptor will be used: ☐ Yes ☒ No Depth _____ feet
Anode installation depths are: 240'; 230'; 220'; 210'; 200'
190'; 180'; 170'; 160'; 150'; _____; _____;

AFFIDAVIT

The undersigned hereby affirms that the drilling, completion and eventual plugging of this well will comply with K.S.A. 55-101 et. seq.

It is agreed that the following minimum requirements will be met:

1. Notify the appropriate District office prior to spudding and again before plugging the well. An agreement between the operator and the District Office on plugging and placement is necessary prior to plugging. In all cases, notify District Office prior to any grouting.
2. Notify appropriate District Office 48 hours prior to workover or re-entry.
3. A copy of the approved notice of intent to drill shall be posted on each drilling rig.
4. The minimum amount of cathodic surface casing as specified below shall be set by grouting to the top when the cathodic surface casing is set.
5. File all required forms: a. File Drill Pit Application (form CDP-1) with Intent to Drill (form CB-1). b. File Certification of Compliance with Kansas Surface Owner Notification Act (form KSONA-1) with Cathodic Protection Borehole Intent (CB-1) c. File Completion Form (ACO-1) within 30 days from spud date. d. Submit plugging report (CP-4) within 30 days after final plugging is completed.

I hereby certify that the statements made herein are true and to the best of my knowledge and belief.

Date: 11/8/11 Signature of Operator or Agent: [Signature] Title: OPERATIONS MANAGER

For KCC Use ONLY
API # 15 - 093-21872-00-00
Conductor pipe required None feet
Minimum Cathodic Surface Casing Required: 20 feet A1+3
Approved by: [Signature] 11-17-2011
This authorization expires: 11-17-2012
(This authorization void if drilling not started within 12 months of approval date.)
Spud date: _____ Agent: _____

Spot Description: NW SW NW
NW SW SW NW Sec. 24 Twp. 22 S. R. 36 ☐ E ☒ W
(1000/10) 2,029 feet from ☒ N / ☐ S Line of Section
50 feet from ☐ E / ☒ W Line of Section

Is SECTION: ☒ Regular ☐ Irregular?
(Check directions from nearest outside corner boundaries)

County: KEARNY
Facility Name: GRAY
Borehole Number: 01
Ground Surface Elevation: 3140' MSL
Cathodic Borehole Total Depth: 250' feet
Depth to Bedrock: 140' feet

Water Information

Aquifer Penetration: ☐ None ☒ Single ☐ Multiple
Depth to bottom of fresh water: 140'
Depth to bottom of usable water: 820'
Water well within one-quarter mile: ☐ Yes ☒ No
Public water supply well within one mile: ☐ Yes ☒ No
Water Source for Drilling Operations:
☐ Well ☐ Farm Pond ☐ Stream ☒ Other
Water Well Location: _____
DWR Permit # Apply if needed
Standard Dimension Ratio (SDR) is = 26
(Cathodic surface csg. O.D. in inches / MWT in inches = SDR)
Annular space between borehole and casing will be grouted with:
☐ Concrete ☐ Neat Cement ☐ Bentonite Cement ☒ Bentonite Clay
Anode vent pipe will be set at: 4 feet above surface
Anode conductor (backfill) material TYPE: CARBO 60
Depth of BASE of Backfill installation material: 250'
Depth of TOP of Backfill installation material: 100'
Borehole will be Pre-Plugged? ☐ Yes ☒ No

* Max TD = 250'

RECEIVED

NOV 14 2011

KCC WICHITA

If this permit has expired or will not be drilled, check a box below, sign, date and return to the address below.

☐ Permit Expired ☐ Well Not Drilled

Date _____ Signature of Operator or Agent _____

For KCC Use ONLY

API # 15 - 093-21872-0000

IN ALL CASES, PLEASE FULLY COMPLETE THIS SIDE OF THE FORM.

In all cases, please fully complete this side of the form. Include items 1 through 3 at the bottom of this page.

Operator: ONEOK PARTNERS
 Facility Name: GRAY
 Borehole Number: 01

Location of Well: County: KEARNY
2,029 feet from ☒ N / ☐ S Line of Section
50 feet from ☐ E / ☒ W Line of Section
 Sec. 24 Twp. 22 S. R. 36 ☐ E ☒ W

Is Section: ☒ Regular or ☐ Irregular

If Section is Irregular, locate well from nearest corner boundary.

Section corner used: ☐ NE ☐ NW ☐ SE ☐ SW

PLAT

Show location of the Cathodic Borehole. Show footage to the nearest lease or unit boundary line. Show the predicted locations of lease roads, tank batteries, pipelines and electrical lines, as required by the Kansas Surface Owner Notice Act (House Bill 2032).

You may attach a separate plat if desired.

SEE ATTACHED

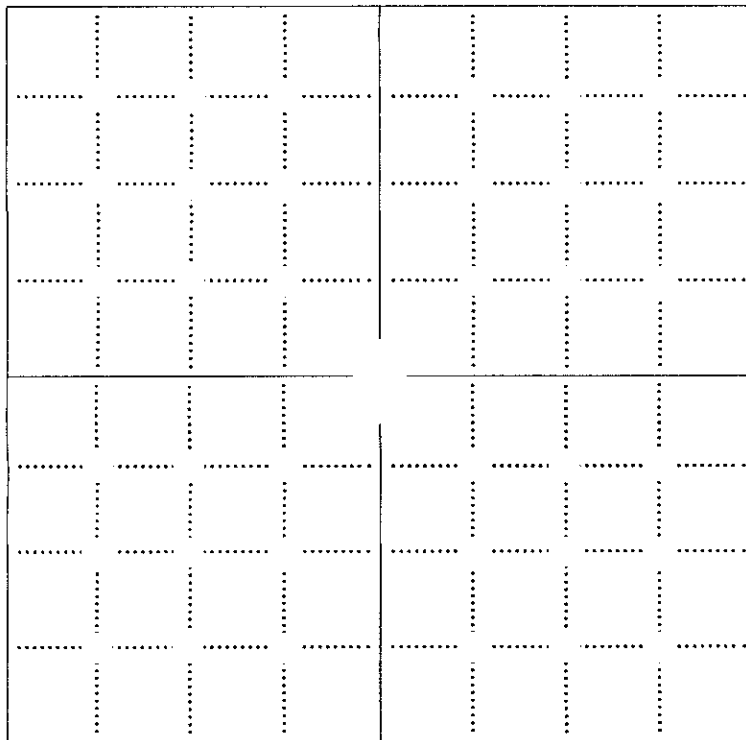
**LEGEND**

- ☐ Well Location
- ☐ Tank Battery Location
- ☐ Pipeline Location
- ☐ Electric Line Location
- ☐ Lease Road Location

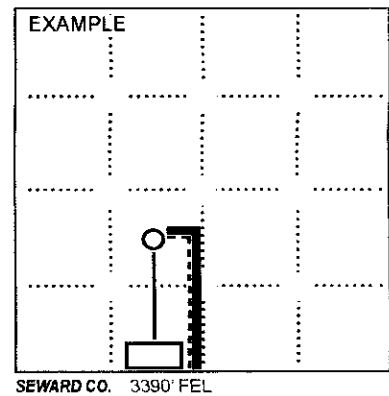

NOTE: In all cases locate the spot of the proposed drilling location.

In plotting the proposed location of the well, you must show:

1. The manner in which you are using the depicted plat by identifying section lines, i.e. 1 section, 1 section with 8 surrounding sections, 4 sections, etc.;
2. The distance of the proposed drilling location from the section's south / north and east / west; line.
3. The predicted locations of lease roads, tank batteries, pipelines, and electrical lines.

RECEIVED
 NOV 14 2011
 KCC WICHITA

06E60

15093-21872-0000

GRAY Well

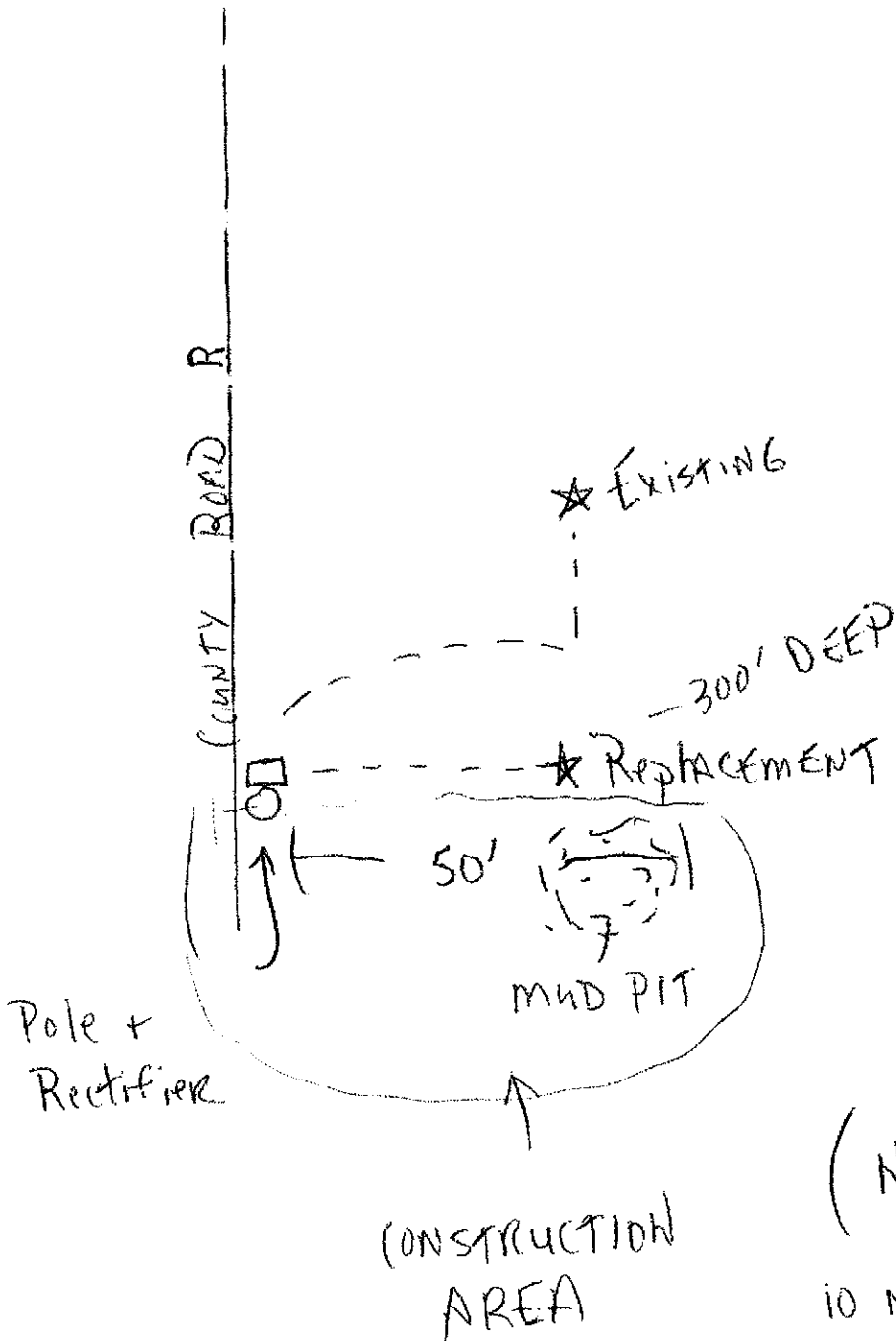

RECEIVED
NOV 14 2011
KCC WICHITA

(NW 1/4 ^{SE 1/4} 24-22-36)

10 Not Lakin on Hwy 25 to Rd 13
4 East on Rd 13 to ROAD R
25 N on Rd R to Site on
East side of ROAD

15-093-21872-0000
KANSAS CORPORATION COMMISSION
OIL & GAS CONSERVATION DIVISION

Form KSONA-1
July 2010
Form Must Be Typed
Form must be Signed
All blanks must be Filled

**CERTIFICATION OF COMPLIANCE WITH THE
KANSAS SURFACE OWNER NOTIFICATION ACT**

This form must be submitted with all Forms C-1 (Notice of Intent to Drill); CB-1 (Cathodic Protection Borehole Intent); T-1 (Request for Change of Operator Transfer of Injection or Surface Pit Permit); and CP-1 (Well Plugging Application). Any such form submitted without an accompanying Form KSONA-1 will be returned.

Select the corresponding form being filed: ☐ C-1 (Intent) ☒ CB-1 (Cathodic Protection Borehole Intent) ☐ T-1 (Transfer) ☐ CP-1 (Plugging Application)

OPERATOR: License # 33851
Name: ONEOK PARTNERS
Address 1: 1407 E OKLAHOMA
Address 2: _____
City: ULYSSES State: KS Zip: 67880 + _____
Contact Person: ROGER JONES
Phone: (620) 424-1549 Fax: (_____) _____
Email Address: _____

Well Location:
NW SW ^{SW} NW Sec. 24 Twp. 22 S. R. 36 ☐ East ☒ West
County: KEARNY
Lease Name: GRAY Well #: 01

If filing a Form T-1 for multiple wells on a lease, enter the legal description of the lease below:

Surface Owner Information:

Name: Phil C. Van Doren Revocable Trust, Barbara A. Van Doren Revocable Trust
Address 1: 1531 Sunny Mead Lane
Address 2: _____
City: Estes Park State: CO Zip: 80517 + 7544

When filing a Form T-1 involving multiple surface owners, attach an additional sheet listing all of the information to the left for each surface owner. Surface owner information can be found in the records of the register of deeds for the county, and in the real estate property tax records of the county treasurer.

If this form is being submitted with a Form C-1 (Intent) or CB-1 (Cathodic Protection Borehole Intent), you must supply the surface owners and the KCC with a plat showing the predicted locations of lease roads, tank batteries, pipelines, and electrical lines. The locations shown on the plat are preliminary non-binding estimates. The locations may be entered on the Form C-1 plat, Form CB-1 plat, or a separate plat may be submitted.

Select one of the following:

- ☒ I certify that, pursuant to the Kansas Surface Owner Notice Act (House Bill 2032), I have provided the following to the surface owner(s) of the land upon which the subject well is or will be located: 1) a copy of the Form C-1, Form CB-1, Form T-1, or Form CP-1 that I am filing in connection with this form; 2) if the form being filed is a Form C-1 or Form CB-1, the plat(s) required by this form; and 3) my operator name, address, phone number, fax, and email address.
- ☐ I have not provided this information to the surface owner(s). I acknowledge that, because I have not provided this information, the KCC will be required to send this information to the surface owner(s). To mitigate the additional cost of the KCC performing this task, I acknowledge that I am being charged a \$30.00 handling fee, payable to the KCC, which is enclosed with this form.

If choosing the second option, submit payment of the \$30.00 handling fee with this form. If the fee is not received with this form, the KSONA-1 form and the associated Form C-1, Form CB-1, Form T-1, or Form CP-1 will be returned.

I hereby certify that the statements made herein are true and correct to the best of my knowledge and belief.

Date: 11/8/11 Signature of Operator or Agent: [Signature] Title: OPERATIONS MANAGER

RECEIVED
NOV 14 2011
KCC WICHITA

**KANSAS CORPORATION COMMISSION
OIL & GAS CONSERVATION DIVISION
APPLICATION FOR SURFACE PIT**

Form CDP-1
May 2010
Form must be Typed

Submit in Duplicate

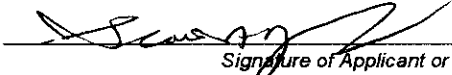
Operator Name: ONEOK PARTNERS		License Number: 33851	
Operator Address: 1407 E OKLAHOMA		ULYSSES KS 67880	
Contact Person: ROGER JONES		Phone Number: 620-424-1549	
Lease Name & Well No.: GRAY 01		Pit Location (QQQQ): NW - SW - ^{SW} NW	
Type of Pit: <input type="checkbox"/> Emergency Pit <input type="checkbox"/> Burn Pit <input type="checkbox"/> Settling Pit <input checked="" type="checkbox"/> Drilling Pit <input type="checkbox"/> Workover Pit <input type="checkbox"/> Haul-Off Pit <small>(If WP Supply API No. or Year Drilled)</small>		Pit is: <input checked="" type="checkbox"/> Proposed <input type="checkbox"/> Existing If Existing, date constructed: _____ Pit capacity: 60 (bbbls)	
		Sec. 24 Twp. 22 R. 36 <input type="checkbox"/> East <input checked="" type="checkbox"/> West 2,029 Feet from <input checked="" type="checkbox"/> North / <input type="checkbox"/> South Line of Section 50 Feet from <input type="checkbox"/> East / <input checked="" type="checkbox"/> West Line of Section KEARNY County	
Is the pit located in a Sensitive Ground Water Area? <input type="checkbox"/> Yes <input checked="" type="checkbox"/> No		Chloride concentration: _____ mg/l <small>(For Emergency Pits and Settling Pits only)</small>	
Is the bottom below ground level? <input checked="" type="checkbox"/> Yes <input type="checkbox"/> No	Artificial Liner? <input checked="" type="checkbox"/> Yes <input type="checkbox"/> No	How is the pit lined if a plastic liner is not used?	
Pit dimensions (all but working pits): 15 Length (feet) 6 Width (feet) <input type="checkbox"/> N/A: Steel Pits Depth from ground level to deepest point: 6 (feet) <input type="checkbox"/> No Pit			
If the pit is lined give a brief description of the liner material, thickness and installation procedure. 6M BLACKPLASTIC LINER LAYED IN PIT & EDGES SECURED TO PIT.		Describe procedures for periodic maintenance and determining liner integrity, including any special monitoring. PIT WILL ONLY BE USED FOR 2-3 DAY PERIOD, THEN PIT WILL BE BACKFILLED.	
Distance to nearest water well within one-mile of pit: 3725 feet Depth of water well 150 feet		Depth to shallowest fresh water 110 feet. Source of information: <input type="checkbox"/> measured <input type="checkbox"/> well owner <input type="checkbox"/> electric log <input checked="" type="checkbox"/> KDWR	
Emergency, Settling and Burn Pits ONLY: Producing Formation: _____ Number of producing wells on lease: _____ Barrels of fluid produced daily: _____ Does the slope from the tank battery allow all spilled fluids to flow into the pit? <input type="checkbox"/> Yes <input type="checkbox"/> No		Drilling, Workover and Haul-Off Pits ONLY: Type of material utilized in drilling/workover: fresh water Number of working pits to be utilized: 1 Abandonment procedure: Remove Fluids Drill pits must be closed within 365 days of spud date.	
I hereby certify that the above statements are true and correct to the best of my knowledge and belief.			
11/8/11 Date		 Signature of Applicant or Agent	

15-093-21872-0000

RECEIVED
NOV 14 2011
KCC WICHITA

KCC OFFICE USE ONLY			
<input type="checkbox"/> Liner <input type="checkbox"/> Steel Pit <input type="checkbox"/> RFAC <input type="checkbox"/> RFAS			
Date Received: 11-14-11	Permit Number: _____	Permit Date: 11-14-11	Lease Inspection: <input type="checkbox"/> Yes <input checked="" type="checkbox"/> No