

STATE OF KANSAS
STATE CORPORATION COMMISSION

WELL PLUGGING RECORD

Give All Information Completely
Make Required Affidavit
Mail or Deliver Report to
Conservation Division
State Corporation Comm.
245 North Water
Wichita, KS 67202

Greeley County. Sec. 8 Twp. 19 Rge. 39 R/W
Location as "NE/CNW $\frac{1}{4}$ SW $\frac{1}{4}$ " or footage from lines
C NW 1/4

Lease Owner Dorchester Exploration Inc.
Lease Name Fecht "C" Well No. 1
Office Address 1204 Vaughn Bldg., Midland, Texas
Character of Well (Completed as Oil, Gas or Dry Hole)
Gas

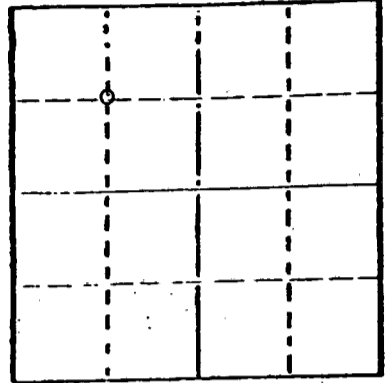

Locate well correctly on above Section Plat

Date Well completed 19
Application for plugging filed 7-27-1976 19
Application for plugging approved 8-3-1976 19
Plugging commenced 7-29-1976 19
Plugging completed 7-30-1976 19
Reason for abandonment of well or producing formation
Non Commercial value.

If a producing well is abandoned, date of last production
Never Produced 19
Was permission obtained from the Conservation Division or
its agents before plugging was commenced? Yes

Name of Conservation Agent who supervised plugging of this well Mr. Massey
Producing formation Hugoton Depth to top 2912 Bottom 2922 Total Depth of Well 2960
Show depth and thickness of all water, oil and gas formations.

OIL, GAS OR WATER RECORDS

CASING RECORD

FORMATION	CONTENT	FROM	TO	SIZE	PUT IN	PULLED OUT
Surface		0'	265'	8 5/8"	265'	0'
Hugoton		0'	2956'	4 1/2"	2956'	2121'

Describe in detail the manner in which the well was plugged, indicating where the mud fluid was placed and the method or methods used in introducing it into the hold. If cement or other plugs were used, state the character of same and depth placed, from _____ feet to _____ feet for each plug set.

Pumped 1 sack of hulls & 10 sacks cement to 2740'
Mud 2740' to 250'
Pumped 35 sacks cement 250' to 150'
Mud 150' to 45'
Bridge & 15 sacks cement 45' to 0'
Cut 8 5/8" off 42" below ground level.

(If additional description is necessary, use BACK of this sheet)

Name of Plugging Contractor Midwest Casing Pulling
Box F, Sublette Kansas # 766

STATE OF Kansas COUNTY OF Haskell ss.
Edgar J. Eves (employee of owner) or (owner or operator) of the above-described well, being first duly sworn on oath, says: That I have knowledge of the facts, statements, and matters herein contained and the log of the above-described well as filed and that the same are true and correct. So help me God.

(Signature) Edgar J. Eves
Box F, Sublette, Kansas 67877
(Address)

DESCRIBED AND SWORN TO before me this 9 day of Aug, 1976

RECEIVED
STATE CORPORATION COMMISSION
My commission expires _____

AUG 26 1976
CONSERVATION DIVISION
Wichita, Kansas

David B. Rinehart
Notary Public



KANSAS DRILLERS LOG

S. 8 T. 19 R. 39 ^E/_W

Loc. C NW
County Greeley

API No. 15 — 071 — 20,097-0000
County Number

Operator
Dorchester Exploration, Inc.

Address
1100 Midland National Bank Tower Midland, Texas 79701

Well No. 1 Lease Name Fecht C

Footage Location
1320 feet from (N) (X) line 1320 feet from (W) line

Principal Contractor Wakefield Drilling Co. Geologist R. L. Higginbottom

Spud Date 12-6-75 Total Depth 2960 P.B.T.D. 2956

Date Completed 1-3-76 Oil Purchaser

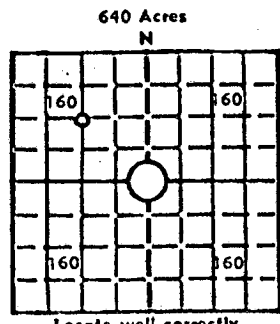

Elev.: Gr. 3535
DF _____ KB _____

CASING RECORD

Report of all strings set — surface, intermediate, production, etc.

Purpose of string	Size hole drilled	Size casing set (in O.D.)	Weight lbs/ft.	Setting depth	Type cement	Sacks	Type and percent additives
Surface	12 1/4"	8 5/8"	28	265	Class H	150	3% CaCl
Production	7 7/8"	4 1/2"	10.5	2956	Pozmix	200	6# salt & 1/4# Flocele per sk

LINER RECORD

PERFORATION RECORD

Top, ft.	Bottom, ft.	Sacks cement	Shots per ft.	Size & type	Depth interval
			10 holes		2912-22

TUBING RECORD

Size	Setting depth	Packer set at
	None	

ACID, FRACTURE, SHOT, CEMENT SQUEEZE RECORD

Amount and kind of material used	Depth interval treated
500 gals 15% acid with Morflo, Hyclean 2 & FEL-A	2912-22

INITIAL PRODUCTION

Date of first production	Producing method (flowing, pumping, gas lift, etc.)
	TSTM MCF

RATE OF PRODUCTION PER 24 HOURS	Oil	Gas	Water
	bbls.	bbls.	CFPB

Disposition of gas (vented, used on lease or sold) None Producing interval(s)

RECEIVED
STATE CORPORATION COMMISSION
APR 25 1984
CONSERVATION DIVISION
Wichita, Kansas

INSTRUCTIONS: As provided in KCC Rule 82-2-125, within 90 days after completion of a well, one completed copy of this Drillers Log shall be transmitted to the State Geological Survey of Kansas, 4150 Monroe Street, Wichita, Kansas 67209. Copies of this form are available from the Conservation Division, State Corporation Commission, 3830 So. Meridian (P.O. Box 17027), Wichita, Kansas 66217. Phone AC 316-522-2206. If confidential custody is desired, please note Rule 82-2-125. Drillers Logs will be on an open file in the Oil and Gas Division, State Geological Survey of Kansas, Lawrence, Kansas 66044.

DESIGNATE TYPE OF COMP.: OIL, GAS, DRY HOLE, SWDW, ETC.:

Operator **Dorchester Exploration, Inc.** 15-071-20097-0000

Well No. **1** Lease Name **Fecht C** Temporarily abandoned

S 8 T 19-SR 39^{XX} W

WELL LOG

Show all important zones of porosity and contents thereof; cored intervals, and all drill-stem tests, including depth interval tested, cushion used, time tool open, flowing and shut-in pressures, and recoveries.

SHOW GEOLOGICAL MARKERS, LOGS RUN, OR OTHER DESCRIPTIVE INFORMATION.

FORMATION DESCRIPTION, CONTENTS, ETC.	TOP	BOTTOM	NAME	DEPTH
Surface sand & Red Bed	0	265		
Blue Clay & Shale	265	1446		
Gyp & Shale	1446	2384		
Gyp, Anhydrite & Sand	2384	2680		
Shale & Sand	2680	2880	Base Stone Corral	2529
Lime & Anhydrite	2880	2930	Upper Winfield	2873
Lime & Shale	2930	2960		
<p>DST #1 2878-2906 ISIP 30 mins 79#, FSIP 90 mins 106# IFP 15 min 3# FFP 60 min 11# Rec 5' drlg mud</p> <p>DST #2 2907-2930 ISIP 30 min 364#, BSIP 90 min 449# - IFP 15 min 8#, FFP 60 min 26#</p>				
			<p>Welex Compensated Acoustic Velocity Log 310'-2930'</p>	

RECEIVED
 STATE CORPORATION COMMISSION
 APR 25 1984
 CONSERVATION DIVISION
 Wichita, Kansas

USE ADDITIONAL SHEETS, IF NECESSARY, TO COMPLETE WELL RECORD.

Date Received

J. W. Payne Signature
 Manager of Operations Title
 6-25-76 Date

File

15-071-20029-00-00

KANSAS DRILLER'S LOG

LEASE: FECHT #1
 OWNER: DORCHESTER EXPLORATION, INC.
 CONT: EARL F. WAKEFIELD, INC.
 SPUD: 12-6-75
 COMP: 12-10-75

LOCATION: SECTION 8-19S-39W
 GREELEY COUNTY, KANSAS

CASING: 8 5/8" SET @ 265'
 4 1/2" SET @ 2955'

Surface Sand & Red Bed	265
Blue Clay & Shale	1446
Gyp - Shale	2384
Gyp - Anhydrite - Sand	2680
Shale - Sand	2880
Lime & Anhydrite	2930
Shale - Lime	2960
R.T.D.	2960

RECEIVED
 STATE CORPORATION COMMISSION
 AUG 16 1976
 CONSERVATION DIVISION
 Wichita, Kansas

STATE OF KANSAS)
)
 COUNTY OF SEDGWICK) ss.

I, Gerald L. Mason, do hereby certify that this is a true and correct log on the FECHT #1, located in Section 8-19S-39W, Greeley County, Kansas, as shown by the daily drilling reports.

EARL F. WAKEFIELD, INC.

By Gerald L. Mason
 Gerald L. Mason

Subscribed and Sworn to before me this 22nd Day of December, 1975.



Carol Jean Noel
 Carol Jean Noel - Notary Public