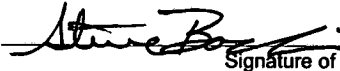

15-083-10165-0001

KANSAS CORPORATION COMMISSION
OIL & GAS CONSERVATION DIVISION
APPLICATION FOR SURFACE PIT

Form CDP-1
April 2004
Form must be Typed

Submit in Duplicate

Operator Name: DAYSTAR Petroleum, Inc.		License Number: 30931
Operator Address: P.O. Box 1285, Great Bend, KS. 67530-1285		
Contact Person: Steve Bodine		Phone Number: (620) 792 - 6702
Lease Name & Well No.: Oppy #2 SWD		Pit Location (QQQQ): C SE SW
Type of Pit: <input type="checkbox"/> Emergency Pit <input type="checkbox"/> Burn Pit <input type="checkbox"/> Settling Pit <input type="checkbox"/> Drilling Pit <input checked="" type="checkbox"/> Workover Pit <input type="checkbox"/> Haul-Off Pit <small>(If WP Supply API No. or Year Drilled)</small>	Pit is: <input type="checkbox"/> Proposed <input checked="" type="checkbox"/> Existing If Existing, date constructed: 02/05/2007 Pit capacity: 80 (bbls)	Sec. 18 Twp. 22s R. 22 <input type="checkbox"/> East <input checked="" type="checkbox"/> West 660 Feet from <input type="checkbox"/> North / <input checked="" type="checkbox"/> South Line of Section 1980 Feet from <input type="checkbox"/> East / <input checked="" type="checkbox"/> West Line of Section Hodgeman County
Is the pit located in a Sensitive Ground Water Area? <input type="checkbox"/> Yes <input checked="" type="checkbox"/> No		Chloride concentration: _____ mg/l <small>(For Emergency Pits and Settling Pits only)</small>
Is the bottom below ground level? <input checked="" type="checkbox"/> Yes <input type="checkbox"/> No	Artificial Liner? <input type="checkbox"/> Yes <input checked="" type="checkbox"/> No	How is the pit lined if a plastic liner is not used? Mud
Pit dimensions (all but working pits): 10 Length (feet) 10 Width (feet) N/A: Steel Pits Depth from ground level to deepest point: 6 (feet)		
If the pit is lined give a brief description of the liner material, thickness and installation procedure.		Describe procedures for periodic maintenance and determining liner integrity, including any special monitoring. Monitored daily
Distance to nearest water well within one-mile of pit 1691' ^{1689'} feet Depth of water well 54' feet		Depth to shallowest fresh water 37' feet. Source of information: _____ measured _____ well owner <input checked="" type="checkbox"/> electric log <input checked="" type="checkbox"/> KDWR
Emergency, Settling and Burn Pits ONLY: Producing Formation: _____ Number of producing wells on lease: _____ Barrels of fluid produced daily: _____ Does the slope from the tank battery allow all spilled fluids to flow into the pit? <input type="checkbox"/> Yes <input type="checkbox"/> No		Drilling, Workover and Haul-Off Pits ONLY: Type of material utilized in drilling/workover: brine water Number of working pits to be utilized: 1 Abandonment procedure: allow to dry and backfill Drill pits must be closed within 365 days of spud date.
I hereby certify that the above statements are true and correct to the best of my knowledge and belief.		
02/05/07 Date		 Signature of Applicant or Agent

15-083-10165-0001

KCC OFFICE USE ONLY		
Date Received: 2/8/07	Permit Number: 15-083-101650001	Permit Date: 2/5/07 Lease Inspection: <input checked="" type="checkbox"/> RECEIVED

Mail to: KCC - Conservation Division, 130 S. Market - Room 2078, Wichita, Kansas 67202

KANSAS CORPORATION COMMISSION

FEB 08 2007

CONSERVATION DIVISION
WICHITA, KS

WORKOVER PIT APPLICATION
VERBAL AUTHORIZATION

DATE: 2-5-07 TIME: 8:50
OPERATOR: DayStar CONTACT PERSON: _____
LEASE NAME: _____
C SE SW SEC. 18 TWP. 22 RANGE 22 W COUNTY: Hg

CONSTRUCTION:
SIZE: WIDTH 10 LENGTH 10 DEPTH 6
ESTIMATED CAPACITY 80 BBLS

EST. DEPTH TO GROUNDWATER (if known): _____
TYPE OF FLUID: Saltwater _____ Workover Fluids
 Cement _____ Drilling Mud/Cuttings

DOES OPERATOR PLAN TO LINE PIT: _____ YES NO
ESTIMATED TIME BEFORE PIT WILL BE CLOSED: 3 Days
ANY KNOWN WATER WELLS WITHIN 1/4 MILE OF PIT: _____ YES NO

K.C.C. INFORMATION: IS PIT IN SGA? _____ YES NO

- K.C.C. DISTRICT #1 RECOMMENDATION (Check One):
- 1. Authorization granted with no liner.
 - 2. Authorization granted, if pit is lined.
 - 3. Authorization granted, no liner necessary, but free fluids must be removed within _____ hours of completion of workover/plugging operations.
 - 4. No verbal authorization will be given without on-site inspection.

Remind operator that pit permit form must be filed within five (5) days after verbal authorization.

RESULTS OF INSPECTION:

RECEIVED
KANSAS CORPORATION COMMISSION
FEB 08 2007
CONSERVATION DIVISION
WICHITA, KS

Michael J. Merin Agent Date 2-5-07
cc: JOHELLE RAINS
15 08 3-101650001

CASING MECHANICAL INTEGRITY TEST

DOCKET # D-27246

Disposal Enhanced Recovery:

C SE SW, Sec 18, T 22 S, R 22 E/W

Repressuring
Flood
Tertiary

660 Feet from South Section Line
3300 Feet from East Section Line

Date injection started _____
API #15 - - - - -

Lease Oppy Well # 2 SWD
County Hodgeman

Operator: Daystar Petroleum Inc.
Name &
Address 1321 W 93rd N
Valley Center, KS 67147

Operator License # 30931
Contact Person Charles Schmidt
Phone 316-755-3492

Max. Auth. Injection Press. _____ psi; Max. Inj. Rate _____ bbl/d;
If Dual Completion - Injection above production _____ Injection below production _____

	Conductor	Surface	Production	Liner	Size	Tubing
Size	_____	10 3/4"	5 1/2"	_____	2 7/8"	_____
Set at	_____	306'	4599'	_____	Set at	3690'
Cement Top	_____	0	4000'	_____	Type	steel
" Bottom	_____	306'	4599'	_____		
DV/Perf.	_____			TD (and plug back) 3995		ft. depth
Packer type	tension		Size 5 1/2" X 2 7/8"	Set at 3695'		
Zone of injection	Topeka	ft. to ft. 3720-3730		Perf. or open hole	perf	

Type Mit: Pressure Radioactive Tracer Survey Temperature Survey

F Time: Start 0 Min. 15 Min. 30 Min.

I
E Pressures: 300 300 300 Set up 1 System Pres. during test 0
L Set up 2 Annular Pres. during test 300
D Set up 3 Fluid loss during test 0 bbls.

A Tested: Tubing or Casing - Tubing Annulus
T ~~Casing~~

The bottom of the tested zone is shut in with _____ a plug

Test Date 10/28/02 Using Swift Services Company's Equipment

The operator hereby certifies that the zone between 0 feet and 3690 feet

was the zone tested Charles Summers Pres. Signature Title

The results were Satisfactory , Marginal _____, Not Satisfactory _____

State Agent Michael J Maier Title Pint II Witness: Yes No _____

REMARKS: Initial test. Tubing is cemented in top to bottom. Used plug in packer to test tubing.

Origin. Conservation Div.; KDHE/T; Dist. Office;
 Computer Update
GPS entered

SAPT KCC Form U-7-6/84

Oppy 2 SW SW

ABK

Township 22S Range 22 & 23W County Hodgeman State Kansas

23w

22w

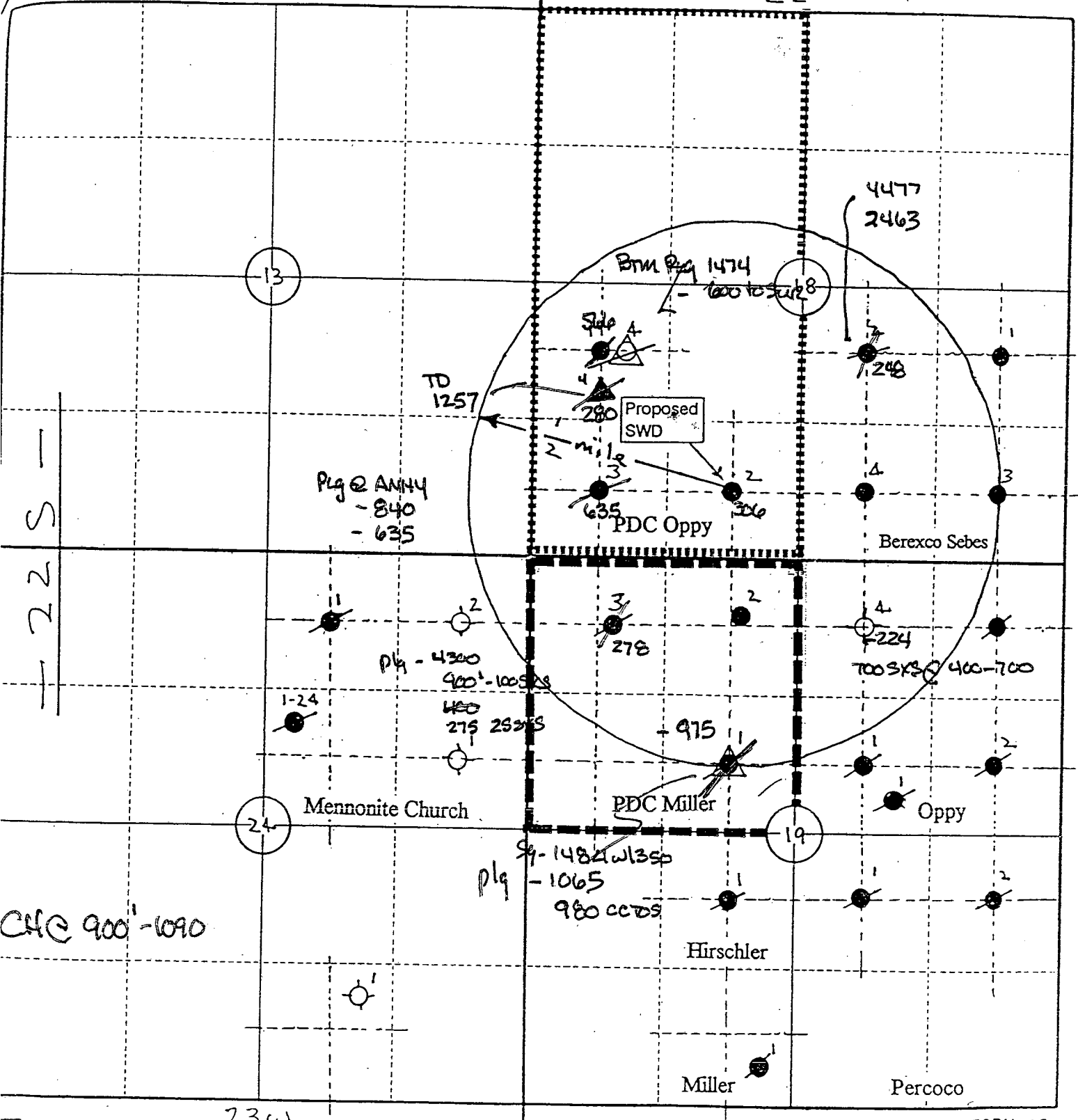

22S

C4 @ 900' - 1090'

23w

22w