

STATE CORPORATION COMMISSION OF KANSAS
OIL & GAS CONSERVATION DIVISION
WELL COMPLETION OR RECOMPLETION FORM
ACO-1 WELL HISTORY
DESCRIPTION OF WELL AND LEASE

API NO. 15-091-22,022-0000

County.....Johnson.....
.....SE. Sec. 17. Twp. 14 Rge. 22. East
..... West

Operator: License # 6142
NameTown Oil Co.....
AddressRt. 4.....
.....Paola, KS. 66071.....
City/State/Zip

220
2145... Ft North from Southeast Corner of Section
..... Ft West from Southeast Corner of Section
(Note: Locate well in section plat below)

Purchaser.....N/A.....

Lease Name.....Jack Kramer..... C-3
Well #.....

Operator Contact Person.....Lester Town.....
Phone913 294-2125.....

Field Name.....
Producing Formation.....
Elevation: Ground.....KB.....

Contractor: License #COMPANY TOOLS.....
Name

Wellsite Geologist.....
Phone.....

Designate Type of Completion
 New Well Re-Entry Workover

Oil SWD Temp Abd
 Gas Inj Delayed Comp
 Dry Other (Core, Water Supply etc.)

If OWO: old well info as follows:
Operator
Well Name
Comp. Date Old Total Depth.....

RECEIVED
STATE CORPORATION COMMISSION
JAN 7 1989
01-17-89
CONSERVATION DIVISION
Wichita, Kansas

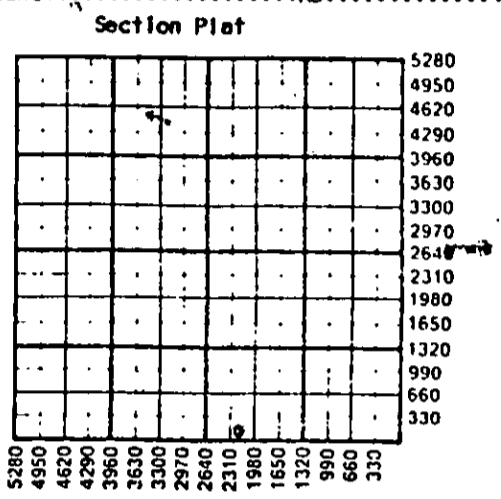

WATER SUPPLY INFORMATION
Disposition of Produced Water: _____ Disposal
Docket # _____ Repressuring

Questions on this portion of the ACO-1 call:
Water Resources Board (913) 296-3717
Source of Water:
Division of Water Resources Permit #.....
 Groundwater.....Ft North from Southeast Corner
(Well)Ft West from Southeast Corner of
Sec Twp Rge East West
 Surface Water.....Ft North from Southeast Corner
(Stream, pond etc).....Ft West from Southeast Corner
Sec Twp Rge East West
 Other (explain).....
(purchased from city, R.W.D. #)

WELL HISTORY
Drilling Method:
 Mud Rotary Air Rotary Cable
9-7-88..... 9-11-88.....
Spud Date Date Reached TD Completion Date
940.....
Total Depth PBDT
Amount of Surface Pipe Set and Cemented at...21...feet
Multiple Stage Cementing Collar Used? Yes No
If yes, show depth set.....feet
If alternate 2 completion, cement circulated
from...21...feet depth to...w/...SX cmt
Cement Company Name
Invoice #

INSTRUCTIONS: This form shall be completed in triplicate and filed with the Kansas Corporation Commission, 200 Colorado Derby Building, Wichita, Kansas 67202, within 120 days of the spud date of any well. Rule 82-3-130, 82-3-107 and 82-3-106 apply.
Information on side two of this form will be held confidential for a period of 12 months if requested in writing and submitted with the form. See rule 82-3-107 for confidentiality in excess of 12 months.
One copy of all wireline logs and drillers time log shall be attached with this form. Submit CP-4 form with all plugged wells. Submit CP-111 form with all temporarily abandoned wells.

All requirements of the statutes, rules and regulations promulgated to regulate the oil and gas industry have been fully complied with and the statements herein are complete and correct to the best of my knowledge.

SignatureLester Town.....

Title..... Notary Date 1-5-89

Subscribed and sworn to before me this 5 day of Jan 1989

Notary Public.....

Date Commission Expires 1-6-89

K.C.C. OFFICE USE ONLY
F Letter of Confidentiality Attached
C Wireline Log Received
C Drillers Time Log Received
Distribution
 KCC SWD/Rep NGPA
 KGS Plug Other
(Specify)
1-17-89
Form ACO-1 (5-86)

Sec. 17 Rge. 22



Operator Name Town Oil Co. Lease Name..... Jack Kramer Well #..... C-3

Sec..... 17 Twp..... 14 Rge..... 22 East West County..... Johnson

WELL LOG

INSTRUCTIONS: Show important tops and base of formations penetrated. Detail all cores. Report all drill stem tests giving interval tested, time tool open and closed, flowing and shut-in pressures, whether shut-in pressure reached static level, hydrostatic pressures, bottom hole temperature, fluid recovery, and flow rates if gas to surface during test. Attach extra sheet if more space is needed. Attach copy of log.

Drill Stem Tests Taken Yes No
Samples Sent to Geological Survey Yes No
Cores Taken Yes No

Formation Description
 Log Sample

Name Top Bottom

See attached log

CASING RECORD <input type="checkbox"/> New <input type="checkbox"/> Used							
Report all strings set-conductor, surface, intermediate, production, etc.							
Purpose of String	Size Hole Drilled	Size Casing Set (in O.D.)	Weight Lbs/Ft.	Setting Depth	Type of Cement	#Sacks Used	Type and Percent Additives
Surface Completion	9 1/4	6 7/8		21	Portland	3	
	5 1/2	2 1/2		930	Portland	100	40% Poz

PERFORATION RECORD			Acid, Fracture, Shot, Cement Squeeze Record (Amount and Kind of Material Used)	
Shots Per Foot	Specify Footage of Each Interval Perforated		Depth	

TUBING RECORD	Size	Set At	Packer at	Liner Run	<input type="checkbox"/> Yes <input type="checkbox"/> No
Date of First Production	Producing Method <input type="checkbox"/> Flowing <input type="checkbox"/> Pumping <input type="checkbox"/> Gas Lift <input type="checkbox"/> Other (explain).....				
Estimated Production Per 24 Hours	Oil	Gas	Water	Gas-Oil Ratio	Gravity
	M/A				
	Bbls	MCF	Bbls	CFPB	

METHOD OF COMPLETION

Production Interval

Disposition of gas: Vented Open Hole Perforation
 Sold Other (Specify)
 Used on Lease Dually Completed
 Commingled

Not perforated or fractured yet

TOWN OIL COMPANY

Route 4
Paola, Kansas 66071

"Drilling and Production"

913-294-2125

Well #C-3
Farm: Jack Kramer
Johnson County, KS.
Lease Owner: Town Oil Co.

WELL LOG

Thickness of Strata	Formation	Total Depth
0-10	Soil & clay	10
37	Shale	47
4	Lime	51
20	Shale	71
5	Lime	76
6	Shale	82
4	Sandy lime	86
4	Sandy shale	90
16	Lime	106
9	Shale	115
8	Lime	123
10	Shale	133
16	Lime	149
12	Shale	161
3	Lime	164
5	Shale	169
76	Lime	245
25	Shale	270
10	Lime	280
14	Shale	294
8	Lime	302
7	Shale	309
7	Lime	316
2	Shale	318
7	Lime	325
25	Shale	350
2	Lime	352
11	Shale	363
2	Lime	386
6	Shale & slate	392
23	Lime	415
4	Shale & slate	419
4	Lime	423
6	Shale & slate	429
6	Lime	435
173	Shale	608
6	Lime	614
4	Shells & slate	618
9	Shale & shells	627
7	Lime	634
6	Sand	640
10	Sandy shale	650
3	Lime	653
6	Slate	659
11	Lime	670

RECEIVED
STATE CORPORATION COMMISSION

JAN 17 1939

CONSERVATION DIVISION
Wichita, Kansas

Hertha

I hereby certify that the statements herein are complete and correct to the best of my knowledge.

Signature Lulu Town

Title Driller Date 1-5-39

Subscribed and sworn to before me this 5 day of Jan 1939

Notary Public Donna Jean Carhart

Date Commission Expires 4-6-39

K.C.C. OFFICE USE ONLY		
<input type="checkbox"/>	F	Letter of Confidentiality Attached
<input type="checkbox"/>	C	Wireline Log Received
<input type="checkbox"/>	C	Drillers Time-log Received
Distribution		
<input checked="" type="checkbox"/>	KCC	SWD/Rep
<input checked="" type="checkbox"/>	KGS	Plug
<input type="checkbox"/>		NGPA
<input type="checkbox"/>		Other
(Specify)		

Sec. 14 page 23C



1-17-39
Form ACO-1 (5-86)

3