

For KCC Use: 12-12-2011  
 Effective Date: 4  
 District # \_\_\_\_\_  
 SGA?  Yes  No

KANSAS CORPORATION COMMISSION  
 OIL & GAS CONSERVATION DIVISION

Form C-1  
 March 2010  
 Form must be Typed  
 Form must be Signed  
 All blanks must be Filled

**NOTICE OF INTENT TO DRILL**

Must be approved by KCC five (5) days prior to commencing well  
 Form KSONA-1, Certification of Compliance with the Kansas Surface Owner Notification Act, MUST be submitted with this form.

Expected Spud Date: 12 18 2011  
month day year

OPERATOR: License# 34099  
 Name: Richland Oil Investments, LLC  
 Address 1: P.O. Box 166  
 Address 2: \_\_\_\_\_  
 City: Palco State: KS Zip: 67657 + \_\_\_\_\_  
 Contact Person: Keith Lambert  
 Phone: (785) 737-5441  
 CONTRACTOR: License# 34233  
 Name: Maverick Drilling LLC

Spot Description: \_\_\_\_\_  
 SE - NE - SW - NW Sec. 29 Twp. 9 S. R. 21  E  W  
(or 1/2 or 3/4)  
1,910 feet from  N /  S Line of Section  
1,200 feet from  E /  W Line of Section  
 Is SECTION:  Regular  Irregular?

(Note: Locate well on the Section Plat on reverse side)  
 County: Graham  
 Lease Name: Grecian Trust Well #: 1 - 29  
 Field Name: Harold North  
 Is this a Prorated / Spaced Field?  Yes  No  
 Target Formation(s): Arbuckle  
 Nearest Lease or unit boundary line (in footage): 730  
 Ground Surface Elevation: 2331 surveyed \_\_\_\_\_ feet MSL  
 Water well within one-quarter mile:  Yes  No  
 Public water supply well within one mile:  Yes  No  
 Depth to bottom of fresh water: 150  
 Depth to bottom of usable water: 1050  
 Surface Pipe by Alternate:  I  II  
 Length of Surface Pipe Planned to be set: 200  
 Length of Conductor Pipe (if any): \_\_\_\_\_  
 Projected Total Depth: 3900  
 Formation at Total Depth: Arbuckle  
 Water Source for Drilling Operations:  
 Well  Farm Pond  Other: Hauled  
 DWR Permit #: \_\_\_\_\_  
 (Note: Apply for Permit with DWR   
 Will Cores be taken?  Yes  No  
 If Yes, proposed zone: \_\_\_\_\_

Well Drilled For:  Oil  Gas  Seismic; # of Holes \_\_\_\_\_  
 Enh Rec  Storage  Disposal  
 Other: \_\_\_\_\_  
 Well Class:  Infield  Pool Ext.  Wildcat  Other \_\_\_\_\_  
 Type Equipment:  Mud Rotary  Air Rotary  Cable  
 If OWWO: old well information as follows:  
 Operator: \_\_\_\_\_  
 Well Name: \_\_\_\_\_  
 Original Completion Date: \_\_\_\_\_ Original Total Depth: \_\_\_\_\_

Directional, Deviated or Horizontal wellbore?  Yes  No  
 If Yes, true vertical depth: \_\_\_\_\_  
 Bottom Hole Location: \_\_\_\_\_  
 KCC DKT #: \_\_\_\_\_

**AFFIDAVIT**

The undersigned hereby affirms that the drilling, completion and eventual plugging of this well will comply with K.S.A. 55 et. seq.  
 It is agreed that the following minimum requirements will be met:

1. Notify the appropriate district office **prior** to spudding of well;
2. A copy of the approved notice of intent to drill **shall be** posted on each drilling rig;
3. The minimum amount of surface pipe as specified below **shall be set** by circulating cement to the top; in all cases surface pipe **shall be set** through all unconsolidated materials plus a minimum of 20 feet into the underlying formation.
4. If the well is dry hole, an agreement between the operator and the district office on plug length and placement is necessary **prior to plugging**;
5. The appropriate district office will be notified before well is either plugged or production casing is cemented in;
6. If an ALTERNATE II COMPLETION, production pipe shall be cemented from below any usable water to surface within **120 DAYS** of spud date. Or pursuant to Appendix "B" - Eastern Kansas surface casing order #133,891-C, which applies to the KCC District 3 area, alternate II cementing must be completed within 30 days of the spud date or the well shall be plugged. **In all cases, NOTIFY district office** prior to any cementing.

I hereby certify that the statements made herein are true and to the best of my knowledge and belief.

Date: 12 - 06 - 2011 Signature of Operator or Agent: Keith E. Lambert Title: Managing Member

RECEIVED  
 DEC 06 2011  
 KCC WICHITA

For KCC Use ONLY  
 API # 15 - 065-237950000  
 Conductor pipe required None feet  
 Minimum surface pipe required 200 feet per ALT.  I  II  
 Approved by: RW 12-7-2011  
 This authorization expires: 12-7-2012  
(This authorization void if drilling not started within 12 months of approval date.)  
 Spud date: \_\_\_\_\_ Agent: \_\_\_\_\_

- Remember to:
- File Certification of Compliance with the Kansas Surface Owner Notification Act (KSONA-1) with Intent to Drill;
  - File Drill Pit Application (form CDP-1) with Intent to Drill;
  - File Completion Form ACO-1 within 120 days of spud date;
  - File acreage attribution plat according to field proration orders;
  - Notify appropriate district office 48 hours prior to workover or re-entry;
  - Submit plugging report (CP-4) after plugging is completed (within 60 days);
  - Obtain written approval before disposing or injecting salt water.
  - If well will not be drilled or permit has expired (See: authorized expiration date) please check the box below and return to the address below.
- Well will not be drilled or Permit Expired Date: \_\_\_\_\_  
 Signature of Operator or Agent: \_\_\_\_\_

29  
 9  
 21  
 E  
 W  
 N

Mail to: KCC - Conservation Division,  
 130 S. Market - Room 2078, Wichita, Kansas 67202

For KCC Use ONLY

API # 15 - 065-23795-0000

**IN ALL CASES PLOT THE INTENDED WELL ON THE PLAT BELOW**

In all cases, please fully complete this side of the form. Include items 1 through 5 at the bottom of this page.

Operator: Richland Oil Investments, LLC  
 Lease: Grecian Trust  
 Well Number: 1 - 29  
 Field: Harrold North

Number of Acres attributable to well:  
 QTR/QTR/QTR/QTR of acreage: SE - NE - SW - NW

Location of Well: County: Graham  
1,910 feet from  N /  S Line of Section  
1,200 feet from  E /  W Line of Section  
 Sec. 29 Twp. 9 S. R. 21  E  W

Is Section:  Regular or  Irregular

If Section is Irregular, locate well from nearest corner boundary.

Section corner used:  NE  NW  SE  SW

**PLAT**

Show location of the well. Show footage to the nearest lease or unit boundary line. Show the predicted locations of lease roads, tank batteries, pipelines and electrical lines, as required by the Kansas Surface Owner Notice Act (House Bill 2032).

You may attach a separate plat if desired.

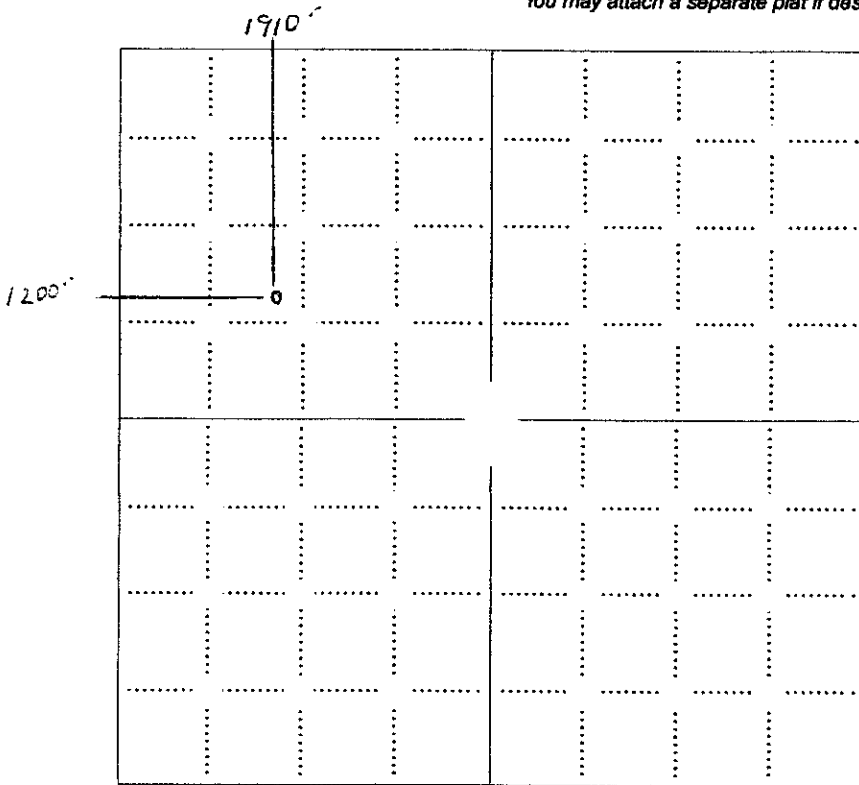

**LEGEND**

- Well Location
- Tank Battery Location
- Pipeline Location
- Electric Line Location
- Lease Road Location

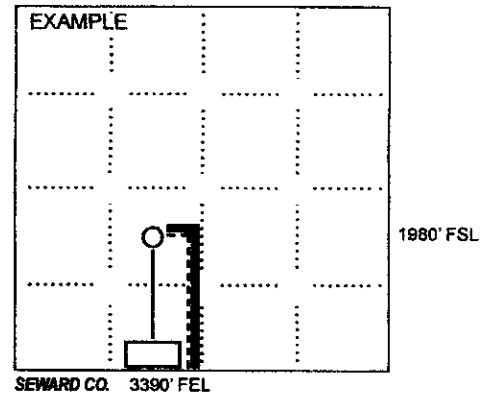

NOTE: In all cases locate the spot of the proposed drilling location.

RECEIVED  
 DEC 06 2011

KCC WICHITA

In plotting the proposed location of the well, you must show:

1. The manner in which you are using the depicted plat by identifying section lines, i.e. 1 section, 1 section with 8 surrounding sections, 4 sections, etc.
2. The distance of the proposed drilling location from the south / north and east / west outside section lines.
3. The distance to the nearest lease or unit boundary line (in footage).
4. If proposed location is located within a prorated or spaced field a certificate of acreage attribution plat must be attached: (CO-7 for oil wells; CG-8 for gas wells).
5. The predicted locations of lease roads, tank batteries, pipelines, and electrical lines.

RICHLAND OIL INVESTMENTS, LLC  
 GRECIAN TRUST LEASE  
 NW. 1/4, SECTION 29, T9S, R21W  
 GRAHAM COUNTY, KANSAS

15-065-23795-0000

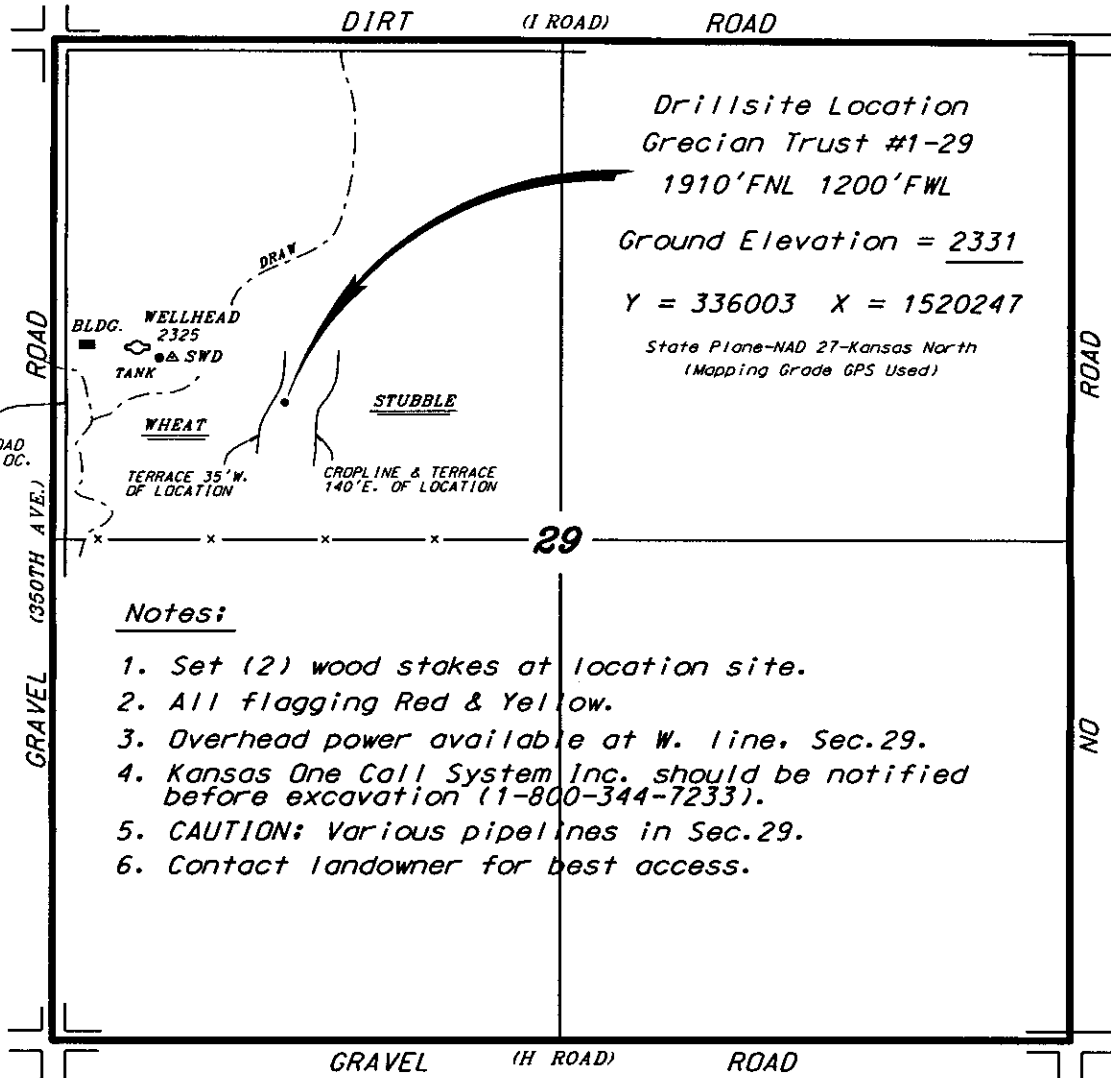

Notes:

1. Set (2) wood stakes at location site.
2. All flagging Red & Yellow.
3. Overhead power available at W. line, Sec.29.
4. Kansas One Call System Inc. should be notified before excavation (1-800-344-7233).
5. CAUTION: Various pipelines in Sec.29.
6. Contact landowner for best access.

\*Ingress and egress to location as shown on this plat is per usage only and may not be legally opened for public use. Contact landowner, tenant and county road department for access.

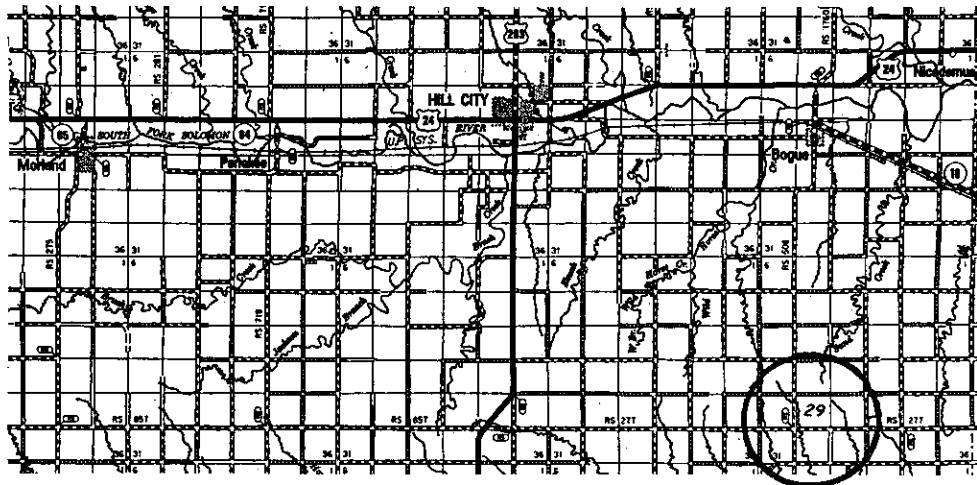

RECEIVED  
 DEC 06 2011  
 KCC WICHITA

\* Controlling data is based upon the best maps and photographs available to us and upon a regular section of land containing 640 acres.  
 \* Approximate section lines were determined using the normal standard of care of oilfield surveyors practicing in the state of Kansas. The section corners, which establish the precise section lines, were not necessarily located, and the exact location of the drillsite location in the section is not guaranteed. Therefore, the operator securing this service and accepting this plat and all other parties relying thereon agree to hold Central Kansas Oilfield Services, Inc., its officers and employees harmless from all losses, costs and expenses and said entities released from any liability from incidental or consequential damages.  
 \* Elevations derived from National Geodetic Vertical Datum.

Date November 30, 2011

15-065-23795-0000

# GRECIAN TRUST #1-29

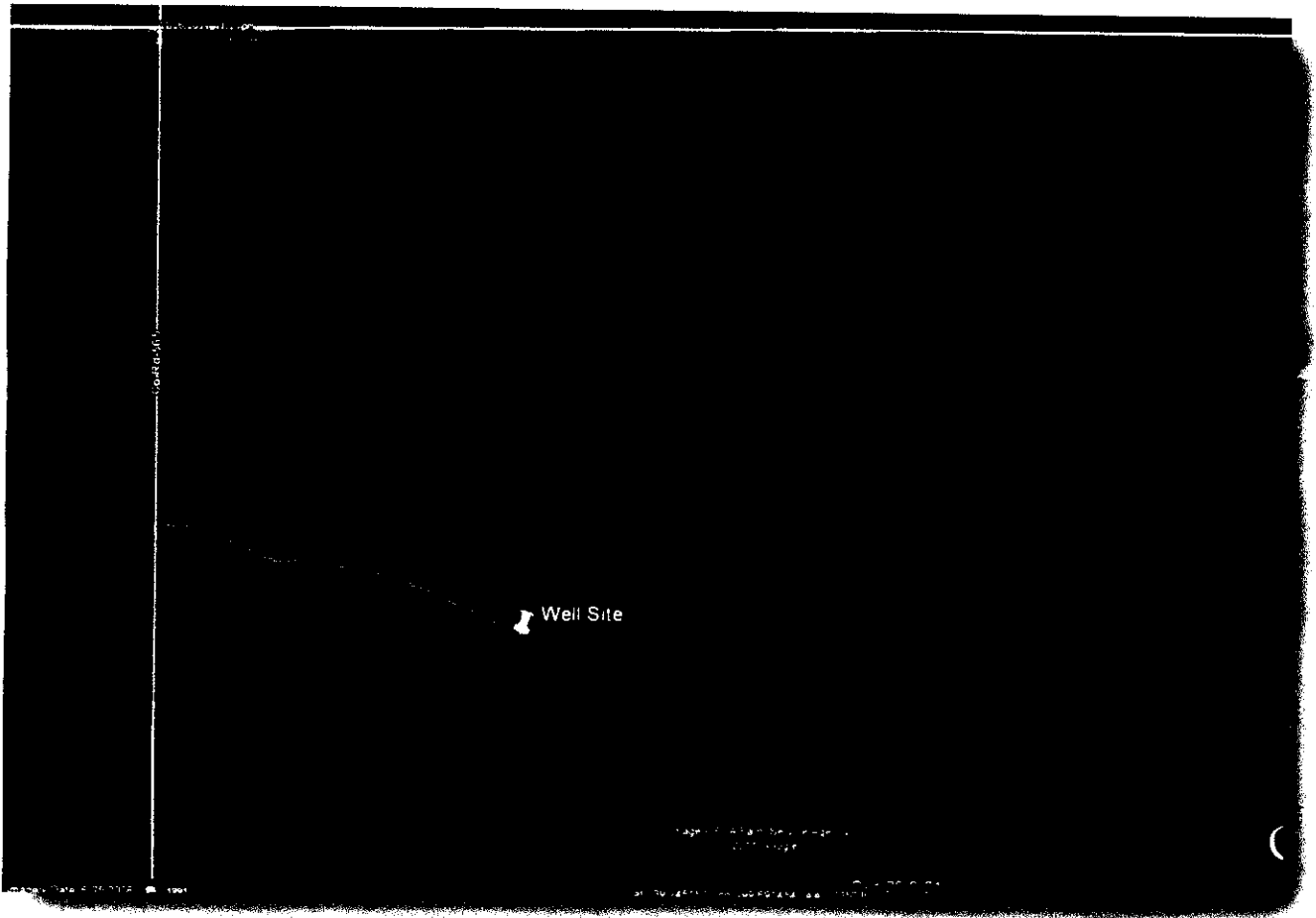





NW/4 29-9s-21w

## Richland Oil Investments, LLC

P.O. Box 166  
Palco, KS 67657

License # 34099

Home PH (785) 737-5441  
Cell PH (785) 737-8050

LEGEND	
	Well Location
	Lease Road Location
	Tank Battery Location
	Lead Line Location
	Electric Line Location

The Surface Notification Act requires notification to the surface owner of proposed well site, tank battery, roads, lead line and electric line. This notification is non-binding and locations can be changed by oil operator.

RECEIVED  
DEC 06 2011  
KCC WICHITA



15-06523795-0000

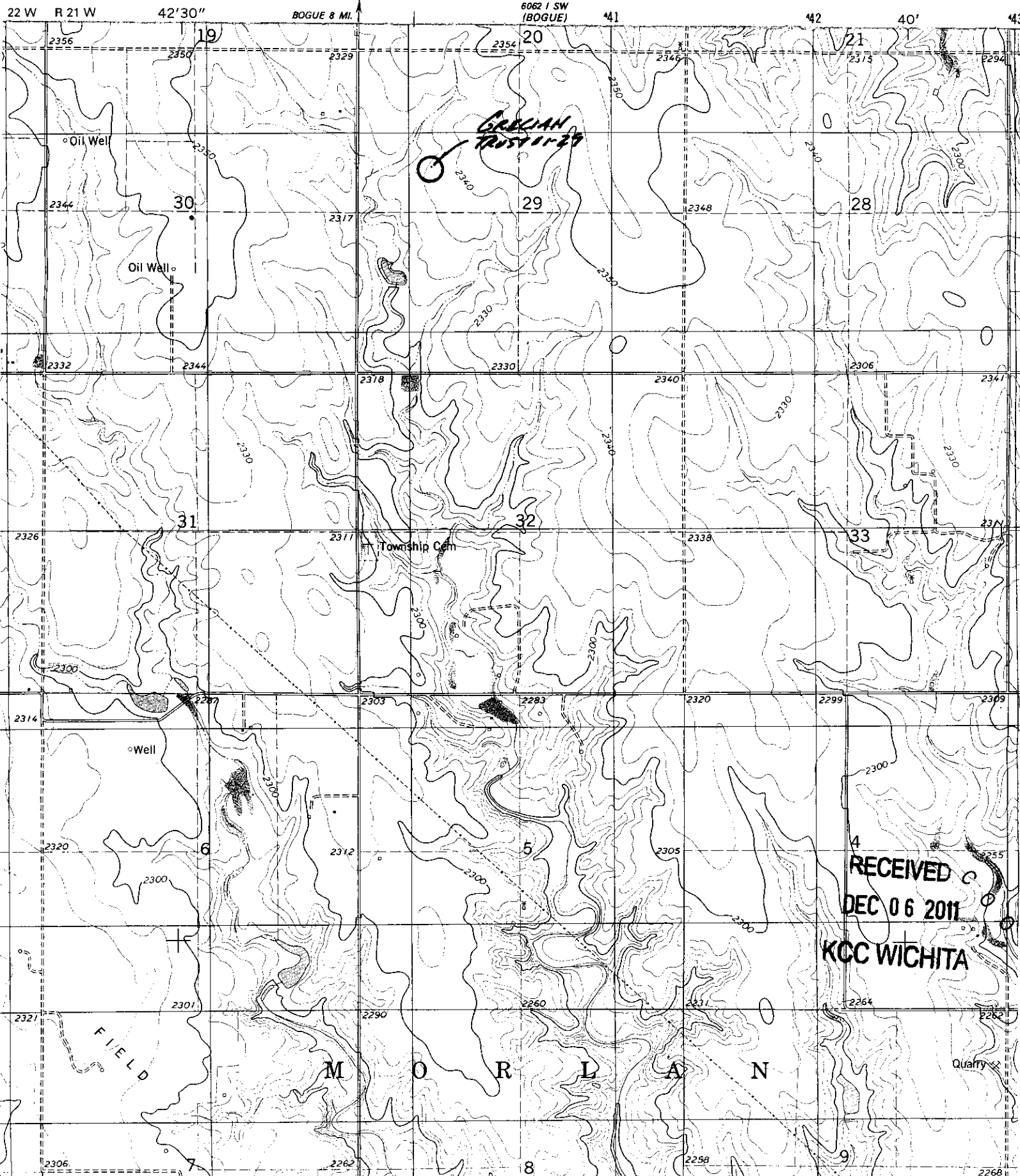

GALICIAN TRUST 11-29

RECEIVED  
DEC 06 2011  
KCC WICHITA

FIELD

MORLAN

Quarry

15-065-23795-0000

KANSAS CORPORATION COMMISSION  
OIL & GAS CONSERVATION DIVISION

Form KSONA-1  
July 2010  
Form Must Be Typed  
Form must be Signed  
All blanks must be Filled

**CERTIFICATION OF COMPLIANCE WITH THE  
KANSAS SURFACE OWNER NOTIFICATION ACT**

*This form must be submitted with all Forms C-1 (Notice of Intent to Drill); CB-1 (Cathodic Protection Borehole Intent); T-1 (Request for Change of Operator Transfer of Injection or Surface Pit Permit); and CP-1 (Well Plugging Application). Any such form submitted without an accompanying Form KSONA-1 will be returned.*

Select the corresponding form being filed:  C-1 (Intent)  CB-1 (Cathodic Protection Borehole Intent)  T-1 (Transfer)  CP-1 (Plugging Application)

OPERATOR: License # 34099  
Name: Richland Oil Investments, LLC  
Address 1: P.O. Box 166  
Address 2: \_\_\_\_\_  
City: Palco State: KS Zip: 67657 + \_\_\_\_\_  
Contact Person: Keith Lambert  
Phone: ( 785 ) 737 - 5441 Fax: ( 785 ) 737 - 5865  
Email Address: \_\_\_\_\_

Well Location:  
SE NE SW NW Sec. 29 Twp. 9 S. R. 21  East  West  
County: Graham  
Lease Name: Grecian Trust Well #: 1 - 29

*If filing a Form T-1 for multiple wells on a lease, enter the legal description of the lease below:*

**Surface Owner Information:**

Name: Kendal L. and Barbara A. Grecian Living Trust dated June 20, 2005  
Address 1: 1133 - A 350th Ave.  
Address 2: \_\_\_\_\_  
City: Palco State: KS Zip: 67657 + \_\_\_\_\_

*When filing a Form T-1 involving multiple surface owners, attach an additional sheet listing all of the information to the left for each surface owner. Surface owner information can be found in the records of the register of deeds for the county, and in the real estate property tax records of the county treasurer.*

*If this form is being submitted with a Form C-1 (Intent) or CB-1 (Cathodic Protection Borehole Intent), you must supply the surface owners and the KCC with a plat showing the predicted locations of lease roads, tank batteries, pipelines, and electrical lines. The locations shown on the plat are preliminary non-binding estimates. The locations may be entered on the Form C-1 plat, Form CB-1 plat, or a separate plat may be submitted.*

**Select one of the following:**

- I certify that, pursuant to the Kansas Surface Owner Notice Act (House Bill 2032), I have provided the following to the surface owner(s) of the land upon which the subject well is or will be located: 1) a copy of the Form C-1, Form CB-1, Form T-1, or Form CP-1 that I am filing in connection with this form; 2) if the form being filed is a Form C-1 or Form CB-1, the plat(s) required by this form; and 3) my operator name, address, phone number, fax, and email address.
- I have not provided this information to the surface owner(s). I acknowledge that, because I have not provided this information, the KCC will be required to send this information to the surface owner(s). To mitigate the additional cost of the KCC performing this task, I acknowledge that I am being charged a \$30.00 handling fee, payable to the KCC, which is enclosed with this form.

*If choosing the second option, submit payment of the \$30.00 handling fee with this form. If the fee is not received with this form, the KSONA-1 form and the associated Form C-1, Form CB-1, Form T-1, or Form CP-1 will be returned.*

I hereby certify that the statements made herein are true and correct to the best of my knowledge and belief.

Date: 12 - 06 - 2011 Signature of Operator or Agent: Keith L. Lambert Title: Managing Member

RECEIVED

DEC 06 2011

KCC WICHITA

KANSAS CORPORATION COMMISSION  
OIL & GAS CONSERVATION DIVISION

Form CDP-1  
May 2010  
Form must be Typed

APPLICATION FOR SURFACE PIT

Submit in Duplicate

Operator Name: <b>Richland Oil Investments, LLC</b>		License Number: <b>34099</b>
Operator Address: <b>P.O. Box 166</b>		<b>Palco KS 67657</b>
Contact Person: <b>Keith Lambert</b>		Phone Number: <b>(785) 737- 5441</b>
Lease Name & Well No.: <b>Grecian Trust 1 - 29</b>		Pit Location (QQQQ): <b>SE NE SW NW</b> Sec. <b>29</b> Twp. <b>9</b> R. <b>21</b> <input type="checkbox"/> East <input checked="" type="checkbox"/> West <b>1,910</b> Feet from <input checked="" type="checkbox"/> North / <input type="checkbox"/> South Line of Section <b>1,200</b> Feet from <input type="checkbox"/> East / <input checked="" type="checkbox"/> West Line of Section <b>Graham</b> County
Type of Pit: <input type="checkbox"/> Emergency Pit <input type="checkbox"/> Burn Pit <input type="checkbox"/> Settling Pit <input checked="" type="checkbox"/> Drilling Pit <input type="checkbox"/> Workover Pit <input type="checkbox"/> Haul-Off Pit <small>(If WP Supply API No. or Year Drilled)</small>	Pit is: <input checked="" type="checkbox"/> Proposed <input type="checkbox"/> Existing If Existing, date constructed: _____ Pit capacity: <b>4,800</b> (bbls)	
Is the pit located in a Sensitive Ground Water Area? <input type="checkbox"/> Yes <input checked="" type="checkbox"/> No		Chloride concentration: _____ mg/l <small>(For Emergency Pits and Settling Pits only)</small>
Is the bottom below ground level? <input checked="" type="checkbox"/> Yes <input type="checkbox"/> No	Artificial Liner? <input type="checkbox"/> Yes <input checked="" type="checkbox"/> No	How is the pit lined if a plastic liner is not used? <b>Bentonite in drilling mud</b>
Pit dimensions (all but working pits): <b>75</b> Length (feet) <b>75</b> Width (feet) <input type="checkbox"/> N/A: Steel Pits Depth from ground level to deepest point: <b>4</b> (feet) <input type="checkbox"/> No Pit		
If the pit is lined give a brief description of the liner material, thickness and installation procedure.		Describe procedures for periodic maintenance and determining liner integrity, including any special monitoring.
Distance to nearest water well within one-mile of pit: <b>4278</b> feet Depth of water well <b>102</b> feet		Depth to shallowest fresh water <b>44</b> feet. Source of information: <input type="checkbox"/> measured <input type="checkbox"/> well owner <input type="checkbox"/> electric log <input checked="" type="checkbox"/> KDWR
<b>Emergency, Settling and Burn Pits ONLY:</b> Producing Formation: _____ Number of producing wells on lease: _____ Barrels of fluid produced daily: _____ Does the slope from the tank battery allow all spilled fluids to flow into the pit? <input type="checkbox"/> Yes <input type="checkbox"/> No		<b>Drilling, Workover and Haul-Off Pits ONLY:</b> Type of material utilized in drilling/workover: _____ Number of working pits to be utilized: <b>3</b> Abandonment procedure: <b>air dry &amp; backfill</b> Drill pits must be closed within 365 days of spud date.
I hereby certify that the above statements are true and correct to the best of my knowledge and belief.  <b>12 - 06 - 2011</b> Date		<b>RECEIVED</b> <b>DEC 06 2011</b> <b>KCC WICHITA</b>
		<i>Keith Lambert</i> Signature of Applicant or Agent

15-065-23795-0000

KCC OFFICE USE ONLY

Liner  Steel Pit  RFAC  RFAS

Date Received: **12-7-11** Permit Number: \_\_\_\_\_ Permit Date: **12-7-11** Lease Inspection:  Yes  No

Mail to: KCC - Conservation Division, 130 S. Market - Room 2078, Wichita, Kansas 67202