

15-071-20628-0000

FOR KCC USE:

FORM C-1 7/91

EFFECTIVE DATE: 5-7-94

FORM MUST BE TYPED

DISTRICT # 1

State of Kansas
NOTICE OF INTENTION TO DRILL

FORM MUST BE SIGNED

SGA? Yes No

ALL BLANKS MUST BE FILLED

Must be approved by the K.C.C. five (5) days prior to commencing well

Expected Spud Date 5 15 94
month day year

Spot NW NE Sec 18 Twp 19 S. Rq 42 East
 NW NE West

OPERATOR: License # 30819
Name: Duncan Energy Company
Address: 1777 S. Harrison St.
City/State/Zip: Denver, CO 80210
Contact Person: John Bettridge
Phone: 303-759-3303

340 feet from South / North line of Section
2100 feet from East / West line of Section

IS SECTION REGULAR IRREGULAR?
(NOTE: Locate well on the Section Plat on Reverse Side)

County: Greeley
Lease Name: Steele Well #: 31-18
Field Name: Wildcat

CONTRACTOR: License #: _____
Name: _____

Is this a Prorated/Spaced Field? yes no
Target Formation(s): Morrow
Nearest lease or unit boundary: 340'

Well Drilled For: Well Class: Type Equipment:
 Oil ... Enh Rec ... Infield Mud Rotary
... Gas ... Storage ... Pool Ext. ... Air Rotary
... DWVO ... Disposal Wildcat ... Cable
... Seismic; ... # of Holes ... Other

Ground Surface Elevation: 3814 feet MSL
Water well within one-quarter mile: yes no
Public water supply well within one mile: yes no

If DWVO: old well information as follows:
Operator: _____
Well Name: _____
Comp. Date: _____ Old Total Depth _____

Depth to bottom of fresh water: 110'
Depth to bottom of usable water: 1800-1500'
Surface Pipe by Alternate: 1 2
Length of Surface Pipe Planned to be set: +200'

Directional, Deviated or Horizontal wellbore? yes no
If yes, true vertical depth: _____
Bottom Hole Location: _____

Length of Conductor pipe required: None
Projected Total Depth: 5330'
Formation at Total Depth: Morrow

AFFIDAVIT

The undersigned hereby affirms that the drilling, completion and eventual plugging of this well will comply with 101, et. seq. STATE CORPORATION COMMISSION

It is agreed that the following minimum requirements will be met:

RECEIVED
MAY 02 1994
05-02-94
CONSERVATION DIVISION

1. Notify the appropriate district office prior to spudding of well;
2. A copy of the approved notice of intent to drill shall be posted on each drilling rig;
3. The minimum amount of surface pipe as specified below shall be set by circulating cement to surface pipe shall be set through all unconsolidated materials plus a minimum of 20 feet into the wellbore.
4. If the well is dry hole, an agreement between the operator and the district office on plug length and placement is necessary prior to plugging;
5. The appropriate district office will be notified before well is either plugged or production casing is cemented in;
6. IF AN ALTERNATE II COMPLETION, PRODUCTION PIPE SHALL BE CEMENTED FROM BELOW ANY USABLE WATER TO SURFACE WITHIN 120 DAYS OF SPUD DATE. IN ALL CASES, NOTIFY DISTRICT OFFICE PRIOR TO ANY CEMENTING.

I hereby certify that the statements made herein are true and to the best of my knowledge and belief.

Date: April 29, 1994 Signature of Operator or Agent: Marie Oluf Title: Sr. Engineering Technician

FOR KCC USE:
API # 15- 071-20628-00-00
Conductor pipe required NONE feet
Minimum surface pipe required 200' feet per Alt.
Approved by: CB 5-2-94
This authorization expires: 11-2-94
(This authorization void if drilling not started within 6 months of effective date.)
Spud date: _____ Agent: _____

REMEMBER TO:

- File Drill Pit Application (form CDP-1) with Intent to Drill;
- File Completion Form ACO-1 within 120 days of spud date;
- File acreage attribution plat according to field prorations orders;
- Notify appropriate district office 48 hours prior to workover or re-entry;
- Submit plugging report (CP-4) after plugging is completed;
- Obtain written approval before disposing or injecting salt water.

Mail to: Conservation Division, 200 Colorado Derby Building, 202 W. First St., Wichita, Kansas 67202-1286.

18
19
42

IN ALL CASES PLOT THE INTENDED WELL ON THE PLAT BELOW

PLAT OF ACREAGE ATTRIBUTABLE TO A WELL IN A PRORATED OR SPACED FIELD

If the intended well is in a prorated or spaced field, please fully complete this side of the form. If the intended well is in a prorated or spaced field complete the plat below showing that the well will be properly located in relationship to other wells producing from the common source of supply. Please show all the wells within 1 mile of the boundaries of the proposed acreage attribution unit for gas wells and within 1/2 mile of the boundaries of the proposed acreage attribution unit for oil wells.

API NO. 15- _____
 OPERATOR Duncan Energy Company
 LEASE Steele
 WELL NUMBER 31-18
 FIELD Wildcat

LOCATION OF WELL: COUNTY Greeley
 _____ feet from south/~~north~~ line of section
340
 _____ feet from east/~~west~~ line of section
2100
 SECTION 18 TWP 19S RG 42W

NUMBER OF ACRES ATTRIBUTABLE TO WELL _____
 QTR/QTR/QTR OF ACREAGE NW - NW - NE

IS SECTION _____ REGULAR or X IRREGULAR
 IF SECTION IS IRREGULAR, LOCATE WELL FROM NEAREST
 CORNER BOUNDARY.

Section corner used: _____ NE _____ NW _____ SE _____ SW

PLAT

(Show location of the well and shade attributable acreage for prorated or spaced wells.)
 (Show footage to the nearest lease or unit boundary line.)

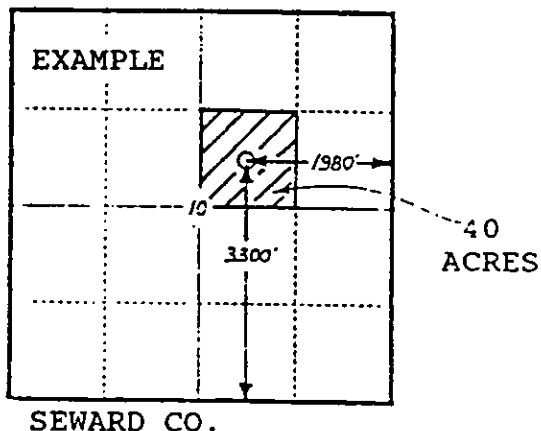
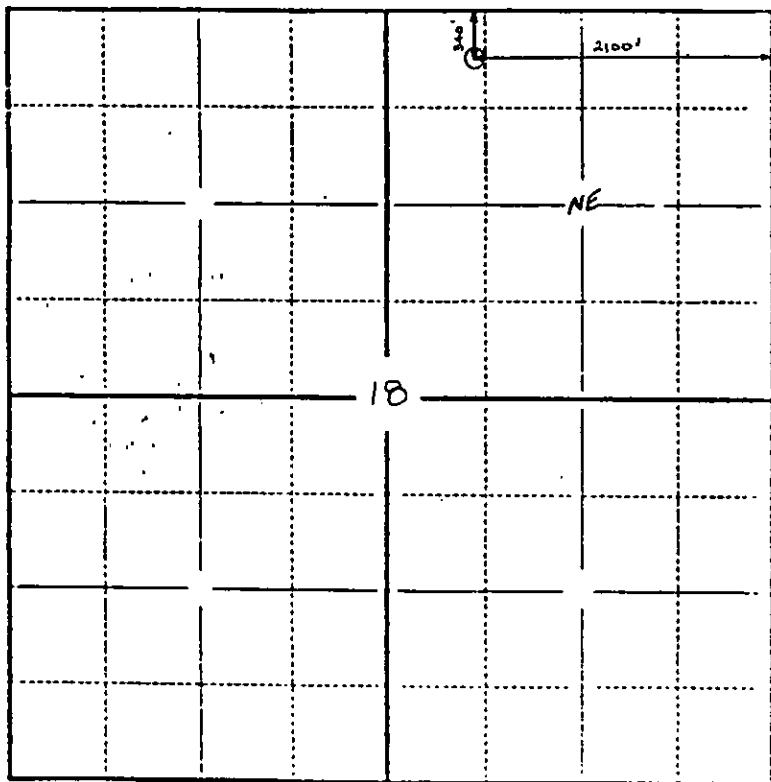

In plotting the proposed location of the well, you must show:

- 1) The manner in which you are using the depicted plat by identifying section lines, i.e. 1 section, 1 section with 8 surrounding sections, 4 sections, etc.;
- 2) the distance of the proposed drilling location from the section's south/north and east/west lines; and
- 3) the distance to the nearest lease or unit boundary line.