

STATE OF KANSAS
STATE CORPORATION COMMISSION

15-071-20192-00-00

WELL PLUGGING RECORD

Give All Information Completely
Make Required Affidavit
Mail or Deliver Report to
Conservation Division
State Corporation Comm.
245 North Water
Wichita, KS 67202

Greeley County, Sec. 4 Twp. 19S Rge. 42 NW/4
Location as "NE/CNW/SW" or footage from lines
C SE/4

Lease Owner Anadarko Production Company
Lease Name GRABER "B" Well No. 1
Office Address P. O. Box 351, Liberal, Kansas 67901
Character of Well (Completed as Oil, Gas or Dry Hole)
Dry Hole

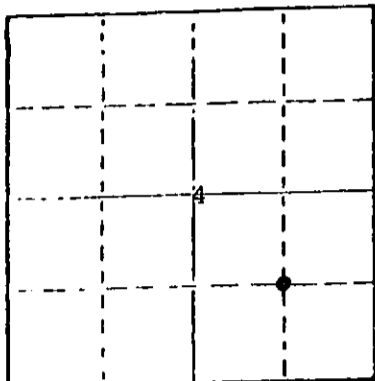

Locate well correctly on above
Section Plat

Date Well completed 2-20 1980
Application for plugging filed 4-21 1980
Application for plugging approved verbal 2-20 1980
Plugging commenced 2-20 1980
Plugging completed 2-20 1980

Reason for abandonment of well or producing formation
Dry Hole

If a producing well is abandoned, date of last production
19

Was permission obtained from the Conservation Division or
its agents before plugging was commenced? yes

Name of Conservation Agent who supervised plugging of this well Gilbert Balthazor
Producing formation Depth to top Bottom Total Depth of Well 5713'
Show depth and thickness of all water, oil and gas formations.

OIL, GAS OR WATER RECORDS

CASING RECORD

FORMATION	CONTENT	FROM	TO	SIZE	PUT IN	PULLED OUT
				8-5/8"	611'	-0-

Describe in detail the manner in which the well was plugged, indicating where the mud fluid
was placed and the method or methods used in introducing it into the hold. If cement or other
plugs were used, state the character of same and depth placed, from feet to
feet for each plug set.

Spotted 70 sxs cmt @ 1100', 20 sxs cmt @ 600', 10 sxs 40-0', put 5 sxs cmt in rathole.

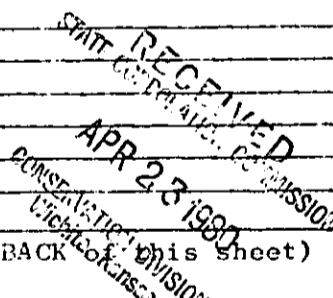

(If additional description is necessary, use BACK of this sheet)

Name of Plugging Contractor Gabbert-Jones, Inc.

STATE OF KANSAS COUNTY OF SEWARD, ss.
Paul Campbell (employee of owner) or ~~XXXXXXXXXXXXXXXXXX~~
of the above-described well, being first duly sworn on oath, says: That I have knowledge of
the facts, statements, and matters herein contained and the log of the above-described well
as filed and that the same are true and correct. So help me God.

(Signature) Paul Campbell
P. O. Box 351, Liberal, Kansas 67901
(Address)

SUBSCRIBED AND SWORN TO before me this 21st day of April, 1980

BEVERLY J. WILLIAMS
Seward County, Kansas
My Appt. Exp. 11/21/82

Beverly J. Williams
Notary Public.

My commission expires November 21, 1982

KANSAS

WELL COMPLETION REPORT AND
DRILLER'S LOG

API No. 15 — 071 — 20,192-00-00
County Number

S. 4 T. 19S R. 42 W

Loc. C SE/4

County Greeley

Operator

Anadarko Production Company

Address

P. O. Box 351, Liberal, Kansas 67901

Well No.

1

Lease Name

GRABER "B"

Footage Location

1320 feet from (N) (S) line 1320 feet from (E) (W) line

Principal Contractor

Gabbert-Jones, Inc.

Geologist

Goolsly

Spud Date

1/30/80

Date Completed

2/20/80

Total Depth

5713'

P.B.T.D.

Directional Deviation

1/2 deg @ 4450'

Oil and/or Gas Purchaser

Dry Hole

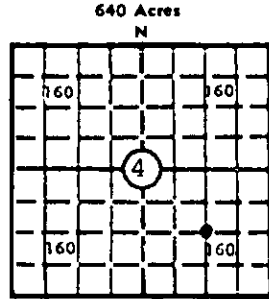

Locate well correctly

Elev.: Gr. 3805.3'

DF 3508' KB 3509'

CASING RECORD

Report of all strings set — surface, intermediate, production, etc.

Purpose of string	Size hole drilled	Size casing set (in O.D.)	Weight lbs/ft.	Setting depth	Type cement	Sacks	Type and percent additives
Surface	12-1/4"	8-5/8"	20#	611	Common	600	3% CaCl

LINER RECORD

PERFORATION RECORD

Top, ft.	Bottom, ft.	Sacks cement	Shots per ft.	Size & type	Depth interval

TUBING RECORD

Size	Setting depth	Packer set at

ACID, FRACTURE, SHOT, CEMENT SQUEEZE RECORD

Amount and kind of material used	Depth interval treated

RECEIVED
STATE CORPORATION COMMISSION
APR 23 1980
CONSERVATION DIVISION
Wichita, Kansas

INITIAL PRODUCTION

Date of first production		Producing method (flowing, pumping, gas lift, etc.)			
DRY HOLE					
RATE OF PRODUCTION PER 24 HOURS	Oil	Gas	Water	Gas-oil ratio	
	bbls.	MCF	bbls.	CFPB	
Disposition of gas (vented, used on lease or sold)			Producing interval (s)		

INSTRUCTIONS: As provided in KCC Rule 82-2-125, within 90 days after completion of a well, one completed copy of this Drillers Log shall be transmitted to the State Geological Survey of Kansas, 4150 Monroe Street, Wichita, Kansas 67209. Copies of this form are available from the Conservation Division, State Corporation Commission, 245 No. Water, Wichita, Kansas 67202. Phone AC 316-522-2206. If confidential custody is desired, please note Rule 82-2-125. Drillers Logs will be on open file in the Oil and Gas Division, State Geological Survey of Kansas, Lawrence, Kansas 66044.

Operator Anadarko Production Company		DESIGNATE TYPE OF COMP.: OIL, GAS, DRY HOLE, SWDW, ETC.:
Well No. 1	Lease Name GRABER "B"	DRY HOLE
S 4 T 19S R 42 ^E _W		

WELL LOG

Show all important zones of porosity and contents thereof; cored intervals, and all drill-stem tests, including depth interval tested, cushion used, time tool open, flowing and shut-in pressures, and recoveries.

SHOW GEOLOGICAL MARKERS, LOGS RUN, OR OTHER DESCRIPTIVE INFORMATION.

FORMATION DESCRIPTION, CONTENTS, ETC.	TOP	BOTTOM	NAME	DEPTH
Surface Clay-Sand-Redbed	0'	355'	LOGS: Schlumberger Dual Induction-SFL Borehole compensated Sonic Log	
Clay	355'	1032'		
Clay-Sand	1032'	1577'		
Shale-Lime	1577'	1870'		
Lime-Shale	1870'	5104'		
Lime	5104'	5220'		
Lime-Shale	5220'	5309'		
Shale-Lime	5309'	5405'		
Lime	5405'	5515'		
Lime-Shale	5515'	5674'		
Lime-Shale	5674'	5713'		
RTD		5713'		
DST #1 3785-3808, 30-60-60-120, op w/wk blow incrg to fair, rec 505' muddy water, IFP 26-132, ISIP 895 (60), FFP 159-291, FSIP 895 (120), HP 1893-1893, temp 103 deg.				

USE ADDITIONAL SHEETS, IF NECESSARY, TO COMPLETE WELL RECORD.

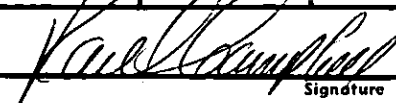
Date Received	 Signature Paul Campbell, Division Production Manager Title April 21, 1980 Date
---------------	--