



KANSAS CORPORATION COMMISSION 1064657
OIL & GAS CONSERVATION DIVISION

Form ACO-1
June 2009
Form Must Be Typed
Form must be Signed
All blanks must be Filled

CONFIDENTIAL

WELL COMPLETION FORM
WELL HISTORY - DESCRIPTION OF WELL & LEASE

OPERATOR: License # 34192
Name: SandRidge Exploration and Production LLC
Address 1: 123 ROBERT S. KERR AVE
Address 2: _____
City: OKLAHOMA CITY State: OK Zip: 73102 + 6406
Contact Person: Karen Sharp
Phone: (405) 429-5745
CONTRACTOR: License # 34464
Name: Lariat Services, Inc.
Wellsite Geologist: Tammy Alcorn
Purchaser: Coffeyville Resources; Atlas

Designate Type of Completion:
 New Well Re-Entry Workover
 Oil WSW SWD SIOW
 Gas D&A ENHR SIGW
 OG GSW Temp. Abd.
 CM (Coal Bed Methane)
 Cathodic Other (Core, Expl., etc.): _____

If Workover/Re-entry: Old Well Info as follows:
Operator: _____

Well Name: _____
Original Comp. Date: _____ Original Total Depth: _____
 Deepening Re-perf. Conv. to ENHR Conv. to SWD
 Conv. to GSW
 Plug Back: _____ Plug Back Total Depth
 Commingled Permit #: _____
 Dual Completion Permit #: _____
 SWD Permit #: _____
 ENHR Permit #: _____
 GSW Permit #: _____

08/14/2011	08/30/2011	09/20/2011
Spud Date or Recompletion Date	Date Reached TD	Completion Date or Recompletion Date

API No. 15 - 15-077-21745-01-00
Spot Description: _____
S2_S2_SW_SE Sec. 16 Twp. 35 S. R. 6 East West
200 Feet from North / South Line of Section
1980 Feet from East / West Line of Section
Footages Calculated from Nearest Outside Section Corner:
 NE NW SE SW
County: Harper
Lease Name: Green Well #: 1-16H
Field Name: Waldron West
Producing Formation: Mississippi
Elevation: Ground: 1232 Kelly Bushing: 1252
Total Depth: 9163 Plug Back Total Depth: _____
Amount of Surface Pipe Set and Cemented at: 583 Feet
Multiple Stage Cementing Collar Used? Yes No
If yes, show depth set: _____ Feet
If Alternate II completion, cement circulated from: _____
feet depth to: _____ w/ _____ sx cmt.

Drilling Fluid Management Plan
(Data must be collected from the Reserve Pit)
Chloride content: 10500 ppm Fluid volume: 8350 bbls
Dewatering method used: Hauled to Disposal
Location of fluid disposal if hauled offsite:
Operator Name: Triple C Farming
Lease Name: Gray Mud Disposal License #: 99999
Quarter NE Sec. 15 Twp. 24 S. R. 7 East West
County: W Garfield, OK Permit #: 18278

AFFIDAVIT

I am the affiant and I hereby certify that all requirements of the statutes, rules and regulations promulgated to regulate the oil and gas industry have been fully complied with and the statements herein are complete and correct to the best of my knowledge.

Submitted Electronically

KCC Office Use ONLY

Letter of Confidentiality Received
Date: 12/20/2011

Confidential Release Date: _____

Wireline Log Received

Geologist Report Received

UIC Distribution

ALT I II III Approved by: NAOMI JAMES Date: 12/20/2011



Standard Wellpath Report
 Sandridge
 Sec 16 - 35S - 6W, Kansas
 Harper County
 Wellbore: Green 1-16H (Actual)

Wellbore

Name	Created	Last Revised
Green 1-16H (Actual)	10-Aug-2011	31-Aug-2011

Well

Name	Government ID	Last Revised
Green 1-16H		10-Aug-2011

Slot

Name	Grid Northing	Grid Easting	Latitude	Longitude	North	East
Green 1-16H	121459.0000	2154274.0000	N36 59 56.5194	W97 58 18.3839	180.99N	1980.88W

Installation

Name	Easting	Northing	Coord System Name	North Alignment
Harper County	2156255.0000	121278.0001	KS-S on NORTH AMERICAN DATUM 1927 datum	Grid

Field

Name	Easting	Northing	Coord System Name	North Alignment
Sec 16 - 35S - 6W	2156255.0000	121278.0001	KS-S on NORTH AMERICAN DATUM 1927 datum	Grid

Created By

Comments

All data is in Feet unless otherwise stated
 Coordinates are from Slot MD's are from Slot and TVD's are from Slot (Green 1-16H 0.00ft above Mean Sea Level)
 Vertical Section is from 0.00N 0.00E on azimuth 359.560 degrees
 Bottom hole distance is 4845.23 Feet on azimuth 359.52 degrees from Wellhead
 Calculation method uses Minimum Curvature method
 Prepared by
 Date Printed: 31-Aug-2011



Standard Wellpath Report
 Sandridge
 Sec 16 - 35S - 6W, Kansas
 Harper County
 Wellbore: Green 1-16H (Actual)

Wellpath (Grid) Report

MD[ft]	Inc[deg]	Azi[deg]	TVD[ft]	North[ft]	East[ft]	Dogleg [deg/100ft]	Vertical Section[ft]	Easting	Northing
0.00	0.00	0.000	0.00	0.00N	0.00E		0.00	2154274.00	121459.00
622.00	0.70	294.400	621.98	1.57N	3.46W	0.11	1.60	2154270.54	121460.57
958.00	0.30	219.800	957.97	1.74N	5.89W	0.20	1.79	2154268.11	121460.74
1433.00	0.40	352.400	1432.97	2.43N	6.91W	0.14	2.48	2154267.09	121461.43
1909.00	0.50	358.700	1908.95	6.15N	7.17W	0.02	6.21	2154266.82	121465.15
2386.00	0.40	18.800	2385.94	9.81N	6.69W	0.04	9.86	2154267.31	121468.81
2862.00	0.40	51.600	2861.93	12.42N	4.85W	0.05	12.45	2154269.15	121471.42
3338.00	0.50	339.600	3337.92	15.39N	4.27W	0.11	15.43	2154269.73	121474.39
3783.00	0.40	309.100	3782.90	18.19N	6.15W	0.06	18.24	2154267.85	121477.19
3815.00	0.40	350.000	3814.90	18.37N	6.26W	0.87	18.42	2154267.74	121477.37
3847.00	2.20	2.200	3846.89	19.10N	6.25W	5.66	19.14	2154267.75	121478.10
3878.00	5.00	1.800	3877.83	21.04N	6.19W	9.03	21.09	2154267.81	121480.04
3910.00	7.60	4.300	3909.63	24.55N	5.99W	8.17	24.59	2154268.01	121483.55
3942.00	9.70	5.300	3941.27	29.34N	5.58W	6.58	29.38	2154268.42	121488.34
3974.00	11.70	4.500	3972.71	35.26N	5.07W	6.27	35.30	2154268.93	121494.26
4005.00	12.90	1.200	4003.00	41.86N	4.76W	4.48	41.89	2154269.24	121500.86
4037.00	14.70	359.800	4034.07	49.49N	4.69W	5.72	49.52	2154269.30	121508.49
4069.00	16.40	1.800	4064.90	58.06N	4.57W	5.57	58.10	2154269.43	121517.07
4101.00	17.80	4.900	4095.49	67.45N	4.01W	5.22	67.48	2154269.99	121526.46
4132.00	20.20	5.800	4124.80	77.50N	3.06W	7.80	77.52	2154270.94	121536.50
4164.00	22.90	5.700	4154.56	89.19N	1.88W	8.44	89.21	2154272.12	121548.20
4196.00	25.40	5.900	4183.75	102.22N	0.56W	7.82	102.22	2154273.44	121561.22
4228.00	28.00	4.600	4212.34	116.53N	0.75E	8.33	116.52	2154274.75	121575.54
4260.00	31.20	4.300	4240.16	132.29N	1.97E	10.01	132.27	2154275.97	121591.30
4291.00	34.10	3.300	4266.26	148.98N	3.07E	9.52	148.95	2154277.07	121607.99
4323.00	36.00	2.500	4292.45	167.33N	4.00E	6.11	167.29	2154278.00	121626.34
4355.00	37.20	2.300	4318.14	186.39N	4.80E	3.77	186.35	2154278.80	121645.40
4386.00	39.30	1.700	4342.49	205.57N	5.47E	6.88	205.52	2154279.47	121664.58
4418.00	41.60	1.900	4366.84	226.32N	6.12E	7.20	226.27	2154280.12	121685.33
4450.00	43.80	1.300	4390.35	248.01N	6.72E	6.99	247.95	2154280.72	121707.03
4481.00	45.60	0.600	4412.39	269.81N	7.08E	6.02	269.75	2154281.08	121728.83
4513.00	48.40	359.100	4434.21	293.21N	7.01E	9.40	293.15	2154281.01	121752.23
4545.00	50.00	358.100	4455.12	317.43N	6.42E	5.53	317.37	2154280.42	121776.45
4577.00	49.80	357.600	4475.73	341.89N	5.50E	1.35	341.83	2154279.50	121800.91
4608.00	49.50	357.200	4495.80	365.49N	4.43E	1.38	365.44	2154278.43	121824.51
4640.00	48.90	356.900	4516.71	389.68N	3.18E	2.00	389.64	2154277.18	121848.70
4672.00	48.00	356.300	4537.94	413.58N	1.76E	3.14	413.56	2154275.76	121872.61
4704.00	47.00	355.700	4559.55	437.12N	0.12E	3.42	437.11	2154274.12	121896.15
4736.00	47.10	355.500	4581.36	460.47N	1.68W	0.55	460.47	2154272.32	121919.50
4769.00	48.90	356.800	4602.10	483.46N	3.22W	6.59	483.47	2154270.78	121942.49
4797.00	51.40	358.300	4622.60	508.00N	4.26W	8.60	508.02	2154269.74	121967.03
4831.00	54.70	358.800	4641.84	533.56N	4.91W	10.39	533.58	2154269.09	121992.59
4863.00	57.90	0.600	4659.59	560.18N	5.04W	11.04	560.20	2154268.96	122019.21
4894.00	61.90	359.600	4675.14	586.99N	5.00W	13.20	587.01	2154269.00	122046.03
4926.00	65.60	0.400	4689.29	615.69N	5.00W	11.78	615.71	2154269.00	122074.72
4958.00	69.50	1.000	4701.50	645.25N	4.63W	12.31	645.27	2154269.37	122104.29
4990.00	73.70	2.000	4711.60	675.60N	3.83W	13.46	675.61	2154270.17	122134.64
5022.00	77.60	2.200	4719.53	706.57N	2.70W	12.20	706.57	2154271.30	122165.62
5053.00	81.50	1.900	4725.15	737.03N	1.61W	12.62	737.02	2154272.39	122196.08
5085.00	85.70	1.600	4728.72	768.81N	0.64W	13.16	768.79	2154273.36	122227.86
5094.00	87.00	1.500	4729.29	777.79N	0.39W	14.49	777.77	2154273.61	122236.84
5178.00	91.70	1.400	4730.25	861.73N	1.73E	5.60	861.70	2154275.73	122320.79
5210.00	92.00	1.200	4729.21	893.71N	2.46E	1.13	893.66	2154276.46	122352.76
5242.00	92.10	1.400	4728.07	925.68N	3.18E	0.70	925.63	2154277.18	122384.74
5274.00	92.30	0.400	4726.84	957.65N	3.68E	3.18	957.60	2154277.68	122416.71
5306.00	92.50	0.500	4725.50	989.62N	3.94E	0.70	989.56	2154277.94	122448.68
5338.00	92.20	359.600	4724.19	1021.60N	3.96E	2.96	1021.54	2154277.96	122480.66
5370.00	92.10	359.200	4722.99	1053.57N	3.63E	1.29	1053.51	2154277.63	122512.64
5402.00	92.40	358.700	4721.73	1085.54N	3.04E	1.82	1085.49	2154277.04	122544.61
5434.00	92.40	358.000	4720.39	1117.50N	2.12E	2.19	1117.45	2154276.12	122576.57
5466.00	92.00	357.700	4719.16	1149.45N	0.92E	1.56	1149.41	2154274.92	122608.52
5498.00	91.90	357.400	4718.07	1181.41N	0.45W	0.99	1181.38	2154273.55	122640.48
5530.00	91.90	357.300	4717.01	1213.35N	1.92W	0.31	1213.33	2154272.08	122672.43
5562.00	91.80	357.600	4715.98	1245.31N	3.35W	0.99	1245.30	2154270.65	122704.38
5594.00	91.50	357.100	4715.06	1277.26N	4.83W	1.82	1277.26	2154269.17	122736.34
5626.00	90.90	357.100	4714.39	1309.21N	6.44W	1.88	1309.22	2154267.56	122768.29
5658.00	90.00	357.200	4714.14	1341.17N	8.04W	2.83	1341.19	2154265.96	122800.25

All data is in Feet unless otherwise stated
 Coordinates are from Slot MD's are from Slot and TVD's are from Slot (Green 1-16H 0.00ft above Mean Sea Level)
 Vertical Section is from 0.00N 0.00E on azimuth 359.560 degrees
 Bottom hole distance is 4845.23 Feet on azimuth 359.52 degrees from Wellhead
 Calculation method uses Minimum Curvature method
 Prepared by
 Date Printed: 31-Aug-2011



Standard Wellpath Report
Sandridge
Sec 16 - 35S - 6W, Kansas
Harper County
Wellbore: Green 1-16H (Actual)

Wellpath (Grid) Report

MD[ft]	Inc[deg]	Azi[deg]	TVD[ft]	North[ft]	East[ft]	Dogleg [deg/100ft]	Vertical Section[ft]	Easting	Northing
5689.00	90.20	356.900	4714.08	1372.13N	9.63W	1.16	1372.16	2154264.37	122831.21
5721.00	90.20	356.600	4713.97	1404.08N	11.45W	0.94	1404.12	2154262.55	122863.16
5753.00	90.00	356.500	4713.91	1436.02N	13.37W	0.70	1436.08	2154260.63	122895.11
5785.00	89.60	357.300	4714.03	1467.97N	15.10W	2.80	1468.04	2154258.90	122927.06
5817.00	89.50	357.000	4714.28	1499.93N	16.69W	0.99	1500.01	2154257.31	122959.02
5849.00	89.20	357.300	4714.64	1531.89N	18.28W	1.33	1531.98	2154255.72	122990.98
5881.00	89.30	358.000	4715.06	1563.86N	19.60W	2.21	1563.96	2154254.40	123022.96
5913.00	89.30	358.700	4715.45	1595.84N	20.52W	2.19	1595.95	2154253.48	123054.94
5945.00	89.40	359.500	4715.81	1627.84N	21.02W	2.52	1627.95	2154252.98	123086.94
5977.00	89.50	359.200	4716.12	1659.83N	21.38W	0.99	1659.95	2154252.62	123118.94
6009.00	89.30	359.200	4716.46	1691.83N	21.83W	0.63	1691.95	2154252.17	123150.93
6041.00	89.10	0.100	4716.90	1723.82N	22.02W	2.88	1723.94	2154251.97	123182.93
6073.00	89.10	0.300	4717.41	1755.82N	21.91W	0.62	1755.94	2154252.09	123214.93
6104.00	89.30	0.400	4717.84	1786.82N	21.72W	0.72	1786.93	2154252.28	123245.93
6136.00	89.50	0.400	4718.17	1818.81N	21.50W	0.63	1818.93	2154252.50	123277.93
6169.00	89.60	0.500	4718.43	1851.81N	21.24W	0.43	1851.92	2154252.76	123310.93
6200.00	89.90	0.400	4718.57	1882.81N	21.00W	1.02	1882.92	2154253.00	123341.93
6232.00	90.00	0.400	4718.60	1914.81N	20.77W	0.31	1914.91	2154253.22	123373.93
6264.00	90.60	0.200	4718.43	1946.81N	20.61W	1.98	1946.91	2154253.39	123405.93
6296.00	90.60	0.600	4718.09	1978.81N	20.38W	1.25	1978.90	2154253.62	123437.93
6328.00	89.60	1.400	4718.04	2010.80N	19.82W	4.00	2010.89	2154254.17	123469.92
6360.00	89.40	1.800	4718.32	2042.79N	18.93W	1.40	2042.87	2154255.07	123501.91
6392.00	89.60	1.700	4718.60	2074.77N	17.95W	0.70	2074.85	2154256.05	123533.90
6423.00	89.90	2.000	4718.73	2105.75N	16.95W	1.37	2105.82	2154257.05	123564.88
6455.00	90.10	1.900	4718.73	2137.74N	15.86W	0.70	2137.79	2154258.13	123596.87
6487.00	89.50	1.000	4718.84	2169.72N	15.05W	3.38	2169.78	2154258.94	123628.86
6519.00	89.60	0.700	4719.09	2201.72N	14.58W	0.99	2201.77	2154259.42	123660.86
6551.00	89.40	0.900	4719.37	2233.72N	14.13W	0.88	2233.76	2154259.87	123692.85
6583.00	89.60	1.100	4719.65	2265.71N	13.57W	0.88	2265.75	2154260.42	123724.85
6615.00	90.00	0.900	4719.76	2297.70N	13.02W	1.40	2297.74	2154260.98	123756.85
6647.00	90.60	0.200	4719.60	2329.70N	12.71W	2.88	2329.73	2154261.29	123788.85
6678.00	91.20	359.700	4719.11	2360.70N	12.74W	2.52	2360.73	2154261.26	123819.84
6710.00	90.80	359.700	4718.55	2392.69N	12.90W	1.25	2392.72	2154261.10	123851.84
6742.00	91.50	359.400	4717.91	2424.69N	13.15W	2.38	2424.71	2154260.84	123883.83
6774.00	91.20	359.800	4717.15	2456.68N	13.38W	1.56	2456.71	2154260.62	123915.83
6806.00	92.20	359.600	4716.21	2488.66N	13.55W	3.19	2488.69	2154260.45	123947.81
6838.00	91.60	359.700	4715.14	2520.64N	13.74W	1.90	2520.67	2154260.26	123979.80
6870.00	90.60	359.600	4714.53	2552.64N	13.94W	3.14	2552.67	2154260.06	124011.79
6902.00	91.20	359.700	4714.03	2584.63N	14.13W	1.90	2584.66	2154259.87	124043.79
6934.00	90.50	0.000	4713.55	2616.63N	14.22W	2.38	2616.66	2154259.78	124075.79
6966.00	90.20	0.000	4713.36	2648.63N	14.22W	0.94	2648.66	2154259.78	124107.79
6998.00	90.20	0.400	4713.25	2680.63N	14.10W	1.25	2680.66	2154259.90	124139.79
7030.00	92.20	0.000	4712.58	2712.62N	13.99W	6.37	2712.64	2154260.01	124171.78
7062.00	92.30	0.400	4711.32	2744.59N	13.88W	1.29	2744.62	2154260.12	124203.76
7094.00	90.20	0.600	4710.62	2776.58N	13.60W	6.59	2776.60	2154260.40	124235.75
7126.00	89.30	0.900	4710.76	2808.58N	13.18W	2.96	2808.60	2154260.82	124267.75
7158.00	88.70	0.500	4711.32	2840.57N	12.79W	2.25	2840.59	2154261.21	124299.74
7190.00	89.00	0.600	4711.96	2872.56N	12.48W	0.99	2872.57	2154261.51	124331.74
7222.00	90.00	0.200	4712.24	2904.56N	12.26W	3.37	2904.57	2154261.74	124363.74
7254.00	90.30	359.800	4712.16	2936.56N	12.26W	1.56	2936.57	2154261.74	124395.74
7286.00	90.50	359.800	4711.93	2968.56N	12.37W	0.62	2968.57	2154261.63	124427.74
7318.00	90.80	359.600	4711.57	3000.56N	12.54W	1.13	3000.56	2154261.46	124459.74
7350.00	91.10	359.400	4711.04	3032.55N	12.82W	1.13	3032.56	2154261.18	124491.74
7382.00	91.60	359.400	4710.29	3064.54N	13.15W	1.56	3064.55	2154260.84	124523.73
7414.00	91.90	359.800	4709.31	3096.52N	13.38W	1.56	3096.54	2154260.62	124555.71
7446.00	90.80	359.600	4708.56	3128.51N	13.55W	3.49	3128.53	2154260.45	124587.71
7478.00	90.90	359.300	4708.08	3160.51N	13.85W	0.99	3160.52	2154260.15	124619.70
7510.00	91.10	359.500	4707.52	3192.50N	14.19W	0.88	3192.52	2154259.81	124651.70
7541.00	90.10	359.100	4707.20	3223.50N	14.57W	3.47	3223.52	2154259.43	124682.70
7573.00	89.90	358.900	4707.20	3255.49N	15.12W	0.88	3255.51	2154258.87	124714.69
7606.00	89.90	358.900	4707.25	3288.49N	15.76W	==>	3288.51	2154258.24	124747.69
7637.00	90.00	358.800	4707.28	3319.48N	16.38W	0.46	3319.51	2154257.62	124778.68
7669.00	90.40	358.900	4707.17	3351.47N	17.02W	1.29	3351.51	2154256.98	124810.68
7701.00	90.20	358.900	4707.00	3383.47N	17.64W	0.62	3383.50	2154256.36	124842.68
7733.00	90.30	359.000	4706.86	3415.46N	18.22W	0.44	3415.50	2154255.78	124874.67
7765.00	90.40	358.700	4706.67	3447.45N	18.87W	0.99	3447.50	2154255.13	124906.67
7797.00	90.30	358.600	4706.47	3479.45N	19.62W	0.44	3479.49	2154254.38	124938.66
7829.00	90.30	358.400	4706.30	3511.43N	20.46W	0.62	3511.49	2154253.54	124970.65

All data is in Feet unless otherwise stated
Coordinates are from Slot MD's are from Slot and TVD's are from Slot (Green 1-16H 0.00ft above Mean Sea Level)
Vertical Section is from 0.00N 0.00E on azimuth 359.560 degrees
Bottom hole distance is 4845.23 Feet on azimuth 359.52 degrees from Wellhead
Calculation method uses Minimum Curvature method
Prepared by
Date Printed: 31-Aug-2011



Standard Wellpath Report
 Sandridge
 Sec 16 - 35S - 6W, Kansas
 Harper County
 Wellbore: Green 1-16H (Actual)

Wellpath (Grid) Report

MD[ft]	Inc[deg]	Azi[deg]	TVD[ft]	North[ft]	East[ft]	Dogleg [deg/100ft]	Vertical Section[ft]	Easting	Northing
7861.00	90.60	358.500	4706.05	3543.42N	21.32W	0.99	3543.48	2154252.68	125002.64
7893.00	91.10	358.800	4705.58	3575.41N	22.08W	1.82	3575.47	2154251.92	125034.63
7925.00	90.60	359.000	4705.10	3607.40N	22.69W	1.68	3607.47	2154251.31	125066.62
7957.00	90.70	358.600	4704.74	3639.39N	23.36W	1.29	3639.46	2154250.64	125098.61
7988.00	90.90	358.900	4704.31	3670.38N	24.04W	1.16	3670.46	2154249.96	125129.60
8020.00	91.20	358.800	4703.72	3702.37N	24.68W	0.99	3702.45	2154249.32	125161.59
8052.00	91.00	358.700	4703.11	3734.35N	25.38W	0.70	3734.44	2154248.62	125193.58
8084.00	91.10	358.600	4702.52	3766.34N	26.13W	0.44	3766.43	2154247.87	125225.57
8116.00	91.10	358.800	4701.91	3798.33N	26.86W	0.62	3798.42	2154247.14	125257.56
8148.00	91.90	358.600	4701.07	3830.31N	27.58W	2.58	3830.41	2154246.42	125289.54
8180.00	92.90	358.900	4699.73	3862.27N	28.28W	3.26	3862.37	2154245.72	125321.51
8212.00	92.00	359.200	4698.36	3894.24N	28.81W	2.96	3894.34	2154245.19	125353.48
8244.00	91.00	359.200	4697.52	3926.22N	29.26W	3.12	3926.33	2154244.74	125385.46
8276.00	89.90	359.000	4697.27	3958.22N	29.76W	3.49	3958.33	2154244.24	125417.46
8308.00	89.80	358.900	4697.36	3990.21N	30.35W	0.44	3990.33	2154243.65	125449.46
8340.00	89.90	358.700	4697.44	4022.20N	31.02W	0.70	4022.32	2154242.98	125481.45
8371.00	90.00	358.500	4697.47	4053.19N	31.77W	0.72	4053.32	2154242.22	125512.44
8403.00	90.20	358.500	4697.41	4085.18N	32.61W	0.63	4085.31	2154241.39	125544.43
8435.00	90.20	358.400	4697.30	4117.17N	33.48W	0.31	4117.31	2154240.52	125576.42
8467.00	90.30	358.500	4697.16	4149.16N	34.34W	0.44	4149.30	2154239.66	125608.41
8499.00	90.40	358.400	4696.96	4181.15N	35.21W	0.44	4181.29	2154238.79	125640.40
8531.00	90.50	358.500	4696.71	4213.13N	36.07W	0.44	4213.29	2154237.92	125672.39
8563.00	89.90	359.200	4696.60	4245.13N	36.72W	2.88	4245.28	2154237.28	125704.39
8595.00	90.00	359.200	4696.63	4277.12N	37.16W	0.31	4277.28	2154236.84	125736.39
8627.00	90.20	359.000	4696.57	4309.12N	37.66W	0.88	4309.28	2154236.33	125768.38
8659.00	90.10	359.300	4696.49	4341.12N	38.14W	0.99	4341.28	2154235.86	125800.38
8691.00	90.20	359.600	4696.41	4373.11N	38.45W	0.99	4373.28	2154235.55	125832.38
8723.00	90.30	359.600	4696.27	4405.11N	38.67W	0.31	4405.28	2154235.33	125864.38
8755.00	90.60	359.500	4696.01	4437.11N	38.92W	0.99	4437.28	2154235.08	125896.38
8787.00	90.60	359.500	4695.68	4469.11N	39.20W	==>	4469.28	2154234.80	125928.38
8819.00	90.90	359.500	4695.26	4501.10N	39.48W	0.94	4501.27	2154234.52	125960.38
8882.00	90.70	359.500	4694.38	4564.10N	40.03W	0.32	4564.27	2154233.97	126023.38
8914.00	90.70	359.700	4693.99	4596.09N	40.25W	0.62	4596.27	2154233.74	126055.37
8978.00	91.10	0.000	4692.98	4660.08N	40.42W	0.78	4660.26	2154233.58	126119.37
9010.00	91.10	359.900	4692.37	4692.08N	40.45W	0.31	4692.25	2154233.55	126151.37
9074.00	91.00	359.800	4691.20	4756.07N	40.62W	0.22	4756.24	2154233.38	126215.36
9106.00	90.90	359.700	4690.67	4788.06N	40.76W	0.44	4788.23	2154233.24	126247.36
9116.00	91.10	359.900	4690.49	4798.06N	40.79W	2.83	4798.23	2154233.21	126257.36
9163.00	91.10	359.900	4689.59	4845.05N	40.87W	==>	4845.22	2154233.13	126304.35

All data is in Feet unless otherwise stated
 Coordinates are from Slot MD's are from Slot and TVD's are from Slot (Green 1-16H 0.00ft above Mean Sea Level)
 Vertical Section is from 0.00N 0.00E on azimuth 359.560 degrees
 Bottom hole distance is 4845.23 Feet on azimuth 359.52 degrees from Wellhead
 Calculation method uses Minimum Curvature method
 Prepared by
 Date Printed: 31-Aug-2011



Standard Wellpath Report
Sandridge
Sec 16 - 35S - 6W, Kansas
Harper County
Wellbore: Green 1-16H (Actual)

Comments

MD[ft]	TVD[ft]	North[ft]	East[ft]	Comment
9163.00	4689.59	4845.05N	40.87W	Projection to Bit at TD

All data is in Feet unless otherwise stated
Coordinates are from Slot MD's are from Slot and TVD's are from Slot (Green 1-16H 0.00ft above Mean Sea Level)
Vertical Section is from 0.00N 0.00E on azimuth 359.560 degrees
Bottom hole distance is 4845.23 Feet on azimuth 359.52 degrees from Wellhead
Calculation method uses Minimum Curvature method
Prepared by
Date Printed: 31-Aug-2011

Send To Printer

Back To MSR Maps

Change to 11x17 Print Size

Show Grid Lines

Change to Landscape

USGS 97 km SW of Wichita, Kansas, United States 01 Jul 1988

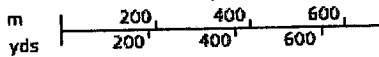
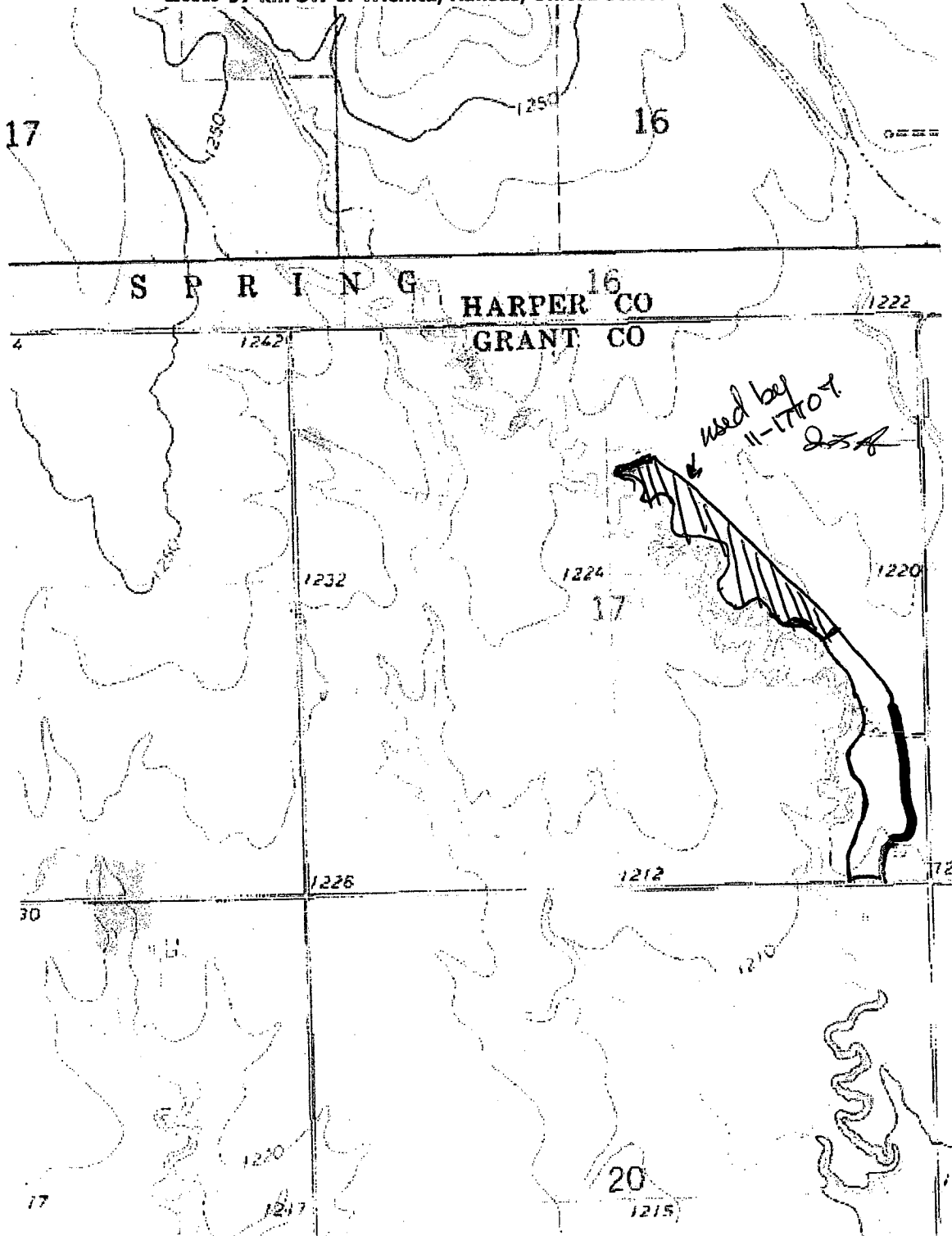

Image courtesy of the U.S. Geological Survey

© 2010 Microsoft Corporation. Terms of Use Privacy Statement