

FOR KCC USE:

FORM C-1 7/91

EFFECTIVE DATE: 1-10-99

FORM MUST BE TYPED

DISTRICT # 1

State of Kansas  
NOTICE OF INTENTION TO DRILL

FORM MUST BE SIGNED

SEAT Yes No

Must be approved by the K.C.C. five (5) days prior to commencing well

ALL BLANKS MUST BE FILLED

Expected Spud Date 1 20 99 Spot W22 SW Sec 8 Twp 20 S. Rg 39 East  
month day year

OPERATOR: License # 7271  
Name: Bartling Oil Co.  
Address: 5910 Courtyard Dr. Suite 255  
City/State/Zip: Austin, Tx 78731  
Contact Person: Tab Bartling  
Phone: 512-795-9597

1320 feet from South North line of Section  
660 feet from East West line of Section  
IS SECTION X REGULAR IRREGULAR

(NOTE: Locate well on the Section Plat on Reverse Side)  
County: Greeley  
Lease Name: Watson Farms Well #: 3  
Field Name: Bradshaw

CONTRACTOR: License #: ADVISS ON ACO-1  
Name: NA

Is this a Prorated/Spaced Field? yes X no  
Target Formation(s): Upper Winfield  
Nearest lease or unit boundary: 660

Well Drilled For: Well Class: Type Equipment:  
Oil Enh Rec X Infield X Mud Rotary  
X Gas Storage Pool Ext Air Rotary  
OWMO Disposal Wildcat Cable  
Seismic: # of Holes X Other

Ground Surface Elevation: 3529.4 feet MSL  
Water well within one-quarter mile: yes X no  
Public water supply well within one mile: yes X no  
Depth to bottom of fresh water: 220

If OWMO: old well information as follows:  
Operator:  
Well Name:  
Comp. Date: Old Total Depth

Depth to bottom of usable water: 1200  
Surface Pipe by Alternate: 1 X 2  
Length of Surface Pipe Planned to be set: 250  
Length of Conductor pipe required: None

Directional, Deviated or Horizontal wellbore? yes X no  
If yes, true vertical depth:  
Bottom Hole Location:

Projected Total Depth: 2950  
Formation at Total Depth: Lower Fort Riley  
Water Source for Drilling Operations:  
well farm pond X other

AFFIDAVIT

The undersigned hereby affirms that the drilling, completion and eventual plugging of this well will comply with K.S.A. 55-101, et. seq.  
It is agreed that the following minimum requirements will be met:

- 1. Notify the appropriate district office prior to spudding of well;
- 2. A copy of the approved notice of intent to drill shall be posted on each drilling rig;
- 3. The minimum amount of surface pipe as specified below shall be set by circulating cement to the top; in all cases surface pipe shall be set through all unconsolidated materials plus a minimum of 20 feet into the underlying formation;
- 4. If the well is dry hole, an agreement between the operator and the district office on plug length and placement is necessary prior to plugging;
- 5. The appropriate district office will be notified before well is either plugged or production casing is cemented in;
- 6. IF AN ALTERNATE II COMPLETION, PRODUCTION PIPE SHALL BE CEMENTED FROM BELOW ANY USABLE WATER TO SURFACE WITHIN 120 DAYS OF SPUD DATE. IN ALL CASES, NOTIFY DISTRICT OFFICE PRIOR TO ANY CEMENTING.

I hereby certify that the statements made herein are true and to the best of my knowledge and belief.  
Date: 12-31-98 Signature of Operator or Agent: Terry Maxwell Title: Consultant

FOR KCC USE:  
API # 15- 071-207010000  
Conductor pipe required NONE feet  
Minimum surface pipe required 240 feet per Alt. X(2)  
Approved by: JK 12-31-98  
This authorization expires: 7-5-99  
(This authorization void if drilling not started within 6 months of effective date.)  
Spud date: Agent:

RECEIVED  
STATE OF KANSAS COMMISSION  
JAN - 5 1999  
01-05-99  
CONSERVATION DIVISION  
Wichita, Kansas

- REMEMBER TO:
- File Drill Pit Application (form CDP-1) with Intent to Drill;
  - File Completion Form ACO-1 within 120 days of spud date;
  - File acreage attribution plat according to field proration orders;
  - Notify appropriate district office 48 hours prior to workover or re-entry;
  - Submit plugging report (CP-4) after plugging is completed;
  - Obtain written approval before disposing or injecting salt water.

Mail to: Conservation Division, 200 Colorado Derby Building, 202 W. First St., Wichita, Kansas 67202-1286.

IN ALL CASES PLOT THE INTENDED WELL ON THE PLAT BELOW

**PLAT OF ACREAGE ATTRIBUTABLE TO A WELL IN A PRORATED OR SPACED FIELD**

If the intended well is in a prorated or spaced field, please fully complete this side of the form. If the intended well is in a prorated or spaced field complete the plat below showing that the well will be properly located in relationship to other wells producing from the common source of supply. Please show all the wells within 1 mile of the boundaries of the proposed acreage attribution unit for gas wells and within 1/2 mile of the boundaries of the proposed acreage attribution unit for oil wells.

API NO. 15-071-  
 OPERATOR Bartling Oil Co.  
 LEASE Watson Farms  
 WELL NUMBER 3  
 FIELD Bradshaw

LOCATION OF WELL: COUNTY Greeley  
1320 feet from south/north line of section  
660 feet from east/west line of section  
 SECTION 8 TWP 20S RG 39W

NUMBER OF ACRES ATTRIBUTABLE TO WELL 640  
 QTR/QTR/QTR OF ACREAGE \_\_\_\_\_

IS SECTION X REGULAR or IRREGULAR  
IF SECTION IS IRREGULAR, LOCATE WELL FROM NEAREST CORNER BOUNDARY.

Section corner used: NE NW SE X SW

**PLAT**

(Show location of the well and shade attributable acreage for prorated or spaced wells.)  
 (Show footage to the nearest lease or unit boundary line.)

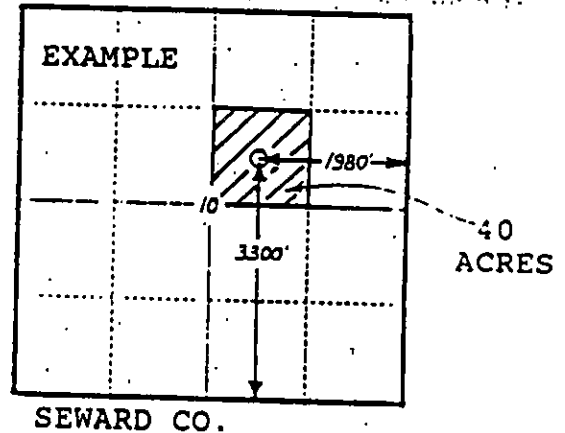
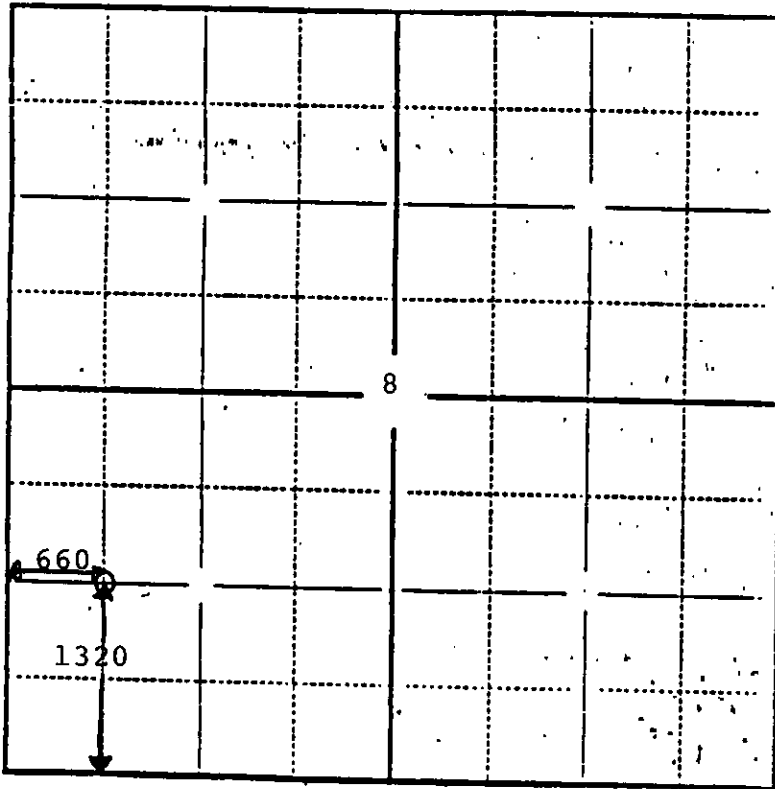

In plotting the proposed location of the well, you must show:

- 1) The manner in which you are using the depicted plat by identifying section lines, i.e. 1 section, 1 section with 8 surrounding sections, 4 sections, etc.;
- 2) the distance of the proposed drilling location from the section's south/north and east/west lines; and
- 3) the distance to the nearest lease or unit boundary line.



*Kansas Corporation Commission*

*Bill Graves, Governor John Wine, Chair Cynthia L. Claus, Commissioner Brian J. Moline, Commissioner*

**REQUEST FOR INFORMATION**

March 14, 2002

Bartling Oil Company -- KCC License # 7271  
5910 Courtyard Dr #255  
Austin, TX 78731

RE: API Well No. 15-071-20701-00-00  
WATSON FARMS 3  
W2SW, 8-20S-39W  
GREELEY County, Kansas

Dear Operator:

According to KCC records, the Intent to Drill approved by the KCC Conservation Division on January 05, 1999, for the well listed above, has expired. The KCC has not received a spud call or an ACO-1 Completion Report on this well.

If drilling operations on the well never commenced, please check, sign and date below and return this letter to the KCC Wichita office in the enclosed return envelope.

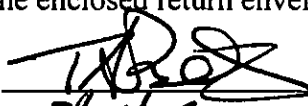
Well not drilled: Signature   
Date: 3/21/02

If the well has been drilled, please submit the required ACO-1 Completion Report with all attachments for this well along with a copy of this letter to the KCC Wichita office.

**In either case please provide the requested information within 30 days from the date of this letter. Pursuant to K.A.R. 82-3-128, failure to respond to this letter with the requested information may result in assessment of a monetary penalty of \$100.00. Failure to file the ACO-1 form, if applicable, may result in assessment of a monetary penalty of \$500.00.**

We appreciate your cooperation in this matter. If you have any questions, please contact me at (316) 337-6200.

Very truly yours,

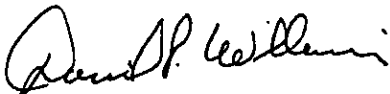
  
Supervisor  
Production Department

RECEIVED  
MAR 20 2002  
KCC WICHITA