

ORIGINAL

5/1/90 RELEASED

SIDE ONE

SEP 24 1990

STATE CORPORATION COMMISSION OF KANSAS
OIL & GAS CONSERVATION DIVISION
WELL COMPLETION OR RECOMPLETION FORM
ACO-1 WELL HISTORY
DESCRIPTION OF WELL AND LEASE

API NO. 15-.....203-20,089-00-00
County.....Wichita.....FROM CONFIDENTIAL
N/2 SE NW Sec. 32 Twp. 20 Rge. 38 East
..... West

Operator: License # 4767
Name Ritchie Exploration, Inc
Address 125 N. Market, Suite 1000
City/State/Zip Wichita, KS, 67202

.....3630... Ft North from Southeast Corner of Section
.....3300... Ft West from Southeast Corner of Section
(Note: Locate well in section plat below)

Purchaser.....N/A.....

Lease Name...Daisy Darbro.....Well #...1.....
Field Name.....

Operator Contact Person Rocky Milford
Phone 316/267-4375

Producing Formation.....n/a.....
Elevation: Ground...3434'.....KB...3439'.....

Contractor: License # 6033
Name Murfin Drilling Co

Wellsite Geologist Bob Mathiasen
Phone 316/267-4375

Section Plat

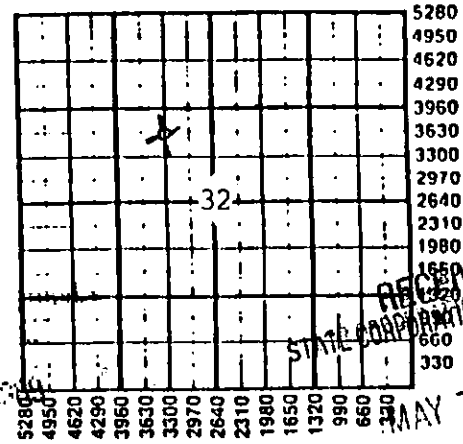

AUT II DIA

RECEIVED
STATE CORPORATION COMMISSION

MAY - 1 1989
OIL & GAS CONSERVATION DIVISION
Wichita, Kansas

Designate Type of Completion
 New Well Re-Entry Workover

 Oil SMD Temp Abd
 Gas Inj Delayed Comp.
 Dry Other (Core, Water Supply etc.)
If ONWO: old well info as follows:
Operator
Well Name
Comp. DateOld Total Depth.....

PLEASE KEEP THIS INFORMATION

WATER SUPPLY INFORMATION
Disposition of Produced Water: _____
Docket #n/a.....
_____ Repressuring

WELL HISTORY
Drilling Method:
 Mud Rotary Air Rotary Cable
.....1/20/89..... 1/29/89..... 1/29/89.....
Spud Date Date Reached TD Completion Date
.....5160'..... n/a.....
Total Depth PBTD
Amount of Surface Pipe Set and Cemented at 262 feet
Multiple Stage Cementing Collar Used? Yes No
If yes, show depth set.....feet
If alternate 2 completion, cement circulated from.....feet depth to.....w/.....SX cmt
Cement Company Name
Invoice #

Questions on this portion of the ACO-1 call:
Water Resources Board (913) 296-3717
Source of Water: Hauled.
Division of Water Resources Permit #.....
 Groundwater.....Ft North from Southeast Corner
(Well)Ft West from Southeast Corner of
Sec Twp Rge East West
 Surface Water.....Ft North from Southeast Corner
(Stream, pond etc).....Ft West from Southeast Corner
Sec Twp Rge East West
 Other (explain).....
(purchased from city, R.W.D. #)

INSTRUCTIONS: This form shall be completed in triplicate and filed with the Kansas Corporation Commission, 200 Colorado Derby Building, Wichita, Kansas 67202, within 120 days of the spud date of any well. Rule 82-3-130, 82-3-107 and 82-3-106 apply. Information on side two of this form will be held confidential for a period of 12 months if requested in writing and submitted with the form. See rule 82-3-107 for confidentiality in excess of 12 months. One copy of all wireline logs and drillers time log shall be attached with this form. Submit CP-4 form with all plugged wells. Submit CP-111 form with all temporarily abandoned wells.

All requirements of the statutes, rules and regulations promulgated to regulate the oil and gas industry have been fully complied with and the statements herein are complete and correct to the best of my knowledge.

Signature [Signature]
Title Vice President Date 4/24/89

Subscribed and sworn to before me this 24th day of April 1989.
Notary Public Linda K. Rice
Date Commission Expires 6/07/92



K.C.C. OFFICE USE ONLY
 Letter of Confidentiality Attached
 Wireline Log Received
 Drillers Time Log Received
Distribution
 ACC SMD/Rep NGPA
 KGS Plug Other
(Specify)

Sec 32 Twp. 20 Rge. 38 E

JAN 1990

Operator Name Ritchie Exploration, Inc. Lease Name Daisy Darbro Well # 1

Sec. 32 Twp. 20S Rge. 38W East West County Wichita RELEASED

WELL LOG

SEP 24 1990

INSTRUCTIONS: Show important tops and base of formations penetrated. Detail all cores. Report tests giving interval tested, time tool open and closed, flowing and shut-in pressures, whether shut-in pressure reached static level, hydrostatic pressures, bottom hole temperature, fluid recovery, and flow rates if gas to surface during test. Attach extra sheet if more space is needed. Attach copy of log.

FROM CONFIDENTIAL

Drill Stem Tests Taken [X] Yes [] No
Samples Sent to Geological Survey [X] Yes [] No
Cores Taken [] Yes [X] No

Formation Description [X] Log [] Sample

Name Top Bottom

DST #1 3011'-3105' (Council Grove). Rec. 60' of mud, gassy on top.
IFP: 74-74#/45"; ISIP: 752#/45";
FFP: 85-85#/45"; FSIP: 689#/45".

Table with 3 columns: Name, Top, Bottom. Rows include Anhydrite, B/Anhydrite, Herington, Council Grove, Heebner, Lansig, Marmaton, Cherokee, Morrow, Mississippi, LTD.

DST #2 4950'-5004' (Morrow Upper sand). Rec. 20' of mud, no show of oil.
IFP: 53-53#/30"; ISIP: 446#/30";
FFP: 64-64#/30"; FSIP: 340#/30".

PLEASE KEEP THIS INFORMATION CONFIDENTIAL

Form sections: CASING RECORD, PERFORATION RECORD, TUBING RECORD, Date of First Production, Producing Method, Estimated Production Per 24 Hours.

METHOD OF COMPLETION

Production Interval

Disposition of gas: [] Vented [] Sold [] Used on Lease [] Open Hole [] Other (Specify) [] Perforation [] Dually Completed [] Conmingled

Phone 913-483-2627, Russell, Kansas
 Phone 316-793-5861, Great Bend, Kansas

ORIGINAL

Phone Plainville 913-434-2812
 Phone Ness City 913-798-3843

ALLIED CEMENTING CO., INC.

N^o 3163

Home Office P. O. Box 31

Russell, Kansas 67665

New

Date	1-29-89	Sec.	32	Twp.	20	Range	38	Called Out	2:30 PM	On Location	6:00 PM	Job Start	7:45 PM	Finish	10:00 PM
Lease	Dairy Dealer		Well No. #	1		Location	Belkirk 1.39 1/2 W.		Wichita	Country	Kans		State		
Contractor	Maurin Drilling														
Type Job	Rotary Plug														
Hole Size	7 7/8					T.D. 5160'									
Csg.	Depth														
Tbg. Size	Depth														
Drill Pipe	4 1/2 XH					Depth 2385'									
Tool	Depth														
Cement Left in Csg.	Shoe Joint														
Press Max.	Minimum														
Meas Line	Displace														
Perf.															

Owner: Same
 To Allied Cementing Co., Inc.
 You are hereby requested to rent cementing equipment and furnish cementer and helper to assist owner or contractor to do work as listed.

Charge To: Ritchie Exploration Inc
 Street: 125 N. Market Suite 1000
 City: Wichita State: Ks 67202
 The above was done to satisfaction and supervision of owner agent or contractor

Purchase Order No. X
 [Signature]
CEMENT

Ness City

EQUIPMENT		
No.	Cementer	[Signature]
# 158	Helper	[Signature]
No.	Cementer	
Pumptrk	Helper	[Signature]
	Driver	
# 69	Driver	[Signature]

DEPTH of Job		
Reference:	Pump truck charge	450.00
100	Mileage	100.00
	1-8" hole plug	20.00
	Sub Total	
	Tax	
	Total	570.00

Remarks:

50 mx - 2385'
 80 mx - 1410'
 50 mx - 790'
 50 mx - 290'
 10 mx - 40'
 15 mx RH 10 mx MH

Thank you.

Amount Ordered	265 mx 60/40 670 gel	
Consisting of		
Common	159	5.00 795.00
Poz. Mix	106	2.25 238.50
Gel.	16	6.75 108.00
Chloride		
Quickset		
	Sales Tax	
Handling	265 FEB 03 1989	.90 238.50
Mileage	100	795.00
	Sub Total	
	Total	2175.00
Floating Equipment		
Total	\$ 2745.00	
Less Disc.	- 549.00	
	\$ 2196.00	