

FOR KCC USE:

FORM C-1 7/91

EFFECTIVE DATE: 4-7-93

State of Kansas

15-203-20099-0000

FORM MUST BE TYPED

DISTRICT #

NOTICE OF INTENTION TO DRILL

FORM MUST BE SIGNED

SEAT Yes No

Must be approved by the K.C.C. five (5) days prior to commencing well

ALL SPACES MUST BE FILLED

Expected Spud Date 4 5 93 150 SE of SE:SE Sec 16 Twp 17 S. Rg 37 East West

OPERATOR: License # 5316 Name: Falcon Exploration Inc. Address: 155 N. Market, Suite 1010 City/State/Zip: Wichita, KS 67202 Contact Person: Jim Thatcher Phone: (316) 265-3351

550 feet from South North line of Section 550 feet from East West line of Section IS SECTION X REGULAR IRREGULAR? County: Wichita Lease Name: Kalbach Well #: 1 Field Name: wildcat

CONTRACTOR: License #: 30684 Name: Abercrombie Drilling Co.

(NOTE: Locate well on the Section Plat on Reverse Side) Is this a Prorated/Spaced Field? yes X no Target Formation(s): Mississippi Nearest lease or unit boundary: 550 Ground Surface Elevation: est. 3350 feet MSL Water well within one-quarter mile: yes X no Public water supply well within one mile: yes X no Depth to bottom of fresh water: 200 Depth to bottom of usable water: 1350 1600 Surface Pipe by Alternate: 1 X 2 Length of Surface Pipe Planned to be set: (600) 250 Length of Conductor pipe required: none Projected Total Depth: 4950 Formation at Total Depth: Mississippi Water Source for Drilling Operations: well farm pond X other

Well Drilled For: Well Class: Type Equipment: X Oil Enh Rec Infield X Mud Rotary Gas Storage Pool Ext. Air Rotary OWD Disposal X Wildcat Cable Seismic: # of Holes Other If OWD: old well information as follows: Operator: Well Name: Comp. Date: Old Total Depth

Directional, Deviated or Horizontal wellbore? yes X no If yes, true vertical depth: Bottom Hole Location:

AFFIDAVIT

The undersigned hereby affirms that the drilling, completion and eventual plugging of this well will comply with K.S.A. 55-101, et. seq. It is agreed that the following minimum requirements will be met:

- 1. Notify the appropriate district office prior to spudding of well; 2. A copy of the approved notice of intent to drill shall be posted on each drilling rig; 3. The minimum amount of surface pipe as specified below shall be set by circulating cement to the top; in all cases surface pipe shall be set through all unconsolidated materials plus a minimum of 20 feet into the underlying formation; 4. If the well is dry hole, an agreement between the operator and the district office on plug length and placement is necessary prior to plugging; 5. The appropriate district office will be notified before well is either plugged or production casing is cemented in; 6. IF AN ALTERNATE II COMPLETION, PRODUCTION PIPE SHALL BE CEMENTED FROM BELOW ANY USABLE WATER TO SURFACE WITHIN 120 DAYS OF SPUD DATE. IN ALL CASES, NOTIFY DISTRICT OFFICE PRIOR TO ANY CEMENTING.

I hereby certify that the statements made herein are true and to the best of my knowledge and belief. Date: 4/1/93 Signature of Operator or Agent: Jim Thatcher Title: AGENT

FOR KCC USE: API # 15-203-20099-00-00 Conductor pipe required None feet Minimum surface pipe required 250 feet per Alt. X 2 Approved by: CR 4-2-93 This authorization expires: 10-2-93 (This authorization void if drilling not started within 6 months of effective date.) Spud date: Agent:

RECEIVED STATE CORPORATION COMMISSION APR 2 1993 CONSERVATION DIVISION Wichita, Kansas

REMEMBER TO:

- File Drill Pit Application (form CDP-1) with Intent to Drill; - File Completion Form ACO-1 within 120 days of spud date; - File acreage attribution plat according to field proration orders; - Notify appropriate district office 48 hours prior to workover or re-entry; - Submit plugging report (CP-4) after plugging is completed; - Obtain written approval before disposing or injecting salt water.

Mail to: Conservation Division, 200 Colorado Derby Building, 202 W. First St., Wichita, Kansas 67202-1286.

IN ALL CASES PLOT THE INTENDED WELL ON THE PLAT BELOW

PLAT OF ACREAGE ATTRIBUTABLE TO A WELL IN A PRORATED OR SPACED FIELD

If the intended well is in a prorated or spaced field, please fully complete this side of the form. If the intended well is in a prorated or spaced field complete the plat below showing that the well will be properly located in relationship to other wells producing from the common source of supply. Please show all the wells within 1 mile of the boundaries of the proposed acreage attribution unit for gas wells and within 1/2 mile of the boundaries of the proposed acreage attribution unit for oil wells.

API NO. 15- _____
 OPERATOR Falcon Exploration Inc. LOCATION OF WELL: COUNTY Wichita
 LEASE Kalbach _____ 550 feet from south/north line of section
 WELL NUMBER 1 _____ 550 feet from east/west line of section
 FIELD wildcat _____ SECTION 16 TWP 17S RG 37W

NUMBER OF ACRES ATTRIBUTABLE TO WELL _____ IS SECTION _____ REGULAR or _____ IRREGULAR
 QTR/QTR/QTR OF ACREAGE _____ IF SECTION IS IRREGULAR, LOCATE WELL FROM NEAREST
CORNER BOUNDARY.

Section corner used: _____ NE _____ NW _____ SE _____ SW
PLAT

(Show location of the well and shade attributable acreage for prorated or spaced wells.)
 (Show footage to the nearest lease or unit boundary line.)

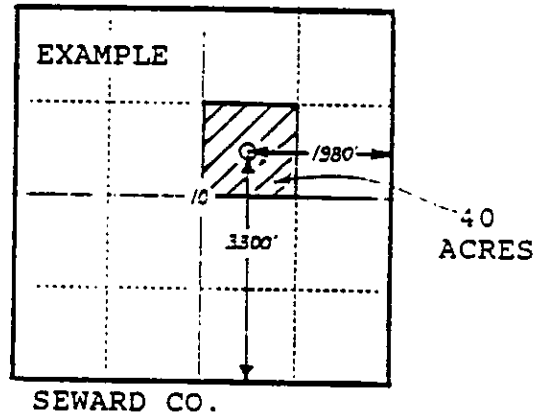
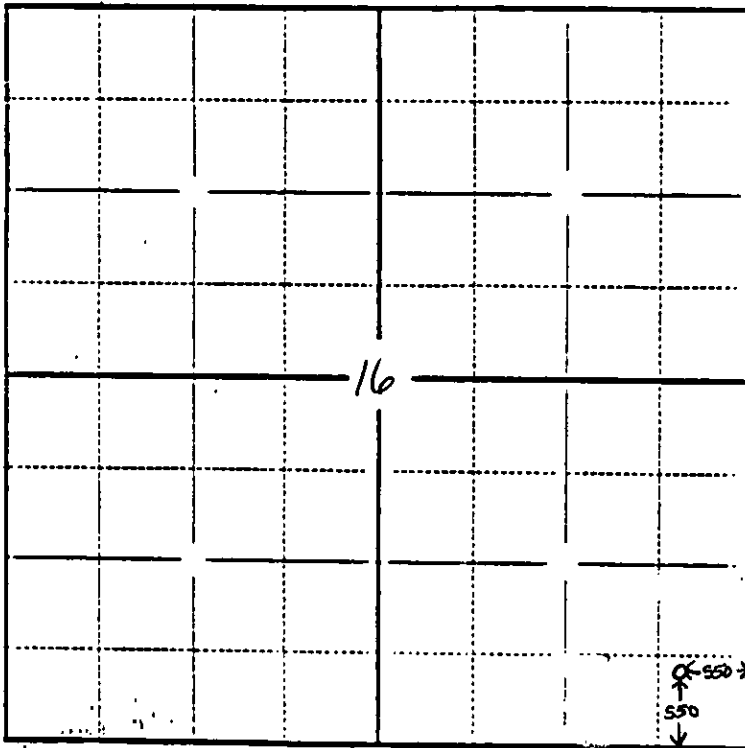

In plotting the proposed location of the well, you must show:

- 1) The manner in which you are using the depicted plat by identifying section lines, i.e. 1 section, 1 section with 8 surrounding sections, 4 sections, etc.;
- 2) the distance of the proposed drilling location from the section's south/north and east/west lines; and
- 3) the distance to the nearest lease or unit boundary line.