

EFFECTIVE DATE: 6-20-2000

State of Kansas

15-171-20552-0000

FORM MUST BE TYPED

DISTRICT # 1

NOTICE OF INTENTION TO DRILL

FORM MUST BE SIGNED

SGA? YES  No

Must be approved by the K.C.C. five (5) days prior to commencing well.

ALL BLANKS MUST BE FILLED

Expected Spud Date: July 15 2000  
Month Day Year

Spot 100' SE of East  
E2 NW SW Sec 15 Twp 19s Rng 33 X West

OPERATOR: License # 5003  
Name: McCoy Petroleum Corporation  
Address: 453 S. Webb Rd., Ste 310, P.O. Box 780208  
City/State/Zip: Wichita, KS 67278-0208  
Contact Person: Steve O'Neill  
Phone: (316)636-2737

1897 feet from South / North line of Section  
4207 feet from East / West line of Section  
IS SECTION  REGULAR  IRREGULAR?  
(NOTE: Locate well on the Section Plat on Reverse Side)

CONTRACTOR: License # 6039  
Name: LD Drilling, Inc.

County: Scott  
Lease Name: FEIERTAG "A" Well # 7-15  
Field Name: Millrich SE

Well Drilled For: Well Class: Type Equipment:  
Oil Enh Rec  Infield  Mud Rotary  
 Gas Storage Pool Ext. Air Rotary  
OWWO Disposal Wildcat Cable  
Seismic: # of Holes Other

Is this a Prorated/Spaced Field?  yes  no  
Target Formation(s): Krider  
Nearest lease or unit boundary: 1073'

If OWWO: old well information as follows:  
Operator:  
Well Name:  
Comp. Date: Old Total Depth

Ground Surface Elevation: 2960' feet MSL  
Water well within one-quarter mile:  yes  no  
Public water supply well within one mile:  yes  no

Directional, Deviated or Horizontal wellbore?  yes  no  
If yes, true vertical depth  
Bottom Hole Location

Depth to bottom of fresh water: 200'  
Depth to bottom of usable water: 1400' 180' 1300'  
Surface Pipe by Alternate: 1  2

Length of Surface Pipe Planned to be set: 240' +  
Length of Conductor Pipe required: none  
Projected Total Depth: 2800'

Formation at Total Depth: Chase  
Water Source for Drilling Operations:  
 well  farm pond  other

APPLY FOR FROM NWR

Will Cores Be Taken?:  yes  no  
If yes, proposed zone:

AFFIDAVIT

The undersigned hereby affirms that the drilling, completion and eventual plugging of this well will comply with K.S.A. 55-101, et. seq.

It is agreed that the following minimum requirements will be met:

1. Notify the appropriate district office prior to spudding of well;
2. A copy of the approved notice of intent to drill shall be posted on each drilling rig;
3. The minimum amount of surface pipe as specified below shall be set by circulating cement to the top; in all cases surface pipe shall be set through all unconsolidated materials plus a minimum of 20 feet into the underlying formation;
4. If the well is dry hole, an agreement between the operator and the district office on plug length and placement is necessary prior to plugging;
5. The appropriate district office will be notified before well is either plugged or production casing is cemented in;
6. IF AN ALTERNATE II COMPLETION, PRODUCTION PIPE SHALL BE CEMENTED FROM BELOW ANY USABLE WATER TO SURFACE WITHIN 120 DAYS OF SPUD DATE. IN ALL CASES, NOTIFY DISTRICT OFFICE PRIOR TO ANY CEMENTING

I hereby certify that the statements made herein are true and to the best of my knowledge and belief.

Date: 6/8/00 Signature of Operator or Agent: Cory N. Baker Title: Geologist

FOR KCC USE:  
 API # 15- 171-20552 0000  
 Conductor pipe required NONE feet  
 Minimum surface pipe required 200 feet per Alt.  (2)  
 Approved by: JK 6-15-2000  
 This authorization expires: 12-15-2000  
 (This authorization void if drilling not started within 6 months of effective date.)  
 Spud date: \_\_\_\_\_ Agent: \_\_\_\_\_

RECEIVED  
STATE CORPORATION COMMISSION

JUN 9 2000

CONSERVATION DIVISION  
Wichita, Kansas

REMEMBER TO:

- File Drill Pit Application (form CDP-1) with Intent to Drill;
- File Completion Form ACO-1 within 120 days of spud date;
- File acreage attribution plat according to field prorations orders;
- Notify appropriate district office 48 hours prior to workover or re-entry;
- Submit plugging report (CP-4) after plugging is completed;
- Obtain written approval before disposing or injecting salt water.

Mail to: KCC - Conservation Division, 130 S. Market - Room 2078, Wichita, Kansas 67202.

15  
19  
33W

IN ALL CASES PLOT THE INTENDED WELL ON THE PLAT BELOW

PLAT OF ACREAGE ATTRIBUTABLE TO A WELL IN A PRORATED OR SPACED FIELD

If the intended well is in a prorated or spaced field, please fully complete this side of the form. If the intended well is in a prorated or spaced field complete the plat below showing that the well will be properly located in relationship to other wells producing from the common source of supply. Please show all the wells within 1 mile of the boundaries of the proposed acreage attribution unit for gas wells and within 1/2 mile of the boundaries of the proposed acreage attribution unit for oil wells.

API NO. 15- \_\_\_\_\_  
 OPERATOR McCoy Petroleum Corporation LOCATION OF WELL: COUNTY Scott  
 LEASE FEIERTAG "A" 1897 feet from south / north line of section  
 WELL NUMBER 7-15 4207 feet from east / west line of section  
 FIELD Millrich SE SECTION 15 TWP 19s RG 33w

NUMBER OF ACRES ATTRIBUTABLE TO WELL 40 IS SECTION X REGULAR or \_\_\_\_\_ IRREGULAR  
 QTR/QTR/QTR OF ACREAGE \_\_\_\_\_ NW SW IF SECTION IS IRREGULAR, LOCATE WELL FROM NEAREST CORNER BOUNDARY.

Section corner used: \_\_\_\_\_ NE \_\_\_\_\_ NW \_\_\_\_\_ SE \_\_\_\_\_ SW

PLAT

(Show location of the well and shade attributable acreage for prorated or spaced wells.)  
 (Show footage to the nearest lease or unit boundary line.)

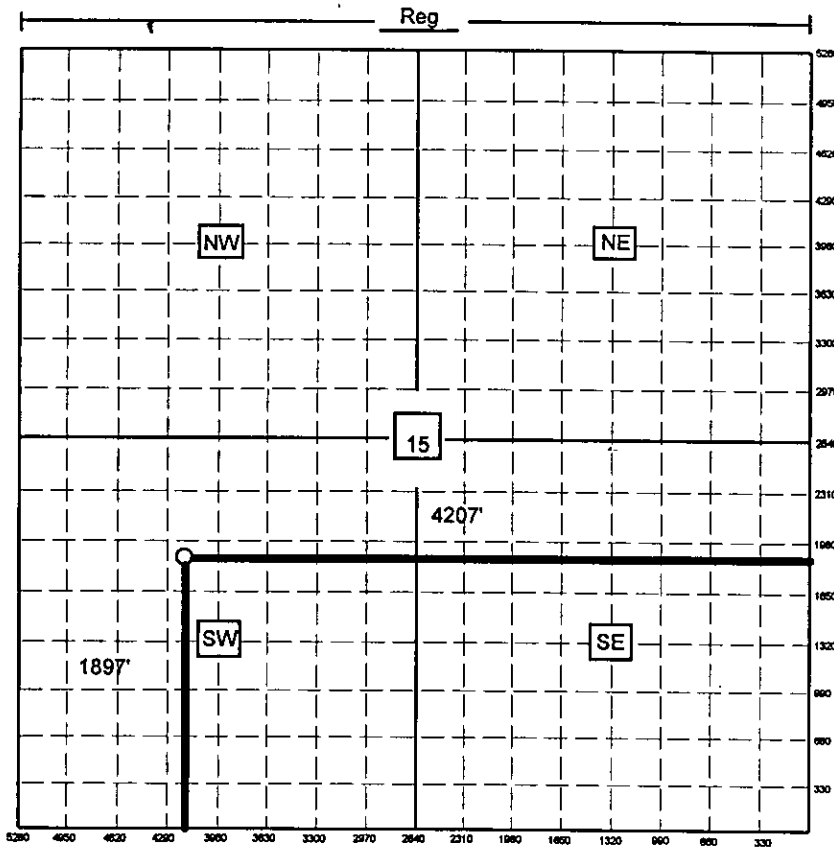

FEIERTAG "A" #7-15  
100' SE of E/2 NW SW  
Sec. 15-19s-33w  
Scott County, KS

RECEIVED  
 STATE CORPORATION COMMISSION

JUN 9 2000

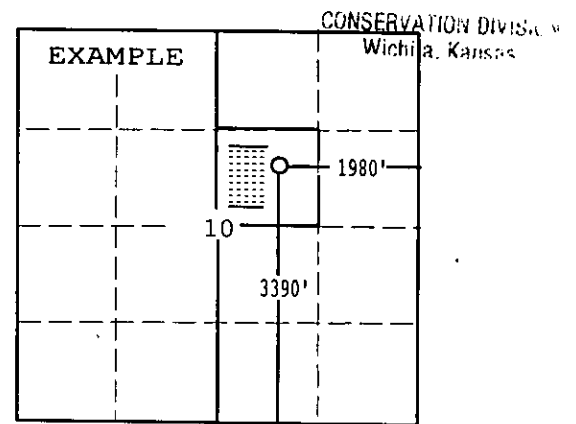

SEWARD CO.

In plotting the proposed location of the well, you must show:

- 1) The manner in which you are using the depicted plat by identifying section lines, i.e. 1 section, 1 section with 8 surrounding sections, 4 sections, etc.;
- 2) the distance of the proposed drilling location from the section's south/north and east/west; and
- 3) the distance to the nearest lease or unit boundary line.