

FOR KCC USE:

FORM C-1 7/91

EFFECTIVE DATE: 5-10-94

State of Kansas 15-171-20465-0000

FORM MUST BE TYPED  
FORM MUST BE SIGNED  
ALL BLANKS MUST BE FILLED

DISTRICT #  
SGAT... Yes  No

NOTICE OF INTENTION TO DRILL

Must be approved by the K.C.C. five (5) days prior to commencing well

Expected Spud Date May 11 1994  
month day year

Spot SW NW SE Sec 15 Top 19 S. Rg 33 East West

OPERATOR: License # 5003  
Name: McCoy Petroleum Corporation  
Address: 3017 N. Cypress  
City/State/Zip: Wichita, KS 67225-4003  
Contact Person: Robert O'Dell  
Phone: (316) 636-2737

1650 feet from South-North line of Section  
2310 feet from East-West line of Section  
IS SECTION  REGULAR  IRREGULAR?

CONTRACTOR: License # 5658  
Name: Sweetman Drilling, Inc.

(NOTE: Locate well on the Section Plat on Reverse Side)  
County: Scott

Well Drilled For: Well Class: Type Equipment:  
.X. Oil ... Enh Rec ... Infield .X. Mud Rotary  
... Gas ... Storage .X. Pool Ext. ... Air Rotary  
... OAWD ... Disposal ... Wildcat ... Cable  
... Seismic: ... # of Holes ... Other  
... Other

Lease Name: Haupt "A" Well #: 1-15  
Field Name: Hugoton North

If OAWD: old well information as follows:

Is this a Prorated/Spaced Field? ... yes  no   
Target Formation(s): Marmaton

Operator: \_\_\_\_\_  
Well Name: \_\_\_\_\_  
Comp. Date: \_\_\_\_\_ Old Total Depth \_\_\_\_\_

Nearest lease or unit boundary: 330'  
Ground Surface Elevation: 2960 est. feet MSL

Directional, Deviated or Horizontal wellbore? ... yes  no  
If yes, true vertical depth: \_\_\_\_\_  
Bottom Hole Location: \_\_\_\_\_

Water well within one-quarter mile: .X. yes ... no   
Public water supply well within one mile: ... yes  no

AFFIDAVIT \*\* Water given by Chris Bean

The undersigned hereby affirms that the drilling, completion and eventual plugging of this well will comply with K.S.A. 55-101, et. seq.

It is agreed that the following minimum requirements will be met:

1. Notify the appropriate district office prior to spudding of well;
2. A copy of the approved notice of intent to drill shall be posted on each drilling rig;
3. The minimum amount of surface pipe as specified below shall be set by circulating cement to the top; in all cases surface pipe shall be set through all unconsolidated materials plus a minimum of 20 feet into the underlying formation;
4. If the well is dry hole, an agreement between the operator and the district office on plug length and placement is necessary prior to plugging;
5. The appropriate district office will be notified before well is either plugged or production casing is cemented in;
6. IF AN ALTERNATE II COMPLETION, PRODUCTION PIPE SHALL BE CEMENTED FROM BELOW ANY USABLE WATER TO SURFACE WITHIN 120 DAYS OF SPUD DATE. IN ALL CASES, NOTIFY DISTRICT OFFICE PRIOR TO ANY CEMENTING.

I hereby certify that the statements made herein are true and to the best of my knowledge and belief.

Date: 5-4-94 Signature of Operator or Agent: R. O. Dell Title: Geologist

FOR KCC USE:  
 API # 15- 171-20465  
 Conductor pipe required NONE feet  
 Minimum surface pipe required 200' feet per Alt. X @  
 Approved by: CR 5-5-94  
 This authorization expires: 11-5-94  
 (This authorization void if drilling not started within 6 months of effective date.)  
 Spud date: \_\_\_\_\_ Agent: \_\_\_\_\_

RECEIVED  
STATE CORPORATION COMMISSION  
MAY 05 1994  
CONSERVATION DIVISION  
Wichita, Kansas

REMEMBER TO:

- File Drill Pit Application (form CDP-1) with Intent to Drill;
- File Completion Form ACO-1 within 120 days of spud date;
- File acreage attribution plat according to field proration orders;
- Notify appropriate district office 48 hours prior to workover or re-entry;
- Submit plugging report (CP-4) after plugging is completed;
- Obtain written approval before disposing or injecting salt water.

Mail to: Conservation Division, 200 Colorado Derby Building, 202 W. First St., Wichita, Kansas 67202-1286.

**IN ALL CASES PLOT THE INTENDED WELL ON THE PLAT BELOW**

**PLAT OF ACREAGE ATTRIBUTABLE TO A WELL IN A PRORATED OR SPACED FIELD**

If the intended well is in a prorated or spaced field, please fully complete this side of the form. If the intended well is in a prorated or spaced field complete the plat below showing that the well will be properly located in relationship to other wells producing from the common source of supply. Please show all the wells within 1 mile of the boundaries of the proposed acreage attribution unit for gas wells and within 1/2 mile of the boundaries of the proposed acreage attribution unit for oil wells.

API NO. 15- \_\_\_\_\_  
 OPERATOR McCoy Petroleum Corporation  
 LEASE Haupt "A"  
 WELL NUMBER 1-15  
 FIELD Hugoton North

LOCATION OF WELL: COUNTY Scott  
1650 feet from south/north line of section  
2310 feet from east/west line of section  
 SECTION 15 TWP 19S RG 33W

NUMBER OF ACRES ATTRIBUTABLE TO WELL 40  
 QTR/QTR/QTR OF ACREAGE \_\_\_\_\_ - NW - SE

IS SECTION X REGULAR or \_\_\_\_\_ IRREGULAR  
IF SECTION IS IRREGULAR, LOCATE WELL FROM NEAREST CORNER BOUNDARY.

Section corner used: \_\_\_\_\_ NE \_\_\_\_\_ NW \_\_\_\_\_ SE \_\_\_\_\_ SW

**PLAT**

(Show location of the well and shade attributable acreage for prorated or spaced wells.)  
 (Show footage to the nearest lease or unit boundary line.)

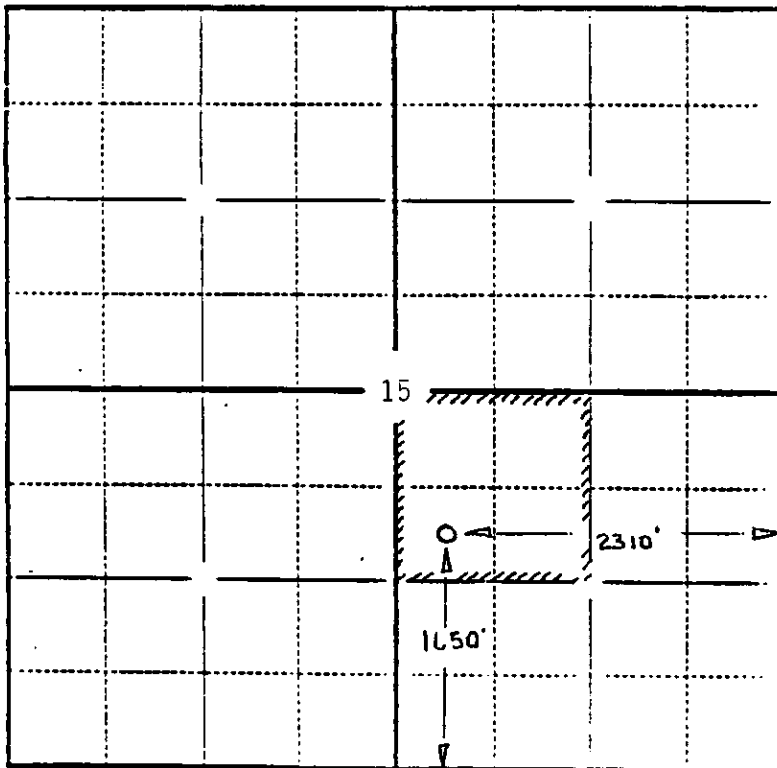

SCOTT COUNTY R 33 W

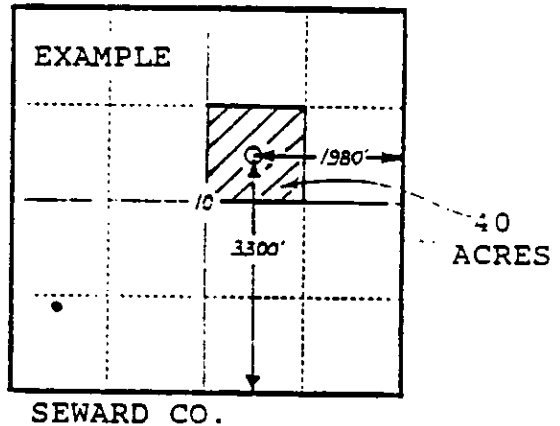

**In plotting the proposed location of the well, you must show:**

- 1) The manner in which you are using the depicted plat by identifying section lines, i.e. 1 section, 1 section with 8 surrounding sections, 4 sections, etc.;
- 2) the distance of the proposed drilling location from the section's south/north and east/west lines; and
- 3) the distance to the nearest lease or unit boundary line.