

FOR KCC USE:

EFFECTIVE DATE: 1-30-94

DISTRICT # 11
SEAT Yes

15-171-20462-0000

FORM C-1 7/91

FORM MUST BE TYPED

FORM MUST BE SIGNED

ALL BLANKS MUST BE FILLED

State of Kansas

NOTICE OF INTENTION TO DRILL

Must be approved by the K.C.C. five (5) days prior to commencing well

Expected Spud Date February 5, 1994 APPX 200' 150' S. NE. SE. Sec 9. Twp 19 S. Rg 33. East
month day year

OPERATOR: License # 30870
Name: Reynolds-Rexwinkle Oil, Inc.
Address: 212 N. Market #402
City/State/Zip: Wichita, Kansas 67202
Contact Person: Dan Reynolds
Phone: 316-269-1233

CONTRACTOR: License #: 6033
Name: Murfin Drilling Company

Well Drilled For: Well Class: Type Equipment:
X. Oil ... Enh Rec ... Infield X. Mud Rotary
X. Gas ... Storage ... Pool Ext. ... Air Rotary
... OWD ... Disposal X. Wildcat ... Cable
... Seismic: ... # of Holes ... Other
... Other

If OWD: old well information as follows:

Operator:
Well Name:
Comp. Date: Old Total Depth

Directional, Deviated or Horizontal wellbore? ... yes ... no

If yes, true vertical depth:

Bottom Hole Location:

1830 feet from South / NORTH line of Section
680 feet from East / WEST line of Section

IS SECTION X REGULAR IRREGULAR

(NOTE: Locate well on the Section Plat on Reverse Side)

County: Scott
Lease Name: Hansen Well #: 1
Field Name: Wildcat

Is this a Prorated/Spaced Field? ... yes X. no

Target Formation(s): Mississippi

Nearest lease or unit boundary: 680

Ground Surface Elevation: 2954 feet MSL

Water well within one-quarter mile: ... yes X. no

Public water supply well within one mile: ... yes X. no

Depth to bottom of fresh water: 90-140

Depth to bottom of usable water: 90-1380

Surface Pipe by Alternate: ... 1 X. 2

Length of Surface Pipe Planned to be set: (380) 220'

Length of Conductor pipe required: none

Projected Total Depth: 4700

Formation at Total Depth: Mississippi

Water Source for Drilling Operations:

X well ... farm pond ... other

DNR Permit # to be drilled, not avail, yet

Will Cores Be Taken?: ... yes X. no

If yes, proposed zone:

AFFIDAVIT

The undersigned hereby affirms that the drilling, completion and eventual plugging of this well will comply with K.S.A. 55-101, et. seq.

It is agreed that the following minimum requirements will be met:

- 1. Notify the appropriate district office prior to spudding of well;
- 2. A copy of the approved notice of intent to drill shall be posted on each drilling rig;
- 3. The minimum amount of surface pipe as specified below shall be set by circulating cement to the top; in all cases surface pipe shall be set through all unconsolidated materials plus a minimum of 20 feet into the underlying formation;
- 4. If the well is dry hole, an agreement between the operator and the district office on plug length and placement is necessary prior to plugging;
- 5. The appropriate district office will be notified before well is either plugged or production casing is cemented in;
- 6. IF AN ALTERNATE II COMPLETION, PRODUCTION PIPE SHALL BE CEMENTED FROM BELOW ANY USABLE WATER TO SURFACE WITHIN 120 DAYS OF SPUD DATE. IN ALL CASES, NOTIFY DISTRICT OFFICE PRIOR TO ANY CEMENTING.

I hereby certify that the statements made herein are true and to the best of my knowledge and belief.

Date: 1-24-94 Signature of Operator or Agent: Daniel M. Reynolds Title: vice president

FOR KCC USE:
API # 15- 171-20462-00-00
Conductor pipe required NONE feet
Minimum surface pipe required 220' feet per Alt. X 2
Approved by: CS 1-25-94
This authorization expires: 2-25-94
(This authorization void if drilling not started within 6 months of effective date.)
Spud date: Agent:

RECEIVED
STATE CORPORATION COMMISSION
JAN 25 1994
CONSERVATION DIVISION
Wichita, Kansas

REMEMBER TO:

- File Drill Pit Application (form CDP-1) with Intent to Drill;
- File Completion Form ACD-1 within 120 days of spud date;
- File acreage attribution plat according to field proration orders;
- Notify appropriate district office 48 hours prior to workover or re-entry;
- Submit plugging report (CP-4) after plugging is completed;
- Obtain written approval before disposing or injecting salt water.

Mail to: Conservation Division, 208 Colorado Derby Building, 202 W. First St., Wichita, Kansas 67202-1286.

19
33

IN ALL CASES INTENDED WELL ON THE PLAT BELOW

PLAT OF ACREAGE ATTRIBUTABLE TO A WELL IN A PRORATED OR SPACED FIELD

If the intended well is in a prorated or spaced field, please fully complete this side of the form. If the intended well is in a prorated or spaced field, complete the plat below showing that the well is properly located in relationship to other wells producing from the common source of supply. Show all the wells within 1 mile of the boundaries of the proposed acreage attributable for gas wells and within 1/2 mile of the boundaries of the proposed acreage attributable for oil wells.

API NO. 15- _____
 OPERATOR _____ LOCATION OF WELL: COUNTY _____
 LEASE _____ _____ feet from south/north line of section
 WELL NUMBER _____ _____ feet from east/west line of section
 FIELD _____ SECTION _____ TWP _____ RG _____

NUMBER OF ACRES ATTRIBUTABLE _____ IS SECTION _____ REGULAR or _____ IRREGULAR
 QTR/QTR/QTR OF ACREAGE _____ IF SECTION IS IRREGULAR, LOCATE WELL FROM NEAREST
CORNER BOUNDARY.

Section corner used: _____ NE _____ NW _____ SE _____ SW

PLAT

(Show location of the acreage attributable for prorated or spaced wells.)
 (Show the nearest lease or unit boundary line.)

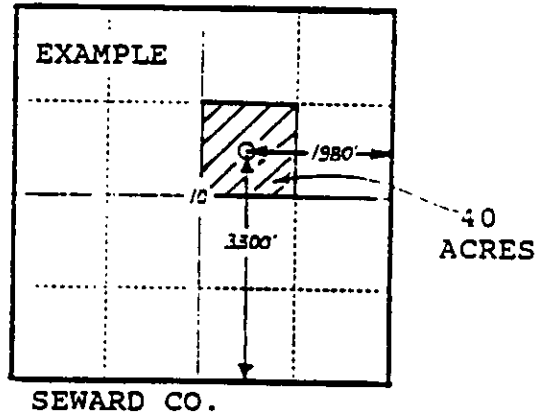
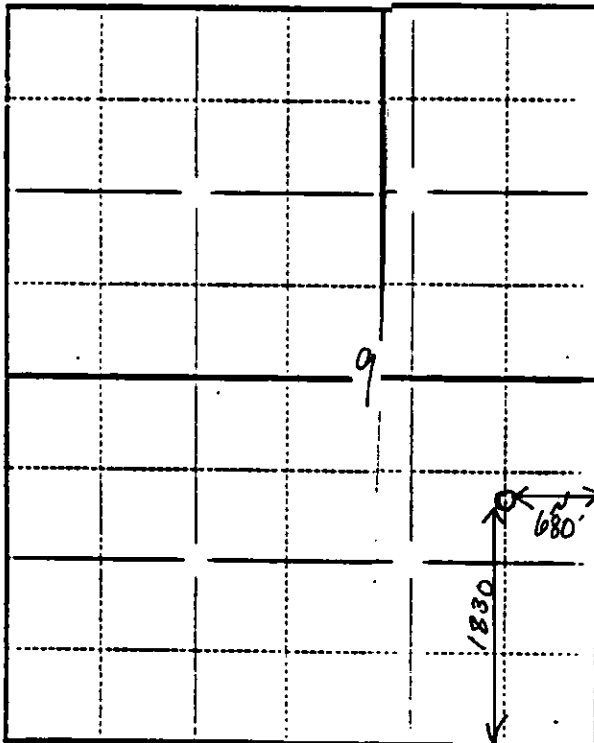

In plotting the proposed well, you must show:

- 1) The manner in which the depicted plat by identifying section lines, i.e. 1 section, 1 section surrounding sections, 4 sections, etc.;
- 2) the distance of the drilling location from the section's south/north and east/west lines; and
- 3) the distance to the lease or unit boundary line.