

FOR KCC USE:

FORM C-1 7/91

EFFECTIVE DATE: 10-14-97

State of Kansas

15-171-20520-0000

FORM MUST BE TYPED

DISTRICT # 1

NOTICE OF INTENTION TO DRILL

FORM MUST BE SIGNED

SGA? Yes ~~No~~

Must be approved by the K.C.C. five (5) days prior to commencing well.

ALL BLANKS MUST BE FILLED

Expected Spud Date ..10 ..20 ..97..... Spot / East
month day year W/2 SE Sec .. 9. Twp ..19. S, Rg ..33.. X West

OPERATOR: License #4243.....
Name: CROSS BAR PETROLEUM, INC.
Address:7570 W. 21st ST. Bldg. 1014 Suite B.....
City/State/Zip: ...Wichita, KS 67205.....
Contact Person: ...Michael Bryan
Phone:316-721-4999.....

.....1320'..... feet from South line of Section
.....2310'.....1980' feet from East line of Section
IS SECTION X REGULAR _____ IRREGULAR?
(NOTE: Locate well on the Section Plat on Reverse Side)
County:SCOTT
Lease Name: HANSEN Well #:1-9 HANSEN
Field Name:

CONTRACTOR: License #: ... 4958
Name: Mallard JV INC.....

Is this a Prorated/Spaced Field? yes ..X. no /
Target Formation(s):MISSISSIPPIAN
Nearest lease or unit boundary:330'.....
Ground Surface Elevation: ...EST. 2957 feet MSL
Water well within one-quarter mile: .. . yes ..X. no /
Public water supply well within one mile: yes ..X. no /
Depth to bottom of fresh water:180'.....200'
Depth to bottom of usable water:1220'.....1300'
Surface Pipe by Alternate: .. . 1 ..X. 2 /
Length of Surface Pipe Planned to be set: 400.....
Length of Conductor pipe required:N/A.....
Projected Total Depth:4900'.....
Formation at Total Depth:MISSISSIPPIAN
Water Source for Drilling Operations:
.. well farm pond ..X. other

Well Drilled For: Well Class: Type Equipment:

..X Oil ... Enh Rec ... Infield ..X. Mud Rotary
.. Gas ... Storage ... Pool Ext. ... Air Rotary
... OWWO ... Disposal ..X Wildcat ... Cable
... Seismic; ... # of Holes ... Other
... Other

If OWWO: old well information as follows:

Operator:
Well Name:
Comp. Date: Old Total Depth

Directional, Deviated or Horizontal wellbore? yes ..X. no /
If yes, true vertical depth:.....
Bottom Hole Location.....

Will Cores Be Taken?: yes ..X. no
If yes, proposed zone:

AFFIDAVIT

The undersigned hereby affirms that the drilling, completion and eventual plugging of this well will comply with K.S.A. 55-101, et. seq.

It is agreed that the following minimum requirements will be met:

1. Notify the appropriate district office prior to spudding of well;
2. A copy of the approved notice of intent to drill shall be posted on each drilling rig;
3. The minimum amount of surface pipe as specified below shall be set by circulating cement to the top; in all cases surface pipe shall be set through all unconsolidated materials plus a minimum of 20 feet into the underlying formation;
4. If the well is dry hole, an agreement between the operator and the district office on plug length and placement is necessary prior to plugging;
5. The appropriate district office will be notified before well is either plugged or production casing is cemented in;
6. IF AN ALTERNATE II COMPLETION, PRODUCTION PIPE SHALL BE CEMENTED FROM BELOW ANY USABLE WATER TO SURFACE WITHIN 120 DAYS OF SPUD DATE. IN ALL CASES, NOTIFY DISTRICT OFFICE PRIOR TO ANY CEMENTING.

I hereby certify that the statements made herein are true and to the best of my knowledge and belief.

Date:10/06/97..... Signature of Operator or Agent Title..PRESIDENT

FOR KCC USE:
 API # 15- 171-20520-0000
 Conductor pipe required NONE feet
 Minimum surface pipe required 220 feet per Alt. X(2)
 Approved by: JK 10-9-97
 This authorization expires: 4-9-98
 (This authorization void if drilling not started within 6 months of effective date.)
 Spud date: _____ Agent: _____

10-08-97

REMEMBER TO:

- File Drill Pit Application (form CDP-1) with Intent to Drill;
- File Completion Form ACO-1 within 120 days of spud date;
- File acreage attribution plat according to field proration orders;
- Notify appropriate district office 48 hours prior to workover or re-entry;
- Submit plugging report (CP-4) after plugging is completed;
- Obtain written approval before disposing or injecting salt water.

Mail to: KCC - Conservation Division, 130 S. Market - Room 2078, Wichita, Kansas 67202.

9
P
33W

IN-ALL CASES PLOT THE INTENDED WELL ON THE PLAT BELOW

PLAT OF ACREAGE ATTRIBUTABLE TO A WELL IN A PRORATED OR SPACED FIELD

If the intended well is in a prorated or spaced field, please fully complete this side of the form. If the intended well is in a prorated or spaced field complete the plat below showing that the well will be properly located in relationship to other wells producing from the common source of supply. Please show all the wells within 1 mile of the boundaries of the proposed acreage attribution unit for gas wells and within 1/2 mile of the boundaries of the proposed acreage attribution unit for oil wells.

API NO. 15- _____
 OPERATOR CROSS BAR PETROLEUM, INC.
 LOCATION OF WELL: COUNTY SCOTT
 LEASE HANSEN _____ 1320 feet from south/XXXXX line of section
 WELL NUMBER #1-9 _____ 2310 feet from east/XXXX line of section
 FIELD WILDCAT _____ SECTION 9 TWP 19S RG 33W

NUMBER OF ACRES ATTRIBUTABLE TO WELL 160 IS SECTION X REGULAR or _____ IRREGULAR
 QTR/QTR/QTR OF ACREAGE W/2 - W/2 - SE IF SECTION IS IRREGULAR, LOCATE WELL FROM NEAREST
 CORNER BOUNDARY.

Section corner used: _____ NE _____ NW X SE _____ SW
PLAT

(Show location of the well and shade attributable acreage for prorated or spaced wells.)
 (Show footage to the nearest lease or unit boundary line.)

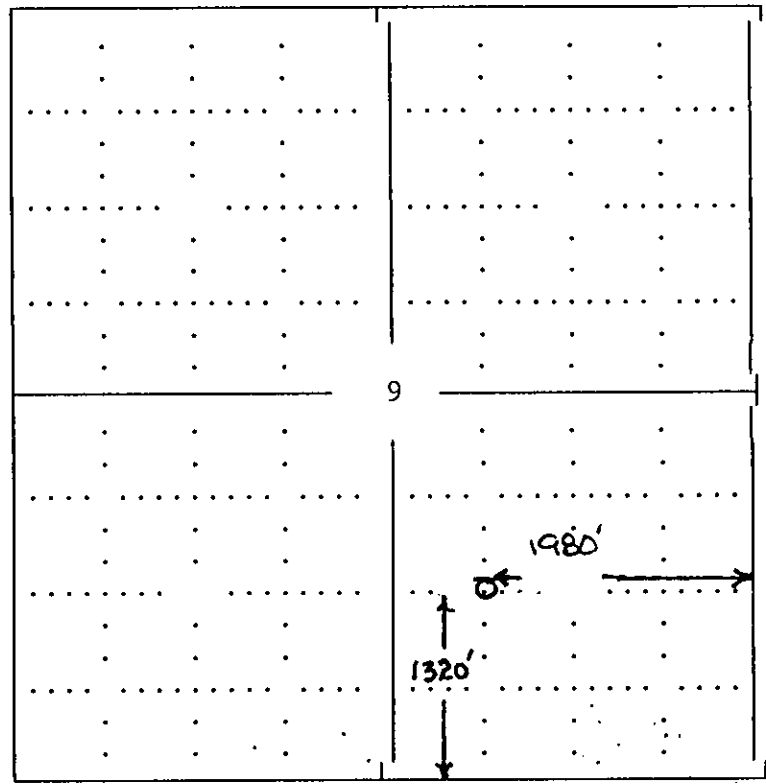

SCOTT CO.

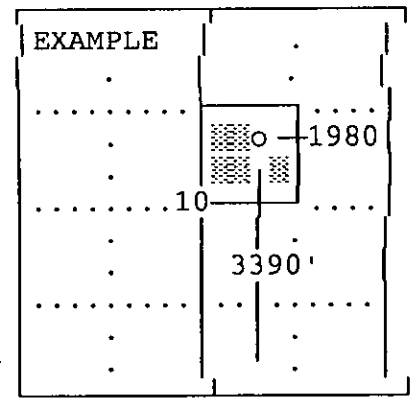

SEWARD CO.

In plotting the proposed location of the well, you must show:

- 1) The manner in which you are using the depicted plat by identifying section lines, i.e. 1 section, 1 section with 8 surrounding sections, 4 sections, etc.;
- 2) the distance of the proposed drilling location from the section's south/north and east/west; and
- 3) the distance to the nearest lease or unit boundary line.