

STATE CORPORATION COMMISSION OF KANSAS
OIL & GAS CONSERVATION DIVISION
WELL COMPLETION OR RECOMPLETION FORM
ACO-1 WELL HISTORY
DESCRIPTION OF WELL AND LEASE

API NO. 15-...171-20,352-00-00
County...Scott
SW.. SW.. NE.. Sec.34.. Twp.17S.Rge.31W. X East West

Operator: License # 5181
Name Donald C. Slawson
Address 104 S. Broadway
200 Douglas Bldg.
City/State/Zip Wichita, KS 67202

2980 29-70... Ft North from Southeast Corner of Section
3300 23-10... Ft West from Southeast Corner of Section
(Note: Locate well in section plat below)

Purchaser.....

Lease Name...Hermes "S" Well #1-A

Operator Contact Person Bill Horigan
Phone (316) 263-3201

Field Name.....

Producing Formation.....

Contractor: License # 5657
Name Slawson Drilling Company

Elevation: Ground..2924'.....KB..2930'.....

Wellsite Geologist Jeff Stewart
Phone.....

Designate Type of Completion
 New Well Re-Entry Workover
 Oil SWD Temp Abd
 Gas Inj Delayed Comp.
 Dry Other (Core, Water Supply etc.)

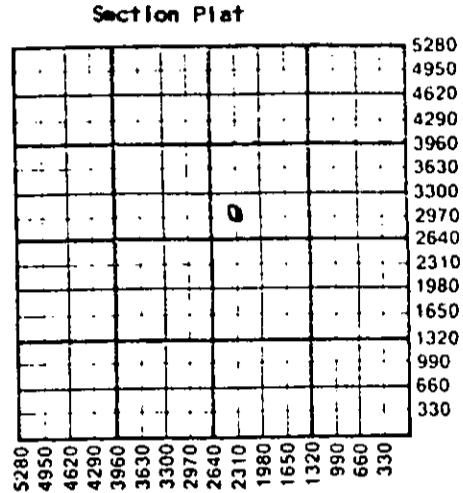

Section Plat
WATER SUPPLY INFORMATION
Disposition of Produced Water: Disposal
Docket # Repressuring

Questions on this portion of the ACO-1 call:
Water Resources Board (913) 296-3717
Source of Water:
Division of Water Resources Permit #.....
 Groundwater.....Ft North from Southeast Corner (Well)Ft West from Southeast Corner of Sec Twp Rge East West
 Surface Water.....Ft North from Southeast Corner (Stream, pond etc).....Ft West from Southeast Corner Sec Twp Rge East West
 Other (explain)..... (purchased from city, R.W.D. #)

If ONWO: old well info as follows:
Operator
Well Name
Comp. Date Old Total Depth.....

WELL HISTORY

Drilling Method:
 Mud Rotary Air Rotary Cable
...1-10-87... 1-17-87... 1-17-87.....
Spud Date Date Reached TD Completion Date
...4624.....
Total Depth PBTD

Amount of Surface Pipe Set and Cemented at 318 feet
Multiple Stage Cementing Collar Used? Yes No
If yes, show depth set.....feet
If alternate 2 completion, cement circulated from.....feet depth to.....w/.....SX cmt
Cement Company Name
Invoice #

INSTRUCTIONS: This form shall be completed in triplicate and filed with the Kansas Corporation Commission, 200 Colorado Derby Building, Wichita, Kansas 67202, within 120 days of the spud date of any well. Rule 82-3-130, 82-3-107 and 82-3-106 apply.
Information on side two of this form will be held confidential for a period of 12 months if requested in writing and submitted with the form. See rule 82-3-107 for confidentiality in excess of 12 months.
One copy of all wireline logs and drillers time log shall be attached with this form. Submit CP-4 form with all plugged wells. Submit CP-111 form with all temporarily abandoned wells.

All requirements of the statutes, rules and regulations promulgated to regulate the oil and gas industry have been fully complied with and the statements herein are complete and correct to the best of my knowledge.

Signature William R. Horigan
Title Kansas Operations Manager Date Feb. 16, 1987

Subscribed and sworn to before me this 16th day of February, 1987.
Notary Public Elizabeth Cochran

Date Commission Expires.....
ELIZABETH COCHRAN
NOTARY PUBLIC
STATE OF KANSAS
My Appt. Exp. 7-8-90

K.C.C. OFFICE USE ONLY
 Letter of Confidentiality Attached
 Wireline Log Received
 Drillers Timelog Received
Distribution
 KCC SWD/Rep NGPA
 KGS Plug Other
(Specify)

Sec. 34 Twp. 17 S. Rge. 31 W

Operator Name Donald C. Slawson Lease Name Hermes "S" Well #1-A

Sec. 34 Twp. 17.S Rge. 31W East West County Scott

15-171-20352-00-00

WELL LOG

INSTRUCTIONS: Show important tops and base of formations penetrated. Detail all cores. Report all drill stem tests giving interval tested, time tool open and closed, flowing and shut-in pressures, whether shut-in pressure reached static level, hydrostatic pressures, bottom hole temperature, fluid recovery, and flow rates if gas to surface during test. Attach extra sheet if more space is needed. Attach copy of log.

Drill Stem Tests Taken [X] Yes [] No
Samples Sent to Geological Survey [X] Yes [] No
Cores Taken [] Yes [X] No

Formation Description [X] Log [] Sample

DST. #1: 4482-4538 (JZ)
30-20-20-20 Wk. bl. died. Rec. 20'
O SPTD Mud. IFP: 9-9, FFP: 18-18,
ISIP: 62, FSIP: 35, HP: 2233-2251.

Table with 3 columns: Name, Top, Bottom. Lists geological formations such as ANHY, B/ANHY, WAB, HEEB, TOR, LANS, MUN CR, STK, BKC, MARM, PWE, FS, L/CHER, JZ, MISS, and TD with their respective depths.

CASING RECORD [X] New [] Used

Report all strings set-conductor, surface, intermediate, production, etc.

Table with 8 columns: Purpose of String, Size Hole Drilled, Size Casing Set (in O.D.), Weight Lbs/Ft., Setting Depth, Type of Cement, #Sacks Used, Type and Percent Additives. Includes entries for Surface strings.

PERFORATION RECORD

Acid, Fracture, Shot, Cement Squeeze Record

Table with 4 columns: Shots Per Foot, Specify Footage of Each Interval Perforated, (Amount and Kind of Material Used), Depth.

TUBING RECORD

Size Set At Packer at Liner Run [] Yes [] No

Date of First Production Producing Method [] Flowing [] Pumping [] Gas Lift [] Other (explain)

Table with 5 columns: Oil, Gas, Water, Gas-Oil Ratio, Gravity. Includes 'Estimated Production Per 24 Hours' and 'RELEASED' stamp.

METHOD OF COMPLETION

FROM CONFIDENTIAL

Disposition of gas: [] Vented [] Solid [] Used on Lease [] Open Hole [] Perforation [] Other (Specify) [] Dually Completed [] Commingled