

FOR KCC USE:

EFFECTIVE DATE: 5-10-2000

DISTRICT # 1

SGA? Yes No

State of Kansas
NOTICE OF INTENTION TO DRILL

Must be approved by the K.C.C. five (5) days prior to commencing well

FORM C-1 7/91
FORM MUST BE TYPED
FORM MUST BE SIGNED
ALL BLANKS MUST BE FILLED

15-203-20134-0000

Expected Spud Date May 29 2000
month day year

OPERATOR: License # 06390 6568
Name Kaiser-Francis Oil Company
Address: P.O. Box 21468
City/State/Zip: Tulsa, OK 74121-1468
Contact Person: Drew Tyler
Phone: 918-491-4343

CONTRACTOR: License #: 30606
Name: Murfin Drilling

Well Drilled For: Well Class: Type Equipment:
X Oil ... Enh Rec X Infield X Mud Rotary
... Gas ... Storage ... Pool Ext. ... Air Rotary
... OWWO ... Disposal ... Wildcat ... Cable
... Seismic; ... # of Holes ... Other
... Other

If OWWO: old well information as follows:
Operator: _____
Well Name: _____
Comp. Date: _____ Old Total Depth _____

Directional, Deviated or Horizontal wellbore? ... yes X no
If yes, true vertical depth: _____
Bottom Hole Location: _____

Spot 68 S & 163' W of
SE SW SW Sec 34 Twp 20 S Rg 38 X West
E/2

592 feet from South/North line of Section
827 feet from East/West line of Section
IS SECTION X REGULAR IRREGULAR?

(NOTE: Locate well on the Section Plat on Reverse Side)
County: Wichita
Lease Name: Caldwell "G" Well #: 6
Field Name: Rupp
Is this a Prorated/Spaced Field? ... yes X no*

Target Formation(s): Morrow
Nearest lease or unit boundary: 592'
Ground Surface Elevation: 3409 feet MSL

Water well within one-quarter mile: ... yes X no
Public water supply well within one mile: ... yes X no
Depth to bottom of fresh water: 220'
Depth to bottom of usable water: 1110'

Surface Pipe by Alternate: 1 X 2
Length of Surface Pipe Planned to be set: 275'
Length of Conductor pipe required: n/a

Projected Total Depth: 4950'
Formation at Total Depth: Morrow
Water Source for Drilling Operations:
... well ... farm pond X other

DWR Permit #: _____
Will Cores Be Taken? ... yes ... no
If yes, proposed zone: _____

*prorated and spaced in Chase & Council Grove

AFFIDAVIT

The undersigned hereby affirms that the drilling, completion and eventual plugging of this well will comply with K.S.A. 55-101, et. seq.
It is agreed that the following minimum requirements will be met:

- 1. Notify the appropriate district office prior to spudding of well;
- 2. A copy of the approved notice of intent to drill shall be posted on each drilling rig;
- 3. The minimum amount of surface pipe as specified below shall be set by circulating cement to the top; in all cases surface pipe shall be set through all unconsolidated materials plus a minimum of 20 feet into the underlying formation;
- 4. If the well is dry hole, an agreement between the operator and the district office on plug length and placement is necessary prior to plugging;
- 5. The appropriate district office will be notified before well is either plugged or production casing is cemented in;
- 6. IF AN ALTERNATE II COMPLETION, PRODUCTION PIPE SHALL BE CEMENTED FROM BELOW ANY USABLE WATER TO SURFACE WITHIN 120 DAYS OF SPUD DATE. IN ALL CASES, NOTIFY DISTRICT OFFICE PRIOR TO ANY CEMENTING.

I hereby certify that the statements made herein are true and to the best of my knowledge and belief.
Date: 5/3/00 Signature of Operator or Agent: Drew Tyler Title: Drilling Engineer

FOR KCC USE: 203-20134-0000
API # 15-
Conductor pipe required NONE feet
Minimum surface pipe required 240 feet per Alt. X(2)
Approved by: JK 5-5-2000
This authorization expires: 11-5-2000
(This authorization void if drilling not started within 6 months of effective date.)
Spud date: _____ Agent: _____

RECEIVED
STATE CORPORATION COMMISSION
MAY 4 2000
CONSERVATION DIVISION
Wichita, Kansas

REMEMBER TO:

- File Drill Pit Application (form CDP-1) with Intent to Drill;
- File Completion Form ACO-1 within 120 days of spud date;
- File acreage attribution plat according to field proration orders;
- Notify appropriate district office 48 hours prior to workover or re-entry;
- Submit plugging report (CP-4) after plugging is completed;
- Obtain written approval before disposing or injecting salt water.

Mail to: Conservation Division, 200 Colorado Derby Building, 202 W. First St., Wichita, Kansas 67202-1286.

34
20
384

IN ALL CASES PLOT THE INTENDED WELL ON THE PLAT BELOW

PLAT OF ACREAGE ATTRIBUTABLE TO A WELL IN A PRORATED OR SPACED FIELD

If the intended well is in a prorated or spaced field, please fully complete this side of the form. If the intended well is in a prorated or spaced field complete the plat below showing that the well will be properly located in relationship to other wells producing from the common source of supply. Please show all the wells within 1 mile of the boundaries of the proposed acreage attribution unit for gas wells and within 1/2 mile of the boundaries of the proposed acreage attribution unit for oil wells.

API NO. 15- _____
OPERATOR Kaiser-Francis Oil Company
LEASE Caldwell "C"
WELL NUMBER 6
FIELD Rupp

LOCATION OF WELL: COUNTY Wichita
592 feet from south/north line of section
827 feet from east/west line of section
SECTION 34 TWP 20S RG 38W

NUMBER OF ACRES ATTRIBUTABLE TO WELL 320
QTR/QTR/QTR OF ACREAGE SE - SW - SW

IS SECTION X REGULAR or IRREGULAR
IF SECTION IS IRREGULAR, LOCATE WELL FROM NEAREST CORNER BOUNDARY.

Section corner used: NE NW SE SW

PLAT

(Show location of the well and shade attributable acreage for prorated or spaced wells.)
(Show footage to the nearest lease or unit boundary line.)

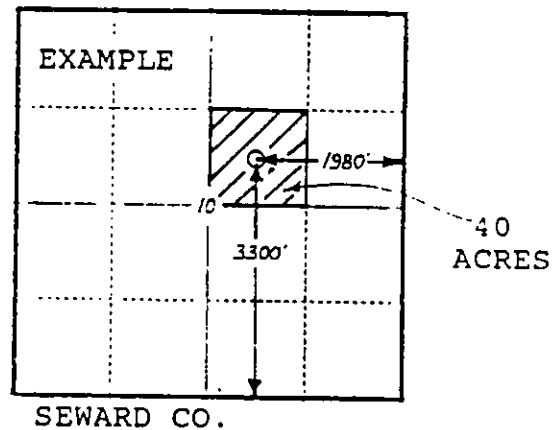
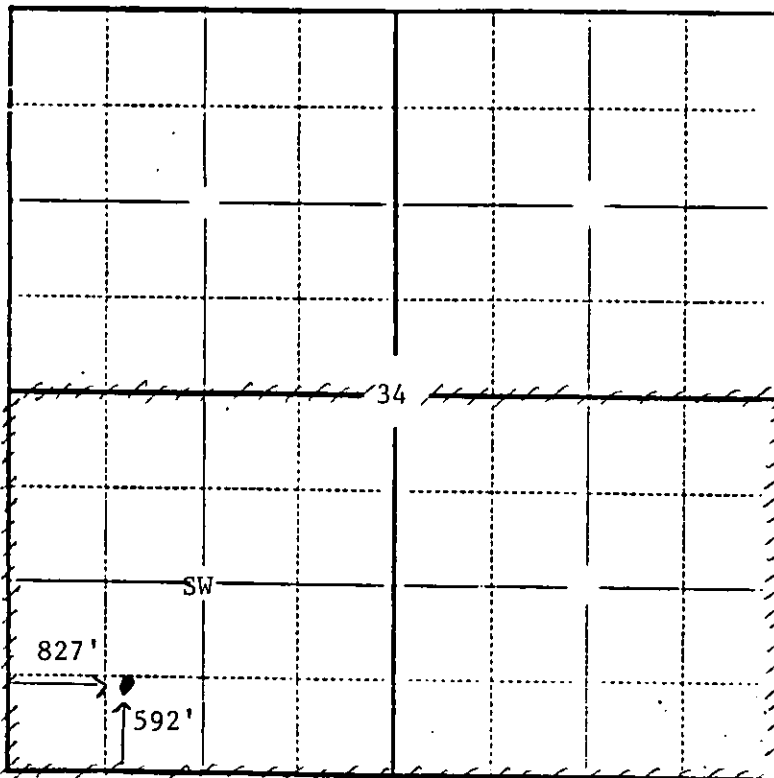

In plotting the proposed location of the well, you must show:

- 1) The manner in which you are using the depicted plat by identifying section lines, i.e. 1 section, 1 section with 8 surrounding sections, 4 sections, etc.;
- 2) the distance of the proposed drilling location from the section's south/north and east/west lines; and
- 3) the distance to the nearest lease or unit boundary line.