

FOR KCC USE:

EFFECTIVE DATE: 5-26-94

DISTRICT #

55A7... Yes... No

State of Kansas

NOTICE OF INTENTION TO DRILL

Must be approved by the K.C.C. five (5) days prior to commencing well

15-203-2011-0000

FORM C-1 7/91

FORM MUST BE TYPED

FORM MUST BE SIGNED

ALL BLANKS MUST BE FILLED

Expected Spud Date JUNE 4 1994 month day year

Spot N2 NW SW Sec 3 Twp 20 S Rg 36 West

OPERATOR: License # 5506 WOOLSEY PETROLEUM CORPORATION 107 N MARKET STE 600 WICHITA KS 67202-1807 I. WAYNE WOOLSEY (316) 267-4379

2310' FSL feet from South / West line of Section 660' FWL feet from East / West line of Section

IS SECTION REGULAR XX IRREGULAR (NOTE: Locate well on the Section Plat on Reverse Side)

County: WICHITA

Lease Name: BERNICE SMITH Well #: 1

Field Name: n/a

Is this a Prorated/Spaced Field? yes XX no

Target Formation(s): MISSISSIPPIAN

Nearst loss or unit boundary: 660'

Ground Surface Elevation: 3223' feet MSL

Water well within one-quarter mile: yes XX no

Public water supply well within one mile: yes XX no

Depth to bottom of fresh water: 75'

Depth to bottom of usable water: 1200'

Surface Pipe by Alternate: 1 XX 2

Length of Surface Pipe Planned to be set: 200'

Length of Conductor pipe required: n/a

Projected Total Depth: 5800'

Formation at Total Depth: MISSISSIPPIAN

Water Source for Drilling Operations: well farm pond XX other

DWR Permit #: n/a

Will Cores Be Taken?: yes XX no

If yes, proposed zone:

CONTRACTOR: License #: 30684 ABERCROMBIE RTD. INC.

Well Drilled For: Well Class: Type Equipment: XX Oil Enh Rec Infield XX Mud Rotary Gas Storage Pool Ext Air Rotary GWVO Disposal XX Wildcat Cable Seismic # of Holes Other

If GWVO: old well information as follows: n/a Operator: Well Name: Comp. Date: Old Total Depth

Directional, Deviated or Horizontal wellbore? yes XX no If yes, true vertical depth: Bottom Hole Location:

AFFIDAVIT

The undersigned hereby affirms that the drilling, completion and eventual plugging of this well will comply with K.S.A. 55-101, et. seq.

It is agreed that the following minimum requirements will be met:

- 1. Notify the appropriate district office prior to spudding of well; 2. A copy of the approved notice of intent to drill shall be posted on each drilling rig; 3. The minimum amount of surface pipe as specified below shall be set by circulating cement to the top; in all cases surface pipe shall be set through all unconsolidated materials plus a minimum of 20 feet into the underlying formation; 4. If the well is dry hole, an agreement between the operator and the district office on plug length and placement is necessary prior to plugging; 5. The appropriate district office will be notified before well is either plugged or production casing is cemented in; 6. IF AN ALTERNATE II COMPLETION, PRODUCTION PIPE SHALL BE CEMENTED FROM BELOW ANY USABLE WATER TO SURFACE WITHIN 120 DAYS OF SPUD DATE. IN ALL CASES, NOTIFY DISTRICT OFFICE PRIOR TO ANY CEMENTING.

I hereby certify that the statements made herein are true and to the best of my knowledge and belief.

Date: 05-11-94 Signature of Operator or Agent: I. Wayne Woolsey Title: President

FOR KCC USE: API # 15-203-2011-0000 Conductor pipe required NONE feet Minimum surface pipe required 200 feet per Alt. X(2) Approved by: CB 5-16-94 This authorization expires: 11-16-94 (This authorization void if drilling not started within 6 months of effective date.) Spud date: Agent:

REMEMBER TO:

- File Drill Pit Application (form CDP-1) with Intent to Drill; - File Completion Form ACO-1 within 120 days of spud date; - File acreage attribution plat according to field proration orders; - Notify appropriate district office 48 hours prior to workover or re-entry; - Submit plugging report (CP-4) after plugging is completed; - Obtain written approval before disposing or injecting salt water.

Mail to: Conservation Division, 200 Colorado Derby Building, 202 W. First St., Wichita, Kansas 67202-1286

RECEIVED STATE CORPORATION COMMISSION

MAY 16 1994 05-16-1994 CONSERVATION DIVISION

IN ALL CASES PLOT THE INTENDED WELL ON THE PLAT BELOW

PLAT OF ACREAGE ATTRIBUTABLE TO A WELL IN A PRORATED OR SPACED FIELD

If the intended well is in a prorated or spaced field, please fully complete this side of the form. If the intended well is in a prorated or spaced field complete the plat below showing that the well will be properly located in relationship to other wells producing from the common source of supply. Please show all the wells within 1 mile of the boundaries of the proposed acreage attribution unit for gas wells and within 1/2 mile of the boundaries of the proposed acreage attribution unit for oil wells.

API NO. 15- \_\_\_\_\_  
 OPERATOR WOOLSEY PETROLEUM CORPORATION  
 LEASE BERNICE SMITH  
 WELL NUMBER 1  
 FIELD n/a

LOCATION OF WELL: COUNTY \_\_\_\_\_  
2310' FSL feet from south/north line of section  
660' FWL feet from east/west line of section  
 SECTION 3 TWP 20S RG 36W

NUMBER OF ACRES ATTRIBUTABLE TO WELL \_\_\_\_\_  
 QTR/QTR/QTR OF ACREAGE \_\_\_\_\_

IS SECTION \_\_\_\_\_ REGULAR or XX IRREGULAR  
IF SECTION IS IRREGULAR, LOCATE WELL FROM NEAREST CORNER BOUNDARY.

Section corner used: \_\_\_\_\_ NE \_\_\_\_\_ NW \_\_\_\_\_ SE XX SW

**PLAT**

(Show location of the well and shade attributable acreage for prorated or spaced wells.)  
 (Show footage to the nearest lease or unit boundary line.)

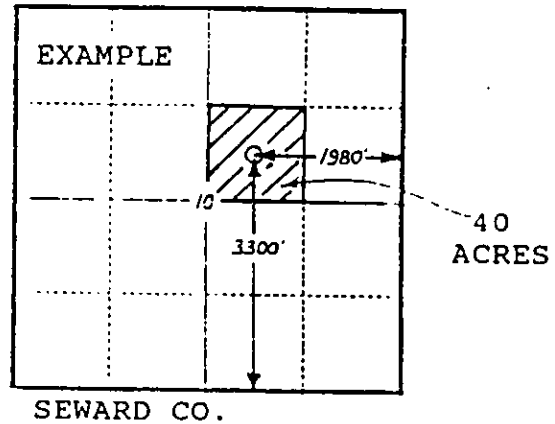
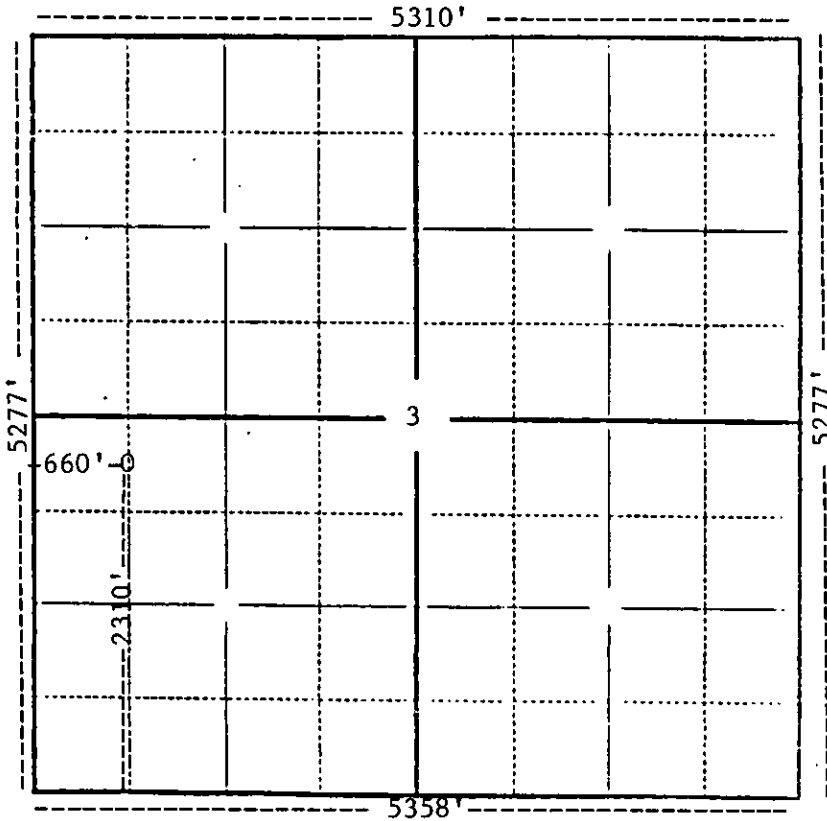

WICHITA CO.

In plotting the proposed location of the well, you must show:

- 1) The manner in which you are using the depicted plat by identifying section lines, i.e. 1 section, 1 section with 8 surrounding sections, 4 sections, etc.;
- 2) the distance of the proposed drilling location from the section's south/north and east/west lines; and
- 3) the distance to the nearest lease or unit boundary line.