

For KCC Use: 2-4-2012
Effective Date: 4
District # _____
SGA? Yes No

KANSAS CORPORATION COMMISSION
OIL & GAS CONSERVATION DIVISION

Form C-1
March 2010
Form must be Typed
Form must be Signed
All blanks must be Filled

NOTICE OF INTENT TO DRILL

Must be approved by KCC five (5) days prior to commencing well
Form KSONA-1, Certification of Compliance with the Kansas Surface Owner Notification Act, MUST be submitted with this form.

Expected Spud Date: Feb 2 2012
month day year

OPERATOR: License# 6768 ✓
Name: Carrie Exploration
Address 1: 210 West 22nd
Address 2: _____
City: Hays State: KS Zip: 67601 + _____
Contact Person: Ron Herold
Phone: 785.625.9318

CONTRACTOR: License# 33350 ✓
Name: Southwind Drilling, Inc

Well Drilled For: Oil Gas Seismic; _____ # of Holes Other: _____
Well Class: Infield Pool Ext. Wildcat Other _____
Type Equipment: Mud Rotary Air Rotary Cable

If OWWO: old well information as follows:
Operator: _____
Well Name: _____
Original Completion Date: _____ Original Total Depth: _____

Directional, Deviated or Horizontal wellbore? Yes No
If Yes, true vertical depth: _____
Bottom Hole Location: _____
KCC DKT #: _____

Spot Description: _____
N2 - SW - SW - NE Sec. 23 Twp. 12 S. R. 22 E W
(10/10/10) 2,194 feet from N / S Line of Section
2,310 feet from E / W Line of Section

Is SECTION: Regular Irregular?
(Note: Locate well on the Section Plat on reverse side)
County: Trego

Lease Name: Doxon/Bunker Well #: C-1
Field Name: Kabet Ogallah North.

Is this a Prorated / Spaced Field? Yes No
Target Formation(s): Arbuckle
Nearest Lease or unit boundary line (in footage): 330

Ground Surface Elevation: 2362 feet MSL
Water well within one-quarter mile: Yes No
Public water supply well within one mile: Yes No

Depth to bottom of fresh water: 150
Depth to bottom of usable water: 900 950
Surface Pipe by Alternate: II

Length of Surface Pipe Planned to be set: 250 A1+ II
Length of Conductor Pipe (if any): _____
Projected Total Depth: 4100
Formation at Total Depth: Arbuckle

Water Source for Drilling Operations:
 Well Farm Pond Other: _____
DWR Permit #: _____

(Note: Apply for Permit with DWR
Will Cores be taken? Yes No
If Yes, proposed zone: _____

AFFIDAVIT

The undersigned hereby affirms that the drilling, completion and eventual plugging of this well will comply with K.S.A. 55 et. seq.
It is agreed that the following minimum requirements will be met:

1. Notify the appropriate district office **prior** to spudding of well;
2. A copy of the approved notice of intent to drill **shall be** posted on each drilling rig;
3. The minimum amount of surface pipe as specified below **shall be set** by circulating cement to the top; in all cases surface pipe **shall be set** through all unconsolidated materials plus a minimum of 20 feet into the underlying formation.
4. If the well is dry hole, an agreement between the operator and the district office on plug length and placement is necessary **prior to plugging**;
5. The appropriate district office will be notified before well is either plugged or production casing is cemented in;
6. If an ALTERNATE II COMPLETION, production pipe shall be cemented from below any usable water to surface within **120 DAYS** of spud date. Or pursuant to Appendix "B" - Eastern Kansas surface casing order #133,891-C, which applies to the KCC District 3 area, alternate II cementing must be completed within 30 days of the spud date or the well shall be plugged. **In all cases, NOTIFY district office** prior to any cementing.

I hereby certify that the statements made herein are true and to the best of my knowledge and belief.

Date: 1.26.12 Signature of Operator or Agent: [Signature] Title: Agent

For KCC Use ONLY
API # 15 - 195-22761-00-00
Conductor pipe required None feet
Minimum surface pipe required 200 feet per ALT. I II
Approved by: [Signature] 1-30-2012
This authorization expires: 1-30-2013
(This authorization void if drilling not started within 12 months of approval date.)
Spud date: _____ Agent: _____

Remember to:

- File Certification of Compliance with the Kansas Surface Owner Notification Act (KSONA-1) with Intent to Drill;
- File Drill Pit Application (form CDP-1) with Intent to Drill;
- File Completion Form ACO-1 within 120 days of spud date;
- File acreage attribution plat according to field proration orders;
- Notify appropriate district office 48 hours prior to workover or re-entry;
- Submit plugging report (CP-4) after plugging is completed (within 60 days);
- Obtain written approval before disposing or injecting salt water.
- If well will not be drilled or permit has expired (See: authorized expiration date) please check the box below and return to the address below.

Well will not be drilled or Permit Expired Date: _____
Signature of Operator or Agent: _____

Mail to: KCC - Conservation Division,
130 S. Market - Room 2078, Wichita, Kansas 67202

RECEIVED

JAN 27 2012

KCC WICHITA

23
12
22
 E W

For KCC Use ONLY

API # 15 - 195-22761-0000

IN ALL CASES PLOT THE INTENDED WELL ON THE PLAT BELOW

In all cases, please fully complete this side of the form. Include items 1 through 5 at the bottom of this page.

Operator: Camie Exploration
 Lease: DOXON/BUNKER
 Well Number: C-1
 Field: KEIPET

Location of Well: County: TREGO
2194 feet from N / S Line of Section
2310 feet from E / W Line of Section
 Sec. 23 Twp. 12 S. R. 22 E W

Number of Acres attributable to well: _____
 QTR/QTR/QTR/QTR of acreage: N2 - SW - SW - NE

Is Section: Regular or Irregular

If Section is Irregular, locate well from nearest corner boundary.

Section corner used: NE NW SE SW

PLAT

Show location of the well. Show footage to the nearest lease or unit boundary line. Show the predicted locations of lease roads, tank batteries, pipelines and electrical lines, as required by the Kansas Surface Owner Notice Act (House Bill 2032).

You may attach a separate plat if desired.

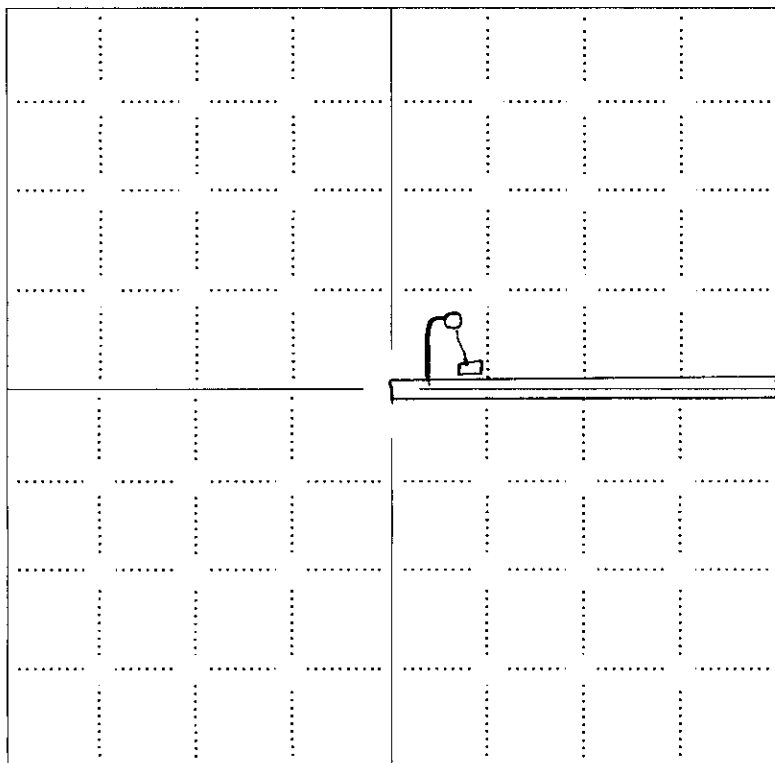

LEGEND

- Well Location
- Tank Battery Location
- Pipeline Location
- Electric Line Location
- Lease Road Location

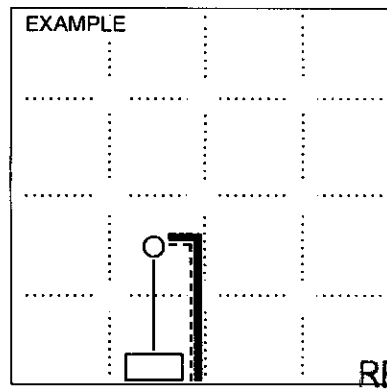

RECEIVED

JAN 27 2012

KCC WICHITA

NOTE: In all cases locate the spot of the proposed drilling location.

In plotting the proposed location of the well, you must show:

1. The manner in which you are using the depicted plat by identifying section lines, i.e. 1 section, 1 section with 8 surrounding sections, 4 sections, etc.
2. The distance of the proposed drilling location from the south / north and east / west outside section lines.
3. The distance to the nearest lease or unit boundary line (in footage).
4. If proposed location is located within a prorated or spaced field a certificate of acreage attribution plat must be attached: (CO-7 for oil wells; CG-8 for gas wells).
5. The predicted locations of lease roads, tank batteries, pipelines, and electrical lines.

CARRIE EXPLORATION & DEVELOPMENT, LLC

DOXON/BUNKER LEASE

NE. 1/4, SECTION 23, T12S, R22W

TREGO COUNTY, KANSAS

15-195-22761-0000

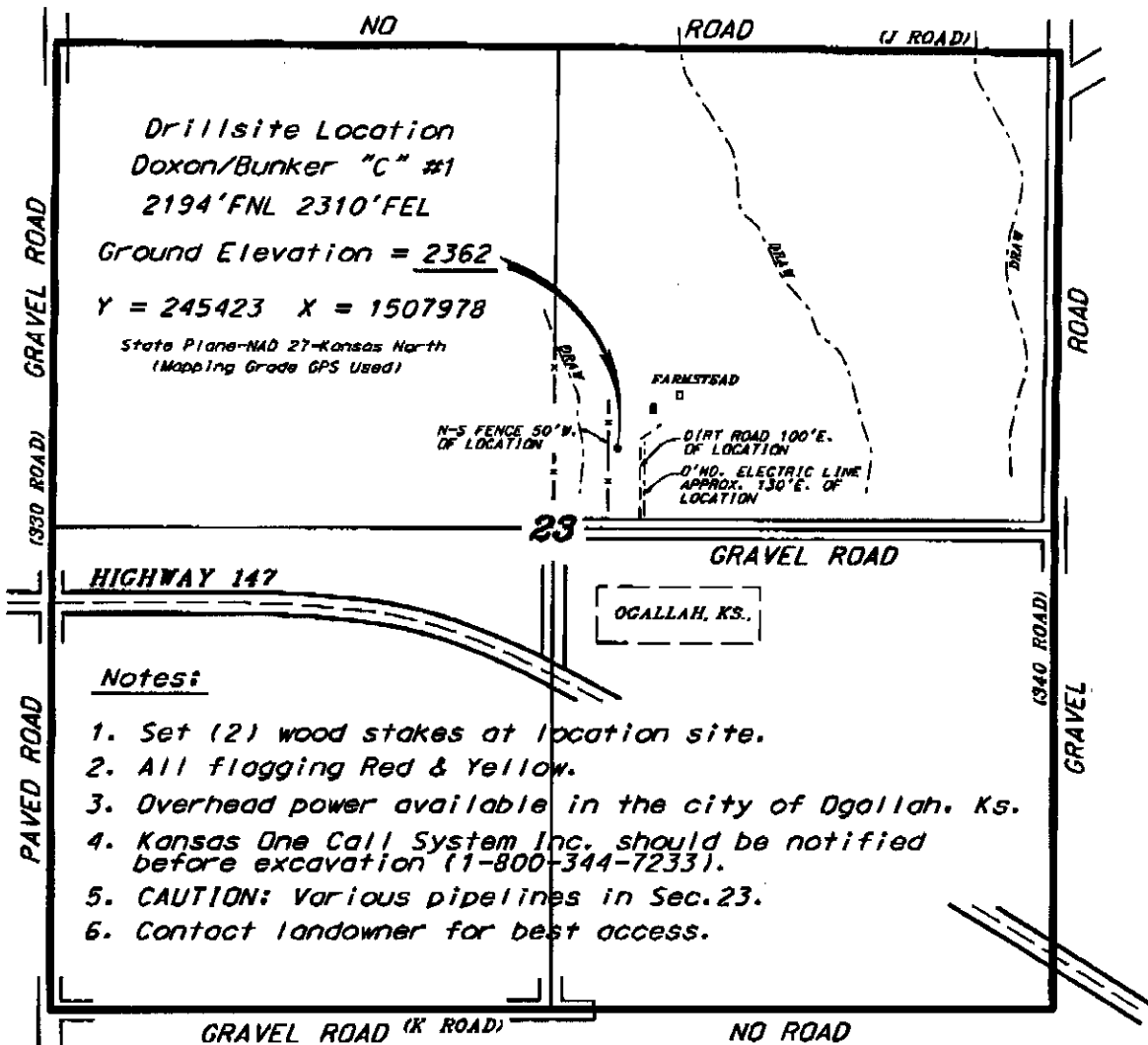

*Ingress and access to location as shown on this plot is per usage only and may not be legally opened for public use. Contact landowner, tenant and county road department for access.

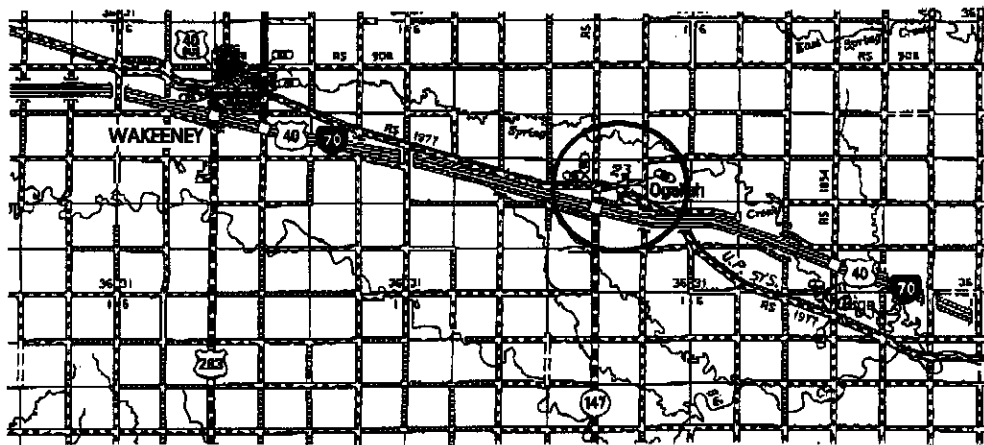

RECEIVED
JAN 27 2012
KCC WICHITA

• Controlling data is based upon the best maps and photographs available to us and upon a regular section of land containing 640 acres.
 • Approximate section lines were determined using the normal standard of care of oilfield surveyors practicing in the state of Kansas. The section corners, which establish the precise section lines, were not necessarily located, and the exact location of the drillsite location in the section is not guaranteed. Therefore, the operator assuming this service and accepting this plot and all other parties relying thereon agree to hold Central Kansas Oilfield Services, Inc., its officers and employees harmless from all losses, costs and expenses and said entities released from any liability from incidental or consequential damages.
 • Elevations derived from National Geodetic Vertical Datum.

Date January 25, 2012

KANSAS CORPORATION COMMISSION
OIL & GAS CONSERVATION DIVISION

Form KSONA-1
July 2010
Form Must Be Typed
Form must be Signed
All blanks must be Filled

**CERTIFICATION OF COMPLIANCE WITH THE
KANSAS SURFACE OWNER NOTIFICATION ACT**

15-195-22761-0000

This form must be submitted with all Forms C-1 (Notice of Intent to Drill); CB-1 (Cathodic Protection Borehole Intent); T-1 (Request for Change of Operator Transfer of Injection or Surface Pit Permit); and CP-1 (Well Plugging Application). Any such form submitted without an accompanying Form KSONA-1 will be returned.

Select the corresponding form being filed: C-1 (Intent) CB-1 (Cathodic Protection Borehole Intent) T-1 (Transfer) CP-1 (Plugging Application)

OPERATOR: License # 6768
Name: Carrie Exploration
Address 1: 210 West 22nd
Address 2: _____
City: Hays State: KS Zip: 67601 + _____
Contact Person: Ron Herold
Phone: (785) 625.9318 Fax: (_____) _____
Email Address: _____

Well Location:
N2 SW SW NE Sec. 23 Twp. 12 S. R. 22 East West
County: Trego
Lease Name: Doxon/Bunker Well #: C-1

If filing a Form T-1 for multiple wells on a lease, enter the legal description of the lease below:

Surface Owner Information:

Name: See Attached
Address 1: _____
Address 2: _____
City: _____ State: _____ Zip: _____ + _____

When filing a Form T-1 involving multiple surface owners, attach an additional sheet listing all of the information to the left for each surface owner. Surface owner information can be found in the records of the register of deeds for the county, and in the real estate property tax records of the county treasurer.

If this form is being submitted with a Form C-1 (Intent) or CB-1 (Cathodic Protection Borehole Intent), you must supply the surface owners and the KCC with a plat showing the predicted locations of lease roads, tank batteries, pipelines, and electrical lines. The locations shown on the plat are preliminary non-binding estimates. The locations may be entered on the Form C-1 plat, Form CB-1 plat, or a separate plat may be submitted.

Select one of the following:

- I certify that, pursuant to the Kansas Surface Owner Notice Act (House Bill 2032), I have provided the following to the surface owner(s) of the land upon which the subject well is or will be located: 1) a copy of the Form C-1, Form CB-1, Form T-1, or Form CP-1 that I am filing in connection with this form; 2) if the form being filed is a Form C-1 or Form CB-1, the plat(s) required by this form; and 3) my operator name, address, phone number, fax, and email address.
- I have not provided this information to the surface owner(s). I acknowledge that, because I have not provided this information, the KCC will be required to send this information to the surface owner(s). To mitigate the additional cost of the KCC performing this task, I acknowledge that I am being charged a \$30.00 handling fee, payable to the KCC, which is enclosed with this form.

If choosing the second option, submit payment of the \$30.00 handling fee with this form. If the fee is not received with this form, the KSONA-1 form and the associated Form C-1, Form CB-1, Form T-1, or Form CP-1 will be returned.

I hereby certify that the statements made herein are true and correct to the best of my knowledge and belief.

Date: 1.26.12 Signature of Operator or Agent: [Signature] Title: Agent

RECEIVED
JAN 27 2012

KCC WICHITA

15195-22761-0000

Landowner Information

Lee & Tina Sells

25029 K Rd

WaKeeney, KS 67672

Robert & Vicki Doxon

33056 Oak St

Ogallah, KS 67656

RECEIVED
JAN 27 2012
KCC WICHITA

**KANSAS CORPORATION COMMISSION
OIL & GAS CONSERVATION DIVISION
APPLICATION FOR SURFACE PIT**

Form CDP-1
May 2010
Form must be Typed

Submit in Duplicate

Operator Name: Carrie Exploration		License Number: 6768
Operator Address: 210 West 22nd		Hays KS 67601
Contact Person: Ron Herold		Phone Number: 785.625.9318
Lease Name & Well No.: Doxon/Bunker C-1		Pit Location (QQQQ): N2 SW SW NE
Type of Pit: <input type="checkbox"/> Emergency Pit <input type="checkbox"/> Burn Pit <input type="checkbox"/> Settling Pit <input checked="" type="checkbox"/> Drilling Pit <input type="checkbox"/> Workover Pit <input type="checkbox"/> Haul-Off Pit <small>(If WP Supply API No. or Year Drilled)</small>	Pit is: <input checked="" type="checkbox"/> Proposed <input type="checkbox"/> Existing If Existing, date constructed: _____ Pit capacity: 4,500 (bbls)	Sec. 23 Twp. 12 R. 22 <input type="checkbox"/> East <input checked="" type="checkbox"/> West 2,194 Feet from <input checked="" type="checkbox"/> North / <input type="checkbox"/> South Line of Section 2,310 Feet from <input checked="" type="checkbox"/> East / <input type="checkbox"/> West Line of Section Trego County
Is the pit located in a Sensitive Ground Water Area? <input type="checkbox"/> Yes <input checked="" type="checkbox"/> No		Chloride concentration: _____ mg/l <small>(For Emergency Pits and Settling Pits only)</small>
Is the bottom below ground level? <input checked="" type="checkbox"/> Yes <input type="checkbox"/> No	Artificial Liner? <input type="checkbox"/> Yes <input checked="" type="checkbox"/> No	How is the pit lined if a plastic liner is not used? Native Mud
Pit dimensions (all but working pits): <u>80</u> Length (feet) <u>80</u> Width (feet) <input type="checkbox"/> N/A: Steel Pits Depth from ground level to deepest point: <u>6</u> (feet) <input type="checkbox"/> No Pit		
If the pit is lined give a brief description of the liner material, thickness and installation procedure.		Describe procedures for periodic maintenance and determining liner integrity, including any special monitoring.
Distance to nearest water well within one-mile of pit: <u>380</u> feet Depth of water well <u>54</u> feet		Depth to shallowest fresh water <u>40</u> feet. Source of information: <input type="checkbox"/> measured <input type="checkbox"/> well owner <input type="checkbox"/> electric log <input checked="" type="checkbox"/> KDWR
Emergency, Settling and Burn Pits ONLY: Producing Formation: _____ Number of producing wells on lease: _____ Barrels of fluid produced daily: _____ Does the slope from the tank battery allow all spilled fluids to flow into the pit? <input type="checkbox"/> Yes <input type="checkbox"/> No		Drilling, Workover and Haul-Off Pits ONLY: Type of material utilized in drilling/workover: <u>Fresh Mud</u> Number of working pits to be utilized: <u>3</u> Abandonment procedure: <u>Allow to dry & backfill</u> Drill pits must be closed within 365 days of spud date.
I hereby certify that the above statements are true and correct to the best of my knowledge and belief.		RECEIVED JAN 27 2012 KCC WICHITA
<u>1.26.12</u> Date	 Signature of Applicant or Agent	

15-795-22761-0500

KCC OFFICE USE ONLY

Liner Steel Pit RFAC RFAS

Date Received: 1-27-12 Permit Number: _____ Permit Date: 1-27-12 Lease Inspection: Yes No