

* Corrected Intent *

CORRECTED

Contractor 2-3-2012

For KCC Use: 12-4-2011
Effective Date: 4
District #: 4
SGA? Yes No

**KANSAS CORPORATION COMMISSION
OIL & GAS CONSERVATION DIVISION**

Form C-1
March 2010
Form must be Typed
Form must be Signed
All blanks must be Filled

NOTICE OF INTENT TO DRILL

Must be approved by KCC five (5) days prior to commencing well
Form KSONA-1, Certification of Compliance with the Kansas Surface Owner Notification Act, MUST be submitted with this form.

Expected Spud Date: February 10, 2012
month day year

Spot Description:
SW - NE - SE - NW Sec. 7 Twp. 11 S. R. 20 E W
3,345 feet from N / S Line of Section
3,024 feet from E / W Line of Section

OPERATOR: License# 30259
Name: Werth Exploration Trust dba
Address 1: 1308 Schwaller Avenue
Address 2:
City: Hays State: KS Zip: 67801
Contact Person: Andy Werth
Phone: (785) 628-3531

Is SECTION: Regular Irregular?
(Note: Locate well on the Section Plat on reverse side)

County: Ellis
Lease Name: Watz Mustang Well #: 3
Field Name: Mixer

* CONTRACTOR: License# 31545 33905
* Name: Discovery Drilling Royal Drilling, Inc.

Is this a Prorated / Spaced Field? yes No
Target Formation(s): Arbuckle

Well Drilled For: Oil Gas
 Seismic; # of Holes _____
 Other: _____
Well Class: Infield Pool Ext. Wildcat Other
Type Equipment: Mud Rotary Air Rotary Cable

Nearest Lease or unit boundary line (in footage): 1935
Ground Surface Elevation: 2108 feet MSL

If OWWO: old well information as follows:
Operator: _____
Well Name: _____
Original Completion Date: _____ Original Total Depth: _____

Water well within one-quarter mile: yes No
Public water supply well within one mile: yes No

Depth to bottom of fresh water: 180
Depth to bottom of usable water: 800

Surface Pipe by Alternate: II
Length of Surface Pipe Planned to be set: 230
Length of Conductor Pipe (if any): N/A

Projected Total Depth: 3800
Formation at Total Depth: Arbuckle

Directional, Deviated or Horizontal wellbore? Yes No
If Yes, true vertical depth: _____
Bottom Hole Location: _____
KCC DKT #: _____

Water Source for Drilling Operations:
 Well Farm Pond Other: _____
DWR Permit #: _____

(Note: Apply for Permit with DWR)
Will Cores be taken? Yes No
If Yes, proposed zone: _____

Sherry Payne, Agent 2/4/2012

AFFIDAVIT

The undersigned hereby affirms that the drilling, completion and eventual plugging of this well will comply with K.S.A. 55 et. seq.
It is agreed that the following minimum requirements will be met:

* WAS: Contractor 31548 Discovery Drilling
IS: 11 33905 Royal Drilling KCC WICHITA
Inc

1. Notify the appropriate district office prior to spudding of well;
2. A copy of the approved notice of intent to drill shall be posted on each drilling rig;
3. The minimum amount of surface pipe as specified below shall be set by circulating cement to the top; in all cases surface pipe shall be set through all unconsolidated materials plus a minimum of 20 feet into the underlying formation.
4. If the well is dry hole, an agreement between the operator and the district office on plug length and placement is necessary prior to plugging;
5. The appropriate district office will be notified before well is either plugged or production casing is cemented in;
6. If an ALTERNATE II COMPLETION, production pipe shall be cemented from below any usable water to surface within 120 DAYS of spud date. Or pursuant to Appendix "B" - Eastern Kansas surface casing order #133,891-C, which applies to the KCC District 3 area, alternate II cementing must be completed within 30 days of the spud date or the well shall be plugged. In all cases, NOTIFY district office prior to any cementing.

I hereby certify that the statements made herein are true and to the best of my knowledge and belief.
Date: November 28, 2011 Signature of Operator or Agent: Ronald Moore Title: Agent

For KCC Use ONLY
API # 15 - 051-26239-0000
Conductor pipe required None feet
Minimum surface pipe required 200 feet per ALT. I II
Approved by: Just 11-29-2011 / KM 2-3-2012
This authorization expires: 11-29-2012
(This authorization void if drilling not started within 12 months of approval date.)
Spud date: _____ Agent: _____

Remember to:

- File Certification of Compliance with the Kansas Surface Owner Notification Act (KSONA-1) with Intent to Drill;
 - File Drill Pit Application (form GDP-1) with Intent to Drill;
 - File Completion Form ACO-1 within 120 days of spud date;
 - File acreage attribution plat according to field pronation orders;
 - Notify appropriate district office 48 hours prior to workover or re-entry;
 - Submit plugging report (CP-4) after plugging is completed (within 60 days);
 - Obtain written approval before disposing or injecting salt water.
 - If well will not be drilled or permit has expired (See: authorized expiration date) please check the box below and return to the address below.
- Well will not be drilled or Permit Expired Date: _____
Signature of Operator or Agent: _____

Mail to: KCC - Conservation Division,
130 S. Market - Room 2078, Wichita, Kansas 67202

RECEIVED

FEB 03 2012

KCC WICHITA

For KCC Use ONLY

API # 15 051-26239-0000

IN ALL CASES PLOT THE INTENDED WELL ON THE PLAT BELOW

In all cases, please fully complete this side of the form. Include items 1 through 5 at the bottom of this page.

Operator: Worth Exploration Trust
 Lease: Watz Mustang
 Well Number: 3
 Field: Mixer

Location of Well: County: Ellis
3,345 feet from N / S Line of Section
3,024 feet from E / W Line of Section
 Sec. 7 Twp. 11 S. R. 20 E W

Number of Acres attributable to well: 10
 QTR/QTR/QTR/QTR of acreage: SW - NE - SE - NW

Is Section: Regular or Irregular

If Section is Irregular, locate well from nearest corner boundary.

Section corner used: NE NW SE SW

PLAT

Show location of the well. Show footage to the nearest lease or unit boundary line. Show the predicted locations of lease roads, tank batteries, pipelines and electrical lines, as required by the Kansas Surface Owner Notice Act (House Bill 2032). You may attach a separate plat if desired.

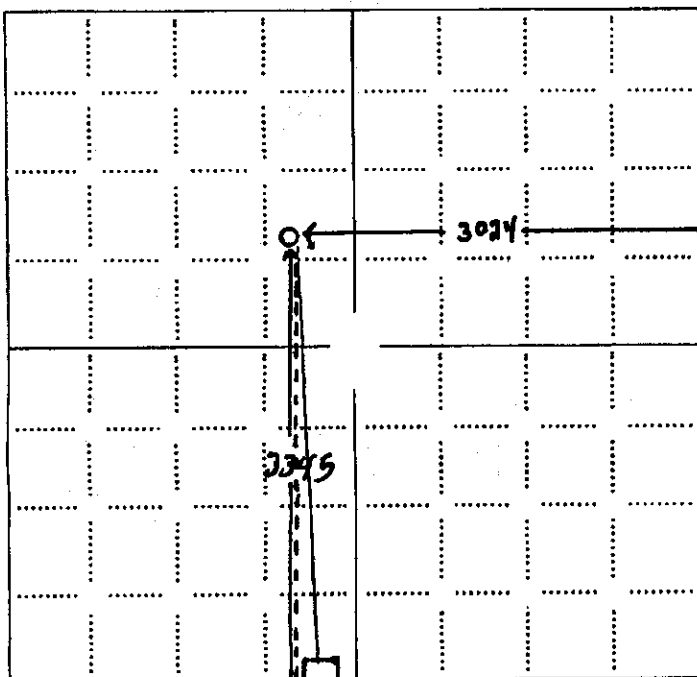

- LEGEND**
- Well Location
 - Tank Battery Location
 - Pipeline Location
 - Electric Line Location
 - Lease Road Location

RECEIVED
 NOV 29 2011

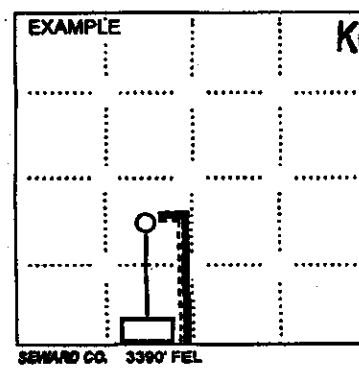

NOTE: In all cases locate the spot of the proposed drilling location.

- In plotting the proposed location of the well, you must show:
1. The manner in which you are using the depicted plat by identifying section lines, i.e. 1 section, 1 section with 8 surrounding sections, 4 sections, etc.
 2. The distance of the proposed drilling location from the south / north and east / west outside section lines.
 3. The distance to the nearest lease or unit boundary line (in footage).
 4. If proposed location is located within a prorated or spaced field a certificate of acreage attribution plat must be attached: (CO-7 for oil wells; CG-8 for gas wells).
 5. The predicted locations of lease roads, tank batteries, pipelines, and electrical lines.