

FOR KCC USE:

FORM C-1 7/91

EFFECTIVE DATE: 5-16-2000

FORM MUST BE TYPED

DISTRICT # 1

State of Kansas

FORM MUST BE SIGNED

SGA? Yes X No

NOTICE OF INTENTION TO DRILL

ALL BLANKS MUST BE FILLED

Must be approved by the K.C.C. five (5) days prior to commencing well.

15-171-20547-0000

Expected Spud Date May 22nd 2000  
month day year

Spot SW SE NE Sec 35 Twp 17S Rg 31W East X West

OPERATOR: License # 7775  
Name: WILTON PETROLEUM, INC.  
Address: 901 King Ave.  
City/State/Zip: Nyssa, OR 97913  
Contact Person: Carl Calam  
Phone: (316) 947-3254

2310 feet from 5000 North line of Section  
990 feet from East line of Section  
IS SECTION X REGULAR IRREGULAR?

CONTRACTOR: License #: 31548  
Name: Discovery Drilling Co., Inc.

(NOTE: Locate well on the Section Plat on Reverse Side)  
County: Scott

Well Drilled For: Well Class: Type Equipment:  
X Oil ... Enh Rec X Infield X Mud Rotary  
... Gas ... Storage ... Pool Ext. ... Air Rotary  
... OWMO ... Disposal ... Wildcat ... Cable  
... Seismic; ... # of Holes ... Other  
... Other

Lease Name: Janssen Well #: 2  
Field Name: MANNING NW

If OWMO: old well information as follows:  
Operator: \_\_\_\_\_  
Well Name: \_\_\_\_\_  
Comp. Date: \_\_\_\_\_ Old Total Depth \_\_\_\_\_

Is this a Prorated/Spaced Field? ... yes X no  
Target Formation(s): LKC Johnson

Directional, Deviated or Horizontal wellbore? ... yes X no  
If yes, true vertical depth: \_\_\_\_\_  
Bottom Hole Location: \_\_\_\_\_

Nearest lease or unit boundary: 330'  
Ground Surface Elevation: 2912 feet MSL

Water well within one-quarter mile: X yes ... no  
Public water supply well within one mile: ... yes X no

Depth to bottom of fresh water: 200'  
Depth to bottom of usable water: 1500'

Surface Pipe by Alternate: ... 1 X 2  
Length of Surface Pipe Planned to be set: 220'

Length of Conductor pipe required: None  
Projected Total Depth: 4600'

Formation at Total Depth: Mississippian  
Water Source for Drilling Operations:  
X well ... farm pond ... other  
APPLY FOR FROM DWR

Will Cores Be Taken? ... yes X no  
If yes, proposed zone: \_\_\_\_\_

AFFIDAVIT

The undersigned hereby affirms that the drilling, completion and eventual plugging of this well will comply with K.S.A. 55-101, et. seq.  
It is agreed that the following minimum requirements will be met:

1. Notify the appropriate district office prior to spudding of well;
2. A copy of the approved notice of intent to drill shall be posted on each drilling rig;
3. The minimum amount of surface pipe as specified below shall be set by circulating cement to the top; in all cases surface pipe shall be set through all unconsolidated materials plus a minimum of 20 feet into the underlying formation;
4. If the well is dry hole, an agreement between the operator and the district office on plug length and placement is necessary prior to plugging;
5. The appropriate district office will be notified before well is either plugged or production casing is cemented in;
6. IF AN ALTERNATE II COMPLETION, PRODUCTION PIPE SHALL BE CEMENTED FROM BELOW ANY USABLE WATER TO SURFACE WITHIN 120 DAYS OF SPUD DATE. IN ALL CASES, NOTIFY DISTRICT OFFICE PRIOR TO ANY CEMENTING.

I hereby certify that the statements made herein are true and to the best of my knowledge and belief.  
Date: 5/9/00 Signature of Operator or Agent: [Signature] Title: Agent

FOR KCC USE:  
API # 15- 171-205470000  
Conductor pipe required NONE feet  
Minimum surface pipe required 220 feet per Alt. X(2)  
Approved by: JK 5-11-2000

This authorization expires: 11-11-2000  
(This authorization void if drilling not started within 6 months of effective date.)  
Spud date: \_\_\_\_\_ Agent: \_\_\_\_\_

RECEIVED  
STATE CORPORATION COMMISSION

MAY 10 2000

CONSERVATION DIVISION  
Wichita, Kansas

REMEMBER TO:

- File Drill Pit Application (form CDP-1) with Intent to Drill;
- File Completion Form ACO-1 within 120 days of spud date;
- File acreage attribution plat according to field proration orders;
- Notify appropriate district office 48 hours prior to workover or re-entry;
- Submit plugging report (CP-4) after plugging is completed;
- Obtain written approval before disposing or injecting salt water.

Mail to: KCC - Conservation Division, 130 S. Market - Room 2078, Wichita, Kansas 67202.

35  
17  
310

**IN ALL CASES PLOT THE INTENDED WELL ON THE PLAT BELOW**

**PLAT OF ACREAGE ATTRIBUTABLE TO A WELL IN A PRORATED OR SPACED FIELD**

If the intended well is in a prorated or spaced field, please fully complete this side of the form. If the intended well is in a prorated or spaced field complete the plat below showing that the well will be properly located in relationship to other wells producing from the common source of supply. Please show all the wells within 1 mile of the boundaries of the proposed acreage attribution unit for gas wells and within 1/2 mile of the boundaries of the proposed acreage attribution unit for oil wells.

API NO. 15- \_\_\_\_\_  
 OPERATOR WILTON PETROLEUM, INC. LOCATION OF WELL: COUNTY Scott  
 LEASE Janssen 2310 feet from ~~3000~~ north line of section  
 WELL NUMBER 2 990 feet from ~~west~~ east line of section  
 FIELD \_\_\_\_\_ SECTION 35 TWP 17S RG 31W

NUMBER OF ACRES ATTRIBUTABLE TO WELL \_\_\_\_\_ IS SECTION X REGULAR or \_\_\_\_\_ IRREGULAR  
 QTR/QTR/QTR OF ACREAGE \_\_\_\_\_ **IF SECTION IS IRREGULAR, LOCATE WELL FROM NEAREST CORNER BOUNDARY.**

Section corner used: \_\_\_\_\_ NE \_\_\_\_\_ NW \_\_\_\_\_ SE \_\_\_\_\_ SW

**PLAT**

(Show location of the well and shade attributable acreage for prorated or spaced wells.)  
 (Show footage to the nearest lease or unit boundary line.)

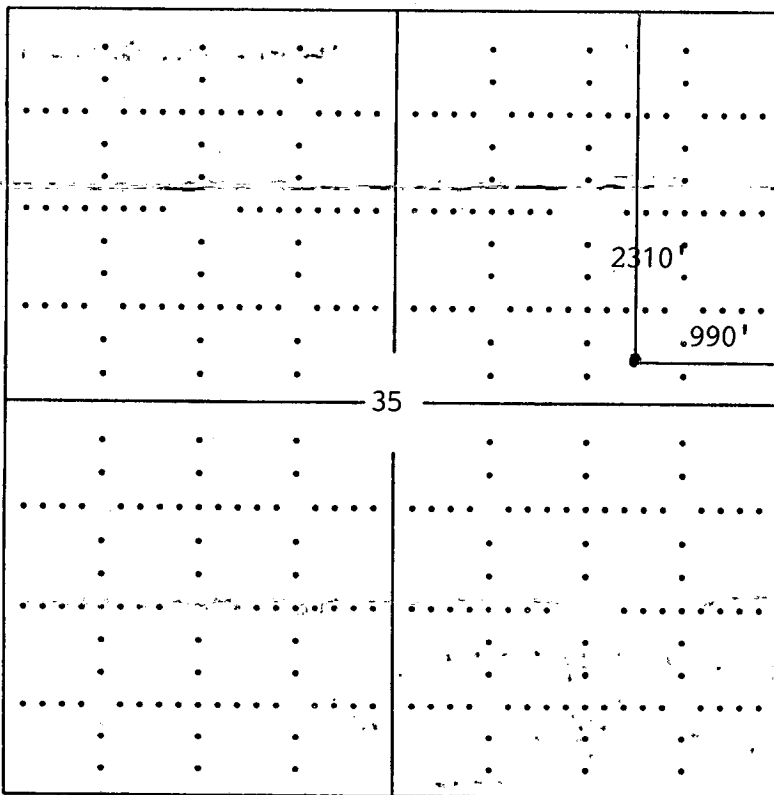

Scott Co.

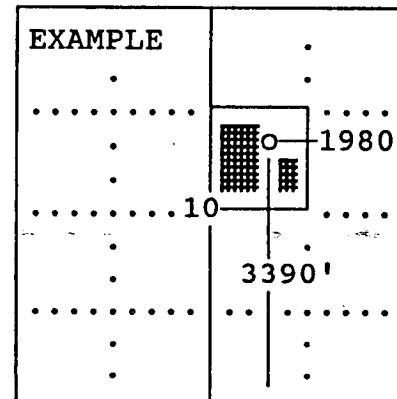

SEWARD CO.

**In plotting the proposed location of the well, you must show:**

- 1) The manner in which you are using the depicted plat by identifying section lines, i.e. 1 section, 1 section with 8 surrounding sections, 4 sections, etc.;
- 2) the distance of the proposed drilling location from the section's south/north and east/west; and
- 3) the distance to the nearest lease or unit boundary line.