

STATE OF KANSAS
STATE CORPORATION COMMISSION

15.101.20192.0000

WELL PLUGGING RECORD

Give All Information Completely
Make Required Affidavit
Mail or Deliver Report to
Conservation Division
State Corporation Comm.
245 North Water
Wichita, KS 67202

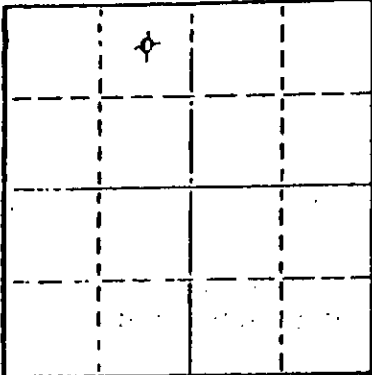

Locate well correctly on above
Section Plot

Lane County, Sec. 7 Twp. 17S Rge. 28 E/W
Location as "NE/CNW 1/4 SW 1/4" or footage from lines
100' North NE NW
Lease Owned Dane G Hansen Trust
Lease Name James Well No. 1
Office Address P O Box 187, Logan, Kansas 67646
Character of Well (Completed as Oil, Gas or Dry Hole)

Dry Hole

Date Well completed 11/13/76 19
Application for plugging filed 11/13/76 19
Application for plugging approved 11/13/76 19
Plugging commenced 11/13/76 19
Plugging completed 11/13/76 19

Reason for abandonment of well or producing formation

Too low structurally

If a producing well is abandoned, date of last production
19

Was permission obtained from the Conservation Division or
its agents before plugging was commenced? Yes

Name of Conservation Agent who supervised plugging of this well Gilbert Balthazor
Producing formation _____ Depth to top _____ Bottom _____ Total Depth of Well 4586'
Show depth and thickness of all water, oil and gas formations.

OIL, GAS OR WATER RECORDS

CASING RECORD

FORMATION	CONTENT	FROM	TO	SIZE	PUT IN	PULLED OUT

Describe in detail the manner in which the well was plugged, indicating where the mud fluid was placed and the method or methods used in introducing it into the hold. If cement or other plugs were used, state the character of same and depth placed, from _____ feet to _____ feet for each plug set.

Filled with heavy mud to 950'

Set plug. Put in 70 sacks cement. Filled with heavy mud to 300'. Set plug. Put in 20 sacks cement. Filled with heavy mud to 40'. Set plug. Filled to top with 1 sack hulls and 10 sacks cement.

(If additional description is necessary, use BACK of this sheet)

Name of Plugging Contractor C-G DRILLING CO.
1107 Douglas Bldg, 104 S Broadway, Wichita, KS 67202

STATE OF Kansas COUNTY OF Sedgwick ss.

G. F. Galloway

(employee of owner) or (owner or operator) of the above-described

well, being first duly sworn on oath, says: That I have knowledge of the facts, statements, and matters herein contained and the log of the above-described well as filed and that the same are true and correct. So help me God

(Signature)

G. F. Galloway

1107 Douglas Bldg, 104 S Broadway

SUBSCRIBED AND SWORN TO before me this 18TH day of NOVEMBER, 1976 Wichita, KS

Debra L Heersche
Debra L Heersche

Notary Public.

My commission expires March 3, 1980

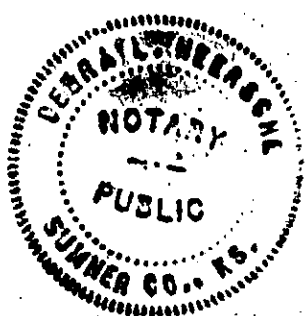

KANSAS DRILLERS LOG

API No. 15 — 101 — 20197-0000
County Number

S. 7 T. 17S R. 28 W
Loc. 100' North NE NW
County Lane

Operator

Dane G. Hansen Trust

Address

P O Box 187, Logan, Kansas 67646

Well No.

1

Lease Name

JAMES

Footage Location

560'

feet from (N) X(S) line

1980

feet from X(W) line

Principal Contractor

C-G DRILLING CO.

Geologist

JERRY L JESPERSEN

Spud Date

10/31/76

Total Depth

4586'

P.B.T.D.

Date Completed

11/13/76

Oil Purchaser

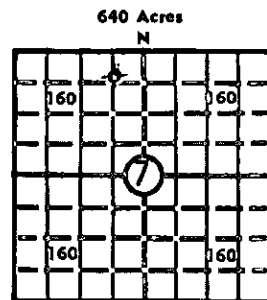

Elev.: Gr. _____

DF _____ KB 2779'

CASING RECORD

Report of all strings set — surface, intermediate, production, etc.

Purpose of string	Size hole drilled	Size casing set (in O.D.)	Weight lbs/ft.	Setting depth	Type cement	Sacks	Type and percent additives
SURFACE	12 1/4"	8 5/8"	28#	306.50'	Common	150	2% Gel 3% CC

LINER RECORD

PERFORATION RECORD

Top, ft.	Bottom, ft.	Sacks cement	Shots per ft.	Size & type	Depth interval

TUBING RECORD

Size	Setting depth	Packer set at

ACID, FRACTURE, SHOT, CEMENT SQUEEZE RECORD

Amount and kind of material used	Depth interval treated

INITIAL PRODUCTION

Date of first production		Producing method (flowing, pumping, gas lift, etc.)		
RATE OF PRODUCTION PER 24 HOURS	Oil	Gas	Water	Gas-oil ratio
	bbls.	MCF	bbls.	CFPB
Disposition of gas (vented, used on lease or sold)			Producing interval(s)	

INSTRUCTIONS: As provided in KCC Rule 82-2-125, within 90 days after completion of a well, one completed copy of this Drillers Log shall be transmitted to the State Geological Survey of Kansas, 4150 Monroe Street, Wichita, Kansas 67209. Copies of this form are available from the Conservation Division, State Corporation Commission, 3830 So. Meridian (P.O. Box 17027), Wichita, Kansas 66217. Phone AC 316-522-2206. If confidential custody is desired, please note Rule 82-2-125. Drillers Logs will be on open file in the Oil and Gas Division, State Geological Survey of Kansas, Lawrence, Kansas 66044.

Operator DANE G HANSEN TRUST		DESIGNATE TYPE OF COMP.: OIL, GAS, DRY HOLE, SWDW, ETC.: DRY HOLE	
Well No. 1	Lease Name JAMES		
S <u>7</u> T <u>17</u> S <u>28</u> ^R _W			
WELL LOG		SHOW GEOLOGICAL MARKERS, LOGS RUN, OR OTHER DESCRIPTIVE INFORMATION.	
Show all important zones of porosity and contents thereof; cored intervals, and all drill-stem tests, including depth interval tested, cushion used, time tool open, flowing and shut-in pressures, and recoveries.			
FORMATION DESCRIPTION, CONTENTS, ETC.	TOP	BOTTOM	NAME
SHALE & SAND	0	1045	
SHALE	1045	1548	
SHALE & SAND	1548	1705	
SAND	1705	1930	
SHALE & SAND	1930	2040	
SHALE & RED BED	2040	2173	
ANHYDRITE	2173	2213	
SHALE & SHELLS	2213	2510	
LIME & SHALE	2510	3980	
LIME & RTD	2980	4586	
DST #1: 4175-4210' OP 30 SI 30 OP 90 SI 30. WEAK STEADY BLOW THRUOUT. REC 220' VSOCMW, IBHP 1107#, FBHP 1108#, IFP 58#, FFP 150#.			
DST #2: 4285-4340 OP 30 SO 30 OP 30 SI 30. REC 10' MUD, IBHP 552#, FBHP 230#, IFP 69#, FFP 81#.			
DST #3: 4466-4545' OP 30 SI 30 OP 30 SI 30. REC 30' MUD W/TRACE OIL IBHP 596#, FBHP 92#, IFP 46 FFP 46#			
USE ADDITIONAL SHEETS, IF NECESSARY, TO COMPLETE WELL RECORD.			
Date Received	<div style="text-align: center;">  Phyllis Buchanan <small>Signature</small> Office Manager <small>Title</small> </div> <div style="text-align: center; margin-top: 10px;"> 11/18/76 <small>Date</small> </div>		