

15-171-20153-00-00

STATE OF KANSAS
STATE CORPORATION COMMISSION

WELL PLUGGING RECORD

Give All Information Completely
Make Required Affidavit
Mail or Deliver Report to
Conservation Division
State Corporation Comm.
245 North Water
Wichita, KS 67202

Scott County. Sec. 27 Twp. 19S Rge. 33W E XX
Location as "NE/CNW/SW" or footage from lines _____
100' S of C. SE SE
Lease Owner Benson Mineral Group, Inc.
Lease Name Irma Smith Well No. 1
Office Address 1400 Metro Bank Bldg. 475 17th Denver, Co.
Character of Well (Completed as Oil, Gas or Dry Hole) 80202

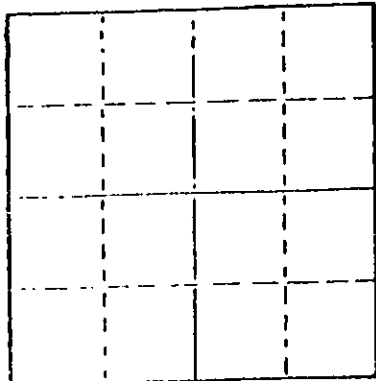

Locate well correctly on above
Section Plat

Dry Hole
Date Well completed 12/11/77 19
Application for plugging filed 12/11/77 19
Application for plugging approved 12/11/77 19
Plugging commenced 12/11/77 19
Plugging completed 12/11/77 19
Reason for abandonment of well or producing formation _____

Dry Hole
If a producing well is abandoned, date of last production _____ 19

Was permission obtained from the Conservation Division or its agents before plugging was commenced? yes

Name of Conservation Agent who supervised plugging of this well Clarence Thompson
Producing formation _____ Depth to top _____ Bottom _____ Total Depth of Well 4750
Show depth and thickness of all water, oil and gas formations.

OIL, GAS OR WATER RECORDS

CASING RECORD:

FORMATION	CONTENT	FROM	TO	SIZE	PUT IN	PULLED OUT

Describe in detail the manner in which the well was plugged, indicating where the mud fluid was placed and the method or methods used in introducing it into the hold. If cement or other plugs were used, state the character of same and depth placed, from _____ feet to _____ feet for each plug set.

Drilling mud to 400', hull plug, 35 sx cement, mud to 40', hull plug, 10 sx cement, 5 sx cement at rathole, 5 sx. cement at mousehole.

RECEIVED
STATE CORPORATION COMMISSION

JAN 06 1978

(If additional description is necessary, use BACK of this sheet)

Name of Plugging Contractor B & N Drilling Co., Division of Benson Mineral Group, Inc.
Box 846, Independence, Ks. 67301

STATE OF KANSAS COUNTY OF MONTGOMERY, ss.
Lucille Shukers (employee of owner) or ~~(owner)~~
of the above-described well, being first duly sworn on oath, says: That I have knowledge of the facts, statements, and matters herein contained and the log of the above-described well as filed and that the same are true and correct. So help me God.

(Signature) Lucille Shukers
Box 846, Independence, Ks. 67301
(Address)

SUBSCRIBED AND SWORN TO before me this 11th day of December, 1977

Gail L. Tucker
Notary Public.

My commission expires 5-7-80



KANSAS DRILLERS LOG

S. 27 T. 19S R. 33E
 Loc. 100'S of C SE SE
 County Scott

API No. 15 — 171 — 20153-00-00
 County Number

Operator
Benson Mineral Group, Inc.

Address
1400 Metro Bank Building, Denver, Colorado 80202

Well No. 1 Lease Name Smith, Irma

Footage Location
 feet from (N) (S) line feet from (E) (W) line

Principal Contractor B & N Drilling Co. Geologist vic Reiser

Spud Date 11/27/77 Total Depth 4750 P.B.T.D.

Date Completed 12/10/77 Oil Purchaser

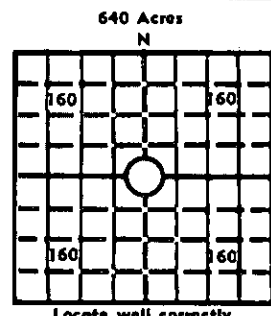

Elev.: Gr. _____
 DF _____ KB _____

CASING RECORD

Report of all strings set — surface, intermediate, production, etc.

Purpose of string	Size hole drilled	Size casing set (in O.D.)	Weight lbs/ft.	Setting depth	Type cement	Sacks	Type and percent additives
Surface	12 1/2"	8-5/8	23	425	Common	30	3% CC 2% Gel.
Plugged & abandon 12/11/77							

LINER RECORD

PERFORATION RECORD

Top, ft.	Bottom, ft.	Sacks cement	Shots per ft.	Size & type	Depth interval
TUBING RECORD					
Size	Setting depth	Packer set at			

ACID, FRACTURE, SHOT, CEMENT SQUEEZE RECORD

Amount and kind of material used	Depth interval treated
RECEIVED STATE CORPORATION COMMISSION JAN 06 1978 CONSERVATION DIVISION Wichita, Kansas	
INITIAL PRODUCTION	

Date of first production None Producing method (flowing, pumping, gas lift, etc.)

RATE OF PRODUCTION PER 24 HOURS
 Oil _____ Gas _____ Water _____ Gas-oil ratio _____
 bbls. MCF bbls. CFPB

Disposition of gas (vented, used on lease or sold) Producing interval (s)

INSTRUCTIONS: As provided in KCC Rule 82-2-125, within 90 days after completion of a well, one completed copy of this Drillers Log shall be transmitted to the State Geological Survey of Kansas, 4150 Monroe Street, Wichita, Kansas 67209. Copies of this form are available from the Conservation Division, State Corporation Commission, 3830 So. Meridian (P.O. Box 17027), Wichita, Kansas 66217. Phone AC 316-522-2206. If confidential custody is desired, please note Rule 82-2-125. Drillers Logs will be on open file in the Oil and Gas Division, State Geological Survey of Kansas, Lawrence, Kansas 66044.

Operator

Benson Mineral Group, Inc.

DESIGNATE TYPE OF COMP.: OIL, GAS, DRY HOLE, SWDW, ETC.:

Well No.

1

Lease Name

Irma Smith

P & A

S 27 T 19S R 33E ^E_{78X}

WELL LOG

Show all important zones of porosity and contents thereof; cored intervals, and all drill-stem tests, including depth interval tested, cushion used, time tool open, flowing and shut-in pressures, and recoveries.

SHOW GEOLOGICAL MARKERS, LOGS RUN, OR OTHER DESCRIPTIVE INFORMATION.

FORMATION DESCRIPTION, CONTENTS, ETC.	TOP	BOTTOM	NAME	DEPTH
sand & shale sand/shale/lime	0 4600	4600 4750 TD		

USE ADDITIONAL SHEETS, IF NECESSARY, TO COMPLETE WELL RECORD.

Date Received

Courtney E Cook

Signature

Production Manager

Title

1/4/78

Date