

FOR KCC USE:

15-071-20576-0080

FORM C-1 7/91

EFFECTIVE DATE: 9-27-92

FORM MUST BE TYPED

DISTRICT # 1

State of Kansas  
NOTICE OF INTENTION TO DRILL

FORM MUST BE SIGNED

SEAL Yes No

Must be approved by the K.C.C. five (5) days prior to commencing well

ALL BLANKS MUST BE FILLED

Expected Spud Date: October 10, 1992  
month day year

Spot 1/2 SW SW Sec 36 Twp 16 S, Rg 43 West

OPERATOR: License # 5046  
Name: Raymond Oil Co., Inc.  
Address: P.O. Box 48788  
City/State/Zip: Wichita, Kansas 67201  
Contact Person: Pat Raymond  
Phone: (316) 267-4214

330' feet from South line of Section  
660' feet from West line of Section  
IS SECTION X REGULAR IRREGULAR

(NOTE: Locate well on the Section Plat on Reverse Side)

County: Greeley  
Lease Name: White Well #: 1  
Field Name: Wildcat

CONTRACTOR: License #: 30606  
Name: Murfin Drilling Co.

Is this a Prorated/Spaced Field? yes X no

Target Formation(s): Morrow

Nearest lease or unit boundary: 330'

Ground Surface Elevation: 3888 feet MSL

Water well within one-quarter mile: yes X no

Public water supply well within one mile: yes X no

Depth to bottom of fresh water: 240'

Depth to bottom of usable water: 1925'

Surface Pipe by Alternate: 1 X 2

Length of Surface Pipe Planned to be set: 300+

Length of Conductor pipe required:

Projected Total Depth: 5250

Formation at Total Depth: Mississippian

Water Source for Drilling Operations:

... well X farm pond other

DWR Permit #:

Will Cores Be Taken?: yes X no

If yes, proposed zone:

Well Drilled For: Well Class: Type Equipment:  
X Oil ... Enh Rec ... Infield X Mud Rotary  
... Gas ... Storage ... Pool Ext. ... Air Rotary  
... OWD ... Disposal X Wildcat ... Cable  
... Seismic: ... # of Holes ... Other

If OWD: old well information as follows:  
Operator:  
Well Name:  
Comp. Date: Old Total Depth

Directional, Deviated or Horizontal wellbore? yes X no

If yes, true vertical depth:

Bottom Hole Location:

AFFIDAVIT

The undersigned hereby affirms that the drilling, completion and eventual plugging of this well will comply with K.S.A. 55-101, et. seq.

It is agreed that the following minimum requirements will be met:

- 1. Notify the appropriate district office prior to spudding of well;
- 2. A copy of the approved notice of intent to drill shall be posted on each drilling rig;
- 3. The minimum amount of surface pipe as specified below shall be set by circulating cement to the top; in all cases surface pipe shall be set through all unconsolidated materials plus a minimum of 20 feet into the underlying formation;
- 4. If the well is dry hole, an agreement between the operator and the district office on plug length and placement is necessary prior to plugging;
- 5. The appropriate district office will be notified before well is either plugged or production casing is cemented in;
- 6. IF AN ALTERNATE II COMPLETION, PRODUCTION PIPE SHALL BE CEMENTED FROM BELOW ANY USABLE WATER TO SURFACE WITHIN 120 DAYS OF SPUD DATE. IN ALL CASES, NOTIFY DISTRICT OFFICE PRIOR TO ANY CEMENTING.

I hereby certify that the statements made herein are true and to the best of my knowledge and belief.

Date: 9-21-92 Signature of Operator or Agent: Pat Raymond Title: Vice President

FOR KCC USE:  
API # 15- 071-20576  
Conductor pipe required None feet  
Minimum surface pipe required 260 feet per Alt. X(2)  
Approved by: 9-22-92  
This authorization expires: 3-22-93  
(This authorization void if drilling not started within 6 months of effective date.)  
Spud date: Agent:

REMEMBER TO:

- File Drill Pit Application (form CDP-1) with Intent to Drill;
- File Completion Form ACD-1 within 120 days of spud date;
- File acreage attribution plat according to field proration orders;
- Notify appropriate district office 48 hours prior to workover or re-entry;
- Submit plugging report (CP-4) after plugging is completed;
- Obtain written approval before disposing or injecting salt water.

Mail to: Conservation Division, 200 Colorado Derby Building, 202 W. First St., Wichita, Kansas 67202-1286.

RECEIVED  
STATE CORPORATION COMMISSION

SEP 22 1992  
09-27-1992  
CONSERVATION DIVISION  
Wichita, Kansas

36  
16  
43

IN ALL CASES PLOT THE INTENDED WELL ON THE PLAT BELOW

**PLAT OF ACREAGE ATTRIBUTABLE TO A WELL IN A PRORATED OR SPACED FIELD**

If the intended well is in a prorated or spaced field, please fully complete this side of the form. If the intended well is in a prorated or spaced field complete the plat below showing that the well will be properly located in relationship to other wells producing from the common source of supply. Please show all the wells within 1 mile of the boundaries of the proposed acreage attribution unit for gas wells and within 1/2 mile of the boundaries of the proposed acreage attribution unit for oil wells.

API NO. 15- \_\_\_\_\_  
 OPERATOR \_\_\_\_\_ LOCATION OF WELL: COUNTY \_\_\_\_\_  
 LEASE \_\_\_\_\_ feet from south/north line of section  
 WELL NUMBER \_\_\_\_\_ feet from east/west line of section  
 FIELD \_\_\_\_\_ SECTION \_\_\_\_\_ TWP \_\_\_\_\_ RG \_\_\_\_\_

NUMBER OF ACRES ATTRIBUTABLE TO WELL \_\_\_\_\_ IS SECTION \_\_\_\_\_ REGULAR or \_\_\_\_\_ IRREGULAR  
 QTR/QTR/QTR OF ACREAGE \_\_\_\_\_ - \_\_\_\_\_ - \_\_\_\_\_ IF SECTION IS IRREGULAR, LOCATE WELL FROM NEAREST CORNER BOUNDARY.

Section corner used: \_\_\_\_\_ NE \_\_\_\_\_ NW \_\_\_\_\_ SE \_\_\_\_\_ SW  
**PLAT**

(Show location of the well and shade attributable acreage for prorated or spaced wells.)  
 (Show footage to the nearest lease or unit boundary line.)

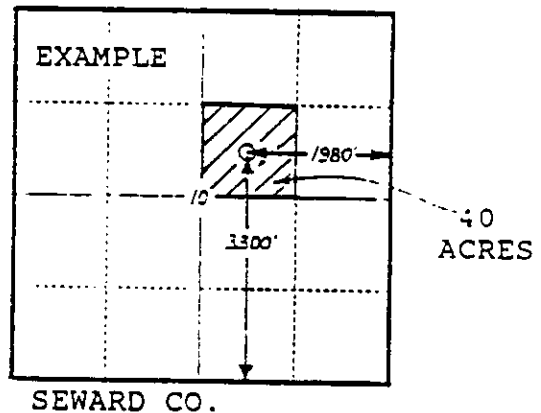
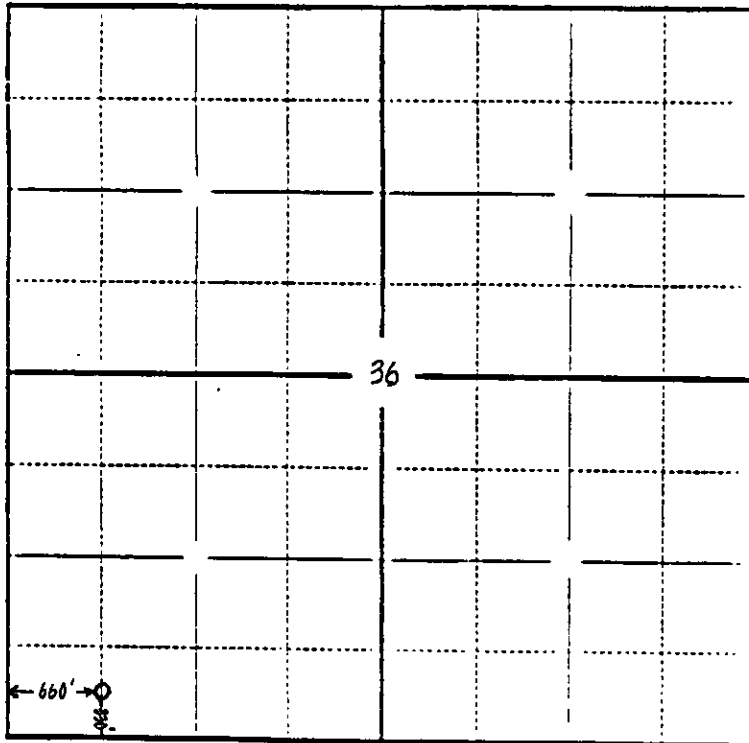

In plotting the proposed location of the well, you must show:

- 1) The manner in which you are using the depicted plat by identifying section lines, i.e. 1 section, 1 section with 8 surrounding sections, 4 sections, etc.;
- 2) the distance of the proposed drilling location from the section's south/north and east/west lines; and
- 3) the distance to the nearest lease or unit boundary line.