

FOR KCC USE:

FORM C-1 7/91

EFFECTIVE DATE: 3-2-92

State of Kansas

15-171-20444-0000

FORM MUST BE TYPED

DISTRICT # 1
SCAT... Yes No

NOTICE OF INTENTION TO DRILL

FORM MUST BE SIGNED

ALL BLANKS MUST BE FILLED

Must be approved by the K.C.C. five (5) days prior to commencing well

Expected Spud Date March 10, 1992
month day year

Spot SW SW NE Sec 27 Twp 19S S. Rg 33 East West

OPERATOR: License # 5399
Name: American Energies Corporation
Address: 155 North Market, Suite 710
City/State/Zip: Wichita, Kansas 67202
Contact Person: Alan J. DeGood
Phone: 316-263-5785

2970 feet from South / North line of Section:
2310 feet from East / West line of Section:

IS SECTION REGULAR IRREGULAR?

(NOTE: Locate well on the Section Plat on Reverse Side)

County: Scott

Lease Name: Smith Well #: G #2

Field Name: Unnamed

Is this a Prorated/Spaced Field? ... yes no

Target Formation(s): Lansing, Morrow, Mississippi

Nearest lease or unit boundary: 330'

Ground Surface Elevation: N/A feet MSL

Water well within one-quarter mile: ... yes no

Public water supply well within one mile: ... yes no

Depth to bottom of fresh water: 250'

Depth to bottom of usable water: 1300'

Surface Pipe by Alternate: 1 2

Length of Surface Pipe Planned to be set: 375'

Length of Conductor pipe required: 0'

Projected Total Depth: 4750'

Formation at Total Depth: Mississippi

Water Source for Drilling Operations:

... well ... farm pond other

DWR Permit #: _____

Will Cores Be Taken? ... yes no

If yes, proposed zone: _____

CONTRACTOR: License #: 5886
Name: Chief Drilling, Inc.

Well Drilled For:	Well Class:	Type Equipment:
<input checked="" type="checkbox"/> Oil	... Enh Rec	... Infield <input checked="" type="checkbox"/> Mud Rotary
... Gas	... Storage	<input checked="" type="checkbox"/> Pool Ext. ... Air Rotary
... OWVO	... Disposal	... Wildcat ... Cable
... Seismic: ... # of Holes	... Other	
... Other		

If OWVO: old well information as follows:
Operator: _____
Well Name: _____
Comp. Date: _____ Old Total Depth _____

Directional, Deviated or Horizontal wellbore? ... yes no
If yes, true vertical depth: _____
Bottom Hole Location: _____

AFFIDAVIT

The undersigned hereby affirms that the drilling, completion and eventual plugging of this well will comply with K.S.A. 55-101, et. seq.

It is agreed that the following minimum requirements will be met:

1. Notify the appropriate district office prior to spudding of well;
2. A copy of the approved notice of intent to drill shall be posted on each drilling rig;
3. The minimum amount of surface pipe as specified below shall be set by circulating cement to the top; in all cases surface pipe shall be set through all unconsolidated materials plus a minimum of 20 feet into the underlying formation;
4. If the well is dry hole, an agreement between the operator and the district office on plug length and placement is necessary prior to plugging;
5. The appropriate district office will be notified before well is either plugged or production casing is cemented in;
6. IF AN ALTERNATE II COMPLETION, PRODUCTION PIPE SHALL BE CEMENTED FROM BELOW ANY USABLE WATER TO SURFACE WITHIN 120 DAYS OF SPUD DATE. IN ALL CASES, NOTIFY DISTRICT OFFICE PRIOR TO ANY CEMENTING.

I hereby certify that the statements made herein are true and to the best of my knowledge and belief.
Date: 3-2-92 Signature of Operator or Agent: Alan J. DeGood Title: Vice-President

FOR KCC USE:
API # 15-171-20444-00-00
Conductor pipe required None feet
Minimum surface pipe required 270 feet per Alt.
Approved by: DA 3-3-92
This authorization expires: 9-3-92
(This authorization void if drilling not started within 6 months of effective date.)
Spud date: _____ Agent: _____

RECEIVED
STATE CORPORATION COMMISSION
MAR - 3 1992
CONSERVATION DIVISION
Wichita, Kansas

REMEMBER TO:

- File Drill Pit Application (form COP-1) with Intent to Drill;
- File Completion Form ACO-1 within 120 days of spud date;
- File acreage attribution plat according to field proration orders;
- Notify appropriate district office 48 hours prior to workover or re-entry;
- Submit plugging report (CP-4) after plugging is completed;
- Obtain written approval before disposing or injecting salt water.

Mail to: Conservation Division, 200 Colorado Derby Building, 202 W. First St., Wichita, Kansas 67202-1286.

IN ALL CASES PLOT THE INTENDED WELL ON THE PLAT BELOW

PLAT OF ACREAGE ATTRIBUTABLE TO A WELL IN A PRORATED OR SPACED FIELD

If the intended well is in a prorated or spaced field, please fully complete this side of the form. If the intended well is in a prorated or spaced field complete the plat below showing that the well will be properly located in relationship to other wells producing from the common source of supply. Please show all the wells within 1 mile of the boundaries of the proposed acreage attribution unit for gas wells and within 1/2 mile of the boundaries of the proposed acreage attribution unit for oil wells.

API NO. 15- _____
 OPERATOR American Energies Corporation
 LEASE Smith "G" #2
 WELL NUMBER "G" #2
 FIELD Wildcat

LOCATION OF WELL: COUNTY Scott
 2970 feet from south/~~north~~ line of section
 2310 feet from east/~~west~~ line of section
 SECTION 27 TWP 19 RG 33

NUMBER OF ACRES ATTRIBUTABLE TO WELL _____
 QTR/QTR/QTR OF ACREAGE SW - SW - NE

IS SECTION X REGULAR or _____ IRREGULAR
IF SECTION IS IRREGULAR, LOCATE WELL FROM NEAREST CORNER BOUNDARY.

Section corner used: _____ NE _____ NW _____ SE _____ SW

PLAT

(Show location of the well and shade attributable acreage for prorated or spaced wells.)
 (Show footage to the nearest lease or unit boundary line.)

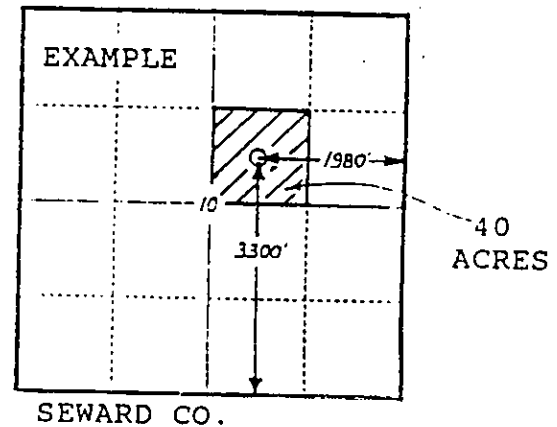
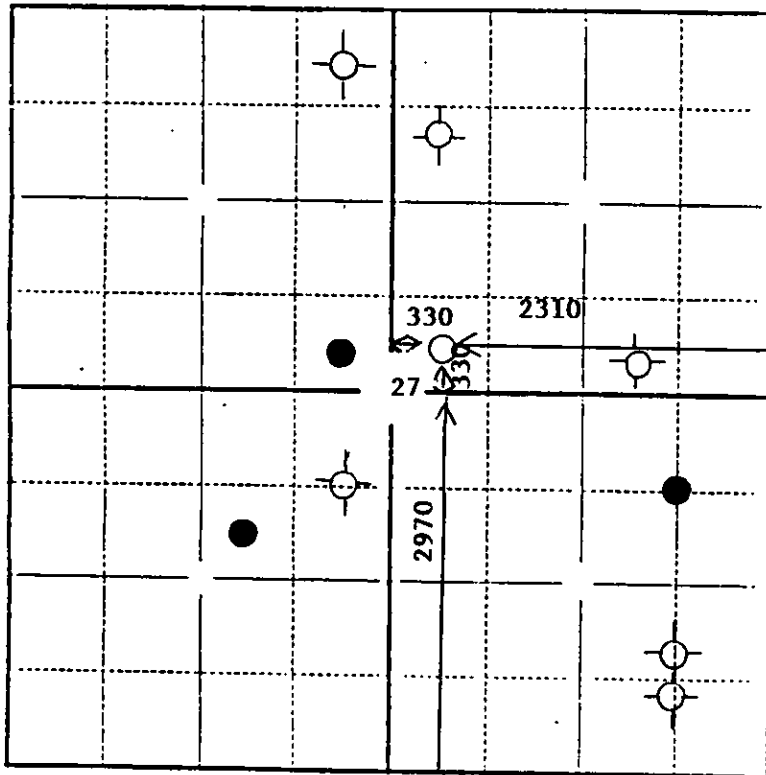

In plotting the proposed location of the well, you must show:

- 1) The manner in which you are using the depicted plat by identifying section lines, i.e. 1 section, 1 section with 8 surrounding sections, 4 sections, etc.;
- 2) the distance of the proposed drilling location from the section's south/north and east/west lines; and
- 3) the distance to the nearest lease or unit boundary line.