

FOR KCC USE:

15-171-20477-0000

FORM C-1 7/91
FORM MUST BE TYPED
FORM MUST BE SIGNED
Must be approved by the K.C.C.

EFFECTIVE DATE: 10-19-94

State of Kansas
ALL BLANKS MUST BE FILLED

NOTICE OF INTENTION TO DRILL DIST 1
five (5) days prior to commencing well

Spot NE NW SE Sec 22 Twp 19 S Rg 33 East West

Expected Spud Date 10 18 94
month day year

OPERATOR: License # 5003
Name: McCoy Petroleum Corporation
Address: 3017 N. Cypress, Wichita, KS
City/State/Zip: Wichita, KS 67226-4003
Contact Person: Tim Pierce
Phone: (316) 636-2737

CONTRACTOR: License # 5658
Name: Sweetman Drilling, Inc.

Well Drilled For: Well Class: Type Equipment:
X Oil Enh Rec Infield X Mud Rotary
Gas Storage Pool Ext Air Rotary
OWVO Disposal X Wildcat Cable
Seismic: # of Holes Other

If OWVO: old well information as follows:
Operator:
Well Name:
Comp. Date: Old Total Depth

Directional, Deviated or Horizontal wellbore? yes X no
If yes, true vertical depth:
Bottom Hole Location:

2310' feet from South-North line of Section
1650' feet from East-West line of Section
IS SECTION X REGULAR IRREGULAR?
(NOTE: Locate well on the Section Plat on Reverse Side)
County: Scott
Lease Name: Mary Clawson "A" Well #: 1-22
Field Name: Wildcat
Is this a Prorated/Spaced Field? yes X no
Target Formation(s): Lansing/KC, Marm, Morrow
Nearest lease or unit boundary: Miss. 330'
Ground Surface Elevation: 2960 est. feet MSW
Water well within one-quarter mile: X yes no
Public water supply well within one mile: yes X no
Depth to bottom of fresh water: 135
Depth to bottom of usable water: 1260
Surface Pipe by Alternate: 1 X 2
Length of Surface Pipe Planned to be set: (400+-) 200
Length of Conductor pipe required: 0
Projected Total Depth: 4750
Formation at Total Depth: St. Louis
Water Source for Drilling Operations:
X well farm pond other
DWR Permit #: To be applied for
Will Cores Be Taken?: yes X no
If yes, proposed zone:

AFFIDAVIT

The undersigned hereby affirms that the drilling, completion and eventual plugging of this well will comply with K.S.A. 55-101, et. seq.
It is agreed that the following minimum requirements will be met:

- 1. Notify the appropriate district office prior to spudding of well;
- 2. A copy of the approved notice of intent to drill shall be posted on each drilling rig;
- 3. The minimum amount of surface pipe as specified below shall be set by circulating cement to the top in all cases surface pipe shall be set through all unconsolidated materials plus a minimum of 20 feet into the underlying formation;
- 4. If the well is dry hole, an agreement between the operator and the district office on plug length and placement is necessary prior to plugging;
- 5. The appropriate district office will be notified before well is either plugged or production casing is cemented in;
- 6. IF AN ALTERNATE II COMPLETION, PRODUCTION PIPE SHALL BE CEMENTED FROM BELOW ANY USABLE WATER TO SURFACE WITHIN 120 DAYS OF SPUD DATE. IN ALL CASES, NOTIFY DISTRICT OFFICE PRIOR TO ANY CEMENTING.

I hereby certify that the statements made herein are true and to the best of my knowledge and belief.
Date: 10-12-94 Signature of Operator or Agent: Timothy J. Pierce Title: Geologist

FOR KCC USE:
API # 15- 171-20477-00-00
Conductor pipe required NONE feet
Minimum surface pipe required 200' feet per Alt. X @
Approved by: CB 10-14-94
This authorization expires: 4-14-95
(This authorization void if drilling not started within 6 months of effective date.)
Spud date: Agent:

REMEMBER TO:

- File Drill Pit Application (form CDP-1) with Intent to Drill;
- File Completion Form ACO-1 within 120 days of spud date;
- File acreage attribution plat according to field proration orders;
- Notify appropriate district office 48 hours prior to workover or re-entry;
- Submit plugging report (CP-4) after plugging is completed;
- Obtain written approval before disposing or injecting salt water.

Mail to: Conservation Division, 200 Colorado Derby Building, 202 W. First St., Wichita, Kansas 67202-1286.

RECEIVED
STATE OF KANSAS
OCT 14 1994

CONSERVATION DIVISION
WICHITA, KANSAS

22-19-33

IN ALL CASES PLOT THE INTENDED WELL ON THE PLAT BELOW

PLAT OF ACREAGE ATTRIBUTABLE TO A WELL IN A PRORATED OR SPACED FIELD

If the intended well is in a prorated or spaced field, please fully complete this side of the form. If the intended well is in a prorated or spaced field complete the plat below showing that the well will be properly located in relationship to other wells producing from the common source of supply. Please show all the wells within 1 mile of the boundaries of the proposed acreage attribution unit for gas wells and within 1/2 mile of the boundaries of the proposed acreage attribution unit for oil wells.

API NO. 15- _____
 OPERATOR McCoy Petroleum Corporaton
 LEASE Mary Clawson "A"
 WELL NUMBER #1-22
 FIELD Wildcat

LOCATION OF WELL: COUNTY Scott
2310 feet from ~~south~~/north line of section
1650 feet from east/~~west~~ line of section
 SECTION 22 TWP 19S RG 33W

NUMBER OF ACRES ATTRIBUTABLE TO WELL 40
 QTR/QTR/QTR OF ACREAGE _____ - NW - SE

IS SECTION X REGULAR or _____ IRREGULAR
IF SECTION IS IRREGULAR, LOCATE WELL FROM NEAREST CORNER BOUNDARY.

Section corner used: _____ NE _____ NW _____ SE _____ SW

PLAT

(Show location of the well and shade attributable acreage for prorated or spaced wells.)
 (Show footage to the nearest lease or unit boundary line.)

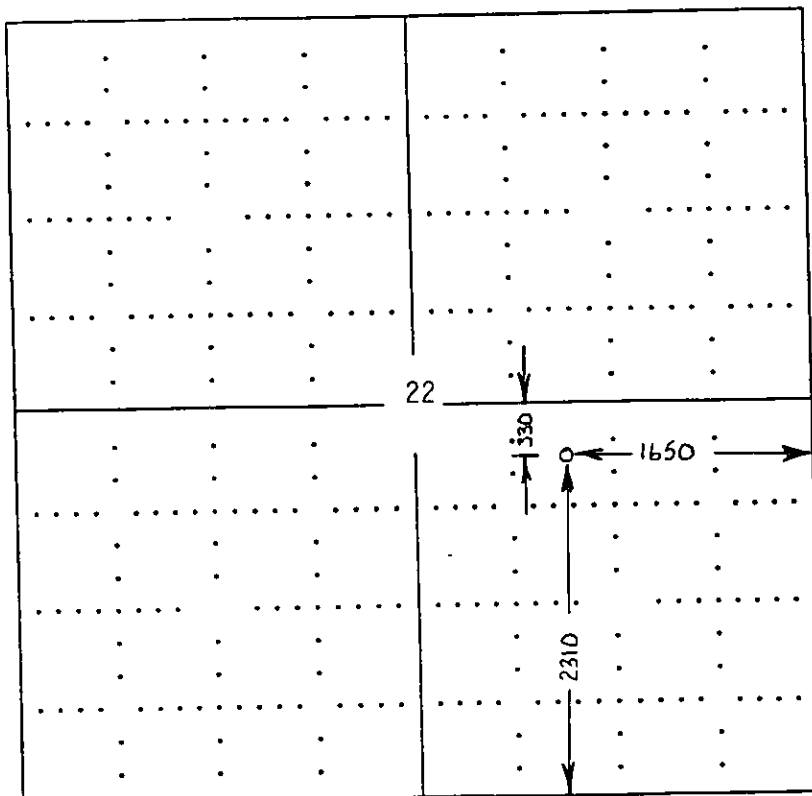

Scott County, KS

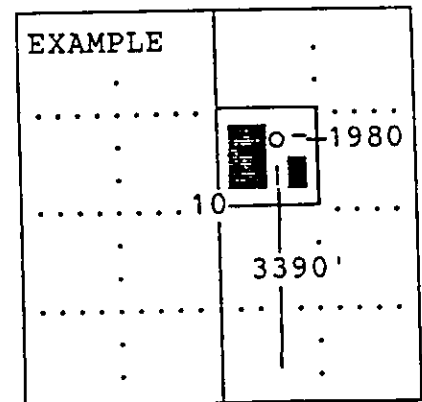

SEWARD CO.

In plotting the proposed location of the well, you must show:

- 1) The manner in which you are using the depicted plat by identifying section lines, i.e. 1 section, 1 section with 8 surrounding sections, 4 sections, etc.;
- 2) the distance of the proposed drilling location from the section's south/north and east/west; and
- 3) the distance to the nearest lease or unit boundary line.