

WELL PLUGGING RECORD

OR FORMATION PLUGGING RECORD

Strike out upper line when reporting plugging off formations.

STATE OF KANSAS STATE CORPORATION COMMISSION

Give All Information Completely Make Required Affidavit Mail or Deliver Report to: Conservation Division State Corporation Commission 800 Bittling Building Wichita, Kansas

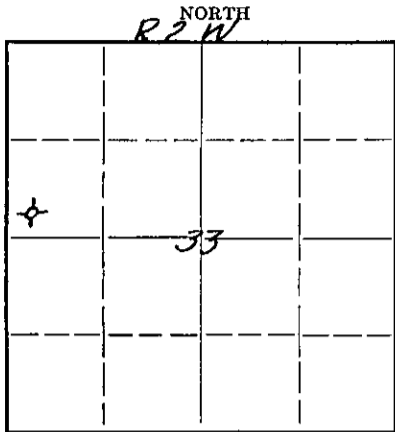

Locate well correctly on above Section Plat

Saline County. Sec. 33 Twp. 14S. Rge. 17/2 (W) Location as "NE1/4NW1/4SW1/4" or footage from lines SW1/4 SW1/4 NW1/4 Lease Owner E.S. Adkins Lease Name Craig Well No. 1 Office Address 912 Philtower, Tulsa, Oklahoma Character of Well (completed as Oil, Gas or Dry Hole) Dry & Abandoned Date well completed January 30 1944 Application for plugging filed January 30 1944 Application for plugging approved January 30 1944 Plugging commenced January 30 1944 Plugging completed January 30 1944 Reason for abandonment of well or producing formation No oil or gas If a producing well is abandoned, date of last production None 19 Was permission obtained from the Conservation Division or its agents before plugging was commenced? Yes

Name of Conservation Agent who supervised plugging of this well Producing formation Depth to top Bottom Total Depth of Well 3448 Feet Show depth and thickness of all water, oil and gas formations.

OIL, GAS OR WATER RECORDS

CASING RECORD

Table with 7 columns: Formation, Content, From, To, Size, Put In, Pulled Out. The table is currently empty.

Describe in detail the manner in which the well was plugged, indicating where the mud fluid was placed and the method or methods used in introducing it into the hold. If cement or other plugs were used, state the character of same and depth placed, from feet to feet for each plug set.

Finished running Schlumberger and laid down drill pipe. Set bridge at 250'; dumped in 15 sacks of Regular Cement and filled with Rotary Mud to 50'; then dumped in ten sacks of Regular Cement. Cut off 10" surface casing 3' below the surface and welded a plate over the 10" surface casing. The cellar hole is open 3' deep 4x4.

Finished at 12:00 Noon, 1-30-44.

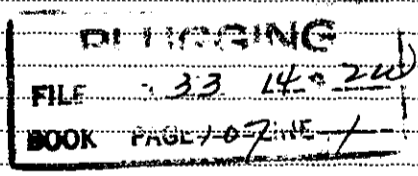

(If additional description is necessary, use BACK of this sheet)

Correspondence regarding this well should be addressed to J. Leighton Avery Address 912 Philtower, Tulsa, Oklahoma

STATE OF Oklahoma, COUNTY OF Tulsa, ss. J. Leighton Avery (employee of owner) or (owner or operator) of the above-described well, being first duly sworn on oath, says: That I have knowledge of the facts, statements, and matters herein contained and the log of the above-described well as filed and that the same are true and correct. So help me God.

(Signature) J. Leighton Avery (Address) 912 Philtower, Tulsa, Okla.

SUBSCRIBED AND SWORN to before me this 15th day of February, 1944

Notary Public. [Signature]

My commission expires July 11, 1946

Craig #1  
SW/4 SW/4 NW/4 Section 33-14S-W  
Saline County, Kansas  
E. S. Adkins

15-169-00151-00-00

Commenced: January 4, 1944  
 Completed: January 30, 1944

Surface clay and sand	0	85	:
Shale and shells	85	280	
Anhydrite and shale	250	275	
Shale and shells	275	285	
Lime and shale	385	390	
Red bed	390	410	
Lime and shale	410	2095	
Lime	2095	2395	
Lime and shale	2395	2435	
Shale	2435	2485	
Shale and lime	2485	2755	
Mississippi lime	2755	2770	
Lime	2770	2959	
Shale	2959	3085	
Lime	3085	3185	
Lime and shale	3185	3262	
Viola lime	3262	3272	
Lime	3272	3434	
Simpson sand	3434	3448	
TOTAL DEPTH	3448		

Casing Record:

10 3/4" casing set at 248' and cemented with  
 150 sacks cement

STATE OF OKLAHOMA )  
 ) ss.  
 COUNTY OF TULSA )

I hereby affirm that the above and foregoing is a true and correct copy of the log of your Craig Well No. 1, located in the Southwest Quarter of the Southwest Quarter of the Northwest Quarter of Section 33, Township 14 South, Range 2 West, Saline County, Kansas.

HELMERICH & PAYNE, INC.

By Lillian Brown  
 Treasurer

Subscribed and sworn to before me, a Notary Public, this 11th day of February, 1944.

O. V. Miller  
 Notary Public

My commission expires October 18, 1947.

PLUGGING  
 FILE 33 14-24  
 BOOK 6-127-5-1