

STATE OF KANSAS
STATE CORPORATION COMMISSION
200 Colorado Derby Building
Wichita, Kansas 67202

WELL PLUGGING RECORD
K.A.R.-82-3-117

API NUMBER 15-169-20,146-0000

LEASE NAME Miller "B"

WELL NUMBER 2

2970 Ft. from S Section Line

3630 Ft. from E Section Line

SEC. 31 TWP. 14 RGE. 2W (●) or (W)

COUNTY Saline

LEASE OPERATOR Range Oil Co.

ADDRESS 1120 KSB & T Bldg. 125 N. Market Wichita, Kansas

PHONE # (316) 265-6231 OPERATORS LICENSE NO. 5120

Date Well Completed 9-6-81

Character of Well SWD

Plugging Commenced 7-29-91

(Oil, Gas, D&A, SWD, Input, Water Supply Well)

Plugging Completed 8-2-91

The plugging proposal was approved on 7-29-91 (date)

by Phil Worley (KCC District Agent's Name);

Is ACO-1 filed? yes If not, is well log attached? yes

Producing Formation Mg./Hunton Depth to Top 3055 Bottom 3228 T.D. 3300

Show depth and thickness of all water, oil and gas formations.

OIL, GAS OR WATER RECORDS

CASING RECORD

STATE CORPORATION COMMISSION

RECEIVED

Formation	Content	From	To	Size	Put in	Pulled out
	water	0	207	8 5/8	207	none
	water	0	3299	4 1/2	3299	422 ft

AUG 13 1991

Describe in detail the manner in which the well was plugged, indicating where the mud fluid was placed and the method or methods used in introducing it into the hole. If cement or other plugs were used, state the character of same and depth placed, from feet to feet each set.

Sand back to 3000 ft, spot 5 sacks cement, pull pipe, bail to 260 ft slurry mix to surface, cut off and backfill

(If additional description is necessary, use BACK of this form.)

Name of Plugging Contractor VAL Energy, Inc. License No. 5822

Address Box 322 Haysville, Ks. 67060

NAME OF PARTY RESPONSIBLE FOR PLUGGING FEES: Range Oil Co.

STATE OF Kansas COUNTY OF Sedgwick, ss.

K. Todd Allam (Employee of Operator) or (Operator) of above-described well, being first duly sworn on oath, says: That I have knowledge of the facts, statements, and matters herein contained and the log of the above-described well as filed that the same are true and correct, so help me God.

(Signature) K Todd Allam

(Address) Wichita, Ks.

SUBSCRIBED AND SWORN TO before me this 9th day of August, 19 91

My Commission Expires:

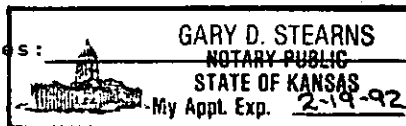

Notary Public

KANSAS

WELL COMPLETION REPORT AND DRILLER'S LOG

API No. 15 — 169 — 20,146 -00-00
County Number

S. 31 T. 14 R. 2 ³⁶W

Loc. SE SW NW

County Saline

Operator
Range Oil Company, Inc.

Address
240 Page Court, 220 W. Douglas, Wichita, Ks 67202

Well No. 2 Lease Name Miller "B"

Footage Location
330 feet from (N) (S) line 990 feet from (E) (W) line

Principal Contractor Range Drlg. Co., Inc. Geologist Bob Olsen

Spud Date 8-26-81 Date Completed 9-6-81 Total Depth 3300 P.B.T.D.

Directional Deviation Oil and/or Gas Purchaser

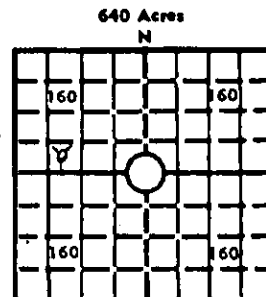

Elev.: Gr. 1229
DF KB 1236

CASING RECORD

Report of all strings set — surface, intermediate, production, etc.

Purpose of string	Size hole drilled	Size casing set (in O.D.)	Weight lbs/ft.	Setting depth	Type cement	Sacks	Type and percent additives
Surface	12 1/2	8 5/8		207	Common	130	3% CaCl
Production	7 7/8	4 1/2		3299	Common	75	10% Salt 2% Gel 6# G11/sx

LINER RECORD

PERFORATION RECORD

Top, ft.	Bottom, ft.	Sacks cement	Shots per ft.	Size & type	Depth interval
TUBING RECORD			3		3224-3228
Size	Setting depth	Packer set at	3		3055-3110

ACID, FRACTURE, SHOT, CEMENT SQUEEZE RECORD

Amount and kind of material used	Depth interval treated
50 gal 15% SGA	3224-3228
2000 gal 15% Req. Acid	3055-3110

RECEIVED
STATE CORPORATION COMMISSION

JUN 24 1991

CONSERVATION DIVISION
Wichita, Kansas

INITIAL PRODUCTION

Date of first production		Producing method (flowing, pumping, gas lift, etc.)			
RATE OF PRODUCTION PER 24 HOURS	Oil bbls.	Gas MCF	Water bbls.	Gas-oil ratio	CFPB
Disposition of gas (vented, used on lease or sold)			Producing Interval (s)		

INSTRUCTIONS: As provided in KCC Rule 82-2-125, within 90 days after completion of a well, one completed copy of this Drillers Log shall be transmitted to the State Geological Survey of Kansas, 4150 Monroe Street, Wichita, Kansas 67209. Copies of this form are available from the Conservation Division, State Corporation Commission, 245 No. Water, Wichita, Kansas 67202. Phone AC 316-522-2206. If confidential custody is desired, please note Rule 82-2-125. Drillers Logs will be on open file in the Oil and Gas Division, State Geological Survey of Kansas, Lawrence, Kansas 66044.

Operator Range Oil Company, Inc.		DESIGNATE TYPE OF COMP.: OIL, GAS, DRY HOLE, SWDW, ETC.:
Well No. 2	Lease Name Miller "B"	SWDW
S 31 T 14 R 2 ^{EX} W		

WELL LOG

Show all important zones of porosity and contents thereof; cased intervals, and all drill-stem tests, including depth interval tested, cushion used, time tool open, flowing and shut-in pressures, and recoveries.

SHOW GEOLOGICAL MARKERS, LOGS RUN, OR OTHER DESCRIPTIVE INFORMATION.

FORMATION DESCRIPTION, CONTENTS, ETC.	TOP	BOTTOM	NAME	DEPTH
---------------------------------------	-----	--------	------	-------

API # 15-169-20,146

Spl. Datum E. Log Datum Struct. Comp.

Date *Est 7 days*

C.G.				
NE				
AD. SD.				
HD.				
SE				
TOP				
PK				
HO. SD.				
HC. I.S.				
IA				
ST				
PE. LS.				
PE. SD.				
HOG				
LY				
KC	2179	-943	2180	-944 11 ↓
BKC	2358	-1122	2358	-1122 11 ↓
CV				
OS				
CK				
CT				
BV				
Miss	2654	-1418	2659	-1423 8 ↓
Miss	2675	-1439	2675	-1439 16 ↓
Kd	2929	-1693	2935	-1699 1 ↑
RTD	3300	-2064		
LTD			3300	-2064
Ht	3041	-1805	3051	-1815 2 ↑
Hg sh	3145	-1909	3146	-1910 3 ↓
Hg dol	3223	-1987	3223	-1987 3 ↓
Viola	3278	-2042	3280	-2044

8-31-81	MIRT
9-1-81	7:00 am Drlg @ 800 1° @ 496
9-2-81	7:00 am Drlg @ 1940 0° @ 1020 3/4° @ 1791
9-3-81	7:00 am Drlg @ 2590 2° @ 2008 1 1/2° @ 2501
9-4-81	8:30 am Circ @ 3228 Preparing for DST(1)
9-5-81	8:00 am RTD 3300 Preparing for E-Log DST(1) 3224-3228 Mis-run (Hole in Pipe)
9-6-81	7:00 am RTD 3300 Ran Petro-Log Set 4 1/2" csg @ 3299 w/ 75 sk Range cem Plug down @ 9:30 p.m. on 9-5-81 Plug held

Plug down @ 9:30 pm on 9-5-81 ; Plug held

USE ADDITIONAL SHEETS, IF NECESSARY, TO COMPLETE WELL RECORD.

Date Received	 Signature
	Geological Secretary Title
	10-15-81 Date