

CONFIDENTIAL

KANSAS CORPORATION COMMISSION
OIL & GAS CONSERVATION DIVISION

ORIGINAL

Form AGO-1
October 2008
Form Must Be Typed

1/13/10¹²

WELL COMPLETION FORM
WELL HISTORY - DESCRIPTION OF WELL & LEASE

OPERATOR: License # 9855

Name: Grand Mesa Operating Company

Address 1: 1700 N. Waterfront Pkwy, Bldg 800

Address 2: _____

City: Wichita State: KS Zip: 67206 + 5 5 1 4

Contact Person: Ronald N. Sinclair

Phone: (316) 265-3000

CONTRACTOR: License # 30606

Name: Murfin Drilling Company

Wellsite Geologist: Steven P. Carl

Purchaser: NCRA

Designate Type of Completion:

New Well Re-Entry Workover

Oil SWD SIOW

Gas ENHR SIGW

CM (Coal Bed Methane) Temp. Abd.

Dry Other

(Core, WSW, Expl., Cathodic, etc.)

If Workover/Re-entry: Old Well Info as follows:

Operator: _____

Well Name: _____

Original Comp. Date: _____ Original Total Depth: _____

Deepening Re-perf. Conv. to Enhr. Conv. to SWD

Plug Back: _____ Plug Back Total Depth _____

Commingled Docket No.: _____

Dual Completion Docket No.: _____

Other (SWD or Enhr.?) Docket No.: _____

10/26/2009 11/06/2009 11/27/2009

Spud Date or
Recompletion Date Date Reached TD Completion Date or
Recompletion Date

API No. 15 - 063-21808-00-00

Spot Description: 340' FLN & 1510' FWL

SW NW NE NW Sec. 32 Twp. 13 S. R. 31 East West

340 Feet from North / South Line of Section

1510 Feet from East / West Line of Section

Footages Calculated from Nearest Outside Section Corner:

NE NW SE SW

County: GOVE

Lease Name: Hess Well #: 2-32

Field Name: Wildcat

Producing Formation: Lansing & Cherokee Zones

Elevation: Ground: 2920' Kelly Bushing: 2925'

Total Depth: 4620' Plug Back Total Depth: 4609'

Amount of Surface Pipe Set and Cemented at: 5jts @ 218 Feet

Multiple Stage Cementing Collar Used? Yes No

If yes, show depth set: 2398' Feet

If Alternate II completion, cement circulated from: 2398'

feet depth to: Surface w/ 175 ax cmt.

Drilling Fluid Management Plan At 11/27/09 to 10/10
(Data must be collected from the Reserve #)

Chloride content: 11,500 ppm Fluid volume: 500 bbls

Dewatering method used: Evaporation and backfill.

Location of fluid disposal if hauled offsite: _____

Operator Name: _____

Lease Name: _____ License No.: _____

Quarter _____ Sec. _____ Twp. _____ S. R. _____ East West

County: _____ Docket No.: _____

INSTRUCTIONS: An original and two copies of this form shall be filed with the Kansas Corporation Commission, 130 S. Market - Room 2078, Wichita, Kansas 67202, within 120 days of the spud date, recompletion, workover or conversion of a well. Rule 82-3-130, 82-3-106 and 82-3-107 apply. Information of side two of this form will be held confidential for a period of 12 months if requested in writing and submitted with the form (see rule 82-3-107 for confidentiality in excess of 12 months). One copy of all wireline logs and geologist well report shall be attached with this form. ALL CEMENTING TICKETS MUST BE ATTACHED. Submit CP-4 form with all plugged wells. Submit CP-111 form with all temporarily abandoned wells.

All requirements of the statutes, rules and regulations promulgated to regulate the oil and gas industry have been fully complied with and the statements herein are complete and correct to the best of my knowledge.

Signature: [Signature] /RONALD N. SINCLAIR

Title: President Date: January 12, 2010

Subscribed and sworn to before me this 12th day of January

20 10

Notary Public: [Signature] /PHYLLIS E. BREWER

Date Commission Expires: July 21, 2011

KCC Office Use ONLY

Letter of Confidentiality Received

If Denied, Yes Date: _____

Wireline Log Received

Geologist Report Received

UIC Distribution

RECEIVED
JAN 14 2010

PHYLLIS E. BREWER
Notary Public - State of Kansas
My Appt. Expires 7-21-11

KCC WICHITA

Operator Name: Grand Mesa Operating Company Lease Name: Hess Well #: 2-32
 Sec. 32 Twp. 13 S. R. 31 East West County: GOVE

INSTRUCTIONS: Show important tops and base of formations penetrated. Detail all cores. Report all final copies of drill stems tests giving interval tested, time tool open and closed, flowing and shut-in pressures, whether shut-in pressure reached static level, hydrostatic pressures, bottom hole temperature, fluid recovery, and flow rates if gas to surface test, along with final chart(s). Attach extra sheet if more space is needed. Attach copy of all Electric Wireline Logs surveyed. Attach final geological well site report.

Drill Stem Tests Taken <input checked="" type="checkbox"/> Yes <input type="checkbox"/> No <i>(Attach Additional Sheets)</i> Samples Sent to Geological Survey <input checked="" type="checkbox"/> Yes <input type="checkbox"/> No Cores Taken <input type="checkbox"/> Yes <input checked="" type="checkbox"/> No Electric Log Run <input checked="" type="checkbox"/> Yes <input type="checkbox"/> No <i>(Submit Copy)</i> List All E. Logs Run: Measured Depth Compact Photo Den/Neutron Log, Measured Depth Array Ind. Ele. Log, Measured Depth Comp. Sonic w/Transit. Time, Measured Depth Micro Res. Log, Cement Bnd Log.	<input checked="" type="checkbox"/> Log Formation (Top), Depth and Datum <input type="checkbox"/> Sample Name Top Datum *SEE ATTACHED SHEET W/ LOG TOPS* <div style="text-align: right; font-weight: bold; font-size: 1.2em;"> RECEIVED JAN 14 2010 KCC WICHITA </div>
--	---

CASING RECORD <input checked="" type="checkbox"/> New <input type="checkbox"/> Used							
Report all strings set-conductor, surface, intermediate, production, etc.							
Purpose of String	Size Hole Drilled	Size Casing Set (In O.D.)	Weight Lbs. / FL	Setting Depth	Type of Cement	# Sacks Used	Type and Percent Additives
Surface	12 1/4"	8 5/8"	24#	218	Common	150	3%CC, 2% Gel
Production	7 7/8"	5 1/2"	15.5#	4619	SMD	265	Stage 2

ADDITIONAL CEMENTING / SQUEEZE RECORD				
Purpose:	Depth Top Bottom	Type of Cement	#Sacks Used	Type and Percent Additives
<input type="checkbox"/> Perforate <input type="checkbox"/> Protect Casing <input type="checkbox"/> Plug Back TD <input type="checkbox"/> Plug Off Zone <input checked="" type="checkbox"/> Protect fresh water	0-2398'	EA-2	175	

Shots Per Foot	PERFORATION RECORD - Bridge Plugs Set/Type Specify Footage of Each Interval Perforated	Acid, Fracture, Shot, Cement Squeeze Record (Amount and Kind of Material Used)	Depth
4	4523-4529', 4513-4517', 4457-4463'	Acid job - 1,300 gal. 15% MCA Acid	4375'
4	4422-4434', 4166-4178', 4149-4160'	85 Ball sealers	
4	4118-4122', 4103-4108'	Acid job - 1,500 gal. 15% MCA Acid	4052'
		100 Ball sealers	

TUBING RECORD: Size: <u>2 7/8"</u> Set At: <u>4602'</u> Packer At: <u> </u> Liner Run: <input type="checkbox"/> Yes <input checked="" type="checkbox"/> No	
Date of First, Resumed Production, SWD or Enhr. <u>November 27, 2009</u>	Producing Method: <input type="checkbox"/> Flowing <input checked="" type="checkbox"/> Pumping <input type="checkbox"/> Gas Lift <input type="checkbox"/> Other (Explain) <u> </u>
Estimated Production Per 24 Hours	Oil Bbls. <u>250</u> Gas Mcf <u> </u> Water Bbls. <u>50</u> Gas-Oil Ratio <u> </u> Gravity <u> </u>

DISPOSITION OF GAS: <input type="checkbox"/> Vented <input type="checkbox"/> Sold <input type="checkbox"/> Used on Lease <i>(If vented, Submit ACO-18.)</i>	METHOD OF COMPLETION: <input type="checkbox"/> Open Hole <input checked="" type="checkbox"/> Perf. <input type="checkbox"/> Dually Comp. <input checked="" type="checkbox"/> Commingled <input type="checkbox"/> Other (Specify) <u> </u>	PRODUCTION INTERVAL: <u>Commingled zones</u>
---	---	---

Hess 2-32
Sec. 32-13S-31W
Gove County, Kansas
Grand Mesa Operating Company
Spud 10/26/09
TD 11/06/09

LOG TOPS - HOLD CONFIDENTIAL 2 YEARS

Name	Top	Datum
Stone Corral	2398	+ 527
Bs/Stone Corral	2420	+ 505
Heebner	3808	- 983
Lansing	3950	-1025
Muncie Creek	4100	-1175
Stark Shale	4186	-1261
Hushpuckney Shale	4224	-1299
Bs/KC	4253	-1328
Marmaton	4281	-1356
Little Osage Shale	4409	-1484
Excello Shale	4434	-1509
Johnson Zone	4511	-1586
Morrow Shale	4533	-1608
Mississippian	4552	-1627
LTD	4618	

JAN 12 2010

RECEIVED
JAN 14 2010
KCC WICHITA

ALLIED CEMENTING CO., LLC. 044332

REMIT TO P.O. BOX 31
RUSSELL, KANSAS 67665

SERVICE POINT: Dakley, KS

DATE <u>10/24/09</u>	SEC <u>32</u>	TWP <u>13</u>	RANGE <u>31</u>	CALLED OUT	ON LOCATION <u>4:30</u>	JOB START <u>5:00pm</u>	JOB FINISH <u>5:30pm</u>
LEASE <u>Hess</u>	WELL # <u>2-32</u>	LOCATION <u>Dakley 11S 3E 4 1/2 S Einto</u>		COUNTY <u>Gove</u>	STATE <u>Ks</u>		
OLD OR NEW (Circle one) <u>NEW</u>							

CONTRACTOR Marlin 24

TYPE OF JOB Surface

HOLE SIZE 12 1/4 T.D. 218'

CASING SIZE 8 1/8 DEPTH 218'

TUBING SIZE DEPTH

DRILL PIPE DEPTH

TOOL DEPTH

PRES. MAX MINIMUM

MEAS. LINE SHOE JOINT

CEMENT LEFT IN CSG. 15'

PERFS.

DISPLACEMENT 12.93

OWNER Same

CEMENT

AMOUNT ORDERED 150 SKI Co 370 CC
270 gel

COMMON	<u>105 150</u>	@	<u>15.45</u>	<u>2319.50</u>
POZMIX		@		
GEL	<u>3</u>	@	<u>20.00</u>	<u>62.40</u>
CHLORIDE	<u>5</u>	@	<u>58.00</u>	<u>291.00</u>
ASC		@		

EQUIPMENT

PUMP TRUCK CEMENTER Alan

422 HELPER Wayne

BULK TRUCK

377 DRIVER Terry

BULK TRUCK

DRIVER

RECEIVED

JAN 1 2010

KCC WICHITA

HANDLING	<u>1.58</u>	@	<u>2.40</u>	<u>379.20</u>
MILEAGE	<u>104 / sk / mile</u>	-	<u>Minivan</u>	<u>312.00</u>
TOTAL				<u>3362.10</u>

REMARKS:

Cement Did Circulate

Thank You
Alan, Wayne, Terry

CHARGE TO: Grand Mesa

STREET _____

CITY _____ STATE _____ ZIP _____

SERVICE

DEPTH OF JOB	<u>218'</u>			
PUMP TRUCK CHARGE				<u>1018.00</u>
EXTRA FOOTAGE		@		
MILEAGE	<u>200 13</u>	@	<u>7.00</u>	<u>1400.00</u>
MANIFOLD		@		<u>91.00</u>
TOTAL				<u>1109.00</u>

PLUG & FLOAT EQUIPMENT

	@			
	@			
	@			
	@			
	@			

TOTAL _____

SALES TAX (If Any) _____

TOTAL CHARGES _____

DISCOUNT _____ IF PAID IN 30 DAYS

To Allied Cementing Co., LLC.
You are hereby requested to rent cementing equipment and furnish cementer and helper(s) to assist owner or contractor to do work as is listed. The above work was done to satisfaction and supervision of owner agent or contractor. I have read and understand the "GENERAL TERMS AND CONDITIONS" listed on the reverse side.

PRINTED NAME Anthony Martin

SIGNATURE Anthony Martin

JOBLOG

SWIFT Services, Inc.

DATE 11-6-09 PAGE NO. 1

CUSTOMER Grand Mesa WELL NO. #2-32 LEASE Hess JOB TYPE 2-stage TICKET NO. 16764

CHART NO.	TIME	RATE (BPM)	VOLUME (BBL) (GAL)	PUMPS		PRESSURE (PSI)		DESCRIPTION OF OPERATION AND MATERIALS
				T	C	TUBING	CASING	
	2030							on loc w/FE
								RTD 4620'
								5 1/2" x 15.5" x 4620' x 10'
								Cent. 1, 3, 5, 7, 9, 11, 13, 15, 17, 50
								Back. 51, 6
								D.V. 51 @ 2398'
	2050							Start FE
	2300							Break circ
	2325	3.5	0			150		Start Preflushes 500 gal Mud flush 20 bbl KCL flush
	2334	5.5	32/0			200		Start Cement 125 sks EA-2
	2340		42					End Cement
								wash P/L
								Drop Plug
	2344	6	0			200		Start Displacement
	2354	6	60			200		start mud
	2357	5	80			300		Catch Cement
	0003		110			750/200		Land Plug
								Release Pressure Float Hold
	0007							Drop Operating Plug
	0020					1200		Open DV
	0025							Huck up to Rig Circ. 4 hrs
	0435		7/4					Plug RH MP 35 sks SMD
	0445	4	0			100		Start KCL Flush
	0450	5	20/0			150		Start Cement 265 sks SMD
	0517		147					End Cement
								Drop Plug
	0520	5	0			100		Start Displacement
			0					circ cement
		5	12			150		catch Cement
	0530		57			550/1500		Land Plug
								Close DV
								Release Pressure / DV Closed

Mike [Signature]
John [Signature]
 Circ 100 sks to pit

RECEIVED
 JAN 14 2010
 KCC WICHITA

Thank you
 Nick, Josh F, & Shane

JOB LOG

SWIFT Services, Inc.

DATE 11-18-09 PAGE NO. 1

CUSTOMER GRANOMESA WELL NO. 2-32 LEASE Hess JOB TYPE ACIDIZ. PERM TICKET NO. 16653

CHART NO.	TIME	RATE (BPM)	VOLUME (FBL) (GAL)	PUMPS		PRESSURE (PSI)		DESCRIPTION OF OPERATION AND MATERIALS
				T	C	TUBING	CASING	
	1205							ON LOCATION ACID: 1300GALS 15% MCA 85 PERM PAC BALLS 2 7/8 X 5 1/2 PERM 4375, PERM 4422 TO 4529
	1215	3.0	0	✓		0		START ACID
			7.0	✓		0		START BALLS THRU 700GALS ACID
			24.0	✓		0		BALLS IN
		.2	26.0	✓		1000		HOLE LOAD ACID
		.5	27.0	✓		850		ACID IN TOP PERM
		1.0	29.0	✓		500		ACID OVER PERM
		2.0	31.0	✓		600		START FLUSH
		2.0	36.0	✓		500		BALLS IN PERM NO BALL ACTION
		2.0	42.0	✓		475		
		3.0	46.0	✓		600		INC RATE
		3.0	60.0	✓		600		END WQ
	1300	2	60.0	✓		400		ISFP
	1305			✓		300		5 MIN
	1310			-		250		10 "
	1315			-		200		15 "
	1320			-		150		20 "
	1325			-		100		25 " TO THE LOAD (500 blks)
	1330			-		20		30 min
	1335			-		VAC		3 min
	1400							JOB COMPLETE

RECEIVED

JAN 14 2010

THANK YOU!
DAVE & JESSIE B.

KCC WICHITA

JOB LOG

SWIFT Services, Inc.

DATE 11-19-09 PAGE NO. 7

CUSTOMER		WELL NO.		LEASE		JOB TYPE		TICKET NO.	
GRAND MESA		2-32		HESS		ACIDIZING FORMATION		17189	
CHART NO.	TIME	RATE (BPM)	VOLUME (BBL) GAL	PUMPS		PRESSURE (PSI)		DESCRIPTION OF OPERATION AND MATERIALS	
				T	C	TUBING	CASING		
	1400								ON LOCATION
									2 7/8 x 5 1/2
									PERFS = 4103-08 4118-22 4149-60 4166-78
									RBP = 4223'
									PRR = 4052 TREAT 4180 SAT
	1515		13	✓					SPOT ACID = 4180
	1525								PULL UP SET PRR = 4052
	1532	3		✓		0			START ACID W/ BALLS - 100 GA IN 700 GAL ACID
		3/4	27	✓		0			" TREAT FORMATION
		1 1/2	29	✓		0			" "
		3	32	✓		0			" "
		3	36	✓		100			" " ACID PUMPED
	1540	3	0	✓		100			START FLUSH
		3	6	✓		150			"
		3	12	✓		225			"
		3	20	✓		250			"
		3	26 1/2	✓		250			" ACID CLEAR
	1548	3	27 1/2	✓		250			" 1 BBL OVERFLOW - SHUT DOWN
						200			2500
						VAC			1 MIN
									RECEIVED
									LOAD = 63 1/2
									JAN 14 2010
	1630								JOB COMPLETE
									KCC WICHITA
									THANK YOU
									WAYNE, JASON R., ROGER B.

KANSAS
CORPORATION COMMISSION

Mark Parkinson, Governor
Thomas E. Wright, Chairman
Michael C. Moffet, Commissioner
Joseph F. Harkins, Commissioner

April 8, 2010

Steve Stribling
Grand Mesa Operating Company
1700 N. Waterfront Parkway
Wichita, KS 67206

RE: Approved Commingling CO031002
Hess 2-32, Sec. 32-T13S-R31W, Gove County
API No. 15-063-21808-00-00

Dear Mr. Stribling:

Your Application for Commingling (ACO-4) for the above described well has been reviewed and approved by the Kansas Corporation Commission (KCC) per K.A.R. 82-3-123. Notice was examined and found to be proper per K.A.R. 82-3-135a. No protest had been filed within the 15-day protest period. This application, which was received by the KCC on March 3, 2010 concerns approval to simultaneously produce from the following sources of supply through the same tubing string in the same wellbore:

Source of Supply	Estimated Current Production			Perf Depth
	BOPD	MCFPD	BWPD	
LKC H/LKC I	18	0	42	4103-07/4149-4159
Marmaton	22	0	0	4318-4322
Ft Scott	22	0	0	4422-4432
Cherokee	22	0	0	4457-4462
Johnson	22	0	0	4512-4517/4523-4527
Total Estimated Current Production	106	0	42	

Based upon the depth of the Johnson formation perforations, total oil production shall not exceed 200 BOPD and total gas production shall not exceed 50% of the absolute open flow (AOF).

Docket Number CO031002 has been assigned to this approved application. Use this number for well completion reports (ACO-1) and other correspondence that may concern this approved commingling.

Sincerely,



Rick Hestermann
Production Department

Confidential to 1/13/2012

KANSAS CORPORATION COMMISSION
OIL & GAS CONSERVATION DIVISION

Form ACO-4
Form must be typed
March 2009

APPLICATION FOR COMMINGLING OF
PRODUCTION (K.A.R. 82-3-123) OR FLUIDS (K.A.R. 82-3-123a)

Commingling ID # C0031002

OPERATOR: License # 9855
Name: Grand Mesa Operating Company
Address 1: 1700 N. Waterfront Parkway
Address 2: Building 600
City: Wichita State: KS Zip: 67206 +
Contact Person: Steve Stribling
Phone: (316) 265-3000

API No. 15 - 063-21808-00-00
Spot Description: 32 per ACO-1
SW NW NE NW Sec. 21 Twp. 13 S. R. 31 East West
340 Feet from North / South Line of Section
1,510 Feet from East / West Line of Section
County: Gove
Lease Name: Hess Well #: 2-32

- 1. Name and upper and lower limit of each production interval to be commingled:

Formation: <u>LKC H/LKC I</u>	(Perfs): <u>4103-07/ 4149-59</u>
Formation: <u>Marmaton</u>	(Perfs): <u>4318-4322</u>
Formation: <u>Ft Scott</u>	(Perfs): <u>4422-4432</u>
Formation: <u>Cherokee</u>	(Perfs): <u>4457-4462</u>
Formation: <u>Johnson</u>	(Perfs): <u>4513-4517/4523-4527</u>

- 2. Estimated amount of fluid production to be commingled from each interval:

Formation: <u>LKC H/LKC I</u>	BOPD: <u>9/9</u>	MCFPD: _____	BWPD: <u>21/21</u>
Formation: <u>Marmaton</u>	BOPD: <u>22</u>	MCFPD: _____	BWPD: <u>0</u>
Formation: <u>Ft Scott</u>	BOPD: <u>22</u>	MCFPD: _____	BWPD: <u>0</u>
Formation: <u>Cherokee</u>	BOPD: <u>22</u>	MCFPD: _____	BWPD: <u>0</u>
Formation: <u>Johnson</u>	BOPD: <u>22</u>	MCFPD: _____	BWPD: <u>0</u>

- 3. Plat map showing the location of the subject well, all other wells on the subject lease, and all wells on offsetting leases within a 1/2 mile radius of the subject well, and for each well the names and addresses of the lessee of record or operator.
- 4. Signed certificate showing service of the application and affidavit of publication as required in K.A.R. 82-3-135a.

For Commingling of PRODUCTION ONLY, include the following:

- 5. Wireline log of subject well. Previously Filed with ACO-1: Yes No
- 6. Complete Form ACO-1 (Well Completion form) for the subject well.

For Commingling of FLUIDS ONLY, include the following:

- 7. Well construction diagram of subject well.
- 8. Any available water chemistry data demonstrating the compatibility of the fluids to be commingled.

AFFIDAVIT: I am the affiant and hereby certify that to the best of my current information, knowledge and personal belief, this request for commingling is true and proper and I have no information or knowledge, which is inconsistent with the information supplied in this application.

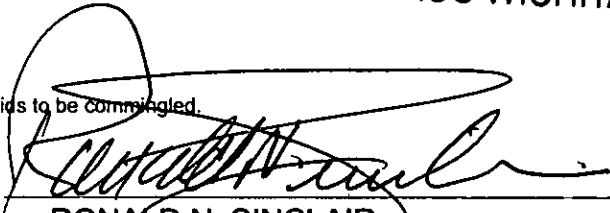
Signature: 
Printed Name: RONALD N. SINCLAIR
Title: PRESIDENT

RECEIVED
MAR 03 2010
KCC WICHITA

KCC Office Use Only

Denied Approved

15-Day Periods Ends: _____

Approved By: _____ Date: _____

Protests may be filed by any party having a valid interest in the application. Protests must be in writing and comply with K.A.R. 82-3-135b and must be filed within 15 days of publication of the notice of application.

AFFIDAVIT OF NOTICE SERVED

RE: APPLICATION FOR COMMINGLING OF PRODUCTION

Well Name: HESS #2-32,

Legal Location: SW-NW-NE-NW, 32-13-31W, GOVE COUNTY, KANSAS

The undersigned hereby certifies that he / she is a duly authorized agent for the applicant, and that on the 1st day of March, 2010, a true and correct copy of the application referenced above was delivered or mailed to the following parties:

Lario Oil & Gas Company, 301 S Market St., Wichita, KS 67202

Ritchie Exploration, Inc., 8100 E. 22nd North, Building 700, Wichita, KS 67226-2338

Wells, Rodger D. dba Pioneer Resources, 80 Windmill Dr, Phillipsburg, KS 67661

I further attest that notice of the filing of this application was published in the **Gove County Advocate**, the official county publication of **Gove County, Kansas**. A copy of the affidavit of this publication is attached.

Signed this 1st day of March, 2010.

Applicant of Duly Authorized Agent:

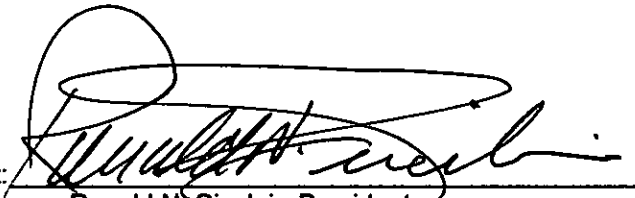

Ronald N. Sinclair, President

Subscribed and sworn to before me this 1st day of March, 2010. _

Notary Public: Mary F. Combs

My Commission Expires: 9/16/2013

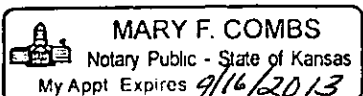
1336



RECEIVED
MAR 03 2010
KCC WICHITA

BEFORE THE STATE CORPORATION COMMISSION
OF THE STATE OF KANSAS
NOTICE OF FILING APPLICATION

RE: Grand Mesa Operating Company— Application for a commingling of production for the Hess #2-32, located in Gove County, Kansas.

TO: All Oil & Gas Producers, Unleased Mineral Interest Owners, Landowners, and all persons whomever concerned.

You, and each of you, are hereby notified that Grand Mesa Operating Company has filed an application for commingling production or fluids from the Lansing Kansas City, Upper Marmaton, Ft Scott, Cherokee and Johnson Zone Formations. The subject well, the Hess #2-32, is located 340 feet from the north line and 1510 feet from the west line in the SW NW NE NW of Section 32, Township 13 South, Range 31 West, Gove County, Kansas. .

Any persons who object to or protest this application shall be required to file their objections or protest with the Conservation Division of the State Corporation Commission of the State of Kansas within thirty (30) days from the date of this publication. These protests shall be filed pursuant to Commission regulations and must state specific reasons why granting the application may cause waste, violate correlative rights or pollute the natural resources of the State of Kansas.

All persons interested or concerned shall take notice of the foregoing and shall govern themselves accordingly.

Grand Mesa Operating Company
1700 N. Waterfront Parkway
Building 600
Wichita, KS 67206

RECEIVED
MAR 03 2010

KCC WICHITA

Hess 2-32
Sec. 32-13S-31W
Gove County, Kansas
Grand Mesa Operating Company
Spud 10/26/09
TD 11/06/09

LOG TOPS – HOLD CONFIDENTIAL 2 YEARS

Name	Top	Datum
Stone Corral	2398	+ 527
Bs/Stone Corral	2420	+ 505
Heebner	3808	- 983
Lansing	3950	-1025
Muncie Creek	4100	-1175
Stark Shale	4186	-1261
Hushpuckney Shale	4224	-1299
Bs/KC	4253	-1328
Marmaton	4281	-1356
Little Osage Shale	4409	-1484
Excello Shale	4434	-1509
Johnson Zone	4511	-1586
Morrow Shale	4533	-1608
Mississippian	4552	-1627
LTD	4618	

RECEIVED
MAR 3 2010
KCC WICHITA

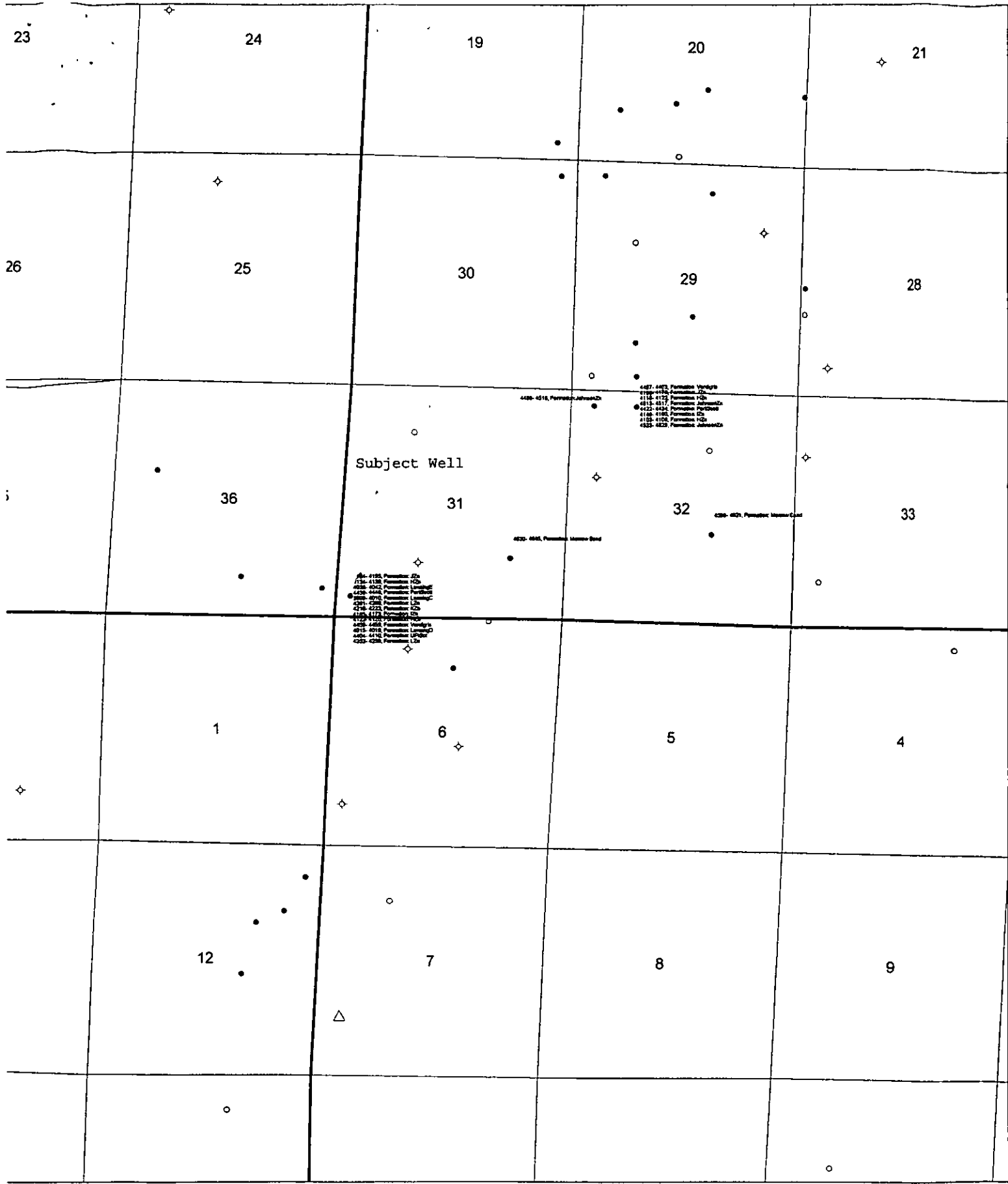

Grand Mesa Operating		
Krebs Project Hess Prospect		
Store Striking	Perforations	Date: 9 February, 2010
Well: 146 - 2232 feet		

RECEIVED
 MAR 2 2010
 KCC WICHITA

Linda D. Joon
 Notary Public Sedgwick County, Kansas

Printer's Fee : \$86.00

RECEIVED
 MAR 26 2010
 KCC WICHITA

AFFIDAVIT

STATE OF KANSAS \
- SS.
County of Sedgwick /

Mark Fletchall, of lawful age, being first duly sworn, deposeeth and saith: That he is Record Clerk of The Wichita Eagle, a daily newspaper published in the City of Wichita, County of Sedgwick, State of Kansas, and having a general paid circulation on a daily basis in said County, which said newspaper has been continuously and uninterruptedly published in said County for more than one year prior to the first publication of the notice hereinafter mentioned, and which said newspaper has been entered as second class mail matter at the United States Post Office in Wichita, Kansas, and which said newspaper is not a trade, religious or fraternal publication and that a notice of a true copy is hereto attached was published in the regular and entire Morning issue of said The Wichita Eagle for 1 issues - ~~weeks~~, that the first publication of said notice was

made as aforesaid on the 24th of

March A.D. 2010, with subsequent publications being made on the following dates:

And affiant further says that he has personal knowledge of the statements above set forth and that they are true.

Mark Fletchall

Subscribed and sworn to before me this

24th day of March, 2010

LINDA D. TOON
Notary Public - State of Kansas
My Appt. Expires 3-13-2013

Linda D. Toon

Notary Public Sedgwick County, Kansas

Printer's Fee : \$86.00

LEGAL PUBLICATION

Published In The Wichita Eagle
March 24, 2010 (3026337)
BEFORE THE STATE CORPORATION
COMMISSION OF THE
STATE OF KANSAS

NOTICE OF FILING APPLICATION
RE: Grand Mesa Operating Company-
Application for a commingling of production
for the Hess #2-32, located in Gove County,
Kansas.
TO: All Oil & Gas Producers, Unleased
Mineral Interest Owners, Landowners, and
all persons whomsoever concerned.
You, and each of you, are hereby notified
that Grand Mesa Operating Company has
filed an application for commingling
production or fluids from the Lansing
Kansas City, Upper Marmaton, Ft Scott,
Cherokee and Johnson Zone Formations.
The subject well, the Hess #2-32, is located
340 feet from the north line and 1510 feet
from the west line in the SW NW NE NW of
Section 32, Township 13 South, Range 31
West, Gove County, Kansas.
Any persons who object to or protest this
application shall be required to file their
objections or protest with the Conservation
Division of the State Corporation
Commission of the State of Kansas within
thirty (30) days from the date of this
publication. These protests shall be filed
pursuant to Commission regulations and
must state specific reasons why granting the
application may cause waste, violate
correlative rights or pollute the natural
resources of the State of Kansas.
All persons interested or concerned shall
take notice of the foregoing and shall govern
themselves accordingly.
Grand Mesa Operating Company
1700 N. Waterfront Parkway
Building 600
Wichita, KS 67206

RECEIVED
MAR 26 2010
KCC WICHITA

AFFIDAVIT OF PUBLICATION

State of Kansas,
Gove County, ss:

Roxanne Broeckelman,
being first duly sworn, deposes and
says: That she is
co-publisher of

Gove County Advocate, a weekly
newspaper printed in the State of
Kansas, and published in and of
general circulation in Gove County,
Kansas, with a general paid
circulation on a weekly basis in
Gove County, Kansas, and that said
newspaper is not a trade, religious
or fraternal publication.

Said newspaper is a weekly
published at least 50 times a year;
and has been so published
continuously and uninterruptedly in
said county and state for a period of
more than five years prior to the first
publication of said notice; and has
been admitted at the post office in
Quinter in said county as periodical
class mail matter.

That the attached notice is a true
copy thereof and was published in
the regular and entire issue of said
newspaper for one
consecutive week(s), the first
publication thereof being made as
aforesaid on the 10th day
of March, 2010,
with subsequent publications being
made on the following dates:

- _____
- _____
- _____
- _____
- _____
- _____
- _____

Printer's Fee\$ 23.65
Additional Copies\$ _____
Affidavit Fees\$ 2.00
Total Publication Fees \$ 25.65

Roxanne Broeckelman

Subscribed and sworn to before me
this 10th day of
March, 2010

Linda L Zerr
Notary Public

My commission expires:
January 8, 2013

LEGAL ADVERTISING
(Published in the Gove County Advocate,
Quinter, KS, Wed., March 10, 2010 - 11)
**BEFORE THE STATE CORPORATION
COMMISSION OF THE STATE OF KANSAS
NOTICE OF FILING APPLICATION**

RE: Grand Mesa Operating Company-
Application for a commingling of production for
the Hess #2-32, located in Gove County,
Kansas.

TO: All Oil & Gas Producers, Unleased Mineral
Interest Owners, Landowners, and all persons
whomever concerned.

You, and each of you, are hereby notified
that Grand Mesa Operating Company has filed
an application for commingling production or
fluids from the Lansing Kansas City, Upper
Marmaton, Ft Scott, Cherokee and Johnson
Zone Formations. The subject well, the Hess
#2-32, is located 340 feet from the north line
and 1510 feet from the west line in the SW NW
NE NW of Section 32, Township 13 South,
Range 31 West, Gove County, Kansas.

Any persons who object to or protest this
application shall be required to file their objec-
tions or protest with the Conservation Division
of the State Corporation Commission of the
State of Kansas within thirty (30) days from the
date of this publication. These protests shall be
filed pursuant to Commission regulations and
must state specific reasons why granting the
application may cause waste, violate correlative
rights or pollute the natural resources of the
State of Kansas.

All persons interested or concerned shall
take notice of the foregoing and shall govern
themselves accordingly.

Grand Mesa Operating Company
1700 N. Waterfront Parkway
Building 600
Wichita, KS 67206

*3-18-10
Called May, need
to publi in Eagle.
Will do and
send in*

LINDA L. ZERR
NOTARY PUBLIC
STATE OF KANSAS
My Appt. Exp. 1-8-2013

RECEIVED
KANSAS CORPORATION COMMISSION
MAR 17 2010
CONFIDENTIAL