



KANSAS CORPORATION COMMISSION 1064463
OIL & GAS CONSERVATION DIVISION

Form ACO-1
June 2009
Form Must Be Typed
Form must be Signed
All blanks must be Filled

WELL COMPLETION FORM
WELL HISTORY - DESCRIPTION OF WELL & LEASE

OPERATOR: License # 34192
Name: SandRidge Exploration and Production LLC
Address 1: 123 ROBERT S. KERR AVE
Address 2: _____
City: OKLAHOMA CITY State: OK Zip: 73102 + 6406
Contact Person: John-Mark Beaver
Phone: (405) 429-5776
CONTRACTOR: License # 34464
Name: Lariat Services, Inc.
Wellsite Geologist: Tammy Alcorn
Purchaser: NCRA

Designate Type of Completion:

- New Well Re-Entry Workover
- Oil WSW SWD SIOW
 Gas D&A ENHR SIGW
 OG GSW Temp. Abd.
 CM (Coal Bed Methane)
 Cathodic Other (Core, Expl., etc.): _____

If Workover/Re-entry: Old Well Info as follows:

Operator: _____

Well Name: _____

Original Comp. Date: _____ Original Total Depth: _____

- Deepening Re-perf. Conv. to ENHR Conv. to SWD
 Conv. to GSW
- Plug Back: _____ Plug Back Total Depth _____
 Commingled Permit #: _____
 Dual Completion Permit #: _____
 SWD Permit #: _____
 ENHR Permit #: _____
 GSW Permit #: _____

<u>09/12/2011</u>	<u>10/01/2011</u>	<u>10/24/2011</u>
Spud Date or Recompletion Date	Date Reached TD	Completion Date or Recompletion Date

API No. 15 - 15-077-21746-01-00

Spot Description: _____

SW SE SW SW Sec. 20 Twp. 34 S. R. 6 East West
200 Feet from North / South Line of Section
760 Feet from East / West Line of Section

Footages Calculated from Nearest Outside Section Corner:

- NE NW SE SW

County: Harper

Lease Name: Britt Well #: 1-20H

Field Name: _____

Producing Formation: Mississippi Lime

Elevation: Ground: 1313 Kelly Bushing: 1324

Total Depth: 9060 Plug Back Total Depth: _____

Amount of Surface Pipe Set and Cemented at: 747 Feet

Multiple Stage Cementing Collar Used? Yes No

If yes, show depth set: _____ Feet

If Alternate II completion, cement circulated from: _____

feet depth to: _____ w/ _____ sx cmt.

Drilling Fluid Management Plan

(Data must be collected from the Reserve Pit)

Chloride content: 7300 ppm Fluid volume: 5810 bbls

Dewatering method used: Hauled to Disposal

Location of fluid disposal if hauled offsite: _____

Operator Name: Gray's Mud Disposal

Lease Name: Grays Mud Disposal License #: 32300

Quarter NW Sec. 15 Twp. 24 S. R. 7 East West

County: Garfield, OK Permit #: 355765

AFFIDAVIT

I am the affiant and I hereby certify that all requirements of the statutes, rules and regulations promulgated to regulate the oil and gas industry have been fully complied with and the statements herein are complete and correct to the best of my knowledge.

Submitted Electronically

KCC Office Use ONLY

- Letter of Confidentiality Received
Date: 02/01/2012
- Confidential Release Date: _____
- Wireline Log Received
- Geologist Report Received
- UIC Distribution
- ALT I II III Approved by: Dorinda Gertzel Date: 02/02/2012



1064463

Operator Name: SandRidge Exploration and Production LLC Lease Name: Britt Well #: 1-20H
 Sec. 20 Twp. 34 S. R. 6 East West County: Harper

INSTRUCTIONS: Show important tops and base of formations penetrated. Detail all cores. Report all final copies of drill stems tests giving interval tested, time tool open and closed, flowing and shut-in pressures, whether shut-in pressure reached static level, hydrostatic pressures, bottom hole temperature, fluid recovery, and flow rates if gas to surface test, along with final chart(s). Attach extra sheet if more space is needed. Attach complete copy of all Electric Wire-line Logs surveyed. Attach final geological well site report.

Drill Stem Tests Taken <input type="checkbox"/> Yes <input checked="" type="checkbox"/> No <i>(Attach Additional Sheets)</i> Samples Sent to Geological Survey <input type="checkbox"/> Yes <input checked="" type="checkbox"/> No Cores Taken <input type="checkbox"/> Yes <input checked="" type="checkbox"/> No Electric Log Run <input checked="" type="checkbox"/> Yes <input type="checkbox"/> No Electric Log Submitted Electronically <input checked="" type="checkbox"/> Yes <input type="checkbox"/> No <i>(If no, Submit Copy)</i> List All E. Logs Run: Induction Compensated Neutron/Density	<input checked="" type="checkbox"/> Log Formation (Top), Depth and Datum <input type="checkbox"/> Sample <table style="width:100%; border-collapse: collapse;"> <tr> <td style="width:60%;">Name</td> <td style="width:20%;">Top</td> <td style="width:20%;">Datum</td> </tr> <tr> <td>Oswego Limestone</td> <td>4260</td> <td>-2905</td> </tr> <tr> <td>Cherokee Group</td> <td>4563</td> <td>-3132</td> </tr> <tr> <td>Verdigris Limestone</td> <td>4614</td> <td>-3165</td> </tr> <tr> <td>Mississippi Lime</td> <td>4940</td> <td>-3348</td> </tr> </table>	Name	Top	Datum	Oswego Limestone	4260	-2905	Cherokee Group	4563	-3132	Verdigris Limestone	4614	-3165	Mississippi Lime	4940	-3348
Name	Top	Datum														
Oswego Limestone	4260	-2905														
Cherokee Group	4563	-3132														
Verdigris Limestone	4614	-3165														
Mississippi Lime	4940	-3348														

CASING RECORD <input checked="" type="checkbox"/> New <input type="checkbox"/> Used							
Report all strings set-conductor, surface, intermediate, production, etc.							
Purpose of String	Size Hole Drilled	Size Casing Set (In O.D.)	Weight Lbs. / Ft.	Setting Depth	Type of Cement	# Sacks Used	Type and Percent Additives
Surface	12.25	9.63	36	747	J-55	50	
Intermediate	8.75	7	29	5190	N-80	250	4% Hazard (R)-0.50% 22m Kcl-Zeol. B
Prod Liner	6.03	4.5	11.6	9055	P-110	450	4% Hazard (R)-0.50% 22m Kcl-Zeol. B

ADDITIONAL CEMENTING / SQUEEZE RECORD				
Purpose:	Depth Top Bottom	Type of Cement	# Sacks Used	Type and Percent Additives
___ Perforate				
___ Protect Casing	-			
___ Plug Back TD				
___ Plug Off Zone	-			

Shots Per Foot	PERFORATION RECORD - Bridge Plugs Set/Type Specify Footage of Each Interval Perforated	Acid, Fracture, Shot, Cement Squeeze Record (Amount and Kind of Material Used)	Depth
Attached	Attached	Attached	Attached

TUBING RECORD:	Size: na	Set At:	Packer At:	Liner Run: <input type="checkbox"/> Yes <input type="checkbox"/> No
----------------	----------	---------	------------	---

Date of First, Resumed Production, SWD or ENHR. 11/09/2011	Producing Method: <input type="checkbox"/> Flowing <input checked="" type="checkbox"/> Pumping <input type="checkbox"/> Gas Lift <input type="checkbox"/> Other (Explain) _____				
Estimated Production Per 24 Hours	Oil Bbls.	Gas Mcf	Water Bbls.	Gas-Oil Ratio	Gravity

DISPOSITION OF GAS: <input type="checkbox"/> Vented <input checked="" type="checkbox"/> Sold <input type="checkbox"/> Used on Lease <i>(If vented, Submit ACO-18.)</i>	METHOD OF COMPLETION: <input type="checkbox"/> Open Hole <input checked="" type="checkbox"/> Perf. <input type="checkbox"/> Dually Comp. <input type="checkbox"/> Commingled <i>(Submit ACO-5) (Submit ACO-4)</i> <input type="checkbox"/> Other (Specify) _____	PRODUCTION INTERVAL: 4973-8722
--	---	-----------------------------------

Form	ACO1 - Well Completion
Operator	SandRidge Exploration and Production LLC
Well Name	Britt 1-20H
Doc ID	1064463

Perforations

1	8997.5-9000; 8859.5-8862; 8721.5-8724	4330 bbls Slickwater, 36bbls 15% NeFe HCl, 119 bbls gelled acid, 76Mlbs 40/70 sd, 4734 TLTR	
2	8581-8583.5; 8443-8445.5; 8305-8307.5	4158bbls Slickwater, 36bbls 15% NeFe HCl, 119 bbls gelled acid, 73M lbs 40/70 sd, 9249 TLTR	
3	8164.5-8167; 8036.5-8029; 7888.5-7891	4039bbls Slickwater, 35bbls 15% NeFe HCl, 119 bbls gelled acid, 75M lbs 40/70 sd, 14148 TLTR	
4	7748-7750.5; 7610-7612.5; 7472-7474.5	4053bbls Slickwater, 37bbls 15% NeFe HCl, 117 bbls gelled acid, 75M lbs 40/70 sd, 18488 TLTR	
5	7331.5-7334; 7193.5-7196; 7055.5-7058	4001bbls Slicwater, 36bbls 15% NeFe HCl, 119 bbls gelled acid, 71M lbs 40/70 sd, 22758 TLTR	
6	6915-6917.5; 6777-6779.5; 6639-3341.5	4107bbls Slickwater, 34bbls 15% NeFe HCl, 121 bbls gelled acid, 75M lbs 40/70 sd, 27115 TLTR	

JOB SUMMARY			PROJECT NUMBER SOK0869	TICKET DATE 10/03/11
COUNTY Barber	State Kansas	COMPANY Landridge Exp and Productio	CUSTOMER REP Felix Ortiz	
LEASE NAME William	Well No. 1-11H	JOB TYPE Surface	EMPLOYEE NAME Eric Parsons	

EMP NAME Eric Parsons	John Jones				
Emmitt Brock					
Michael Bajo					
Michael Horne					

Form. Name _____ Type: _____

Packer Type _____ Set At **0**

Bottom Hole Temp. **80** Pressure _____

Retainer Depth _____ Total Depth **926**

Date	Called Out 10/3/2011	On Location 10/3/2011	Job Started 10/3/2011	Job Completed 10/4/2011
Time		9:30pm	11:00pm	

Type and Size	Qty	Make
Auto Fill Tube	0	Weatherford
Insert Float Val	0	
Centralizers	0	
Top Plug	0	
HEAD	0	
Limit clamp	0	
Weld-A	0	
Texas Pattern Guide Shoe	0	
Cement Basket	0	

	New/Used	Weight	Size	Grade	From	To	Max. Allow
Casing		36#	9 5/8"		Surface	926	1,500
Liner							
Liner							
Tubing			0				
Drill Pipe							
Open Hole			12 1/4"		Surface	923	Shots/Ft.
Perforations							
Perforations							
Perforations							

Materials			
Mud Type	WBM	Density	g Lb/Gal
Disp. Fluid	Fresh Water	Density	8.33 Lb/Gal
Spacer type	Fresh Water BBL.	10	8.33
Spacer type	BBL.		
Acid Type	Gal.	%	
Acid Type	Gal.	%	
Surfactant	Gal.	ln	
NE Agent	Gal.	ln	
Fluid Loss	Gal/Lb	ln	
Gelling Agent	Gal/Lb	ln	
Fric. Red.	Gal/Lb	ln	
MISC.	Gal/Lb	ln	

Perfbac Balls _____ Qty. _____

Other _____

Other _____

Other _____

Other _____

Hours On Location		Operating Hours		Description of Job
Date	Hours	Date	Hours	
10/3	4.0	9/5	1.5	Surface
Total	4.0	Total	1.5	

Pressures			
MAX	1,500 PSI	AVG	150
Average Rates in BPM			
MAX	6 BMP	AVG	4
Cement Left In Pipe			
Feel	45	Reason	SHOE JOINT

Cement Data						
Stage	Sacks	Cement	Additives	W/Rq.	Yield	Lbs/Gal
1	280	Otex Lite Standard	6% Gel - 2% Calcium Chloride - 1/4lb/sk Cello-Flake - .5% C-41P	10.88	1.84	12.70
2	160	Standard	2% Calcium Chloride - 1/4lb/sk Cello-Flake - .5% C-41P	6.20	1.18	15.60
3	100	Standard	2% Calcium Chloride on slide if necessary	6.20	1.18	15.60

Summary					
Preflush	_____	Type:	_____	Preflush:	BBB
Breakdown	_____	MAXIMUM	1,500 PSI	Load & Bkdn:	Gal - BBB
	_____	Lost Returns-N	NO/FULL	Excess /Return	BBB
	_____	Actual TOC	SURFACE	Calc. TOC:	_____
Average	_____	Bump Plug PSI:	850	Final Circ.	PSI:
ISIP	5 Min.	10 Min.	15 Min.	Cement Slurry:	BBB
				Total Volume	BBB
					10.00
					N/A
					20
					68
					68.00
					365
					125.4
					203.39

CUSTOMER REPRESENTATIVE _____ SIGNATURE _____

JOB SUMMARY			PROJECT NUMBER SOK0881	TICKET DATE 10/08/11
COUNTY Barber	State Kansas	COMPANY Sandridge Exp and Prod	CUSTOMER REP Felix Ortiz	
LEASE NAME William	Well No. 1-11H	JOB TYPE Intermediate	EMPLOYEE NAME Chris Bigbey	

EMP NAME Chris Bigbey					
RJ Stonehocker					
Flo Helkena					

Form. Name _____ Type: _____

Packer Type _____ Set At **0**

Bottom Hole Temp. **0** Pressure _____

Retainer Depth _____ Total Depth **5252**

Date	Called Out	On Location	Job Started	Job Completed
	10/8/2011	10/9/2011	10/9/2011	10/9/2011
Time	2330	0500	0650	0835

Type and Size	Qty	Make
Auto Fill Tube	0	IR
Insert Float Val	0	IR
Centralizers	0	IR
Top Plug	0	IR
HEAD	0	IR
Limit clamp	0	IR
Weld-A	0	IR
Texas Pattern Guide Shoe	0	IR
Cement Basket	0	IR

	New/Used	Weight	Size	Grade	From	To	Max. Allow
Casing		29.0	7		Surface	5,252	
Liner							
Liner							
Tubing							
Drill Pipe							
Open Hole			8 3/4		Surface	5,228	Shots/Ft.
Perforations							
Perforations							
Perforations							

Materials

Mud Type _____ Density _____ Lb/Gal

Disp. Fluid _____ Density _____ Lb/Gal

Spacer type _____ BBL _____

Spacer type _____ BBL _____

Acid Type _____ Gal. _____ %

Acid Type _____ Gal. _____ %

Surfactant _____ Gal. _____ In

NE Agent _____ Gal. _____ In

Fluid Loss _____ Gal/Lb _____ In

Gelling Agent _____ Gal/Lb _____ In

Fric. Red. _____ Gal/Lb _____ In

MISC. _____ Gal/Lb _____ In

Perfoac Balls _____ Qty. _____

Other _____

Other _____

Other _____

Other _____

Hours On Location		Operating Hours		Description of Job
Date	Hours	Date	Hours	
10/9	6.0	10/9	1.8	Intermediate
Total	6.0	Total	1.8	

Pressures	
MAX 3500	AVG. 600
Average Rates in BPM	
MAX 10	AVG 6
Cement Left in Pipe	
Feet 87	Reason Shoe Jt.

Stage	Sacks	Cement	Additives	WRq.	Yield	Lbs/Gal
1	260	60/60 POZ PREMIUM	4% Gel - 0.4% C-12 - 0.1% C-37 - 0.6% C-41P - 2 lb/sk Phenoacal	6.77	1.44	13.60
2	0	0		0	0.00	0.00
3	0	0		0	0.00	0.00

Summary

Preflush Breakdown	10	Type: caustic	Preflush: BBI	20.00	Type: FRESH WATER
		MAXIMUM	Load & Bkdn: Gal - BBI		Pad:Bbl - Gal
		Lost Returns-N	Excess /Return BBI		Calc. Disp Bbl
		Actual TOC	Calc. TOC:	3,735	Actual Disp. 184.00
Average		Frac. Gradient	Treatment: Gal - BBI		Disp:Bbl 181.80
ISIP	5 Min.	10 Min	Cement Slurry: BBI	64.1	
		15 Min	Total Volume	268.10	

CUSTOMER REPRESENTATIVE *Felix Ortiz* SIGNATURE

JOB SUMMARY			PROJECT NUMBER SOK0909	TICKET DATE 10/18/11
COUNTY Barber	STATE Kansas	COMPANY Landridge Exp and Productio	CUSTOMER REP Claude	
LEASE NAME William	Well No 1-11H	JOB TYPE Intermediate	EMPLOYEE NAME Chris Bigbey	

EMP NAME					
Chris Bigbey					
Emmit Brock					
RJ Stonehocker					
John Hall					

Form. Name _____ Type: _____
Packer Type _____ Set At 0
Bottom Hole Temp. 0 Pressure _____
Retainer Depth _____ Total Depth 9183

Date	Called Out 10/18/2011	On Location 10/18/2011	Job Started 10/18/2011	Job Completed 10/18/2011
Time	1000	1330	1440	1630

Type and Size	Qty	Make
Auto Fill Tube	0	Weatherford
Insert Float Val	0	
Centralizers	0	
Top Plug	0	
HEAD	0	
Limit clamp	0	
Weld-A	0	
Texas Pattern Guide Shoe	0	
Cement Basket	0	

New/Used		Weight	Size	Grade	From	To	Max. Allow
Casing		11.6	4 1/2		4821	9,183	
Liner							
Liner							
Tubing		44.0	4 3/4		3,895	4,821	
Drill Pipe		15.5	3 1/2		Surface	3,895	
Open Hole			6 1/8		5,227	9,183	Shots/Ft.
Perforations							
Perforations							
Perforations							

Materials

Mud Type _____ Density _____ Lb/Gal
Disp. Fluid _____ Density _____ Lb/Gal
Spacer type _____ BBL. _____
Spacer type _____ BBL. _____
Acid Type _____ Gal. _____ %
Acid Type _____ Gal. _____ %
Surfactant _____ Gal. _____ In
NE Agent _____ Gal. _____ In
Fluid Loss _____ Gal/Lb _____ In
Gelling Agent _____ Gal/Lb _____ In
Fric. Red. _____ Gal/Lb _____ In
MISC. _____ Gal/Lb _____ In

Perpac Balls _____ Qty. _____
Other _____
Other _____
Other _____
Other _____

Hours On Location		Operating Hours		Description of Job
Date	Hours	Date	Hours	
10/18	4.0	10/18	1.8	Intermediate
Total	4.0	Total	1.8	

MAX	3500	AVG.	800
Average Rates in BPM			
MAX	8	AVG	5
Cement Left in Pipe			
Feel	80	Reason	Shoe Jt.

Stage	Sacks	Cement	Additives	W/Rq.	Yield	Lbs/Gal
1	465	60/60 Premium Poz	(4%Gcl) - .4% C12 - .1% C37 - 0.5% C-41P -	2 Lb/Sk Pheno	6.77	1.44 13.60
2	0	0		0	0.00	0.00 0.00
3	0	0		0	0.00	0.00 0.00

Summary

Preflush 10 Type: caustic
Breakdown _____ MAXIMUM 3,500
Lost Returns-n _____ no
Actual TOC _____ 4,337
Average _____ Frac. Gradient
to IP _____ 5 Min. _____ 10 Min. _____ 15 Min. _____

Preflush: BBI 20.00 Type: Fresh Water
Load & Bkdn: Gal - BBI _____ Pad:Bbl -Gal _____
Excess /Return BBI _____ Calc. Disp Bbl _____ 96
Calc. TOC: _____ 4,363 Actual Disp. _____ 92.00
Treatment: Gal - BBI _____ Disp:Bbl _____ 95.60
Cement Slurr: BBI _____
Total Volume BBI _____ 231.30

CUSTOMER REPRESENTATIVE Claude Huller SIGNATURE

	Measured Depth (ft)	Sub-Sea Incl. (ft)	Vertical Azim. (ft)	True Vert Depth (ft)	Northings (+) Southings (-) (ft)	Eastings (+) Westings (-) (ft)	Vertical Section (ft)	FNL	FSL	FWL	FEL
	SHL	0	0	0	0	0	0	0	5080.00	200.00	760.00
BHL	9011	91.00	358.50	4714.20	4669.00	-77.59	4669.62	411.00	4869.00	682.41	4597.59
Miss Entry	4940	69.70	358.00	4676.69	600.17	-10.08	600.25	4479.83	800.17	749.92	4530.08
Top Perf	4973	73.00	358.00	4686.60	629.52	-11.11	629.62	4450.48	829.52	748.89	4531.11
Bottom Perf	9000	91.10	358.50	4714.44	4656.01	-77.25	4656.62	423.99	4856.01	682.75	4597.25

	Measured Depth (ft)	Sub-Sea Incl. (ft)	Vertical Azim. (ft)	True Vert Depth (ft)	Northings (+) Southings (-) (ft)	Eastings (+) Westings (-) (ft)	Vertical Section (ft)	FNL	FSL	FWL	FEL
		0	0	0	0	0	0	0	5080.00	200.00	760.00
	255	0.20	194.50	255.00	-0.43	-0.11	-0.43	5080.43	199.57	759.89	4520.11
	504	0.50	194.50	503.99	-1.90	-0.49	-1.90	5081.90	198.10	759.51	4520.49
	746	0.40	194.50	745.99	-3.74	-0.97	-3.73	5083.74	196.26	759.03	4520.97
	799	0.40	194.50	798.99	-4.10	-1.06	-4.09	5084.10	195.90	758.94	4521.06
	1012	0.50	228.40	1011.98	-5.44	-1.94	-5.41	5085.44	194.56	758.06	4521.94
	1517	0.70	190.40	1516.95	-9.94	-4.15	-9.88	5089.94	190.06	755.85	4524.15
	2023	0.70	189.20	2022.92	-16.03	-5.20	-15.96	5096.03	183.97	754.80	4525.20
	2497	0.60	114.80	2496.89	-19.93	-3.41	-19.88	5099.93	180.07	756.59	4523.41
	2942	0.80	131.40	2941.86	-22.96	1.04	-22.97	5102.96	177.04	761.04	4518.96
	3417	1.80	112.20	3416.73	-27.97	10.43	-28.10	5107.97	172.03	770.43	4509.57
	3670	0.40	283.00	3669.70	-29.27	13.25	-29.44	5109.27	170.73	773.25	4506.75
	3702	0.60	284.00	3701.70	-29.21	12.98	-29.37	5109.21	170.79	772.98	4507.02
	3734	1.40	357.40	3733.69	-28.78	12.80	-28.94	5108.78	171.22	772.80	4507.20
	3766	3.10	11.90	3765.67	-27.54	12.96	-27.71	5107.54	172.46	772.96	4507.04
	3797	5.00	17.60	3796.59	-25.43	13.54	-25.61	5105.43	174.57	773.54	4506.46
	3829	6.70	18.90	3828.42	-22.33	14.57	-22.52	5102.33	177.67	774.57	4505.43
	3861	7.70	20.10	3860.17	-18.56	15.91	-18.76	5098.56	181.44	775.91	4504.09
	3892	9.10	22.40	3890.84	-14.34	17.56	-14.57	5094.34	185.66	777.56	4502.44
	3923	10.70	26.40	3921.37	-9.49	19.77	-9.75	5089.49	190.51	779.77	4500.23
	3955	12.50	28.20	3952.72	-3.78	22.73	-4.08	5083.78	196.22	782.73	4497.27
	3986	14.10	28.40	3982.89	2.50	26.11	2.15	5077.50	202.50	786.11	4493.89
	4018	15.80	29.10	4013.80	9.73	30.08	9.34	5070.27	209.73	790.08	4489.92
	4049	18.00	29.30	4043.46	17.60	34.48	17.14	5062.40	217.60	794.48	4485.52
	4081	19.80	21.90	4073.74	26.94	38.92	26.43	5053.06	226.94	798.92	4481.08
	4113	22.20	11.20	4103.62	37.91	42.12	37.35	5042.09	237.91	802.12	4477.88
	4144	24.30	4.30	4132.11	50.02	43.74	49.44	5029.98	250.02	803.74	4476.26

4176	26.30	358.90	4161.04	63.67	44.09	63.09	5016.33	263.67	804.09	4475.91
4208	28.10	355.40	4189.50	78.27	43.35	77.70	5001.73	278.27	803.35	4476.65
4239	30.00	352.50	4216.60	93.24	41.75	92.68	4986.76	293.24	801.75	4478.25
4271	32.40	351.20	4243.97	109.64	39.40	109.12	4970.36	309.64	799.40	4480.60
4303	34.70	350.30	4270.64	127.10	36.55	126.61	4952.90	327.10	796.55	4483.45
4334	36.60	349.30	4295.83	144.88	33.35	144.43	4935.12	344.88	793.35	4486.65
4366	38.00	349.30	4321.29	163.93	29.75	163.53	4916.07	363.93	789.75	4490.25
4398	39.70	350.60	4346.21	183.70	26.25	183.33	4896.30	383.70	786.25	4493.75
4430	41.80	351.90	4370.45	204.34	23.08	204.02	4875.66	404.34	783.08	4496.92
4461	44.00	352.90	4393.15	225.25	20.29	224.97	4854.75	425.25	780.29	4499.71
4493	46.00	354.20	4415.78	247.74	17.75	247.48	4832.26	447.74	777.75	4502.25
4525	48.40	354.40	4437.52	271.10	15.42	270.87	4808.90	471.10	775.42	4504.58
4556	50.20	354.40	4457.74	294.49	13.13	294.29	4785.51	494.49	773.13	4506.87
4587	50.20	354.40	4477.58	318.19	10.81	318.02	4761.81	518.19	770.81	4509.19
4619	50.10	354.50	4498.08	342.64	8.43	342.50	4737.36	542.64	768.43	4511.57
4650	49.80	354.40	4518.03	366.26	6.13	366.15	4713.74	566.26	766.13	4513.87
4681	49.50	354.60	4538.10	389.78	3.87	389.69	4690.22	589.78	763.87	4516.13
4713	50.00	355.10	4558.78	414.10	1.68	414.05	4665.90	614.10	761.68	4518.32
4745	49.80	355.10	4579.39	438.49	-0.41	438.46	4641.51	638.49	759.59	4520.41
4776	51.70	355.30	4599.00	462.41	-2.42	462.40	4617.59	662.41	757.58	4522.42
4808	55.50	355.80	4617.99	488.09	-4.42	488.10	4591.91	688.09	755.58	4524.42
4840	58.60	356.50	4635.39	514.87	-6.22	514.91	4565.13	714.87	753.78	4526.22
4871	62.30	357.20	4650.68	541.80	-7.69	541.85	4538.20	741.80	752.31	4527.69
4903	66.00	357.70	4664.63	570.56	-8.97	570.63	4509.44	770.56	751.03	4528.97
4935	69.70	358.00	4676.69	600.17	-10.08	600.25	4479.83	800.17	749.92	4530.08
4966	73.00	358.00	4686.60	629.52	-11.11	629.62	4450.48	829.52	748.89	4531.11
4998	75.30	358.00	4695.34	660.29	-12.18	660.39	4419.71	860.29	747.82	4532.18
5029	77.20	357.70	4702.71	690.38	-13.31	690.49	4389.62	890.38	746.69	4533.31
5061	79.20	357.40	4709.25	721.67	-14.65	721.80	4358.33	921.67	745.35	4534.65
5093	81.80	357.30	4714.54	753.19	-16.11	753.34	4326.81	953.19	743.89	4536.11
5124	84.40	357.10	4718.26	783.93	-17.62	784.09	4296.07	983.93	742.38	4537.62
5156	86.10	357.60	4720.91	815.78	-19.09	815.97	4264.22	1015.78	740.91	4539.09
5205	88.30	358.50	4723.30	864.69	-20.75	864.89	4215.31	1064.69	739.25	4540.75
5236	88.10	358.40	4724.28	895.67	-21.59	895.87	4184.33	1095.67	738.41	4541.59
5268	88.60	359.00	4725.20	927.65	-22.32	927.86	4152.35	1127.65	737.68	4542.32
5300	88.80	359.40	4725.92	959.63	-22.76	959.85	4120.37	1159.63	737.24	4542.76
5331	88.20	358.50	4726.74	990.62	-23.33	990.84	4089.38	1190.62	736.67	4543.33
5363	88.20	359.80	4727.74	1022.60	-23.81	1022.82	4057.40	1222.60	736.19	4543.81
5394	88.40	359.80	4728.66	1053.58	-23.92	1053.81	4026.42	1253.58	736.08	4543.92
5426	88.30	0.10	4729.58	1085.57	-23.94	1085.79	3994.43	1285.57	736.06	4543.94

5458	88.30	360.00	4730.53	1117.56	-23.92	1117.77	3962.44	1317.56	736.08	4543.92
5489	89.30	0.30	4731.18	1148.55	-23.83	1148.76	3931.45	1348.55	736.17	4543.83
5521	89.30	0.40	4731.57	1180.55	-23.64	1180.76	3899.45	1380.55	736.36	4543.64
5553	89.90	0.40	4731.79	1212.54	-23.42	1212.75	3867.46	1412.54	736.58	4543.42
5585	89.50	0.30	4731.96	1244.54	-23.22	1244.74	3835.46	1444.54	736.78	4543.22
5616	89.00	0.10	4732.37	1275.54	-23.11	1275.73	3804.46	1475.54	736.89	4543.11
5648	90.00	0.10	4732.65	1307.54	-23.06	1307.73	3772.46	1507.54	736.94	4543.06
5680	92.10	0.30	4732.06	1339.53	-22.94	1339.72	3740.47	1539.53	737.06	4542.94
5711	93.00	0.60	4730.68	1370.50	-22.70	1370.68	3709.50	1570.50	737.30	4542.70
5743	93.00	0.90	4729.01	1402.45	-22.28	1402.62	3677.55	1602.45	737.72	4542.28
5775	91.10	0.90	4727.86	1434.43	-21.78	1434.59	3645.57	1634.43	738.22	4541.78
5806	90.70	0.70	4727.38	1465.42	-21.35	1465.57	3614.58	1665.42	738.65	4541.35
5838	91.20	0.30	4726.85	1497.41	-21.07	1497.56	3582.59	1697.41	738.93	4541.07
5870	90.80	359.10	4726.29	1529.41	-21.24	1529.56	3550.59	1729.41	738.76	4541.24
5901	88.70	359.20	4726.42	1560.40	-21.70	1560.55	3519.60	1760.40	738.30	4541.70
5933	88.60	359.80	4727.18	1592.39	-21.97	1592.54	3487.61	1792.39	738.03	4541.97
5965	88.50	359.50	4727.99	1624.38	-22.17	1624.53	3455.62	1824.38	737.83	4542.17
5997	90.20	359.80	4728.35	1656.38	-22.37	1656.53	3423.62	1856.38	737.63	4542.37
6029	92.40	359.60	4727.62	1688.37	-22.53	1688.52	3391.63	1888.37	737.47	4542.53
6060	90.40	358.40	4726.87	1719.35	-23.07	1719.51	3360.65	1919.35	736.93	4543.07
6092	88.70	358.50	4727.12	1751.34	-23.94	1751.50	3328.66	1951.34	736.06	4543.94
6124	87.70	358.70	4728.12	1783.31	-24.72	1783.48	3296.69	1983.31	735.28	4544.72
6156	87.70	358.70	4729.41	1815.28	-25.45	1815.46	3264.72	2015.28	734.55	4545.45
6187	87.70	358.90	4730.65	1846.25	-26.10	1846.43	3233.75	2046.25	733.90	4546.10
6219	87.50	358.70	4731.99	1878.21	-26.76	1878.40	3201.79	2078.21	733.24	4546.76
6250	87.40	358.50	4733.37	1909.17	-27.52	1909.37	3170.83	2109.17	732.48	4547.52
6282	87.40	359.40	4734.82	1941.13	-28.11	1941.33	3138.87	2141.13	731.89	4548.11
6314	88.30	359.10	4736.02	1973.11	-28.53	1973.31	3106.89	2173.11	731.47	4548.53
6345	89.40	0.10	4736.64	2004.10	-28.74	2004.30	3075.90	2204.10	731.26	4548.74
6377	90.40	0.10	4736.70	2036.10	-28.69	2036.30	3043.90	2236.10	731.31	4548.69
6409	90.50	0.60	4736.45	2068.10	-28.49	2068.29	3011.90	2268.10	731.51	4548.49
6440	90.80	1.00	4736.10	2099.09	-28.06	2099.28	2980.91	2299.09	731.94	4548.06
6472	90.70	1.10	4735.68	2131.08	-27.47	2131.26	2948.92	2331.08	732.53	4547.47
6503	90.80	0.40	4735.27	2162.08	-27.07	2162.25	2917.92	2362.08	732.93	4547.07
6535	90.80	0.60	4734.82	2194.07	-26.79	2194.24	2885.93	2394.07	733.21	4546.79
6567	90.60	0.80	4734.43	2226.07	-26.40	2226.22	2853.93	2426.07	733.60	4546.40
6599	91.00	0.80	4733.99	2258.06	-25.95	2258.21	2821.94	2458.06	734.05	4545.95
6630	90.70	0.10	4733.53	2289.06	-25.71	2289.20	2790.94	2489.06	734.29	4545.71
6662	90.50	0.30	4733.19	2321.06	-25.59	2321.19	2758.94	2521.06	734.41	4545.59
6694	90.80	360.00	4732.83	2353.05	-25.51	2353.19	2726.95	2553.05	734.49	4545.51

6726	90.20	0.40	4732.55	2385.05	-25.40	2385.18	2694.95	2585.05	734.60	4545.40
6757	90.50	0.30	4732.36	2416.05	-25.21	2416.17	2663.95	2616.05	734.79	4545.21
6789	90.30	359.80	4732.14	2448.05	-25.18	2448.17	2631.95	2648.05	734.82	4545.18
6821	90.50	0.00	4731.91	2480.05	-25.24	2480.17	2599.95	2680.05	734.76	4545.24
6852	90.50	359.70	4731.64	2511.05	-25.32	2511.16	2568.95	2711.05	734.68	4545.32
6884	90.90	359.10	4731.25	2543.04	-25.65	2543.16	2536.96	2743.04	734.35	4545.65
6915	90.90	359.20	4730.77	2574.04	-26.11	2574.16	2505.96	2774.04	733.89	4546.11
6947	90.70	359.70	4730.32	2606.03	-26.42	2606.15	2473.97	2806.03	733.58	4546.42
6979	91.30	0.20	4729.76	2638.03	-26.45	2638.15	2441.97	2838.03	733.55	4546.45
7010	91.30	0.20	4729.06	2669.02	-26.34	2669.13	2410.98	2869.02	733.66	4546.34
7042	90.00	359.20	4728.69	2701.01	-26.51	2701.13	2378.99	2901.01	733.49	4546.51
7074	89.10	359.10	4728.95	2733.01	-26.98	2733.13	2346.99	2933.01	733.02	4546.98
7106	89.10	359.90	4729.45	2765.00	-27.26	2765.12	2315.00	2965.00	732.74	4547.26
7138	89.50	359.30	4729.84	2797.00	-27.48	2797.12	2283.00	2997.00	732.52	4547.48
7169	90.20	359.20	4729.92	2828.00	-27.89	2828.12	2252.00	3028.00	732.11	4547.89
7201	91.10	359.40	4729.56	2859.99	-28.28	2860.12	2220.01	3059.99	731.72	4548.28
7233	91.60	359.50	4728.80	2891.98	-28.59	2892.11	2188.02	3091.98	731.41	4548.59
7265	91.00	358.90	4728.08	2923.97	-29.04	2924.10	2156.03	3123.97	730.96	4549.04
7297	91.10	358.80	4727.49	2955.96	-29.68	2956.09	2124.04	3155.96	730.32	4549.68
7328	90.90	358.30	4726.95	2986.94	-30.46	2987.09	2093.06	3186.94	729.54	4550.46
7360	90.70	358.60	4726.50	3018.93	-31.33	3019.08	2061.07	3218.93	728.67	4551.33
7392	90.90	358.20	4726.06	3050.91	-32.22	3051.07	2029.09	3250.91	727.78	4552.22
7423	90.90	358.40	4725.57	3081.90	-33.14	3082.07	1998.10	3281.90	726.86	4553.14
7454	90.90	358.30	4725.08	3112.88	-34.03	3113.06	1967.12	3312.88	725.97	4554.03
7486	91.00	358.30	4724.55	3144.86	-34.98	3145.05	1935.14	3344.86	725.02	4554.98
7518	91.00	358.40	4723.99	3176.84	-35.90	3177.04	1903.16	3376.84	724.10	4555.90
7550	90.20	359.00	4723.66	3208.83	-36.63	3209.04	1871.17	3408.83	723.37	4556.63
7582	89.60	359.70	4723.71	3240.83	-36.99	3241.04	1839.17	3440.83	723.01	4556.99
7614	89.50	359.90	4723.97	3272.83	-37.10	3273.03	1807.17	3472.83	722.90	4557.10
7645	89.50	359.90	4724.24	3303.83	-37.16	3304.03	1776.17	3503.83	722.84	4557.16
7677	89.50	359.60	4724.51	3335.83	-37.30	3336.03	1744.17	3535.83	722.70	4557.30
7709	89.50	359.40	4724.79	3367.82	-37.58	3368.03	1712.18	3567.82	722.42	4557.58
7740	89.50	359.50	4725.06	3398.82	-37.87	3399.03	1681.18	3598.82	722.13	4557.87
7772	89.60	359.30	4725.32	3430.82	-38.21	3431.02	1649.18	3630.82	721.79	4558.21
7803	89.70	359.20	4725.51	3461.82	-38.62	3462.02	1618.18	3661.82	721.38	4558.62
7835	89.80	358.70	4725.64	3493.81	-39.20	3494.02	1586.19	3693.81	720.80	4559.20
7867	89.00	359.00	4725.98	3525.80	-39.84	3526.02	1554.20	3725.80	720.16	4559.84
7898	89.60	359.20	4726.36	3556.79	-40.33	3557.02	1523.21	3756.79	719.67	4560.33
7930	89.70	358.70	4726.55	3588.79	-40.92	3589.02	1491.21	3788.79	719.08	4560.92
7962	89.60	359.40	4726.75	3620.78	-41.45	3621.02	1459.22	3820.78	718.55	4561.45

7993	90.00	358.80	4726.86	3651.78	-41.93	3652.01	1428.22	3851.78	718.07	4561.93
8025	89.80	358.60	4726.91	3683.77	-42.66	3684.01	1396.23	3883.77	717.34	4562.66
8056	89.40	358.70	4727.13	3714.76	-43.39	3715.01	1365.24	3914.76	716.61	4563.39
8088	90.50	358.00	4727.16	3746.75	-44.31	3747.01	1333.25	3946.75	715.69	4564.31
8120	90.30	358.20	4726.93	3778.73	-45.37	3779.00	1301.27	3978.73	714.63	4565.37
8151	90.10	357.70	4726.83	3809.71	-46.48	3809.99	1270.29	4009.71	713.52	4566.48
8183	90.90	358.10	4726.55	3841.69	-47.65	3841.98	1238.31	4041.69	712.35	4567.65
8215	90.60	357.70	4726.13	3873.66	-48.83	3873.97	1206.34	4073.66	711.17	4568.83
8246	90.50	358.20	4725.83	3904.64	-49.94	3904.96	1175.36	4104.64	710.06	4569.94
8271	90.10	358.00	4725.70	3929.63	-50.76	3929.95	1150.37	4129.63	709.24	4570.76
8303	89.80	358.00	4725.73	3961.61	-51.88	3961.95	1118.39	4161.61	708.12	4571.88
8335	90.00	358.10	4725.78	3993.59	-52.97	3993.94	1086.41	4193.59	707.03	4572.97
8366	91.30	357.40	4725.43	4024.56	-54.19	4024.93	1055.44	4224.56	705.81	4574.19
8398	91.20	357.10	4724.73	4056.52	-55.72	4056.90	1023.48	4256.52	704.28	4575.72
8429	90.70	357.30	4724.22	4087.48	-57.24	4087.87	992.52	4287.48	702.76	4577.24
8493	91.40	357.40	4723.05	4151.40	-60.19	4151.83	928.60	4351.40	699.81	4580.19
8524	90.50	358.20	4722.53	4182.37	-61.38	4182.81	897.63	4382.37	698.62	4581.38
8556	90.60	357.80	4722.23	4214.35	-62.50	4214.80	865.65	4414.35	697.50	4582.50
8588	90.40	357.90	4721.95	4246.32	-63.70	4246.79	833.68	4446.32	696.30	4583.70
8619	90.20	357.90	4721.78	4277.30	-64.84	4277.78	802.70	4477.30	695.16	4584.84
8651	89.90	357.50	4721.76	4309.28	-66.12	4309.77	770.72	4509.28	693.88	4586.12
8683	91.60	357.90	4721.34	4341.25	-67.41	4341.76	738.75	4541.25	692.59	4587.41
8714	92.10	358.00	4720.34	4372.21	-68.51	4372.73	707.79	4572.21	691.49	4588.51
8746	91.90	358.10	4719.22	4404.17	-69.60	4404.71	675.83	4604.17	690.40	4589.60
8778	91.30	358.40	4718.33	4436.14	-70.58	4436.69	643.86	4636.14	689.42	4590.58
8809	91.00	358.00	4717.70	4467.12	-71.55	4467.68	612.88	4667.12	688.45	4591.55
8841	90.90	358.60	4717.17	4499.10	-72.50	4499.67	580.90	4699.10	687.50	4592.50
8872	91.00	358.00	4716.66	4530.09	-73.42	4530.66	549.91	4730.09	686.58	4593.42
8904	90.90	357.90	4716.13	4562.06	-74.57	4562.65	517.94	4762.06	685.43	4594.57
8936	91.00	358.40	4715.60	4594.04	-75.60	4594.64	485.96	4794.04	684.40	4595.60
8967	91.10	358.50	4715.03	4625.02	-76.44	4625.63	454.98	4825.02	683.56	4596.44
8998	91.10	358.50	4714.44	4656.01	-77.25	4656.62	423.99	4856.01	682.75	4597.25
9011	91.00	358.50	4714.20	4669.00	-77.59	4669.62	411.00	4869.00	682.41	4597.59

American Measurement Services

A Limited Liability Company
Ames, Oklahoma

Station Number: KS03R00
Producer: SANDRIDGE ENERGY
Lease: BRITT 1-20H
Sample Pressure: 110.0
Sample Temperature: 75.0
Cylinder Number: 4115
Analysis By: AMS
Date Sampled: 10/31/2011
Analysis Run Date: 10/31/2011

Gas Components	Mole Percent	GPM
Methane	54.233	
Ethane	6.192	1.6460
Propane	3.718	1.0180
lButane	0.567	0.1845
NButane	1.633	0.5120
iPentane	0.401	0.1459
NPentane	0.549	0.1979
C6 +	0.749	0.3251
Nitrogen	26.383	
CO2	5.574	
	100.00%	4.0295

BTU @ 14.65 @ 60 F - Real

Dry 898.7
Wet 883.0

Gasoline Content

Propane And Heavier 2.3835
Butane And Heavier 1.3654
Pentane And Heavier 0.6689

Specific Gravity - Real 0.8552
Z = 0.9973

H2S Field Test: PPM

Field Remarks: Pulled from separator

Analysis Based Upon GPA 2145, 2172, And 2261

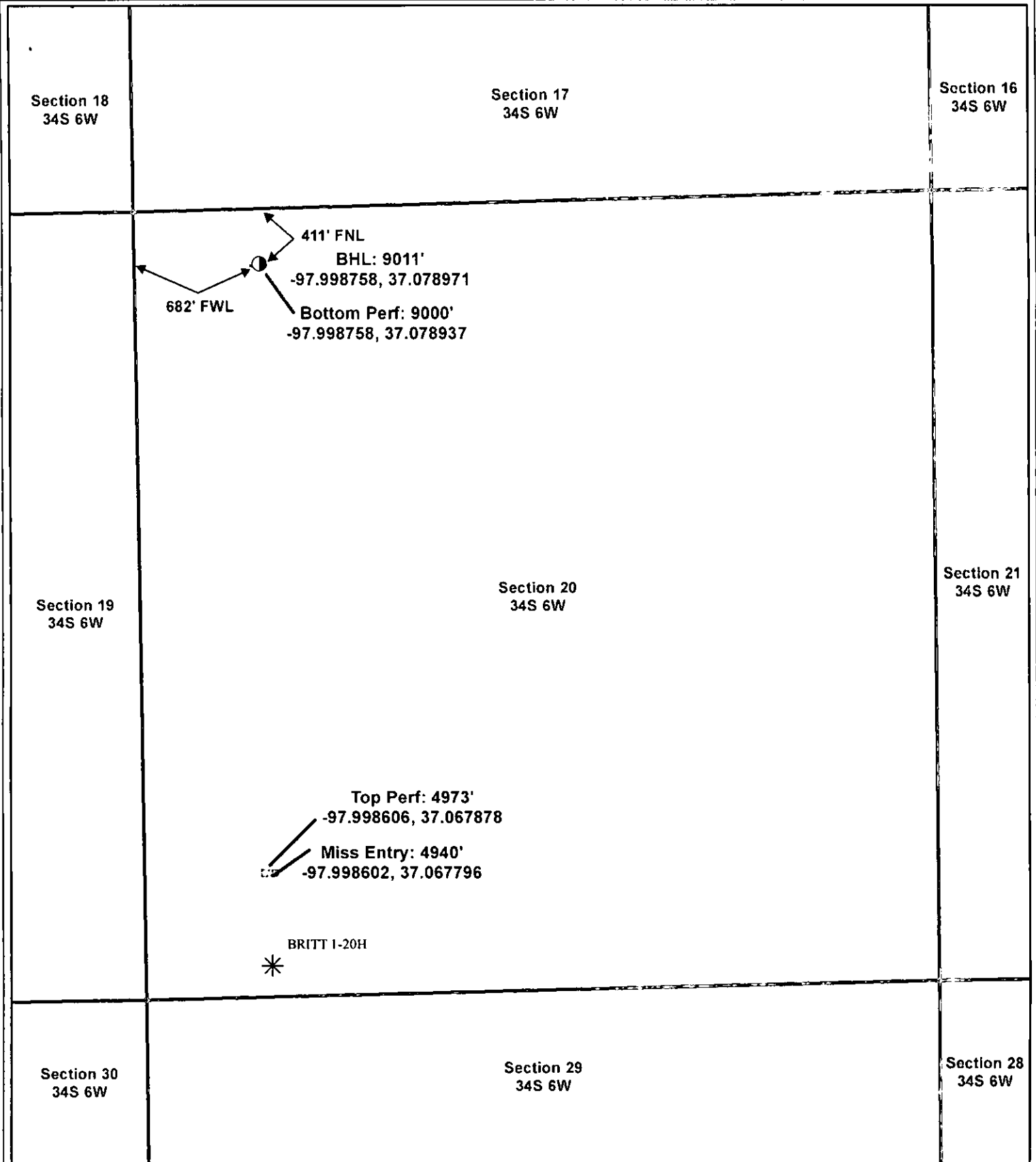

<p>● Actual BH Location</p> <p>* SandRidge Wells</p> <p>Perf</p> <p>Sections</p>	<p>Actual Bottom-Hole Location of Britt 1-20H Harper County, Kansas T&R: 34S 6W Section: 20, 411' FNL & 682' FEL Long: -97.998758, Lat: 37.078971</p> <p>1 in = 833 ft</p>	<p>Draftsman: Matt White</p> <p>Draft Date: 2/1/2012</p>	
		<p>Drawing Name/Number: Addendum_Britt_1-20H.mxd</p>	
		<p>Coordinate System: NAD 1927 State Plane Kansas South FIPS: 1502</p>	

Conservation Division
Finney State Office Building
130 S. Market, Rm. 2078
Wichita, KS 67202-3802



Phone: 316-337-6200
Fax: 316-337-6211
<http://kcc.ks.gov/>

Mark Sievers, Chairman
Ward Loyd, Commissioner
Thomas E. Wright, Commissioner

Sam Brownback, Governor

February 02, 2012

John-Mark Beaver
SandRidge Exploration and Production LLC
123 ROBERT S. KERR AVE
OKLAHOMA CITY, OK 73102-6406

Re: ACO-1
API 15-077-21746-01-00
Britt 1-20H
SW/4 Sec.20-34S-06W
Harper County, Kansas

Dear John-Mark Beaver:

K.A.R. 82-3-107 provides for all completion information to be filed within 120 days of the spud date. Subsection(e)(2) of that regulation states "All rights to confidentiality shall be lost if the filings are not timely."

The above referenced well was spudded on 09/12/2011 and the ACO-1 was received on February 01, 2012 (not within the 120 days timely requirement).

Therefore, your request for confidential treatment of data contained within the ACO-1 filing cannot be granted at this time.

If you should have any questions, please do not hesitate to contact me at (316)337-6200.

Sincerely,

Production Department

Conservation Division
Finney State Office Building
130 S. Market, Rm. 2078
Wichita, KS 67202-3802



Phone: 316-337-6200
Fax: 316-337-6211
<http://kcc.ks.gov/>

Mark Sievers, Chairman
Ward Loyd, Commissioner
Thomas E. Wright, Commissioner

Sam Brownback, Governor

January 19, 2012

John-Mark Beaver
SandRidge Exploration and Production LLC
123 ROBERT S. KERR AVE
OKLAHOMA CITY, OK 73102-6406

Re: ACO1
API 15-077-21746-01-00
Britt 1-20H
SW/4 Sec.20-34S-06W
Harper County, Kansas

Dear Production Department:

We are herewith requesting that the Well Completion Form ACO-1 and attached information for the subject well be held confidential for a period of two years.

Should you have any questions or need additional information regarding subject well, please contact our office.

Respectfully,
John-Mark Beaver