

STATE CORPORATION COMMISSION OF KANSAS
OIL & GAS CONSERVATION DIVISION

WELL COMPLETION OR RECOMPLETION FORM
ACO-1 WELL HISTORY

DESCRIPTION OF WELL AND LEASE

Operator: license # 5399
name American Energies Corporation
address 575 Fourth Financial Center
City/State/Zip Wichita, KS. 67202

Operator Contact Person Alan DeGood
Phone 316-263-5785

Contractor: license # 5147
name BEREDCO, INC.

Wellsite Geologist Harold A. Brown
Phone 316-263-5785

PURCHASER N/A

Designate Type of Completion
 New Well Re-Entry Workover

- Oil SWD Temp Abd
- Gas Inj Delayed Comp.
- Dry Other (Core, Water Supply etc.)

If OWWO: old well info as follows:
Operator
Well Name
Comp. Date Old Total Depth

WELL HISTORY

Drilling Method: Mud Rotary Air Rotary Cable

10/25/86 11/02/86 11/03/86
Spud Date Date Reached TD Completion Date

4800' Total Depth PBD

Amount of Surface Pipe Set and Cemented at 254' feet

Multiple Stage Cementing Collar Used? Yes No

If Yes, Show Depth Set feet

If alternate 2 completion, cement circulated from feet depth to w/ SX cmt

API NO. 15-171-20,345-00-00

County Scott

NW NW SE Sec 16 Twp 20S Rge 33

2310 Ft North from Southeast Corner of Section
2310 Ft West from Southeast Corner of Section
(Note: locate well in section plat below)

Lease Name Flying "M" Ranch Well# B-1

Field Name Wildcat

Producing Formation Mississippian

Elevation: Ground 2,960' KB 2,965'

Section Plat

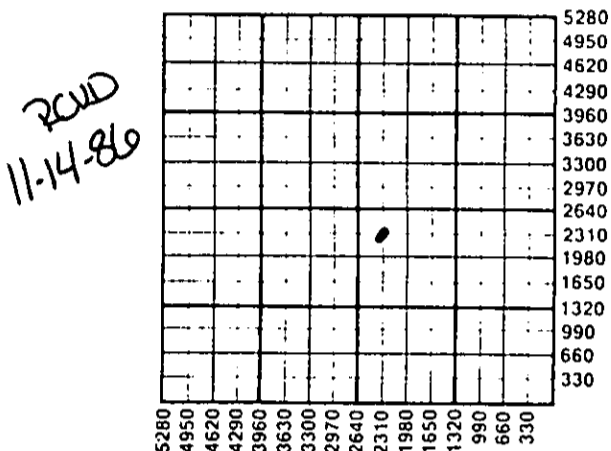

WATER SUPPLY INFORMATION

Source of Water:

Division of Water Resources Permit #

Groundwater Ft North From Southeast Corner and
(Well) Ft. West From Southeast Corner of
Sec Twp Rge East West

Surface Water Ft North From Southeast Corner and
(Stream, Pond etc.) Ft West From Southeast Corner
Sec Twp Rge East West

Other (explain) Purchased Mr. Miller's well in
(purchased from city, R.W.D.#) SE/4 16-20-33

Disposition of Produced Water: Disposal Repressuring

Docket #

INSTRUCTIONS: This form shall be completed in duplicate and filed with the Kansas Corporation Commission, 200 Colorado Derby Building, Wichita, Kansas 67202, within 90 days after completion or recompletion of any well. Rules 82-3-130 and 82-3-107 apply.

Information on side two of this form will be held confidential for a period of 12 months if requested in writing and submitted with the form. See rule 82-3-107 for confidentiality in excess of 12 months.

One copy of all wireline logs and drillers time log shall be attached with this form. Submit CP-4 form with all plugged wells. Submit CP-111 form with all temporarily abandoned wells.

All requirements of the statutes, rules, and regulations promulgated to regulate the oil and gas industry have been fully complied with and the statements herein are complete and correct to the best of my knowledge.

Signature Alan L. DeGood
Title Vice-President Date 11-13-86

Subscribed and sworn to before me this 13th day of November 19 86

Notary Public LuAnn Hershorn
Date Commission Expires 8-29-88

K.C.C. OFFICE USE ONLY
F Letter of Confidentiality Attached
C Wireline Log Received
C Drillers Timelog Received
Distribution
 KCC SWD/Rep NGPA
 KGS Plug Other (Specify)



Vertical handwritten note: Nov. 16, 1986, 20 Rge. 33

SIDE TWO

Operator Name American Energies Corp. Lease Name Flying "M" Well# B-1 SEC 16... TWP.20S...RGE.33..... East West
 Ranch B-1

WELL LOG

INSTRUCTIONS: Show important tops and base of formations penetrated. Detail all cores. Report all drill stem tests giving interval tested, time tool open and closed, flowing and shut-in pressures, whether shut-in pressure reached static level, hydrostatic pressures, bottom hole temperature, fluid recovery, and flow rates if gas to surface during test. Attach extra sheet if more space is needed. Attach copy of log.

Drill Stem Tests Taken Yes No
 Samples Sent to Geological Survey Yes No
 Cores Taken Yes No

Formation Description
 Log Sample

DST #1 4652-4700. Rec. 30' SOCM.
 IFP 50-50/30"
 ISIP 1165/63"
 FFP 57-58/65"
 FSIP 940/60"

Name	Top	Bottom
Shale/sand	0	2040'
Lime/shale/anyhidrite	2040	2440'
Lime/shale	2440	4800'
T Stone Canal	2048	+917
Heebner	3813	-848
Lansing	3856	-891
Hertha	4244	-1279
Morrow	4615	-1650
Ste Genevieve	4661	-1696
St Louis	4724	-1759

CASING RECORD <input type="checkbox"/> new <input type="checkbox"/> used							
Report all strings set - conductor, surface, intermediate, production, etc.							
Purpose of string	size hole drilled	size casing set (in O.D.)	weight lbs/ft.	setting depth	type of cement	# sacks used	type and percent additives
Surface	8-5/8		25#	254'	60/40 Poz	165	
PERFORATION RECORD				Acid, Fracture, Shot, Cement Squeeze Record			
shots per foot	specify footage of each interval perforated			(amount and kind of material used)			Depth
TUBING RECORD				Liner Run <input type="checkbox"/> Yes <input type="checkbox"/> No			
Date of First Production	Producing method <input type="checkbox"/> flowing <input type="checkbox"/> pumping <input type="checkbox"/> gas lift <input type="checkbox"/> Other (explain)						
Estimated Production Per 24 Hours	Oil	Gas	Water	Gas-Oil Ratio	Gravity		
	Bbls	MCF	Bbls	CFPB			

Disposition of gas: vented sold used on lease

METHOD OF COMPLETION: open hole perforation other (specify) _____

PRODUCTION INTERVAL: _____

Dually Completed.
 Commingled

NOV 1 1964