

FOR KCC USE:

FORM C-1 7/91

FORM MUST BE TYPED

FORM MUST BE SIGNED

ALL BLANKS MUST BE FILLED

EFFECTIVE DATE: 10-20-92

State of Kansas

DISTRICT # 2

NOTICE OF INTENTION TO DRILL

SEAT: Yes No

Must be approved by the K.C.C. five (5) days prior to commencing well

Expected Spud Date: October 15, 1992

Spot 50 feet East of Ctr. N/2 NE NE Sec 22 Twp 16 S. Rg 4 West

OPERATOR: License # 3869
Name: IMPERIAL OIL PROPERTIES, INC.
Address: 212 N. Market, #513
City/State/Zip: Wichita, KS 67202
Contact Person: Robert L. Williams, Jr.
Phone: 316.265-6977

950 feet from South / NE line of Section
610 feet from East / NE line of Section
IS SECTION X REGULAR IRREGULAR?
(NOTE: Locate well on the Section Plat on Reverse Side)
County: SALINE
Lease Name: CHRISTOPHER Well #: 1
Field Name: Wildcat

CONTRACTOR: License # 5822
Name: VAL ENERGY, INC.

Is this a Prorated/Spaced Field? yes X no
Target Formation(s): Maquoketa, Simpson
Nearest lease or unit boundary: 330 feet
Ground Surface Elevation: 1385 feet MSL
Water well within one-quarter mile: yes X no
Public water supply well within one mile: yes X no
Depth to bottom of fresh water: 150 feet
Depth to bottom of usable water: 180 feet
Surface Pipe by Alternate: X 1 2
Length of Surface Pipe Planned to be set: 250 feet
Length of Conductor pipe required:
Projected Total Depth: 3800 feet
Formation at Total Depth: Arbuckle
Water Source for Drilling Operations:
X well farm pond other
DNR Permit #: Will advise when well is drilled
Will Cores Be Taken?: yes X no
If yes, proposed zone:

Well Drilled For: Well Class: Type Equipment:
X Oil Enh Rec Infield X Mud Rotary
Gas Storage Pool Ext. Air Rotary
OAWO Disposal Wildcat Cable
Seismic: # of Holes Other
Other

If OAWO: old well information as follows:
Operator:
Well Name:
Comp. Date: Old Total Depth

Directional, Deviated or Horizontal wellbore? yes X no
If yes, true vertical depth:
Bottom Hole Location:

AFFIDAVIT

The undersigned hereby affirms that the drilling, completion and eventual plugging of this well will comply with K.S.A. 55-101, et. seq.
It is agreed that the following minimum requirements will be met:

- 1. Notify the appropriate district office prior to spudding of well;
2. A copy of the approved notice of intent to drill shall be posted on each drilling rig;
3. The minimum amount of surface pipe as specified below shall be set by circulating cement to the top; in all cases surface pipe shall be set through all unconsolidated materials plus a minimum of 20 feet into the underlying formation;
4. If the well is dry hole, an agreement between the operator and the district office on plug length and placement is necessary prior to plugging;
5. The appropriate district office will be notified before well is either plugged or production casing is cemented in;
6. IF AN ALTERNATE II COMPLETION, PRODUCTION PIPE SHALL BE CEMENTED FROM BELOW ANY USABLE WATER TO SURFACE WITHIN 120 DAYS OF SPUD DATE. IN ALL CASES, NOTIFY DISTRICT OFFICE PRIOR TO ANY CEMENTING.

I hereby certify that the statements made herein are true and to the best of my knowledge and belief.
Date: OCTOBER 5, 1992 Signature of Operator or Agent: Title: PRESIDENT

FOR KCC USE:
API # 15- 169-20309-02-00
Conductor pipe required None feet
Minimum surface pipe required 250 feet per Alt. O X
Approved by: CB 10-15-92
This authorization expires: 4-15-93
(This authorization void if drilling not started within 6 months of effective date.)
Spud date: Agent:

RECEIVED
STATE CORPORATION COMMISSION
OCT 6 1992
10-06-1992
CONSERVATION DIVISION
Wichita, Kansas

REMEMBER TO:

- File Drill Pit Application (form CDP-1) with Intent to Drill;
- File Completion Form ACO-1 within 120 days of spud date;
- File acreage attribution plat according to field proration orders;
- Notify appropriate district office 48 hours prior to workover or re-entry;
- Submit plugging report (CP-4) after plugging is completed;
- Obtain written approval before disposing or injecting salt water.

Mail to: Conservation Division, 200 Colorado Derby Building, 202 W. First St., Wichita, Kansas 67202-1286.

IN ALL CASES PLOT THE INTENDED WELL ON THE PLAT BELOW

PLAT OF ACREAGE ATTRIBUTABLE TO A WELL IN A PRORATED OR SPACED FIELD

If the intended well is in a prorated or spaced field, please fully complete this side of the form. If the intended well is in a prorated or spaced field complete the plat below showing that the well will be properly located in relationship to other wells producing from the common source of supply. Please show all the wells within 1 mile of the boundaries of the proposed acreage attribution unit for gas wells and within 1/2 mile of the boundaries of the proposed acreage attribution unit for oil wells.

API NO. 15- _____
 OPERATOR IMPERIAL OIL PROPERTIES, INC.
 LEASE CHRISTOPHER
 WELL NUMBER 1
 FIELD WILDCAT

LOCATION OF WELL: COUNTY SALINE
330 feet from ~~south~~/north line of section
610 feet from east/~~west~~ line of section
 SECTION 22 TWP 16 South RG 4 West

NUMBER OF ACRES ATTRIBUTABLE TO WELL _____
 QTR/QTR/QTR OF ACREAGE _____

IS SECTION X REGULAR or _____ IRREGULAR
IF SECTION IS IRREGULAR, LOCATE WELL FROM NEAREST CORNER BOUNDARY.

Section corner used: _____ NE _____ NW _____ SE _____ SW

PLAT

(Show location of the well and shade attributable acreage for prorated or spaced wells.)
 (Show footage to the nearest lease or unit boundary line.)

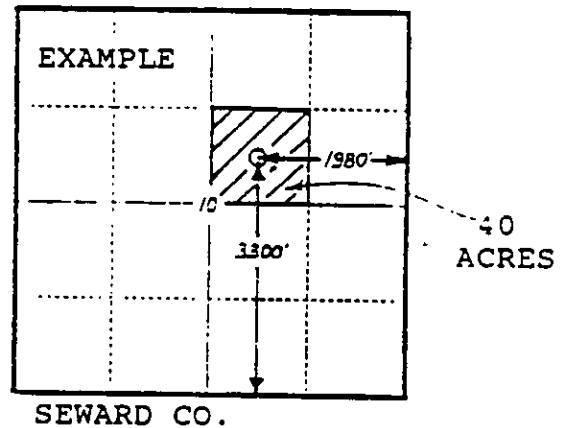
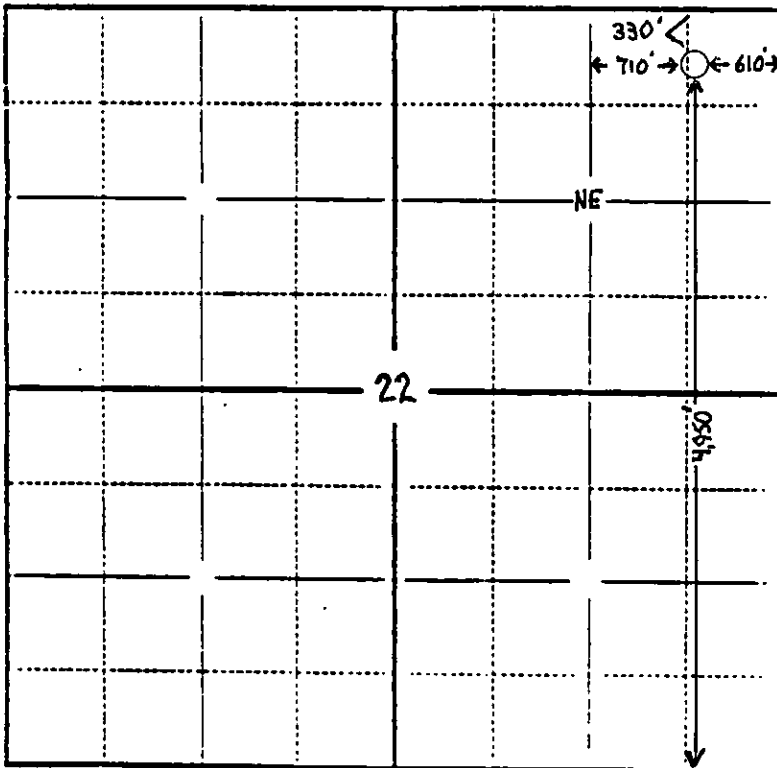

In plotting the proposed location of the well, you must show:

- 1) The manner in which you are using the depicted plat by identifying section lines, i.e. 1 section, 1 section with 8 surrounding sections, 4 sections, etc.;
- 2) the distance of the proposed drilling location from the section's south/north and east/west lines; and
- 3) the distance to the nearest lease or unit boundary line.