

Owwo

For KCC Use: 4-21-2012
Effective Date: _____
District # _____
SGA? Yes No

KANSAS CORPORATION COMMISSION
OIL & GAS CONSERVATION DIVISION

Form C-1
March 2010
Form must be Typed
Form must be Signed
All blanks must be Filled

NOTICE OF INTENT TO DRILL

Must be approved by KCC five (5) days prior to commencing well
Form KSONA-1, Certification of Compliance with the Kansas Surface Owner Notification Act, MUST be submitted with this form.

Expected Spud Date: 4 15 2012
month day year

Spot Description: 250' W of C SE NW
W2 SE NW Sec. 30 Twp. 27 S. R. 29 E W
1,980 feet from N / S Line of Section
1,730 feet from E / W Line of Section

OPERATOR: License# 34472
Name: Sunflower Energy, LLC
Address 1: 10801 Mastin
Address 2: Suite 920
City: Overland Park State: KS Zip: 66210 + _____
Contact Person: W.P. Moore
Phone: 913-491-1717

Is SECTION: Regular Irregular?
(Note: Locate well on the Section Plat on reverse side)
County: Gray

CONTRACTOR: License# 33793
Name: H2 Drilling LLC

Lease Name: Ginest Well #: #1 OWWO
Field Name: Unnamed
Is this a Prorated / Spaced Field? Yes No
Target Formation(s): Mississippi

Well Drilled For: Oil Gas Enh Rec Storage Disposal Seismic; # of Holes _____ Other: _____
Well Class: Infield Pool Ext. Wildcat Other _____
Type Equipment: Mud Rotary Air Rotary Cable

Nearest Lease or unit boundary line (in footage): 660
Ground Surface Elevation: 2754 feet MSL
Water well within one-quarter mile: Yes No
Public water supply well within one mile: Yes No
Depth to bottom of fresh water: 280 280
Depth to bottom of usable water: 760
Surface Pipe by Alternate: I II
Length of Surface Pipe Planned to be set: 1784 set
Length of Conductor Pipe (if any): _____
Projected Total Depth: 5200
Formation at Total Depth: Mississippi

If OWWO: old well information as follows:
Operator: Pendleton Land & Exploration, Inc.
Well Name: Ginest #1
Original Completion Date: 11/25/79 Original Total Depth: 5200

Water Source for Drilling Operations:
 Well Farm Pond Other: Hauled
DWR Permit #: _____
(Note: Apply for Permit with DWR No Yes)
Will Cores be taken? Yes No
If Yes, proposed zone: _____

Directional, Deviated or Horizontal wellbore? Yes No
If Yes, true vertical depth: _____
Bottom Hole Location: _____
KCC DKT #: _____

AFFIDAVIT

The undersigned hereby affirms that the drilling, completion and eventual plugging of this well will comply with K.S.A. 55 et. seq.
It is agreed that the following minimum requirements will be met:

1. Notify the appropriate district office **prior** to spudding of well;
2. A copy of the approved notice of intent to drill **shall be** posted on each drilling rig;
3. The minimum amount of surface pipe as specified below **shall be set** by circulating cement to the top; in all cases surface pipe **shall be set** through all unconsolidated materials plus a minimum of 20 feet into the underlying formation.
4. If the well is dry hole, an agreement between the operator and the district office on plug length and placement is necessary **prior to plugging**;
5. The appropriate district office will be notified before well is either plugged or production casing is cemented in;
6. If an ALTERNATE II COMPLETION, production pipe shall be cemented from below any usable water to surface within **120 DAYS** of spud date.
Or pursuant to Appendix "B" - Eastern Kansas surface casing order #133,891-C, which applies to the KCC District 3 area, alternate II cementing must be completed within 30 days of the spud date or the well shall be plugged. **In all cases, NOTIFY district office** prior to any cementing.

I hereby certify that the statements made herein are true and to the best of my knowledge and belief.

Date: 3/19/12 Signature of Operator or Agent: [Signature] Title: MANAGING MEMBER

RECEIVED
MAR 26 2012
KCC WICHITA

For KCC Use ONLY
API # 15 - 069-20053-0001
Conductor pipe required None feet
Minimum surface pipe required 1784 feet per ALT. I II
Approved by: [Signature] 4-16-2012
This authorization expires: 4-16-2013
(This authorization void if drilling not started within 12 months of approval date.)
Spud date: _____ Agent: _____

Remember to:
- File Certification of Compliance with the Kansas Surface Owner Notification Act (KSONA-1) with Intent to Drill;
- File Drill Pit Application (form CDP-1) with Intent to Drill;
- File Completion Form ACO-1 within 120 days of spud date;
- File acreage attribution plat according to field proration orders;
- Notify appropriate district office 48 hours prior to workover or re-entry;
- Submit plugging report (CP-4) after plugging is completed (within 60 days);
- Obtain written approval before disposing or injecting salt water.
- If well will not be drilled or permit has expired (See: authorized expiration date) please check the box below and return to the address below.
 Well will not be drilled or Permit Expired Date: _____
Signature of Operator or Agent: _____

Mail to: KCC - Conservation Division,
130 S. Market - Room 2078, Wichita, Kansas 67202

30
27
29
 E W

For KCC Use ONLY

API # 15 - 069-20053-0001

IN ALL CASES PLOT THE INTENDED WELL ON THE PLAT BELOW

In all cases, please fully complete this side of the form. Include items 1 through 5 at the bottom of this page.

Operator: Sunflower Energy, LLC
 Lease: Ginest
 Well Number: #1 OWWO
 Field: _____
 Number of Acres attributable to well: _____
 QTR/QTR/QTR/QTR of acreage: _____ - _____ - SE - NW

Location of Well: County: Gray
 _____ feet from N / S Line of Section
 _____ feet from E / W Line of Section
 Sec. 30 Twp. 27 S. R. 29 E W

Is Section: Regular or Irregular

If Section is Irregular, locate well from nearest corner boundary.

Section corner used: NE NW SE SW

PLAT

Show location of the well. Show footage to the nearest lease or unit boundary line. Show the predicted locations of lease roads, tank batteries, pipelines and electrical lines, as required by the Kansas Surface Owner Notice Act (House Bill 2032). You may attach a separate plat if desired.

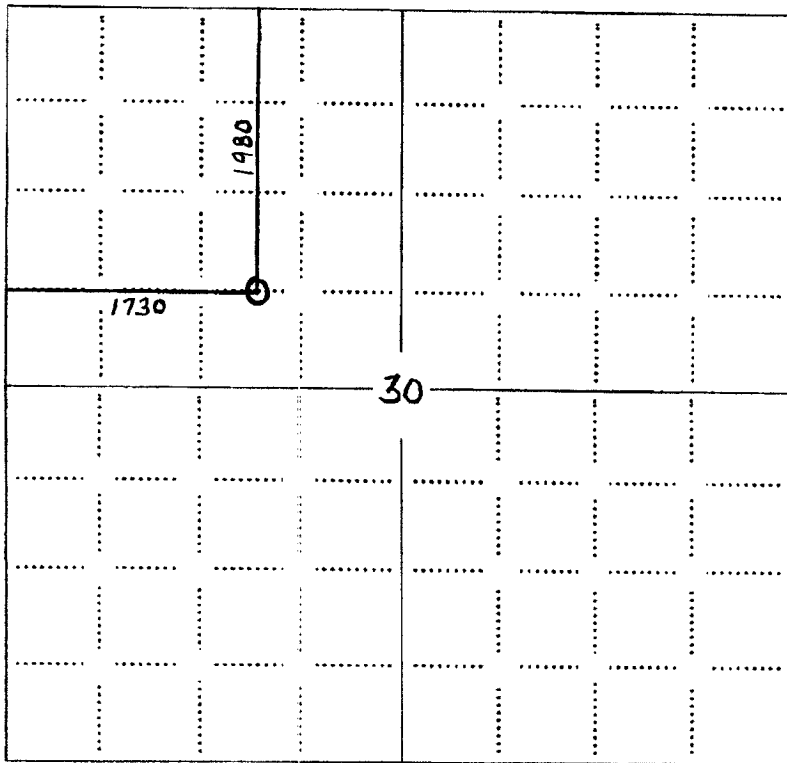

- LEGEND**
- Well Location
 - Tank Battery Location
 - Pipeline Location
 - Electric Line Location
 - Lease Road Location

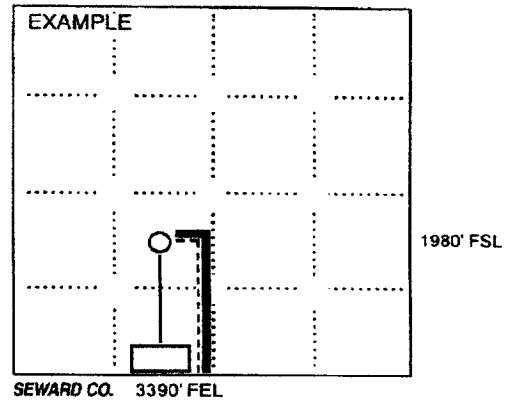

NOTE: In all cases locate the spot of the proposed drilling location.

In plotting the proposed location of the well, you must show:

1. The manner in which you are using the depicted plat by identifying section lines, i.e. 1 section, 1 section with 8 surrounding sections, 4 sections, etc.
2. The distance of the proposed drilling location from the south / north and east / west outside section lines.
3. The distance to the nearest lease or unit boundary line (in footage).
4. If proposed location is located within a prorated or spaced field a certificate of acreage attribution plat must be attached: (CO-7 for oil wells; CG-8 for gas wells).

5. The predicted locations of lease roads, tank batteries, pipelines, and electrical lines.

RECEIVED
 MAR 26 2012
 KCC WICHITA

For KCC Use ONLY

API # 15 - 069-20053-0001

IN ALL CASES PLOT THE INTENDED WELL ON THE PLAT BELOW

In all cases, please fully complete this side of the form. Include items 1 through 5 at the bottom of this page.

Operator: Sunflower Energy, LLC

Lease: Ginest

Well Number: #1 OWWO

Field: _____

Number of Acres attributable to well: _____

QTR/QTR/QTR/QTR of acreage: _____ - _____ - SE - NW

Location of Well: County: Gray

1,980 feet from N / S Line of Section

1,730 feet from E / W Line of Section

Sec. 30 Twp. 27 S. R. 29 E W

Is Section: Regular or Irregular

If Section is Irregular, locate well from nearest corner boundary.

Section corner used: NE NW SE SW

PLAT

Show location of the well. Show footage to the nearest lease or unit boundary line. Show the predicted locations of lease roads, tank batteries, pipelines and electrical lines, as required by the Kansas Surface Owner Notice Act (House Bill 2032). You may attach a separate plat if desired.

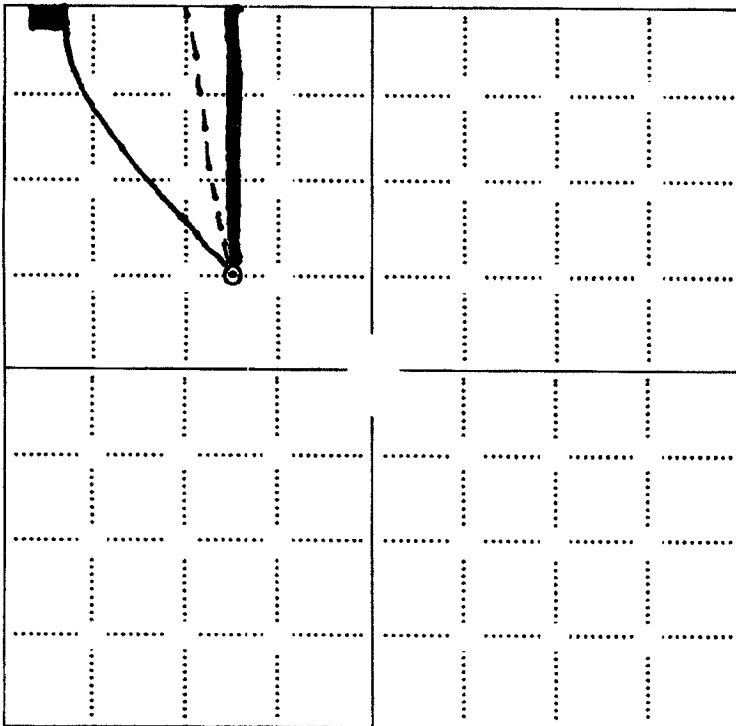

LEGEND

- Well Location
- Tank Battery Location
- Pipeline Location
- Electric Line Location
- Lease Road Location

RECEIVED
MAR 26 2012
KCC-WICHITA

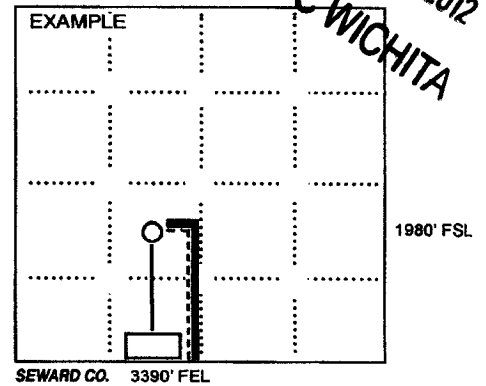

NOTE: In all cases locate the spot of the proposed drilling location.

In plotting the proposed location of the well, you must show:

1. The manner in which you are using the depicted plat by identifying section lines, i.e. 1 section, 1 section with 8 surrounding sections, 4 sections, etc.
2. The distance of the proposed drilling location from the south / north and east / west outside section lines.
3. The distance to the nearest lease or unit boundary line (in footage).
4. If proposed location is located within a prorated or spaced field a certificate of acreage attribution plat must be attached: (C0-7 for oil wells; CG-8 for gas wells).
5. The predicted locations of lease roads, tank batteries, pipelines, and electrical lines.

KANSAS CORPORATION COMMISSION
OIL & GAS CONSERVATION DIVISION

Form KSONA-1
July 2010
Form Must Be Typed
Form must be Signed
All blanks must be Filled

**CERTIFICATION OF COMPLIANCE WITH THE
KANSAS SURFACE OWNER NOTIFICATION ACT**

15-069-20053-0001

This form must be submitted with all Forms C-1 (Notice of Intent to Drill); CB-1 (Cathodic Protection Borehole Intent); T-1 (Request for Change of Operator Transfer of Injection or Surface Pit Permit); and CP-1 (Well Plugging Application). Any such form submitted without an accompanying Form KSONA-1 will be returned.

Select the corresponding form being filed: C-1 (Intent) CB-1 (Cathodic Protection Borehole Intent) T-1 (Transfer) CP-1 (Plugging Application)

OPERATOR: License # 34472
Name: Sunflower Energy, LLC
Address 1: 10801 Mastin
Address 2: Suite 920
City: Overland Park State: KS Zip: 66210 + _____
Contact Person: W.P. Moore
Phone: (913) 491-1717 Fax: (_____) _____
Email Address: _____

Well Location:
_____ SE _____ NW Sec. 30 Twp. 27 S. R. 29 East West
County: Gray
Lease Name: Ginest Well #: #1 OWWO

If filing a Form T-1 for multiple wells on a lease, enter the legal description of the lease below:

Surface Owner Information:

Name: Kenneth G. Ginest
Address 1: 408 N. 1st St.
Address 2: _____
City: Garden City State: KS Zip: 67846 + _____

When filing a Form T-1 involving multiple surface owners, attach an additional sheet listing all of the information to the left for each surface owner. Surface owner information can be found in the records of the register of deeds for the county, and in the real estate property tax records of the county treasurer.

If this form is being submitted with a Form C-1 (Intent) or CB-1 (Cathodic Protection Borehole Intent), you must supply the surface owners and the KCC with a plat showing the predicted locations of lease roads, tank batteries, pipelines, and electrical lines. The locations shown on the plat are preliminary non-binding estimates. The locations may be entered on the Form C-1 plat, Form CB-1 plat, or a separate plat may be submitted.

Select one of the following:

- I certify that, pursuant to the Kansas Surface Owner Notice Act (House Bill 2032), I have provided the following to the surface owner(s) of the land upon which the subject well is or will be located: 1) a copy of the Form C-1, Form CB-1, Form T-1, or Form CP-1 that I am filing in connection with this form; 2) if the form being filed is a Form C-1 or Form CB-1, the plat(s) required by this form; and 3) my operator name, address, phone number, fax, and email address.
- I have not provided this information to the surface owner(s). I acknowledge that, because I have not provided this information, the KCC will be required to send this information to the surface owner(s). To mitigate the additional cost of the KCC performing this task, I acknowledge that I am being charged a \$30.00 handling fee, payable to the KCC, which is enclosed with this form.

If choosing the second option, submit payment of the \$30.00 handling fee with this form. If the fee is not received with this form, the KSONA-1 form and the associated Form C-1, Form CB-1, Form T-1, or Form CP-1 will be returned.

I hereby certify that the statements made herein are true and correct to the best of my knowledge and belief.

Date: 3/19/12 Signature of Operator or Agent: [Signature] Title: MANAGING MEMBER

RECEIVED
MAR 26 2012
KCC WICHITA

**KANSAS CORPORATION COMMISSION
OIL & GAS CONSERVATION DIVISION
APPLICATION FOR SURFACE PIT**

Form CDP-1
May 2010
Form must be Typed

Submit in Duplicate

Operator Name: Sunflower Energy, LLC		License Number: 34472
Operator Address: 10801 Mastin		Suite 920 Overland Park KS 66210
Contact Person: W.P. Moore		Phone Number: 913-491-1717
Lease Name & Well No.: Ginest #1 OWWO		Pit Location (QQQQ): <u>W2 SE NW</u> Sec. <u>30</u> Twp. <u>27</u> R. <u>29</u> <input type="checkbox"/> East <input checked="" type="checkbox"/> West <u>1,980</u> Feet from <input checked="" type="checkbox"/> North / <input type="checkbox"/> South Line of Section <u>1,730</u> Feet from <input type="checkbox"/> East / <input checked="" type="checkbox"/> West Line of Section <u>Gray</u> County
Type of Pit: <input type="checkbox"/> Emergency Pit <input type="checkbox"/> Burn Pit <input type="checkbox"/> Settling Pit <input checked="" type="checkbox"/> Drilling Pit <input type="checkbox"/> Workover Pit <input type="checkbox"/> Haul-Off Pit <small>(If WP Supply API No. or Year Drilled)</small>	Pit is: <input checked="" type="checkbox"/> Proposed <input type="checkbox"/> Existing If Existing, date constructed: _____ Pit capacity: <u>2,000</u> (bbis)	
Is the pit located in a Sensitive Ground Water Area? <input checked="" type="checkbox"/> Yes <input type="checkbox"/> No		Chloride concentration: _____ mg/l <small>(For Emergency Pits and Settling Pits only)</small>
Is the bottom below ground level? <input checked="" type="checkbox"/> Yes <input type="checkbox"/> No	Artificial Liner? <input type="checkbox"/> Yes <input checked="" type="checkbox"/> No	How is the pit lined if a plastic liner is not used? Native soil
Pit dimensions (all but working pits): <u>65</u> Length (feet) <u>65</u> Width (feet) Depth from ground level to deepest point: <u>6</u> (feet)		<input type="checkbox"/> N/A: Steel Pits <input type="checkbox"/> No Pit
If the pit is lined give a brief description of the liner material, thickness and installation procedure.		Describe procedures for periodic maintenance and determining liner integrity, including any special monitoring.
Distance to nearest water well within one-mile of pit: <u>2300</u> feet Depth of water well <u>240</u> feet		Depth to shallowest fresh water <u>100</u> feet. Source of information: <input type="checkbox"/> measured <input type="checkbox"/> well owner <input type="checkbox"/> electric log <input checked="" type="checkbox"/> KQWR
Emergency, Settling and Burn Pits ONLY: Producing Formation: _____ Number of producing wells on lease: _____ Barrels of fluid produced daily: _____ Does the slope from the tank battery allow all spilled fluids to flow into the pit? <input type="checkbox"/> Yes <input type="checkbox"/> No		Drilling, Workover and Haul-Off Pits ONLY: Type of material utilized in drilling/workover: <u>Drilling mud and water</u> Number of working pits to be utilized: <u>3</u> Abandonment procedure: <u>Allow free fluids to evaporate and cuttings to dry and backfill</u> Drill pits must be closed within 365 days of spud date.
I hereby certify that the above statements are true and correct to the best of my knowledge and belief.		
<u>3/19/12</u> Date		<u>[Signature]</u> Signature of Applicant or Agent
KCC OFFICE USE ONLY		
Date Received: <u>3-26-12</u> Permit Number: _____		Permit Date: <u>4-13-12</u> Lease Inspection: <input checked="" type="checkbox"/> Yes <input type="checkbox"/> No

**RECEIVED
MAR 26 2012
KCC-WICHITA**

15-069-20053-0001

STATE OF KANSAS
STATE CORPORATION COMMISSION

15069 20053 0000

WELL PLUGGING RECORD

Give All Information Completely
Make Required Affidavit
Mail or Deliver Report to
Conservation Division
State Corporation Comm.
245 North Water
Wichita, KS 67202

Gray County, Sec. 30 Twp. 27S Rge. 29 E/W
Location as "NE/CNW 1/4 SW 1/4" or footage from lines
C W/2 SE NW
Lease Owner Pendleton Land & Exploration, Inc.
Lease Name Ginest Well No. #1
Office Address 1410 Security Life Bldg., Denver, Colorado 8020
Character of Well (Completed as Oil, Gas or Dry Hole)
Dry Hole
Date Well completed 11-25-79 19
Application for plugging filed 11-25-79 19
Application for plugging approved 11-25-79 19
Plugging commenced 11-25-79 19
Plugging completed 11-25-79 19
Reason for abandonment of well or producing formation
Commercial quantities of oil not found
If a producing well is abandoned, date of last production 19

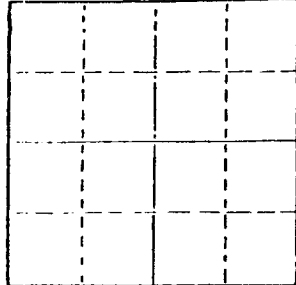

Locate well correctly on above
Section Plot

Name of Conservation Agent who supervised plugging of this well Clarence Thomas, Jr.
Producing formation _____ Depth to top _____ Bottom _____ Total Depth of Well 5200'
Show depth and thickness of all water, oil and gas formations.

OIL, GAS OR WATER RECORDS

CASING RECORD

FORMATION	CONTENT	FROM	TO	SIZE	PUT IN	PULLED OUT
				8 5/8"	1784'	None

Describe in detail the manner in which the well was plugged, indicating where the mud fluid was placed and the method or methods used in introducing it into the hold. If cement or other plugs were used, state the character of same and depth placed, from _____ feet to _____ feet for each plug set.

Plug @ 1750' w/50 sx.
Plug @ 750' w/25 sx.
Plug @ 40' w/10 sx.
Rat Hole 5 sx.

UEG - 1979

(If additional description is necessary, use BACK of this sheet)

Name of Plugging Contractor Rains & Williamson Oil Co., Inc.

STATE OF Kansas COUNTY OF Sedgwick, ss.
Wilson Rains, President of Rains & Williamson Oil Co., Inc. (employee of owner) or (owner or operator) of the above-described well, being first duly sworn on oath, says: That I have knowledge of the facts, statements, and matters herein contained and the log of the above described well as filed and that the same are true and correct. So help me God.

(Signature) Wilson Rains
435 Page Court, 220 W. Douglas, Wichita, Ks. 67202
(Address)

SUBSCRIBED AND SWORN TO before me this 30 day of November, 1979

My commission expires 10-4-83

Juanita M. Green
Juanita M. Green Notary Public.

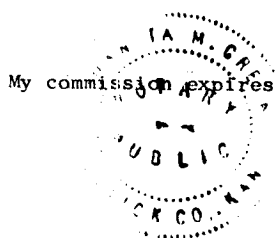

April 13, 2012

Sunflower Energy, LLC
10801 Mastin Ste 920
Overland Park, KS 66210

Re: Drilling Pit Application
Ginest Lease Well No. 1 OWWO
NW/4 Sec. 30-27S-29W
Gray County, Kansas

Dear Sir or Madam:

District staff has inspected the above referenced location and has determined that the reserve pit shall be constructed **without slots**, the bottom shall be flat and reasonably level, and the free fluids must be removed. The fluids are to be removed from the reserve pit within 96 hours of drilling completion.

If production casing is set all completion fluids shall be removed from the working pits daily. NO completion fluids or non-exempt wastes shall be placed in the reserve pit.

The fluids should be taken to an authorized disposal well. Please call the District Office at (620) 225-8888 when the fluids have been removed. Please file form CDP-5 (August 2004), Exploration and Production Waste Transfer, within 30 days of fluid removal. Conservation division forms are available through our office and on the KCC web site:
www.kcc.state.ks.us/conservation/forms.

A copy of this letter should be posted in the doghouse along with the approved Intent to Drill.

If you have any questions or concerns please feel free to contact the undersigned at the above address.

Sincerely,

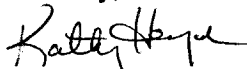

Kathy Haynes
Environmental Protection and Remediation Department

cc: File