

For KCC Use: 5-20-2012  
 Effective Date: 3  
 District #: 3  
 SGA?  Yes  No

KANSAS CORPORATION COMMISSION  
 OIL & GAS CONSERVATION DIVISION

Form C-1  
 March 2010  
 Form must be Typed  
 Form must be Signed  
 All blanks must be Filled

NOTICE OF INTENT TO DRILL

Must be approved by KCC five (5) days prior to commencing well  
 Form KSONA-1, Certification of Compliance with the Kansas Surface Owner Notification Act, MUST be submitted with this form.

Expected Spud Date: 5 month 2012 year

OPERATOR: License# 8333  
 Name: Barnett Oil / Winfred Barnett  
 Address 1: 2303 70th Rd.  
 Address 2: \_\_\_\_\_  
 City: Humboldt State: Ks. Zip: 66748 + \_\_\_\_\_  
 Contact Person: Monty Barnett  
 Phone: 620-473-2688  
 CONTRACTOR: License# 33900  
 Name: HoDown Drilling / Steve Leis

Spot Description: NW-SE SW-SE Sec. 5 Twp. 26 S. R. 17  E  W  
450 feet from  N /  S Line of Section  
1,949 feet from  E /  W Line of Section

Is SECTION:  Regular  Irregular?  
 (Note: Locate well on the Section Plat on reverse side)  
 County: Woodson

Lease Name: Pringle/Eastbrook Well #: B-4  
 Field Name: Charute/Humboldt Humboldt-Charute  
 Is this a Prorated / Spaced Field?  Yes  No  
 Target Formation(s): Bartlesville

Nearest Lease or unit boundary line (in footage): Min. 165'  
 Ground Surface Elevation: 1030 feet MSL

Water well within one-quarter mile:  Yes  No  
 Public water supply well within one mile:  Yes  No

Depth to bottom of fresh water: 60 ft.  
 Depth to bottom of usable water: 200 ft.

Surface Pipe by Alternate:  I  II  
 Length of Surface Pipe Planned to be set: 20'

Length of Conductor Pipe (if any): \_\_\_\_\_  
 Projected Total Depth: 1000

Formation at Total Depth: 1000' Cherokee Group.

Water Source for Drilling Operations:  
 Well  Farm Pond  Other: \_\_\_\_\_  
 DWR Permit #: \_\_\_\_\_

(Note: Apply for Permit with DWR   
 Will Cores be taken?  Yes  No  
 If Yes, proposed zone: \_\_\_\_\_

Well Drilled For:  Oil  Gas  Enh Rec  Storage  Disposal  Seismic; # of Holes \_\_\_\_\_  Other: \_\_\_\_\_  
 Well Class:  Infield  Pool Ext.  Wildcat  Other \_\_\_\_\_  
 Type Equipment:  Mud Rotary  Air Rotary  Cable  
 If OWWO: old well information as follows:  
 Operator: \_\_\_\_\_  
 Well Name: \_\_\_\_\_  
 Original Completion Date: \_\_\_\_\_ Original Total Depth: \_\_\_\_\_

Directional, Deviated or Horizontal wellbore?  Yes  No  
 If Yes, true vertical depth: \_\_\_\_\_  
 Bottom Hole Location: \_\_\_\_\_  
 KCC DKT #: \_\_\_\_\_

AFFIDAVIT

The undersigned hereby affirms that the drilling, completion and eventual plugging of this well will comply with K.S.A. 55 et. seq.  
 It is agreed that the following minimum requirements will be met:

1. Notify the appropriate district office prior to spudding of well;
2. A copy of the approved notice of intent to drill shall be posted on each drilling rig;
3. The minimum amount of surface pipe as specified below shall be set by circulating cement to the top; in all cases surface pipe shall be set through all unconsolidated materials plus a minimum of 20 feet into the underlying formation.
4. If the well is dry hole, an agreement between the operator and the district office on plug length and placement is necessary prior to plugging;
5. The appropriate district office will be notified before well is either plugged or production casing is cemented in;
6. If an ALTERNATE II COMPLETION, production pipe shall be cemented from below any usable water to surface within 120 DAYS of spud date. Or pursuant to Appendix "B" - Eastern Kansas surface casing order #133,891-C, which applies to the KCC District 3 area, alternate II cementing must be completed within 30 days of the spud date or the well shall be plugged. In all cases, NOTIFY district office prior to any cementing.

I hereby certify that the statements made herein are true and to the best of my knowledge and belief.

Date: 5-11-12 Signature of Operator or Agent: Winfred Barnett Title: owner/operator

For KCC Use ONLY  
 API # 15 - 207-28167-0000  
 Conductor pipe required None feet  
 Minimum surface pipe required 20 feet per ALT.  I  II  
 Approved by: June 5-15-2012  
 This authorization expires: 5-15-2013  
 (This authorization void if drilling not started within 12 months of approval date.)  
 Spud date: \_\_\_\_\_ Agent: \_\_\_\_\_

Remember to:

- File Certification of Compliance with the Kansas Surface Owner Notification Act (KSONA-1) with Intent to Drill;
- File Drill Pit Application (form CDP-1) with Intent to Drill;
- File Completion Form ACO-1 within 120 days of spud date;
- File acreage attribution plat according to field proration orders;
- Notify appropriate district office 48 hours prior to workover or re-entry;
- Submit plugging report (CP-4) after plugging is completed (within 60 days);
- Obtain written approval before disposing or injecting salt water.
- If well will not be drilled or permit has expired (See: authorized expiration date) please check the box below and return to the address below.

Well will not be drilled or Permit Expired Date: \_\_\_\_\_  
 Signature of Operator or Agent: \_\_\_\_\_

RECEIVED  
 MAY 14 2012  
 KCC WICHITA

5  
 26  
 17  
 E  
 W

For KCC Use ONLY

API # 15 - 207-28167-0000

### IN ALL CASES PLOT THE INTENDED WELL ON THE PLAT BELOW

In all cases, please fully complete this side of the form. Include items 1 through 5 at the bottom of this page.

Operator: Barnett Oil /Winfred Barnett  
 Lease: Pringle/Eastbrook  
 Well Number: B-4  
 Field: Chanute/Humboldt

Number of Acres attributable to well: \_\_\_\_\_  
 QTR/QTR/QTR/QTR of acreage: \_\_\_\_\_ - \_\_\_\_\_ - \_\_\_\_\_ - \_\_\_\_\_

Location of Well: County: Woodson  
 450 feet from  N /  S Line of Section  
 1,949 feet from  E /  W Line of Section  
 Sec. 5 Twp. 26 S. R. 17  E  W

Is Section:  Regular or  Irregular

If Section is Irregular, locate well from nearest corner boundary.  
 Section corner used:  NE  NW  SE  SW

### PLAT

Show location of the well. Show footage to the nearest lease or unit boundary line. Show the predicted locations of lease roads, tank batteries, pipelines and electrical lines, as required by the Kansas Surface Owner Notice Act (House Bill 2032). You may attach a separate plat if desired.

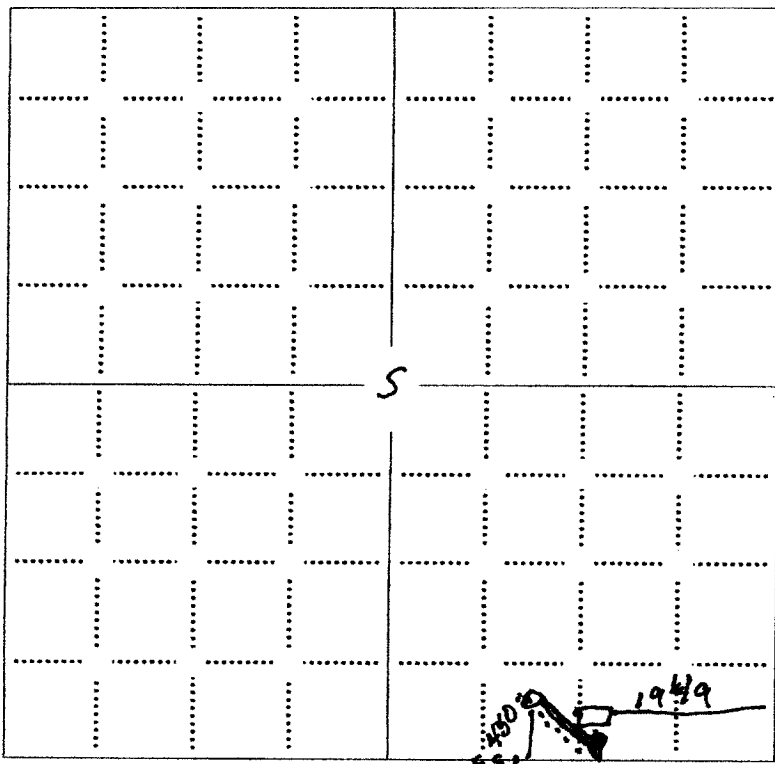

NOTE: In all cases locate the spot of the proposed drilling location.

#### LEGEND

- Well Location
- Tank Battery Location
- Pipeline Location
- Electric Line Location
- Lease Road Location

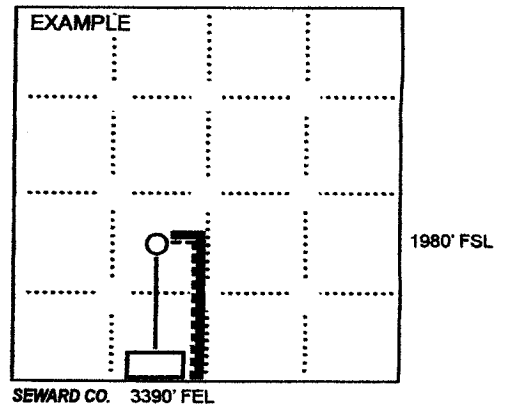

RECEIVED  
MAY 14 2012

KCC WICHITA

In plotting the proposed location of the well, you must show:

- The manner in which you are using the depicted plat by identifying section lines, i.e. 1 section, 1 section with 8 surrounding sections, 4 sections, etc.
- The distance of the proposed drilling location from the south / north and east / west outside section lines.
- The distance to the nearest lease or unit boundary line (in footage).
- If proposed location is located within a prorated or spaced field a certificate of acreage attribution plat must be attached: (CO-7 for oil wells; CG-8 for gas wells).

KANSAS CORPORATION COMMISSION  
OIL & GAS CONSERVATION DIVISION

Form KSONA-1  
July 2010  
Form Must Be Typed  
Form must be Signed  
All blanks must be Filled

**CERTIFICATION OF COMPLIANCE WITH THE  
KANSAS SURFACE OWNER NOTIFICATION ACT**

15-207-28167-0000

This form must be submitted with all Forms C-1 (Notice of Intent to Drill); CB-1 (Cathodic Protection Borehole Intent); T-1 (Request for Change of Operator Transfer of Injection or Surface Pit Permit); and CP-1 (Well Plugging Application). Any such form submitted without an accompanying Form KSONA-1 will be returned.

Select the corresponding form being filed:  C-1 (Intent)  CB-1 (Cathodic Protection Borehole Intent)  T-1 (Transfer)  CP-1 (Plugging Application)

OPERATOR: License # 8333  
Name: Barnett Oil / Winfred Barnett  
Address 1: 2303 70th Rd.  
Address 2:  
City: Humboldt State: Ks. Zip: 66748 +  
Contact Person: Monty Barnett  
Phone: ( 620 ) 473 Fax: ( 2688 )  
Email Address:

Well Location:  
\_\_\_\_\_ Sec. 5 Twp. 26 S. R. 17  East  West  
County: Woodson  
Lease Name: Pringle/Eastbrook Well #: B-4

If filing a Form T-1 for multiple wells on a lease, enter the legal description of the lease below:

**Surface Owner Information:**

Name: Eastbrook Dev. Com. Les Solomon  
Address 1: 113 Wetherburn Lane  
Address 2:  
City: Williamsburg State: VA Zip: 23188 +

When filing a Form T-1 involving multiple surface owners, attach an additional sheet listing all of the information to the left for each surface owner. Surface owner information can be found in the records of the register of deeds for the county, and in the real estate property tax records of the county treasurer.

If this form is being submitted with a Form C-1 (Intent) or CB-1 (Cathodic Protection Borehole Intent), you must supply the surface owners and the KCC with a plat showing the predicted locations of lease roads, tank batteries, pipelines, and electrical lines. The locations shown on the plat are preliminary non-binding estimates. The locations may be entered on the Form C-1 plat, Form CB-1 plat, or a separate plat may be submitted.

**Select one of the following:**

I certify that, pursuant to the Kansas Surface Owner Notice Act (House Bill 2032), I have provided the following to the surface owner(s) of the land upon which the subject well is or will be located: 1) a copy of the Form C-1, Form CB-1, Form T-1, or Form CP-1 that I am filing in connection with this form; 2) if the form being filed is a Form C-1 or Form CB-1, the plat(s) required by this form; and 3) my operator name, address, phone number, fax, and email address.

I have not provided this information to the surface owner(s). I acknowledge that, because I have not provided this information, the KCC will be required to send this information to the surface owner(s). To mitigate the additional cost of the KCC performing this task, I acknowledge that I am being charged a \$30.00 handling fee, payable to the KCC, which is enclosed with this form.

If choosing the second option, submit payment of the \$30.00 handling fee with this form. If the fee is not received with this form, the KSONA-1 form and the associated Form C-1, Form CB-1, Form T-1, or Form CP-1 will be returned.

I hereby certify that the statements made herein are true and correct to the best of my knowledge and belief.

Date: 5-11-12 Signature of Operator or Agent: Winfred Barnett Title: Owner/Operator

RECEIVED

MAY 14 2012

KCC WICHITA

**KANSAS CORPORATION COMMISSION  
OIL & GAS CONSERVATION DIVISION  
APPLICATION FOR SURFACE PIT**

Form CDP-1  
May 2010  
Form must be Typed

*Submit in Duplicate*

Operator Name: <b>Barnett Oil /Winfred Barnett</b>		License Number: <b>8333</b>
Operator Address: <b>2303 70th Rd.</b>		<b>Humboldt Ks. 66748</b>
Contact Person: <b>Monty Barnett</b>		Phone Number: <b>620-473-2688</b>
Lease Name & Well No.: <b>Pringle/Eastbrook B-4</b>		Pit Location (QQQQ): <b>NW SE SW SE</b> <b>SW - SW - SW -</b>
Type of Pit: <input type="checkbox"/> Emergency Pit <input type="checkbox"/> Burn Pit <input type="checkbox"/> Settling Pit <input checked="" type="checkbox"/> Drilling Pit <input type="checkbox"/> Workover Pit <input type="checkbox"/> Haul-Off Pit <small>(If WP Supply API No. or Year Drilled)</small>	Pit is: <input checked="" type="checkbox"/> Proposed <input type="checkbox"/> Existing If Existing, date constructed: _____ Pit capacity: <b>150</b> (bbls)	Sec. <b>5</b> Twp. <b>26</b> R. <b>17</b> <input checked="" type="checkbox"/> East <input type="checkbox"/> West <b>450</b> Feet from <input type="checkbox"/> North / <input checked="" type="checkbox"/> South Line of Section <b>1,949</b> Feet from <input checked="" type="checkbox"/> East / <input type="checkbox"/> West Line of Section <b>Woodson</b> County
Is the pit located in a Sensitive Ground Water Area? <input type="checkbox"/> Yes <input checked="" type="checkbox"/> No		Chloride concentration: _____ mg/l <small>(For Emergency Pits and Settling Pits only)</small>
Is the bottom below ground level? <input checked="" type="checkbox"/> Yes <input type="checkbox"/> No	Artificial Liner? <input type="checkbox"/> Yes <input checked="" type="checkbox"/> No	How is the pit lined if a plastic liner is not used? <b>Bentonite</b>
Pit dimensions (all but working pits): <b>20</b> Length (feet) <b>8</b> Width (feet) <input type="checkbox"/> N/A: Steel Pits Depth from ground level to deepest point: <b>4</b> (feet) <input type="checkbox"/> No Pit		
If the pit is lined give a brief description of the liner material, thickness and installation procedure.		Describe procedures for periodic maintenance and determining liner integrity, including any special monitoring.
Distance to nearest water well within one-mile of pit: <b>n/a</b> feet    Depth of water well _____ feet		Depth to shallowest fresh water <b>60</b> feet. Source of information: <input type="checkbox"/> measured <input checked="" type="checkbox"/> well owner <input type="checkbox"/> electric log <input type="checkbox"/> KDWR
<b>Emergency, Settling and Burn Pits ONLY:</b> Producing Formation: _____ Number of producing wells on lease: _____ Barrels of fluid produced daily: _____ Does the slope from the tank battery allow all spilled fluids to flow into the pit? <input type="checkbox"/> Yes <input type="checkbox"/> No		<b>Drilling, Workover and Haul-Off Pits ONLY:</b> Type of material utilized in drilling/workover: <b>Dry mud / Bentonite</b> Number of working pits to be utilized: <b>1</b> Abandonment procedure: <b>Air dry &amp; backfill.</b> Drill pits must be closed within 365 days of spud date.
I hereby certify that the above statements are true and correct to the best of my knowledge and belief.		<b>RECEIVED MAY 14 2012 KCC WICHITA</b>
<b>5-11-12</b> Date	 Signature of Applicant or Agent	

15-207-28167-0522

<b>KCC OFFICE USE ONLY</b>			
Date Received: <b>5-14-12</b>	Permit Number: _____	Permit Date: <b>5-14-12</b>	Lease Inspection: <input type="checkbox"/> Yes <input checked="" type="checkbox"/> No
<input type="checkbox"/> Liner <input type="checkbox"/> Steel Pit <input type="checkbox"/> RFAC <input type="checkbox"/> RFAS			