

0200

For KCC Use: 5-30-2012
Effective Date: _____
District # 4
SGA? Yes No

KANSAS CORPORATION COMMISSION
OIL & GAS CONSERVATION DIVISION
NOTICE OF INTENT TO DRILL

Form must be Typed
Form must be Signed
All blanks must be Filled

Must be approved by KCC five (5) days prior to commencing well

Form KSONA-1, Certification of Compliance with the Kansas Surface Owner Notification Act, MUST be submitted with this form.

Expected Spud Date: June 23 2012
month day year

OPERATOR: License# 5145
Name: Dreiling Oil, Inc.
Address 1: P.O. Box 550
Address 2: _____
City: Hays State: Ks. Zip: 67601 + 0550
Contact Person: Terry W. Piesker
Phone: 785-625-8327

CONTRACTOR: License# 6426
Name: Express Well Service and Supply

Well Drilled For: Oil Gas Enh Rec Storage Disposal Seismic; # of Holes _____ Other: To Replug per KCC Rules
Well Class: Infield Pool Ext. Wildcat Other
Type Equipment: Mud Rotary Air Rotary Cable
 If OWWO: old well information as follows:
Operator: Leo J. Dreiling Oil Co.
Well Name: Staab "A" #4
Original Completion Date: 2-7-66 Original Total Depth: 2-12-66

Spot Description: _____
W/2 - NE - SW Sec. 6 Twp. 13 S. R. 17 E W
(a/a/a/a) 1,980 feet from N / S Line of Section
1,650 feet from E / W Line of Section

Is SECTION: Regular Irregular?
(Note: Locate well on the Section Plat on reverse side)

County: Ellis
Lease Name: Staab "A" Well #: 4
Field Name: Polifka

Is this a Prorated / Spaced Field? Yes No
Target Formation(s): LKC

Nearest Lease or unit boundary line (in footage): 990'
Ground Surface Elevation: 2061 feet MSL
Water well within one-quarter mile: Yes No
Public water supply well within one mile: Yes No

Depth to bottom of fresh water: 120'
Depth to bottom of usable water: 500' 660

Surface Pipe by Alternate: I II
Length of Surface Pipe Planned to be set: _____
Length of Conductor Pipe (if any): _____
Projected Total Depth: 3629'

Formation at Total Depth: L-KC
Water Source for Drilling Operations:
 Well Farm Pond Other: _____
DWR Permit #: _____

(Note: Apply for Permit with DWR)
Will Cores be taken? Yes No
If Yes, proposed zone: _____

AFFIDAVIT

The undersigned hereby affirms that the drilling, completion and eventual plugging of this well will comply with K.S.A. 55 et. seq.
It is agreed that the following minimum requirements will be met:

1. Notify the appropriate district office **prior** to spudding of well;
2. A copy of the approved notice of intent to drill **shall be** posted on each drilling rig;
3. The minimum amount of surface pipe as specified below **shall be set** by circulating cement to the top; in all cases surface pipe shall be set through all unconsolidated materials plus a minimum of 20 feet into the underlying formation.
4. If the well is dry hole, an agreement between the operator and the district office on plug length and placement is necessary **prior to plugging**;
5. The appropriate district office will be notified before well is either plugged or production casing is cemented in;
6. If an ALTERNATE II COMPLETION, production pipe shall be cemented from below any usable water to surface within **120 DAYS** of spud date. Or pursuant to Appendix "B" - Eastern Kansas surface casing order #133,891-C, which applies to the KCC District 3 area, alternate II cementing must be completed within 30 days of the spud date or the well shall be plugged. **In all cases, NOTIFY district office** prior to any cementing.

I hereby certify that the statements made herein are true and to the best of my knowledge and belief.

Date: 5-16-2012 Signature of Operator or Agent: Terry W. Piesker Title: Expl. & Prod. Man.

For KCC Use ONLY
API # 15 - 051-30256-00-01
Conductor pipe required None feet
Minimum surface pipe required 145 feet per ALT. I II
Approved by: SB 5-25-2012
This authorization expires: 5-25-2013
(This authorization void if drilling not started within 12 months of approval date.)
Spud date: _____ Agent: _____

- Remember to:
- File Certification of Compliance with the Kansas Surface Owner Notification Act (KSONA-1) with Intent to Drill;
 - File Drill Pit Application (form CDP-1) with Intent to Drill;
 - File Completion Form ACO-1 within 120 days of spud date;
 - File acreage attribution plat according to field proration orders;
 - Notify appropriate district office 48 hours prior to workover or re-entry;
 - Submit plugging report (CP-4) after plugging is completed (within 60 days);
 - Obtain written approval before disposing or injecting salt water.
 - If well will not be drilled or permit has expired (See: authorized expiration date) please check the box below and return to the address below.
- Well will not be drilled or Permit Expired Date: _____
Signature of Operator or Agent: _____

Mail to: KCC - Conservation Division,
130 S. Market - Room 2078, Wichita, Kansas 67202

RECEIVED
MAY 17 2012
KCC WICHITA

6
13
17
 E
 W

For KCC Use ONLY

API # 15 - 051-30256-0001

IN ALL CASES PLOT THE INTENDED WELL ON THE PLAT BELOW

In all cases, please fully complete this side of the form. Include items 1 through 5 at the bottom of this page.

Operator: Dreiling Oil, Inc.
Lease: Staab "A"
Well Number: 4
Field: _____

Number of Acres attributable to well: _____
QTR/QTR/QTR/QTR of acreage: _____ - W/2 - NE - SW

Location of Well: County: Ellis
1,980 _____ feet from N / S Line of Section
1,650 _____ feet from E / W Line of Section
Sec. 6 Twp. 13 S. R. 17 E W

Is Section: Regular or Irregular

If Section is Irregular, locate well from nearest corner boundary.

Section corner used: NE NW SE SW

PLAT

Show location of the well. Show footage to the nearest lease or unit boundary line. Show the predicted locations of lease roads, tank batteries, pipelines and electrical lines, as required by the Kansas Surface Owner Notice Act (House Bill 2032). You may attach a separate plat if desired.

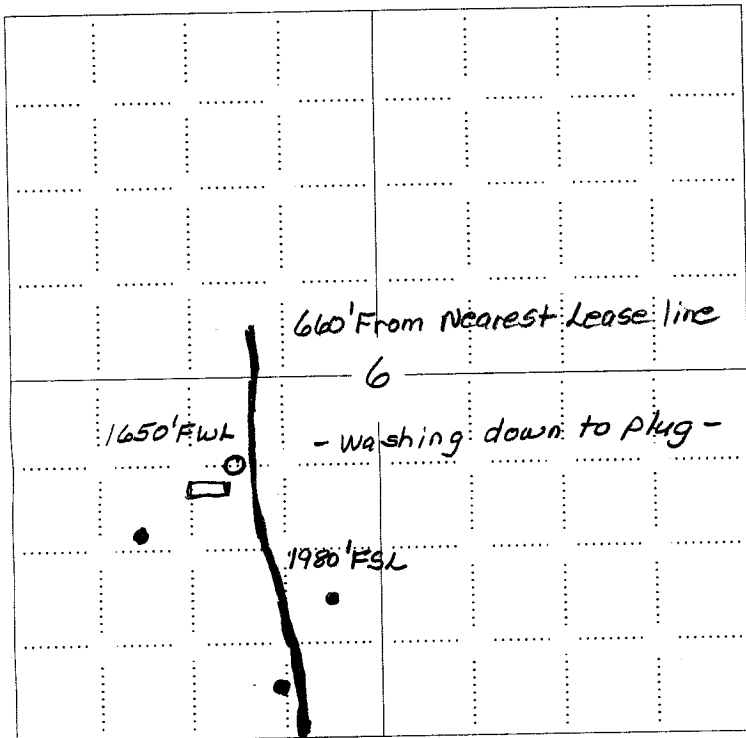

LEGEND

- Well Location
- Tank Battery Location
- Pipeline Location
- Electric Line Location
- Lease Road Location

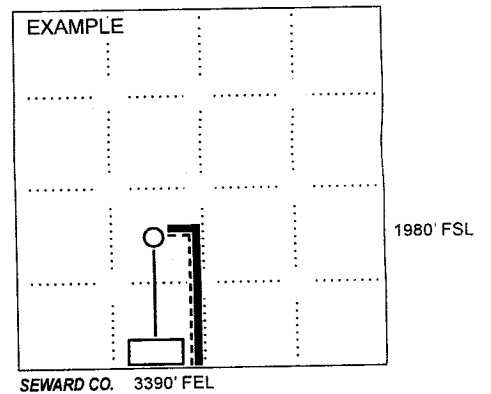

NOTE: In all cases locate the spot of the proposed drilling location.

In plotting the proposed location of the well, you must show:

1. The manner in which you are using the depicted plat by identifying section lines, i.e. 1 section, 1 section with 8 surrounding sections, 4 sections, etc.
2. The distance of the proposed drilling location from the south / north and east / west outside section lines.
3. The distance to the nearest lease or unit boundary line (in footage).
4. If proposed location is located within a prorated or spaced field a certificate of acreage attribution plat must be attached: (C0-7 for oil wells; CG-8 for gas wells).
5. The predicted locations of lease roads, tank batteries, pipelines, and electrical lines.

RECEIVED
MAY 17 2012

KCC WICHITA

KANSAS CORPORATION COMMISSION
OIL & GAS CONSERVATION DIVISION

Form KSONA-1
July 2010
Form Must Be Typed
Form must be Signed
All blanks must be Filled

**CERTIFICATION OF COMPLIANCE WITH THE
KANSAS SURFACE OWNER NOTIFICATION ACT**

15-051-30256-0001

This form must be submitted with all Forms C-1 (Notice of Intent to Drill); CB-1 (Cathodic Protection Borehole Intent); T-1 (Request for Change of Operator Transfer of Injection or Surface Pit Permit); and CP-1 (Well Plugging Application). Any such form submitted without an accompanying Form KSONA-1 will be returned.

Select the corresponding form being filed: C-1 (Intent) CB-1 (Cathodic Protection Borehole Intent) T-1 (Transfer) CP-1 (Plugging Application)

OPERATOR: License # 5145
Name: Dreiling Oil, Inc.
Address 1: P.O. Box 550
Address 2: _____
City: Hays State: Ks. Zip: 67601 + 0550
Contact Person: Terry W. Piesker
Phone: (785) 625-8327 Fax: (785) 625-8378
Email Address: tpiesker@eaglecom.net

Well Location:
W/2 NE SW Sec. 6 Twp. 13 S. R. 17 East West
County: Ellis
Lease Name: Staab "A" Well #: 4

If filing a Form T-1 for multiple wells on a lease, enter the legal description of the lease below:

Surface Owner Information:

Name: Marion Staab.
Address 1: 1101 Cody Avenue
Address 2: _____
City: Hay State: Ks. Zip: 67601 + _____

When filing a Form T-1 involving multiple surface owners, attach an additional sheet listing all of the information to the left for each surface owner. Surface owner information can be found in the records of the register of deeds for the county, and in the real estate property tax records of the county treasurer.

If this form is being submitted with a Form C-1 (Intent) or CB-1 (Cathodic Protection Borehole Intent), you must supply the surface owners and the KCC with a plat showing the predicted locations of lease roads, tank batteries, pipelines, and electrical lines. The locations shown on the plat are preliminary non-binding estimates. The locations may be entered on the Form C-1 plat, Form CB-1 plat, or a separate plat may be submitted.

Select one of the following:

I certify that, pursuant to the Kansas Surface Owner Notice Act (House Bill 2032), I have provided the following to the surface owner(s) of the land upon which the subject well is or will be located: 1) a copy of the Form C-1, Form CB-1, Form T-1, or Form CP-1 that I am filing in connection with this form; 2) if the form being filed is a Form C-1 or Form CB-1, the plat(s) required by this form; and 3) my operator name, address, phone number, fax, and email address.

I have not provided this information to the surface owner(s). I acknowledge that, because I have not provided this information, the KCC will be required to send this information to the surface owner(s). To mitigate the additional cost of the KCC performing this task, I acknowledge that I am being charged a \$30.00 handling fee, payable to the KCC, which is enclosed with this form.

If choosing the second option, submit payment of the \$30.00 handling fee with this form. If the fee is not received with this form, the KSONA-1 form and the associated Form C-1, Form CB-1, Form T-1, or Form CP-1 will be returned.

I hereby certify that the statements made herein are true and correct to the best of my knowledge and belief.

Date: 5-16-2012 Signature of Operator or Agent: Terry W. Piesker Title: Explor & Prod. Man.

STATE OF KANSAS
STATE CORPORATION COMMISSION

Give All Information Completely
Make Required Affidavit
Mail or Deliver Report to:
Conservation Division
State Corporation Commission
211 No. Broadway
Wichita, Kansas

WELL PLUGGING RECORD

15-051-30256 0000

Ellis County, Sec. 6 Twp. 13 Rge. 17 (E) W (W)

Location as "NE/CNW&SW¼" or footage from lines C-W 1/2 - NE-SW
Lease Owner Leo J. Dreiling Oil Company
Lease Name Staab A Well No. #11
Office Address Victoria, Kansas
Character of Well (completed as Oil, Gas or Dry Hole) D & A
Date well completed 2-12- 19 66
Application for plugging filed 2-12- 19 66
Application for plugging approved 2-12- 19 66
Plugging commenced 2-12- 19 66
Plugging completed 2-12- 19 66
Reason for abandonment of well or producing formation dry

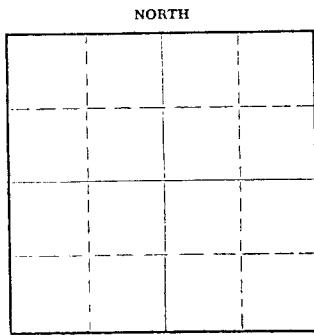

Locate well correctly on above
Section Plat

If a producing well is abandoned, date of last production _____ 19____
Was permission obtained from the Conservation Division or its agents before plugging was com-
menced? yes

Name of Conservation Agent who supervised plugging of this well Gib Leiker-Victoria, Kansas
Producing formation _____ Depth to top -0- Bottom -0- Total Depth of Well 3629 Feet
Show depth and thickness of all water, oil and gas formations.

OIL, GAS OR WATER RECORDS

CASING RECORD

FORMATION	CONTENT	FROM	TO	SIZE	PUT IN	PULLED OUT
SURFACE PIPE				8-5/8"	115'	

Describe in detail the manner in which the well was plugged, indicating where the mud fluid was placed and the method or methods used in introducing it into the hole. If cement or other plugs were used, state the character of same and depth placed, from _____ feet to _____ feet for each plug set.

Filled hole with rotary mud to a depth of 540' where 1st plug was set using 20 sacks cement. Filling hole with rotary mud to a depth of 140' where 2nd plug was set using 20 sks. cmt. Rotary mud was used to fill hole to a depth of 40' where 3rd plug was set using 10 sks cement and filling hole to surface.

RECEIVED
STATE CORP. COM. DIVISION

FEB 18 1966

(If additional description is necessary, use BACK of this sheet)

Name of Plugging Contractor L.J. Dreiling & Sons, Inc.
Address Victoria, Kansas

STATE OF Kansas, COUNTY OF Ellis, ss.
I, Leo F. Dreiling, a partner (owner or operator) of the above-described well, being first duly sworn on oath, says: That I have knowledge of the facts, statements, and matters herein contained and the log of the above-described well as filed and that the same are true and correct. So help me God.

(Signature) Leo F. Dreiling
Leo F. Dreiling Victoria, Kansas
(Address)

SUBSCRIBED AND SWORN TO before me this 15th day of February, 1966

My commission expires October 26, 1968

Elmer Weltz
Notary Public.

May 25, 2012

Dreiling Oil, Inc.
PO Box 550
Hays, KS 67601-0550

RE: Drilling Pit Application
Staab A Lease Well No. 4
SW/4 Sec. 06-13S-17W
Ellis County, Kansas

Dear Sir or Madam:

District staff has inspected the above referenced location and has determined that the reserve pit shall be constructed **without slots**, the bottom shall be flat and reasonably level, **and lined with bentonite or native clay**. The free fluids must be removed. The fluids are to be removed from the reserve pit as soon as practical after drilling operations have ceased.

If production casing is set all completion fluids shall be removed from the working pits daily. NO completion fluids or non-exempt wastes shall be placed in the reserve pit.

The fluids should be taken to an authorized disposal well. Please call the District Office at (785) 625-0550 when the fluids have been removed. Please file form CDP-5, Exploration and Production Waste Transfer, within 30 days of fluid removal. Conservation division forms are available through our office and on the KCC web site: www.kcc.state.ks.us/conservation/forms.

A copy of this letter should be posted in the doghouse along with the approved Intent to Drill. If you have any questions or concerns please feel free to contact the undersigned at the above address.

Sincerely,

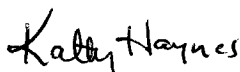

Kathy Haynes
Environmental Protection and Remediation Department

cc: district

**KANSAS CORPORATION COMMISSION
OIL & GAS CONSERVATION DIVISION
APPLICATION FOR SURFACE PIT**

Form CDP-1
May 2010
Form must be Typed

Submit in Duplicate

Operator Name: Dreiling Oil, Inc.		License Number: 5145
Operator Address: P.O. Box 550		Hays Ks. 67601
Contact Person: Terry W. Piesker		Phone Number: 785-625-8327
Lease Name & Well No.: Staab "A" 4		Pit Location (QQQQ): <u> W 2 NE - SW </u>
Type of Pit: <input type="checkbox"/> Emergency Pit <input type="checkbox"/> Burn Pit <input type="checkbox"/> Settling Pit <input checked="" type="checkbox"/> Drilling Pit <input type="checkbox"/> Workover Pit <input type="checkbox"/> Haul-Off Pit <small>(If WP Supply API No. or Year Drilled)</small>	Pit is: <input type="checkbox"/> Proposed <input type="checkbox"/> Existing If Existing, date constructed: _____ Pit capacity: 180 (bbls)	Sec. <u>6</u> Twp. <u>13</u> R. <u>17</u> <input type="checkbox"/> East <input checked="" type="checkbox"/> West <u>900</u> ¹⁹⁸⁰ Feet from <input checked="" type="checkbox"/> North / <input checked="" type="checkbox"/> South Line of Section <u>2,310</u> ¹⁶⁵⁰ Feet from <input checked="" type="checkbox"/> East / <input checked="" type="checkbox"/> West Line of Section Ellis County
Is the pit located in a Sensitive Ground Water Area? <input type="checkbox"/> Yes <input checked="" type="checkbox"/> No		Chloride concentration: _____ mg/l <small>(For Emergency Pits and Settling Pits only)</small>
Is the bottom below ground level? <input type="checkbox"/> Yes <input type="checkbox"/> No	Artificial Liner? <input type="checkbox"/> Yes <input type="checkbox"/> No	How is the pit lined if a plastic liner is not used? Native and fresh water mud
Pit dimensions (all but working pits): <u>10</u> Length (feet) <u>30</u> Width (feet) <input type="checkbox"/> N/A: Steel Pits Depth from ground level to deepest point: <u>5</u> (feet) <input type="checkbox"/> No Pit		
If the pit is lined give a brief description of the liner material, thickness and installation procedure.		Describe procedures for periodic maintenance and determining liner integrity, including any special monitoring.
Distance to nearest water well within one-mile of pit: <u>1000</u> feet Depth of water well <u>50</u> feet		Depth to shallowest fresh water <u>20</u> feet. Source of information: <input type="checkbox"/> measured <input type="checkbox"/> well owner <input checked="" type="checkbox"/> electric log <input type="checkbox"/> KDWR
Emergency, Settling and Burn Pits ONLY: Producing Formation: _____ Number of producing wells on lease: _____ Barrels of fluid produced daily: _____ Does the slope from the tank battery allow all spilled fluids to flow into the pit? <input type="checkbox"/> Yes <input type="checkbox"/> No		Drilling, Workover and Haul-Off Pits ONLY: Type of material utilized in drilling/workover: <u>Fresh water mud</u> Number of working pits to be utilized: <u>3</u> Abandonment procedure: <u>Evaporation and backfill</u> Drill pits must be closed within 365 days of spud date.
I hereby certify that the above statements are true and correct to the best of my knowledge and belief.		
<u>5-16-2012</u> Date	<u>Terry W. Piesker</u> Signature of Applicant or Agent	RECEIVED MAY 17 2012 KCC WICHITA

15-051-30256-00-01

* Public water supply <u>1-13-18W NE/4</u>	KCC OFFICE USE ONLY	<input checked="" type="checkbox"/> Liner <input type="checkbox"/> Steel Pit <input checked="" type="checkbox"/> RFAC <input type="checkbox"/> RFAS
Date Received: <u>5-17-12</u> Permit Number: _____	Permit Date: <u>5-25-12</u> Lease Inspection: <input checked="" type="checkbox"/> Yes <input type="checkbox"/> No	

Mail to: KCC - Conservation Division, 130 S. Market - Room 2078, Wichita, Kansas 67202