

EFFECTIVE DATE: 10-3-95  
DISTRICT # 1  
SGA? ... Yes  No

State of Kansas  
NOTICE OF INTENTION TO DRILL

FORM MUST BE TYPED  
FORM MUST BE SIGNED  
ALL BLANKS MUST BE FILLED

Must be approved by the K.C.C. five (5) days prior to commencing well.

Expected Spud Date 10 1 95  
month day year

Spot NW NE SW Sec 5 Twp 16 S, Rg 27 East West XX

OPERATOR: License # 5015  
Name: Helljar Drilling Co., Inc.  
Address: 125 N. Market #1422  
City/State/Zip: Wichita, KS, 67202  
Contact Person: Don Helljar  
Phone: (316) 267-2845

CONTRACTOR: License #: 30684  
Name: Abercrombie RTD, Inc.

Well Drilled For:	Well Class:	Type Equipment:
<input checked="" type="checkbox"/> Oil	<input type="checkbox"/> Enh Rec	<input type="checkbox"/> Infield
<input type="checkbox"/> Gas	<input type="checkbox"/> Storage	<input checked="" type="checkbox"/> Pool Ext.
<input type="checkbox"/> OWWO	<input type="checkbox"/> Disposal	<input type="checkbox"/> Wildcat
<input type="checkbox"/> Seismic	<input type="checkbox"/> # of Holes	<input type="checkbox"/> Other
<input type="checkbox"/> Other		

If OWWO: old well information as follows:  
Operator: \_\_\_\_\_  
Well Name: \_\_\_\_\_  
Comp. Date: \_\_\_\_\_ Old Total Depth \_\_\_\_\_

Directional, Deviated or Horizontal wellbore? .... yes  no  
If yes, true vertical depth: \_\_\_\_\_  
Bottom Hole Location: \_\_\_\_\_

... 2310! ..... feet from South / North line of Section  
... 1650! ..... feet from East West line of Section  
IS SECTION XX REGULAR \_\_\_\_\_ IRREGULAR?  
(NOTE: Locate well on the Section Plat on Reverse Side)  
County: Lane  
Lease Name: CHRISTIAN CHURCH Well #: 3  
Field Name: \_\_\_\_\_  
Is this a Prorated/Spaced Field? .... yes  no  
Target Formation(s): LKC  
Nearest lease or unit boundary: 330'  
Ground Surface Elevation: Unknown feet MSL  
Water well within one-quarter mile: .... yes  no  
Public water supply well within one mile: .... yes  no  
Depth to bottom of fresh water: 140' 180'  
Depth to bottom of usable water: 1100'  
Surface Pipe by Alternate: .... 1  2  
Length of Surface Pipe Planned to be set: 230'  
Length of Conductor pipe required: 0'  
Projected Total Depth: 4450'  
Formation at Total Depth: MISSISSIPPI  
Water Source for Drilling Operations:  
... well .... farm pond  other

Will Cores Be Taken?: .... yes  no  
If yes, proposed zone: \_\_\_\_\_

AFFIDAVIT

The undersigned hereby affirms that the drilling, completion and eventual plugging of this well will comply with K.S.A. 55-101 et. seq.

It is agreed that the following minimum requirements will be met:

1. Notify the appropriate district office prior to spudding of well;
2. A copy of the approved notice of intent to drill shall be posted on each drilling rig;
3. The minimum amount of surface pipe as specified below shall be set by circulating cement to the top; in all cases surface pipe shall be set through all unconsolidated materials plus a minimum of 20 feet into the underlying formation;
4. If the well is dry hole, an agreement between the operator and the district office on plug length and placement is necessary prior to plugging;
5. The appropriate district office will be notified before well is either plugged or production casing is cemented in;
6. IF AN ALTERNATE II COMPLETION, PRODUCTION PIPE SHALL BE CEMENTED FROM BELOW ANY USABLE WATER TO SURFACE WITHIN 120 DAYS OF SPUD DATE. IN ALL CASES, NOTIFY DISTRICT OFFICE PRIOR TO ANY CEMENTING.

I hereby certify that the statements made herein are true and to the best of my knowledge and belief.

Date: 9-27-95 Signature of Operator or Agent: Mark R. Galvan Title: Mark R. Galvan, Vice President

FOR KCC USE:
API # 15- <u>101-217130000</u>
Conductor pipe required <u>NONE</u> feet
Minimum surface pipe required <u>200'</u> feet per Alt. <input checked="" type="checkbox"/> (2)
Approved by: <u>JK 9-28-95</u>
This authorization expires: <u>3-28-96</u>
(This authorization void if drilling not started within 6 months of effective date.)
Spud date: _____ Agent: _____

RECEIVED  
STATE CORPORATION COMMISSION  
SEP 28 1995  
09-28-1995  
CONSERVATION DIVISION  
Wichita, Kansas

REMEMBER TO:

- File Drill Pit Application (form CDP-1) with Intent to Drill;
- File Completion Form ACO-1 within 120 days of spud date;
- File acreage attribution plat according to field proration orders;
- Notify appropriate district office 48 hours prior to workover or re-entry;
- Submit plugging report (CP-4) after plugging is completed;
- Obtain written approval before disposing or injecting salt water.

Mail to: KCC - Conservation Division, 130 S. Market - Room 2078, Wichita, Kansas 67202.

2702

**IN ALL CASES PLOT THE INTENDED WELL ON THE PLAT BELOW**

**PLAT OF ACREAGE ATTRIBUTABLE TO A WELL IN A PRORATED OR SPACED FIELD**

If the intended well is in a prorated or spaced field, please fully complete this side of the form. If the intended well is in a prorated or spaced field complete the plat below showing that the well will be properly located in relationship to other wells producing from the common source of supply. Please show all the wells within 1 mile of the boundaries of the proposed acreage attribution unit for gas wells and within 1/2 mile of the boundaries of the proposed acreage attribution unit for oil wells.

API NO. 15- \_\_\_\_\_

OPERATOR \_\_\_\_\_ LOCATION OF WELL: COUNTY \_\_\_\_\_

LEASE \_\_\_\_\_ feet from south/north line of section

WELL NUMBER \_\_\_\_\_ feet from east/west line of section

FIELD \_\_\_\_\_ SECTION \_\_\_\_\_ TWP \_\_\_\_\_ RG \_\_\_\_\_

NUMBER OF ACRES ATTRIBUTABLE TO WELL \_\_\_\_\_ IS SECTION \_\_\_\_\_ REGULAR OR \_\_\_\_\_ IRREGULAR

QTR/QTR/QTR OF ACREAGE \_\_\_\_\_ **IF SECTION IS IRREGULAR, LOCATE WELL FROM NEAREST CORNER BOUNDARY.**

Section corner used: \_\_\_\_\_ NE \_\_\_\_\_ NW \_\_\_\_\_ SE \_\_\_\_\_ SW

**PLAT**

(Show location of the well and shade attributable acreage for prorated or spaced wells.)  
 (Show footage to the nearest lease or unit boundary line.)

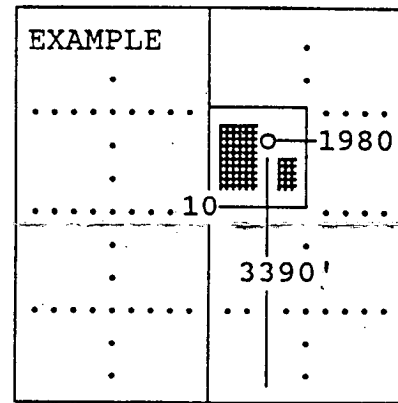
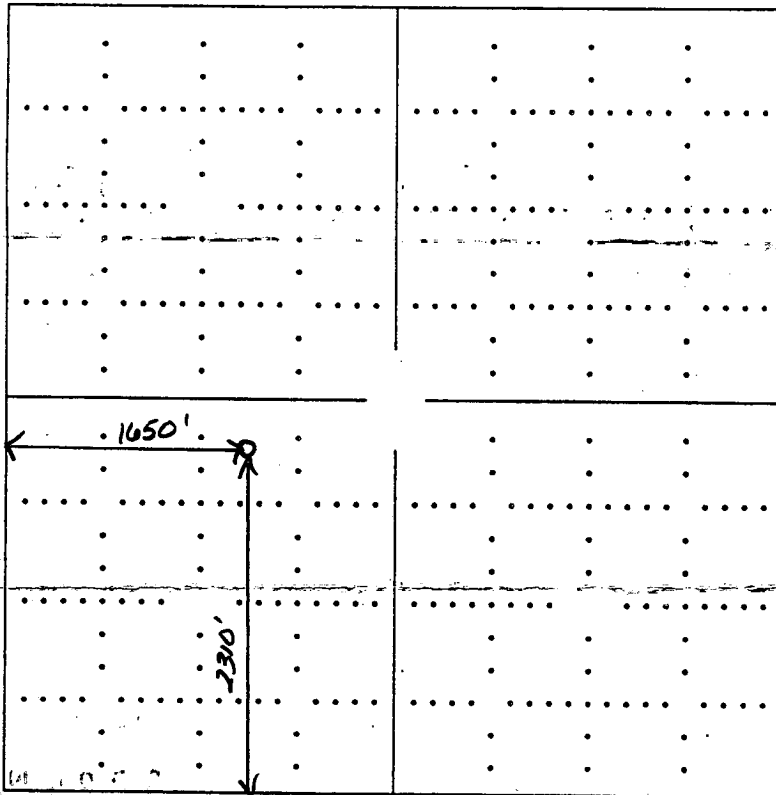

SEWARD CO.

**In plotting the proposed location of the well, you must show:**

- 1) The manner in which you are using the depicted plat by identifying section lines, i.e. 1 section, 1 section with 8 surrounding sections, 4 sections, etc.;
- 2) the distance of the proposed drilling location from the section's south/north and east/west; and
- 3) the distance to the nearest lease or unit boundary line.