

FOR KCC USE:

EFFECTIVE DATE: 3-13-95

DISTRICT #

SEAT: Yes No

State of Kansas

NOTICE OF INTENTION TO DRILL

Must be approved by the K.C.C. five (5) days prior to commencing well

FORM C-1 7/9

FORM MUST BE TYPE

FORM MUST BE SIGNED

ALL BLANKS MUST BE FILLED

Expected Spud Date March 15, 1995 100' W Spot 75' N N 1/2 S 1/2 SE Sec 31, Twp 16, S, Rg 27. — East
month day year

OPERATOR: License # ... 30870176 - Reynolds Rexwinkle Oil, Inc. I
Name: .. Reynolds Rexwinkle Oil, Inc. ..
Address: .. 212 N. Market #402 ..
City/State/Zip: ... Wichita, Kansas ..
Contact Person: Dan Reynolds ..
Phone: ... 316-269-1233 ..

..... 1065 feet from South / XXXX line of Section
..... 1420 feet from East / XXXX line of Section
IS SECTION X REGULAR _____ IRREGULAR?

(NOTE: Locate well on the Section Plat on Reverse Side)

County: Lane ..
Lease Name: ... Munsell Well #: .. 1 ..
Field Name: Wildcat ..

Is this a Prorated/Spaced Field? yes .. X .. no

Target Formation(s): Mississippi ..

Nearest lease or unit boundary: 1065 ..

Ground Surface Elevation: ... 2700 feet MSL

Water well within one-quarter mile: yes .. X .. no

Public water supply well within one mile: yes .. X .. no

Depth to bottom of fresh water: 250-100 ..

Depth to bottom of usable water: 100-1250 ..

Surface Pipe by Alternate: 1 .. X .. 2

Length of Surface Pipe Planned to be set: 250 ..

Length of Conductor pipe required: none ..

Projected Total Depth: ... 4700 ..

Formation at Total Depth: .. Mississippi ..

Water Source for Drilling Operations:
..... well .. X .. farm pond other

DWR Permit #: ..

Will Cores Be Taken?: yes .. X .. no

If yes, proposed zone: ..

CONTRACTOR: License #: 4958 ..
Name: Mallard JV, Inc. ..

Well Drilled For:	Well Class:	Type Equipment:
<input checked="" type="checkbox"/> Oil ... Enh Rec	... Infield	<input checked="" type="checkbox"/> Mud Rotary
... Gas ... Storage	... Pool Ext.	... Air Rotary
... OWD ... Disposal	<input checked="" type="checkbox"/> Wildcat	... Cable
... Seismic: ... # of Holes	... Other	
... Other		

If OWD: old well information as follows:
Operator: ..
Well Name: ..
Comp. Date: Old Total Depth ..

Directional, Deviated or Horizontal wellbore? yes .. X .. no

If yes, true vertical depth: ..

Bottom Hole Location: ..

AFFIDAVIT

RECEIVED
KANSAS CORPORATION COMMISSION

MAR 08 1995

03-08-1995
CONSERVATION DIVISION
WICHITA, KS

The undersigned hereby affirms that the drilling, completion and eventual plugging of this well will comply with K.S.A. 55-101, et. seq.

- It is agreed that the following minimum requirements will be met:
1. Notify the appropriate district office prior to spudding of well;
 2. A copy of the approved notice of intent to drill shall be posted on each drilling rig;
 3. The minimum amount of surface pipe as specified below shall be set by circulating cement to the top; in all cases surface pipe shall be set through all unconsolidated materials plus a minimum of 20 feet into the underlying formation;
 4. If the well is dry hole, an agreement between the operator and the district office on plug length and placement is necessary prior to plugging;
 5. The appropriate district office will be notified before well is either plugged or production casing is cemented in;
 6. IF AN ALTERNATE II COMPLETION, PRODUCTION PIPE SHALL BE CEMENTED FROM BELOW ANY USABLE WATER TO SURFACE WITHIN 120 DAYS OF SPUD DATE. IN ALL CASES, NOTIFY DISTRICT OFFICE PRIOR TO ANY CEMENTING.

I hereby certify that the statements made herein are true and to the best of my knowledge and belief.
Date: March 7, 1995 Signature of Operator or Agent: Dan Reynolds Title: Vice President

FOR KCC USE:
API # 15- 101-21698-0000
Conductor pipe required _____ feet
Minimum surface pipe required 200 feet per Alt. X(2)
Approved by: Dan Reynolds
This authorization expires: 9-8-95
(This authorization void if drilling not started within 6 months of effective date.)
Spud date: _____ Agent: _____

REMEMBER TO:

- File Drill Pit Application (form COP-1) with Intent to Drill;
- File Completion Form ACO-1 within 120 days of spud date;
- File acreage attribution plat according to field proration orders;
- Notify appropriate district office 48 hours prior to workover or re-entry;
- Submit plugging report (CP-4) after plugging is completed;
- Obtain written approval before disposing or injecting salt water.

Mail to: Conservation Division, 200 Colorado Derby Building, 202 W. First St., Wichita, Kansas 67202-1286.

31
16
27

IN ALL CASES PLOT THE INTENDED WELL ON THE PLAT BELOW

PLAT OF ACREAGE ATTRIBUTABLE TO A WELL IN A PRORATED OR SPACED FIELD

If the intended well is in a prorated or spaced field, please fully complete this side of the form. If the intended well is in a prorated or spaced field complete the plat below showing that the well will be properly located in relationship to other wells producing from the common source of supply. Please show all the wells within 1 mile of the boundaries of the proposed acreage attribution unit for gas wells and within 1/2 mile of the boundaries of the proposed acreage attribution unit for oil wells.

API NO. 15- _____
 OPERATOR _____
 LEASE _____
 WELL NUMBER _____
 FIELD _____

LOCATION OF WELL: COUNTY _____
 _____ feet from south/north line of section
 _____ feet from east/west line of section
 SECTION _____ TWP _____ RG _____

NUMBER OF ACRES ATTRIBUTABLE TO WELL _____
 QTR/QTR/QTR OF ACREAGE _____

IS SECTION _____ REGULAR or _____ IRREGULAR
IF SECTION IS IRREGULAR, LOCATE WELL FROM NEAREST CORNER BOUNDARY.

Section corner used: _____ NE _____ NW _____ SE _____ SW
PLAT

(Show location of the well and shade attributable acreage for prorated or spaced wells.)
 (Show footage to the nearest lease or unit boundary line.)

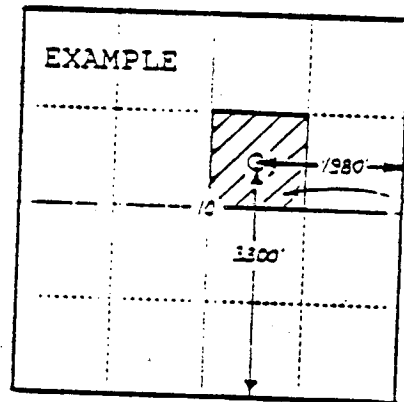
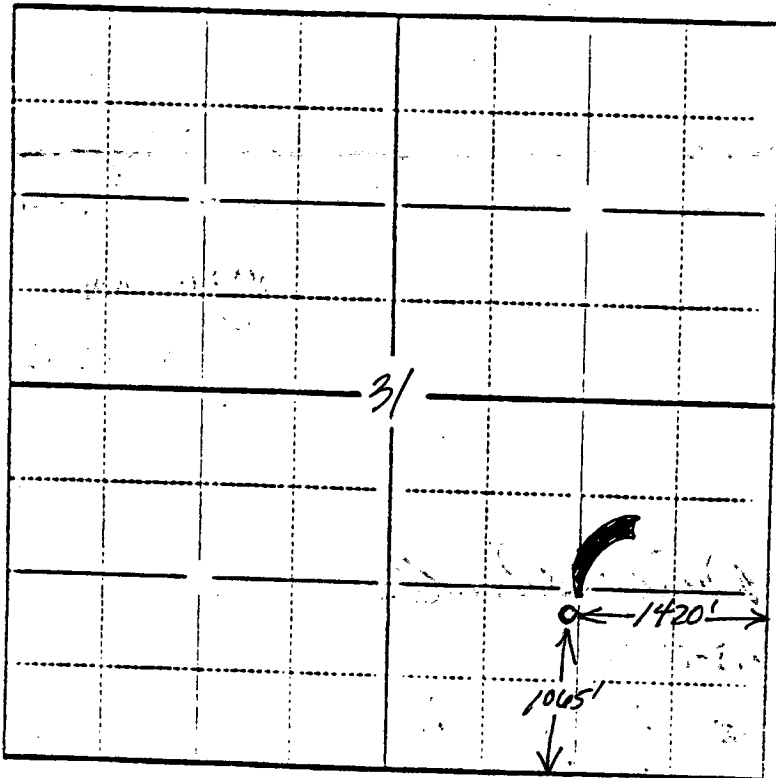

In plotting the proposed location of the well, you must show:

- 1) The manner in which you are using the depicted plat by identifying section lines, i.e. 1 section, 1 section with 8 surrounding sections, 4 sections, etc.,
- 2) the distance of the proposed drilling location from the section's south/north and east/west lines; and
- 3) the distance to the nearest lease or unit boundary line.