

FOR KCC USE:

FORM C-1 7/91

EFFECTIVE DATE: 9-17-96

FORM MUST BE TYPED

DISTRICT # SGAT Yes X No

State of Kansas

FORM MUST BE SIGNED

NOTICE OF INTENTION TO DRILL

ALL BLANKS MUST BE FILLED

Must be approved by the K.C.C. five (5) days prior to commencing well

Expected Spud Date October 14 1996

Spot NE SE SE Sec 18 Twp 16 S, Rg 27 East

OPERATOR: License # 6039 Name: L. D. Drilling, Inc./Rheem Resources, Inc. Address: R.R. 1 Box 183 B City/State/Zip: Great Bend, Kansas 67530 Contact Person: L. D. Davis Phone: (316) 793-3051

990 feet from South/North line of Section 330 feet from East/West line of Section IS SECTION X REGULAR INREGULAR

(NOTE: Locate well on the Section Plat on Reverse Side)

CONTRACTOR: License # 6039 Name: L. D. DRILLING INC.

County: Lane Lease Name: Ewing Well #: #1 AAA Field Name: Is this a Prorated/Spaced Field? yes X no Target Formation(s): Lansing-Kansas City Nearest lease or unit boundary: 330 Ground Surface Elevation: Est. 2684' Water well within one-quarter mile: yes X no Public water supply well within one mile: yes X no Depth to bottom of fresh water: 220-180 Depth to bottom of usable water: 1360 Surface Pipe by Alternate: 1 X 2 Length of Surface Pipe Planned to be set: 300 Length of Conductor pipe required: none Projected Total Depth: 4600 Formation at Total Depth: Mississippian Water Source for Drilling Operations: well Farm pond X other DWR Permit #: Will Cores Be Taken?: If yes, proposed zone:

Well Drilled For: Well Class: Type Equipment: X Oil Enh Rec Infield X Mud Rotary Gas Storage Pool Ext Air Rotary OMDW Disposal Wildcat Cable Seismic: # of Holes Other If OMDW, old well information as follows: Operator: Well Name: Comp. Date: Old Total Depth

Directional, Deviated or Horizontal wellbore? yes X no If yes, true vertical depth: Bottom Hole Location:

AFFIDAVIT

The undersigned hereby affirms that the drilling, completion and eventual plugging of this well will comply with K.S.A. 55-101, et. seq. It is agreed that the following minimum requirements will be met:

RECEIVED KANSAS CORP OMM 09-12-1996

- 1. Notify the appropriate district office prior to spudding of well;
2. A copy of the approved notice of intent to drill shall be posted on each drilling rig;
3. The minimum amount of surface pipe as specified below shall be set by circulating cement to the top; in all cases surface pipe shall be set through all unconsolidated materials plus a minimum of 20 feet into the underlying formation;
4. If the well is dry hole, an agreement between the operator and the district office on plug length and placement is necessary prior to plugging;
5. The appropriate district office will be notified before well is either plugged or production casing is cemented in;
6. IF AN ALTERNATE II COMPLETION, PRODUCTION PIPE SHALL BE CEMENTED FROM BELOW ANY USABLE WATER TO SURFACE WITHIN 120 DAYS OF SPUD DATE. IN ALL CASES, NOTIFY DISTRICT OFFICE PRIOR TO ANY CEMENTING.

I hereby certify that the statements made herein are true and to the best of my knowledge and belief. Date: 9-11-96 Signature of Operator or Agent: Bessie DeWorff Title: Sec/Treas

FOR KCC USE: API # 15- 101-217280000 Conductor pipe required NONE feet Minimum surface pipe required 300 feet per Alt. X (2) Approved by: X 9-12-96 This authorization expires: 3-12-97 (This authorization void if drilling not started within 6 months of effective date.) Spud date: Agent:

REMEMBER TO:

- File Drill Pit Application (form COP-1) with Intent to Drill;
- File Completion form ACO-1 within 120 days of spud date;
- File acreage attribution plat according to field proration orders;
- Notify appropriate district office 48 hours prior to workover or re-entry;
- Submit plugging report (CP-4) after plugging is completed;
- Obtain written approval before disposing or injecting salt water.

Mail to: Conservation Division, 200 Colorado Derby Building, 202 W. First St., Wichita, Kansas 67202-1286.

18 16 27W

IN ALL CASES PLOT THE INTENDED WELL ON THE PLAT BELOW

PLAT OF ACREAGE ATTRIBUTABLE TO A WELL IN A PRORATED OR SPACED FIELD

If the intended well is in a prorated or spaced field, please fully complete this side of the form. If the intended well is in a prorated or spaced field complete the plat below showing that the well will be properly located in relationship to other wells producing from the common source of supply. Please show all the wells within 1 mile of the boundaries of the proposed acreage attribution unit for gas wells and within 1/2 mile of the boundaries of the proposed acreage attribution unit for oil wells.

API NO. 15- \_\_\_\_\_  
 OPERATOR \_\_\_\_\_  
 LEASE \_\_\_\_\_  
 WELL NUMBER \_\_\_\_\_  
 FIELD \_\_\_\_\_

LOCATION OF WELL: COUNTY \_\_\_\_\_ Lane \_\_\_\_\_  
 \_\_\_\_\_ 990 feet from south/north line of section  
 \_\_\_\_\_ 330 feet from east/west line of section  
 SECTION 18 TWP 16 S RC 27 W

NUMBER OF ACRES ATTRIBUTABLE TO WELL 10  
 QTR/QTR/QTR OF ACREAGE NE - SE - SE

IS SECTION X REGULAR or IRREGULAR  
 IF SECTION IS IRREGULAR, LOCATE WELL FROM NEAREST  
 CORNER BOUNDARY.  
 Section corner used: NE NW X SE SW

PLAT

(Show location of the well and shade attributable acreage for prorated or spaced wells.)  
 (Show footage to the nearest lease or unit boundary line.)

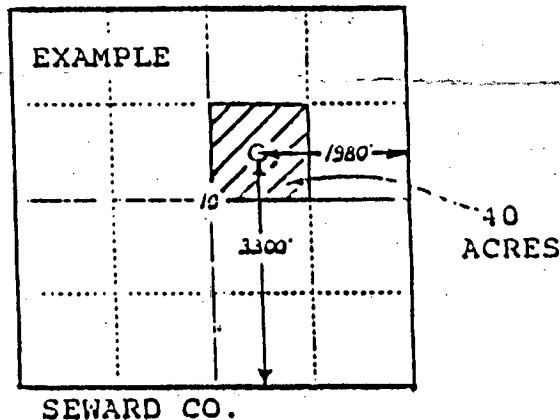
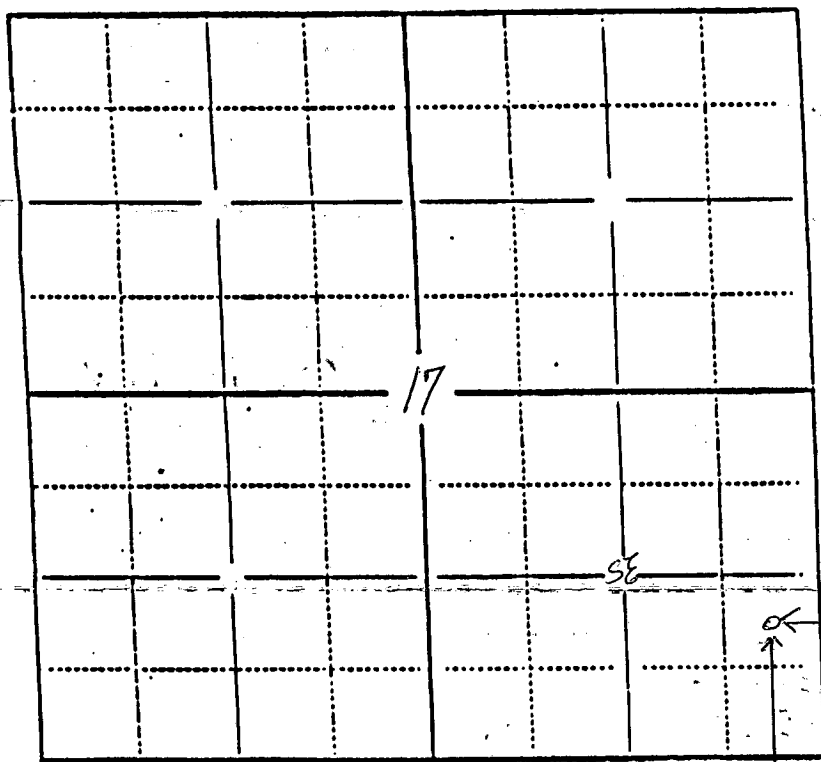

In plotting the proposed location of the well, you must show:

- 1) The manner in which you are using the depicted plat by identifying section lines, i.e. 1 section, 1 section with 8 surrounding sections, 4 sections, etc.;
- 2) the distance of the proposed drilling location from the section's south/north and east/west lines; and
- 3) the distance to the nearest lease or unit boundary line.