

FOR KCC USE:

EFFECTIVE DATE: 3-29-95  
DISTRICT # 4  
SGA? Yes No

State of Kansas

NOTICE OF INTENTION TO DRILL

Must be approved by the K.C.C. five (5) days prior to commencing well.

LANG #1 OWWD

C SW NE--Originally turned in as this

owwd FORM C-1 7/91

FORM MUST BE TYPED

FORM MUST BE SIGNED

ALL BLANKS MUST BE FILLED

Expected Spud Date April 11 1995  
month day year

Spot 1980' FNL 2100' FEL  
..... NE/4Sec .9.. Twp ..16 S, Rg ..27. X East

OPERATOR: License # 6039  
Name: L. D. Drilling, Inc.  
Address: R.R. 1 Box 183 B  
City/State/Zip: Great Bend, Kansas 67530  
Contact Person: L. D. Davis  
Phone: (316) 793-3051

..... 1980' feet from South North line of Section  
..... 2100' feet from East / West line of Section  
IS SECTION X REGULAR IRREGULAR?

(NOTE: Locate well on the Section Plat on Reverse Side)  
County: Lane  
Lease Name: LANG Well #: 1 OWWD

CONTRACTOR: License # 6039  
Name: L. D. DRILLING, INC. (Company Tools)

Field Name: .....  
Is this a Prorated/Spaced Field? .... yes ..X.. no

Well Drilled For: Well Class: Type Equipment:  
..X Oil ... Enh Rec ... Infield ..X Mud Rotary  
... Gas ... Storage ..X Pool Ext. ... Air Rotary  
..X OWWO ... Disposal ... Wildcat ... Cable  
... Seismic; ... # of Holes ... Other  
... Other .....

Target Formation(s): Mississippian  
Nearest lease or unit boundary: ..... 540' ✓

If OWWD: old well information as follows:  
Operator: Donald G. Slawson  
Well Name: Lang "0" #1  
Comp. Date: 12-17-84 Old Total Depth 4625'

Ground Surface Elevation: 2663' feet MSL  
Water well within one-quarter mile: .... yes ..X no

Directional, Deviated or Horizontal wellbore? .... yes ..X no  
If yes, true vertical depth: .....  
Bottom Hole Location: .....

Public water supply well within one mile: .... yes ..X no  
Depth to bottom of fresh water: ..... 180'  
Depth to bottom of usable water: ..... 1280' 1320'

AFFIDAVIT

The undersigned hereby affirms that the drilling, completion and eventual plugging of this well will comply with K.S.A. 55-1101 et. seq.  
It is agreed that the following minimum requirements will be met:

STATE COMMISSION RECEIVED  
MAR 24 1995  
03-24-1995  
CONSERVATION DIVISION

1. Notify the appropriate district office prior to spudding of well;
2. A copy of the approved notice of intent to drill shall be posted on each drilling rig;
3. The minimum amount of surface pipe as specified below shall be set by circulating cement to the top; in all cases surface pipe shall be set through all unconsolidated materials plus a minimum of 20 feet into the underlying formation;
4. If the well is dry hole, an agreement between the operator and the district office on plug length and placement is necessary prior to plugging;
5. The appropriate district office will be notified before well is either plugged or production casing is cemented in;
6. IF AN ALTERNATE II COMPLETION, PRODUCTION PIPE SHALL BE CEMENTED FROM BELOW ANY USABLE WATER TO SURFACE WITHIN 120 DAYS OF SPUD DATE. IN ALL CASES, NOTIFY DISTRICT OFFICE PRIOR TO ANY CEMENTING.

I hereby certify that the statements made herein are true and to the best of my knowledge and belief.  
Date: 3-23-95 Signature of Operator or Agent: Bessie DeWerff Title: Sec/Treas

FOR KCC USE:  
API # 15- 101-21101-00-01  
Conductor pipe required NONE feet  
Minimum surface pipe required 777 feet per Alt. X(2)  
Approved by: DPW 3-24-95  
This authorization expires: 9-24-95  
(This authorization void if drilling not started within 6 months of effective date.)  
Spud date: \_\_\_\_\_ Agent: \_\_\_\_\_

REMEMBER TO:

- File Drill Pit Application (form CDP-1) with Intent to Drill;
- File Completion Form ACO-1 within 120 days of spud date;
- File acreage attribution plat according to field proration orders;
- Notify appropriate district office 48 hours prior to workover or re-entry;
- Submit plugging report (CP-4) after plugging is completed;
- Obtain written approval before disposing or injecting salt water.

Mail to: KCC - Conservation Division, 130 S. Market - Room 2078, Wichita, Kansas 67202.

9  
16  
220

**IN ALL CASES PLOT THE INTENDED WELL ON THE PLAT BELOW**

**PLAT OF ACREAGE ATTRIBUTABLE TO A WELL IN A PRORATED OR SPACED FIELD**

If the intended well is in a prorated or spaced field, please fully complete this side of the form. If the intended well is in a prorated or spaced field complete the plat below showing that the well will be properly located in relationship to other wells producing from the common source of supply. Please show all the wells within 1 mile of the boundaries of the proposed acreage attribution unit for gas wells and within 1/2 mile of the boundaries of the proposed acreage attribution unit for oil wells.

API NO. 15- \_\_\_\_\_  
 OPERATOR L. D. DRILLING, INC.  
 LEASE LANG OWWD  
 WELL NUMBER #1  
 FIELD \_\_\_\_\_

LOCATION OF WELL: COUNTY LANE  
1980 feet from south/~~north~~ line of section  
2100 feet from ~~east~~/west line of section  
 SECTION 9 TWP 16 RG 27

NUMBER OF ACRES ATTRIBUTABLE TO WELL 10  
 QTR/QTR/QTR OF ACREAGE C - SW - NE

IS SECTION X REGULAR or \_\_\_\_\_ IRREGULAR  
**IF SECTION IS IRREGULAR, LOCATE WELL FROM NEAREST CORNER BOUNDARY.**

Section corner used: \_\_\_\_\_ NE \_\_\_\_\_ NW \_\_\_\_\_ SE \_\_\_\_\_ SW

**PLAT**

(Show location of the well and shade attributable acreage for prorated or spaced wells.)  
 (Show footage to the nearest lease or unit boundary line.)

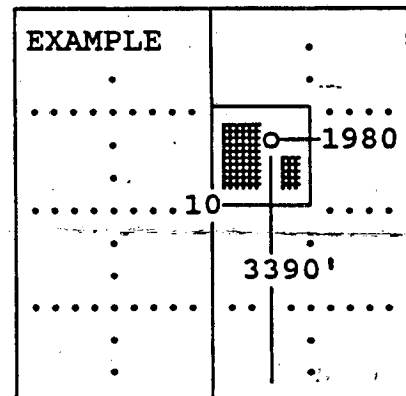
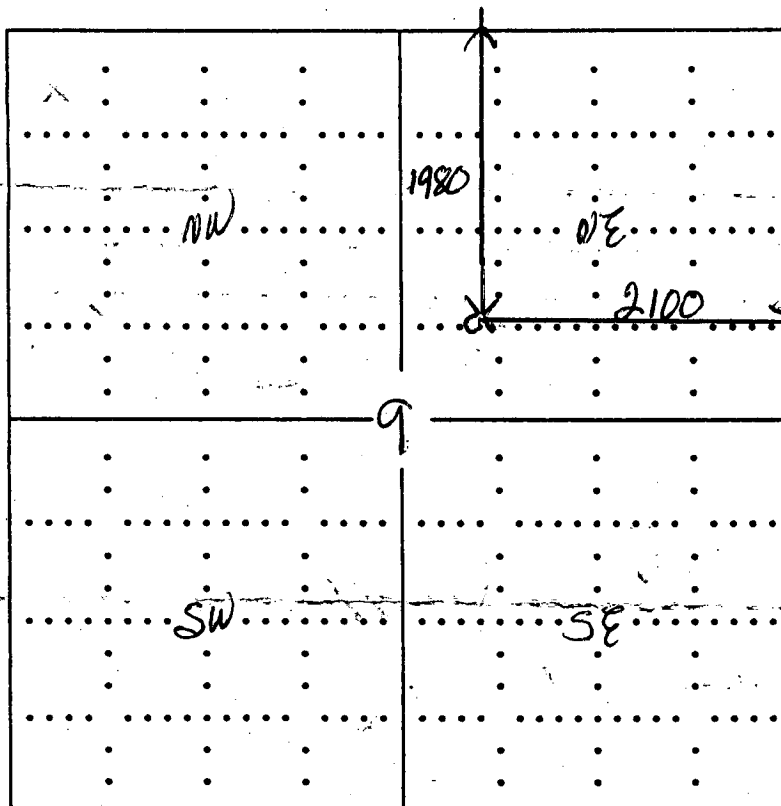

SEWARD CO.

**In plotting the proposed location of the well, you must show:**

- 1) The manner in which you are using the depicted plat by identifying section lines, i.e. 1 section, 1 section with 8 surrounding sections, 4 sections, etc.;
- 2) the distance of the proposed drilling location from the section's south/north and east/west; and
- 3) the distance to the nearest lease or unit boundary line.