

STATE OF KANSAS
KANSAS CORPORATION COMMISSION
CONSERVATION DIVISION
130 South Market - Room 2078
Wichita, Kansas 67202

FORM CP-1 (3/92)

WELL PLUGGING APPLICATION FORM
(PLEASE TYPE FORM and File ONE Copy)

API # 15-007-20679.00.00 (Identifier number of this well). This must be listed for wells drilled since 1967; if no API# was issued, indicate spud or completion date.

WELL OPERATOR A. L. Abercrombie Inc. KCC LICENSE # 5393
(owner/company name) (operator's)

ADDRESS Rt #1 Box 56 CITY Great Bend

STATE Kansas ZIP CODE 67530 CONTACT PHONE # (316) 793 8186

LEASE Simpson WELL# 1 SEC. 32 T. 31 R. 12 (~~East~~/West)

100' E C NE NE SPOT LOCATION/Q000 COUNTY Barber

4620 FEET (in exact footage) FROM S/N (circle one) LINE OF SECTION (NOT Lease Line)

560 FEET (in exact footage) FROM E/W (circle one) LINE OF SECTION (NOT Lease Line)

Check One: OIL WELL GAS WELL D&A SWD/ENHR WELL DOCKET# _____

CONDUCTOR CASING SIZE _____ SET AT _____ CEMENTED WITH _____ SACKS

SURFACE CASING SIZE 8-5/8 SET AT 467 CEMENTED WITH 350 SACKS

PRODUCTION CASING SIZE 4-1/2 SET AT 4283 CEMENTED WITH 175 bottom stage SACKS

LIST (ALL) PERFORATIONS and BRIDGEPLUG SETS: 4200-34 Prod pkr @ 4190 3920-24
DV tool @ 2835 W/ 150 sx

ELEVATION 1545/1553 T.D. 4285 PBDT 4252 ANHYDRITE DEPTH NA
(G.L./K.B.) (Stone Corral Formation)

CONDITION OF WELL: GOOD POOR CASING LEAK JUNK IN HOLE

PROPOSED METHOD OF PLUGGING In compliance w/ rules & regulations state Ks.

(If additional space is needed attach separate page)

IS WELL LOG ATTACHED TO THIS APPLICATION AS REQUIRED? yes IS ACO-1 FILED? _____

If not explain why? _____

PLUGGING OF THIS WELL WILL BE DONE IN ACCORDANCE WITH K.S.A. 55-101 AND THE RULES AND REGULATIONS OF THE STATE CORPORATION COMMISSION.

LIST NAME OF COMPANY REPRESENTATIVE AUTHORIZED TO BE IN CHARGE OF PLUGGING OPERATIONS:

E. L. Abercrombie PHONE# () 316 793-8186

ADDRESS Rt #1 Box 56 City/State Great Bend, Ks. 67530

PLUGGING CONTRACTOR Mike's Testing & Salvage, Inc. KCC LICENSE # 31529

ADDRESS P.O. Box 467, Chase, Ks. 67524 PHONE # () 316-938-2943

PROPOSED DATE AND HOUR OF PLUGGING (If Known?) soon as possible

PAYMENT OF THE PLUGGING FEE (K.A.R. 82-3-118) WILL BE GUARANTEED BY OPERATOR OR AGENT

DATE: 8-21-98 AUTHORIZED OPERATOR/AGENT: E.L. Abercrombie
(signature)

OCT 19 1978
KANSAS DRILLERS LOG

IMPORTANT
Kans. Geo. Survey request samples on this well.

S. 32 T. 31S R. 12W E

Loc. NE NE

County Barber

API No. 15 — 007 — 20679 . 00 . 00
County Number

Operator
Abercrombie Drilling

Address
801 Union Center Wichita, Ks. 67202

Well No. # 1 Lease Name Simpson

Footage Location
660 feet from (N) ~~W~~ line 560 feet from (E) ~~W~~ line

Principal Contractor Abercrombie Drilling, Inc. Geologist Harold Steincamp

Spud Date October 20, 1978 Total Depth 4285' P.B.T.D. 4252'

Date Completed October 28, 1978 Oil Purchaser

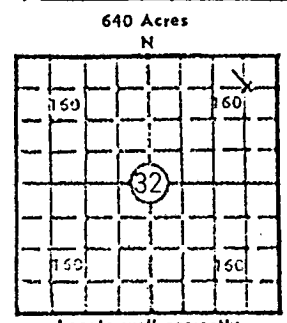

Elev.: Gr. 1545'

DF 1551' KB 1553'

CASING RECORD

Report of all strings set— surface, intermediate, production, etc.

Purpose of string	Size hole drilled	Size casing set (in O.D.)	Weight lbs/ft.	Setting depth	Type cement	Sacks	Type and percent additives
Surface	12 1/2"	8 5/8"	28#	477'	common	350	3% Ca.Cl. 2% gel.
Production	7-7/8"	4 1/2"	10 1/2#	4283'	50/50 posmix common	50 100	2% gel, 12 1/2# gilsco 2% gel, salt sat.
D.V. Tool	7-7/8"			2835'	common	150	2% Gel, salt sat.

LINER RECORD

PERFORATION RECORD

Top, ft.	Bottom, ft.	Sacks cement	Shots per ft.	Size & type	Depth interval
			2	strip jet	4200-4234'

TUBING RECORD

Size	Setting depth	Packer set at
2" Eue	4208.92'	

ACID, FRACTURE, SHOT, CEMENT SQUEEZE RECORD

Amount and kind of material used	Depth interval treated
500 gallon MCA, 1500 gallon 15% Non-E	4200-4234'
Fractured a/38, 500 gallons, 3% gelled acid water with 20/40 and 50 sacks of 10/20 sand	150 sacks 4200-4234'

INITIAL PRODUCTION

Date of first production	Producing method (flowing, pumping, gas lift, etc.)
RATE OF PRODUCTION PER 24 HOURS	Oil <u>Trace</u> bbls. Gas <u>11,100</u> MCF Water <u>Trace</u> bbls. Gas-oil ratio <u>CFPB</u>
Producing interval(s) <u>4 point test, 1-12-79</u> <u>4200-4234'</u>	

INSTRUCTIONS: As provided in KCC Rule 82-2-125, within 90 days after completion of a well, one completed copy of this Drillers Log shall be transmitted to the State Geological Survey of Kansas, 4150 Monroe Street, Wichita, Kansas 67209. Copies of this form are available from the Conservation Division, State Corporation Commission, 3830 So. Meridian (P.O. Box 17027), Wichita, Kansas 66217. Phone AC 316-522-2206. If confidential custody is desired, please note Rule 82-2-125. Drillers Logs will be on open file in the Oil and Gas Division, State Geological Survey of Kansas, Lawrence, Kansas 66044.

Operator Abercrombie Drilling, Inc.		DESIGNATE TYPE OF COMP.: OIL, GAS, DRY HOLE, SWDW, ETC.: Gas
Well No. 1	Lease Name Simpson	
S 32 T 31 S R 12 W		

WELL LOG

Show all important zones of porosity and contents thereof; cored intervals, and all drill-stem tests, including depth interval tested, cushion used, time tool open, flowing and shut-in pressures, and recoveries.

SHOW GEOLOGICAL MARKERS, LOGS RUN, OR OTHER DESCRIPTIVE INFORMATION.

FORMATION DESCRIPTION, CONTENTS, ETC.	TOP	BOTTOM	NAME	DEPTH
Red bed and sand	0	477	<u>SAMPLE TOPS:</u>	
Red bed and shale	477	585		
Red bed, shale and lime	585	1815	Indian Cave	2586' (-1033)
Lime and shale	1815	2135	Elgin Shale	3348' (-1795)
Shale and lime	2135	2535	Heebner	3500' (-1947)
Lime and shale	2535	2622	1st Douglas Sand	3556' (-2003)
Shale and lime	2622	2740	2nd Douglas Sand	3650' (-2097)
Lime and shale	2740	3455	Lansing	3689' (-2136)
Shale and lime	3455	3539	Stark Shale	4041' (-2488)
Lime and shale	3539	4285		
Rotary Total Depth		4285	<u>ELECTRIC LOG TOPS:</u>	
DST #1 (2582-2622') Indian Cave Sand			Indian Cave	2582' (-1029)
30", 45", 60", 45"			Elgin Shale	3345' (-1792)
Gas to surface 20", 30" gauged 66,600			Heebner	3500' (-1947)
CFGPD			1st Douglas Sand	3556' (-2003)
2nd open 10" gauged 151,000 CFGPD			2nd Douglas Sand	3650' (-2097)
20" gauged 151,000 CFGPD			Lansing	3688' (-2135)
30" gauged 159,000 CFGPD			Miss.	4194' (-2641)
40" gauged 167,000 CFGPD,			B/Miss. Chert	4252' (-2699)
stabilized at 167,000.			LTD	4284' (-2731)
Rec. 135' water cut mud 1/3, 376' mdy wtr			DTD	4285' (-2732)
IFP 85-106, IBHP 1087, FFP 138-181,				
FBHP 1066.				
Temp. 96°				
DST #2 (3531-3585') 15", 45", 60", 45"				
Strong blow. Rec. 2100' sw				
IFP 189-379, IBHP 1391, FFP 540-1038,				
FBHP 1391				
DST #3 (4179-4285')				
Gas to surface 6 minutes, stabilize				
158,000				
Rec. 424' free oil, 372' gas & mdy oil				
IBHP 1474, FBHP 1370				

RECEIVED
 AUG 24 1953
 STATE OF KANSAS
 DEPARTMENT OF GEOLOGY

USE ADDITIONAL SHEETS, IF NECESSARY, TO COMPLETE WELL RECORD.

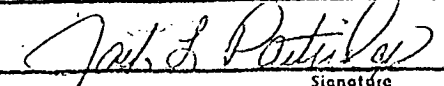
Date Received	 Signature
	Jack L. Partridge, Asst. Sec.-Treas. Title
	Date



Kansas Corporation Commission

Bill Graves, Governor John Wine, Chair Susan M. Seltsam, Commissioner Cynthia L. Claus, Commissioner

NOTICE OF RECEIPT OF WELL PLUGGING APPLICATION (CP-1)

August 24, 1998

A.L. Abercrombie, Inc.
Rt. #1 Box 56
Great Bend, Ks.

Simpson #1
API 15-00720679
100'E-C NE NE
Sec. 32-31S-12W
Barber County

Dear E.L. Abercrombie,

This letter is to notify you that the Conservation Division is in receipt of your plugging proposal, form CP-1, for the above-captioned well.

Your CP-1 has been reviewed by the Conservation Division central office for completeness and to verify license numbers. The plugging proposal will now be forwarded to the district office listed below for review of your proposed method of plugging.

Please contact the district office for approval of your proposed plugging method at least at five (5) days before plugging the well, pursuant to K.A.R. 82-3-113 (b). If a workover pit will be used during the plugging of the well it must be permitted. A CDP-1 form must be filed and approved prior to the use of the pit.

The Conservation Division's review of form CP-1, either in the central or district office, does not include an inquiry into well ownership or the filing operator's legal right to plug the well.

This notice in no way constitutes authorization to plug the above-captioned well by persons not having legal rights of ownership or interest in the well. This notice is void after ninety (90) days from the above date.

Sincerely,

A handwritten signature in cursive script, appearing to read "David P. Williams".

David P. Williams
Production Supervisor

District: #1
304 W. McArtor
Dodge City, KS 67801
(316) 225-8888